

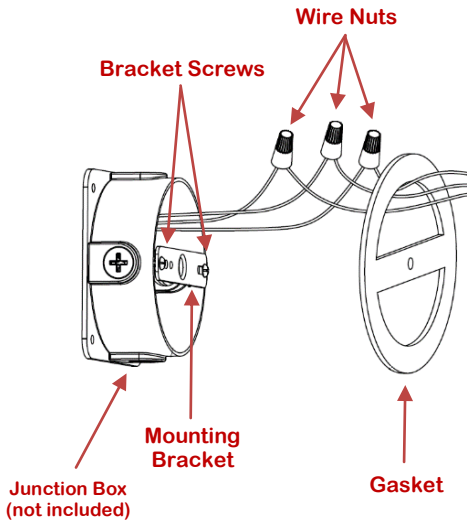

# LED Floodlight

QUICK START GUIDE

# Assembly Guide



**Mounting  
Base**

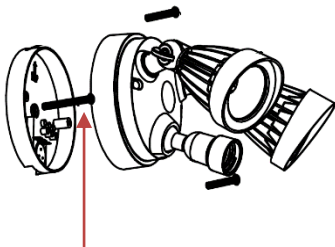
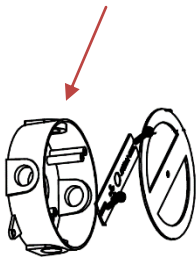

**Bracket  
Screw**

# What's Included

Floodlight



Gasket



Mounting Bracket



Screwdriver



Wire Nuts (x3)



Long Bracket Screw



Medium & Short Bracket Screws  
(x2 each)



Note:

# Before You Begin

- Shut OFF the power at the fuse or circuit breaker box.
- DO NOT rely on a wall switch alone to turn off the power.
- If you're unsure which switch it is to turn off the floodlight power, please consult with a licensed electrician.
- Make sure your setup location will have strong Wi-Fi reception.
- This equipment is intended for installation in a restricted access location. Access can only be gained by service persons or by users who have been instructed about the reasons for the restrictions applied to the location and about any precautions that shall be taken.
- If you plan to perpetually power on device, please add appropriate disconnecting apparatus and overcurrent protection device, outside of the device.
- **WARNING: Failing to shut off the power could result in a serious injury, electrical shock, and/or risk of fire.**



## Step 1: Download the app



Reflection Home

- Download the **Reflection Home App** from the Apple App Store or Google Play.
- **Connect your mobile device Wi-Fi** to the network you want your camera to be paired to.
- The app also includes the installation instructions and videos if you prefer.

**Important:** Make sure the app you download matches the same logo as shown above.

## Step 2: Remove your existing floodlight

- Use a screwdriver or another tool to remove your existing floodlight from the junction box.
- Disconnect the three sets of wires from the floodlight.
- If there is a mounting bracket attached to your junction box, you may remove that as well.

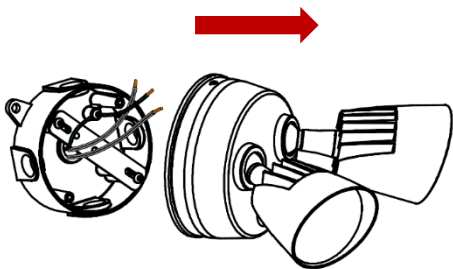

## Step 3: Install the bracket and gasket

- Use the provided screws in the box to install the mounting bracket onto your junction box. Make sure it is tight and secure.
- With the provided gasket, peel off the white tape and stick that side around the opening in the wall. **Make sure the center hole lines up with the center bracket hole and that there are no openings around the gasket.**

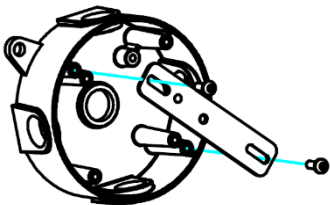



## Step 4: Connect the wires

- You should see three sets of wires from both your wall and the mounting base: a ground wire (usually green or copper), black wire, and white wire.
- Use the provided wire nuts to twist the open ends of the matching wires together.

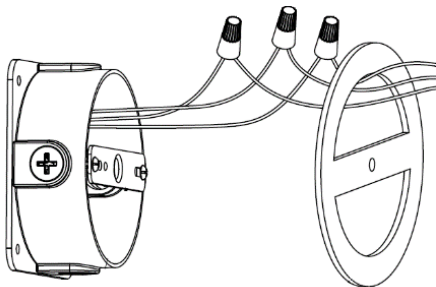

## Step 5: Install the mounting base

- First, make sure that the mounting base is set properly.
- With the provided long screw, push the screw through the middle screw-hole of the mounting base. Use the provided screwdriver to tightly secure it.
- Ensure that the gasket and base is tight and does not move.

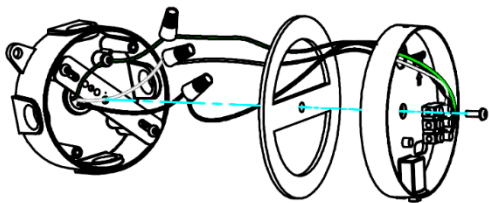

## Step 6: Mount the floodlight

- The floodlight can now be mounted onto the mounting base. Make sure the screw-hole at the top matches on both the mounting plate and the floodlight, then use the provided screw and screwdriver to screw them tightly in place.



## Step 7: Pair the floodlight

- Turn on the power from the power breaker. Once the power is back on, a sound will play from the floodlight notifying you that it's ready to pair.
- Go back into the Reflection Home app and follow the in-app screens to complete the pairing process.



## Reset

1. To perform a factory reset, you must **open the cap and hold its internal reset button for 10 seconds.**

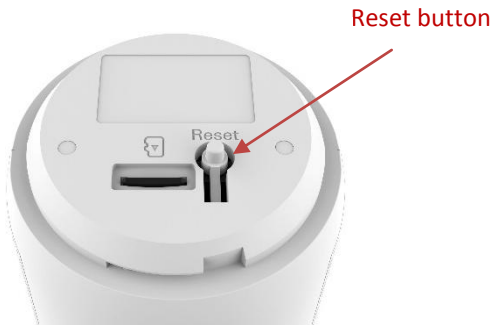

## Light Indicators & Status

1. **Solid Pink** – Booting
2. **Blinking Red** – Recording in progress
3. **Blinking Blue** – Ready to connect to WiFi
4. **Double Blinking Blue** – Connecting to Wi-Fi
5. **Solid Blue** – Connected to WiFi

Indicator  
light



## **FCC Warning**

This device complies with part 15 of the FCC rules. Operation is subject to the following two conditions: (1) this device may not cause harmful interference, and (2) this device must accept any interference received, including interference that may cause undesired operation.

Changes or modifications not expressly approved by the party responsible for compliance could void the user's authority to operate the equipment.

**NOTE:** This equipment has been tested and found to comply with the limits for a Class B digital device, pursuant to part 15 of the FCC Rules. These limits are designed to provide reasonable protection against harmful interference in a residential installation. This equipment generates uses and can radiate radio frequency energy and, if not installed and used in accordance with the instructions, may cause harmful interference to radio communications. However, there is no guarantee that interference will not occur in a particular installation. If this equipment does cause harmful interference to radio or television reception, which can be determined by turning the equipment off and on, the user is encouraged to try to correct the interference by one or more of the following measures:

- Reorient or relocate the receiving antenna.

- Increase the separation between the equipment and receiver.
- Connect the equipment into an outlet on a circuit different from that to which the receiver is connected.
- Consult the dealer or an experienced radio/TV technician for help.

## Radiation Exposure Statement

This equipment complies with FCC radiation exposure limits set forth for an uncontrolled environment. This equipment should be installed and operated with minimum distance 20cm between the radiator and your body.

### **Reflection International Inc.**

1502 Foothill Blvd., #103-222,

La Verne, CA 91750

Customer Service: + 1 888 889 8320

E-mail: [help@reflectionamerica.com](mailto:help@reflectionamerica.com)





[www.reflectionamerica.com](http://www.reflectionamerica.com)