

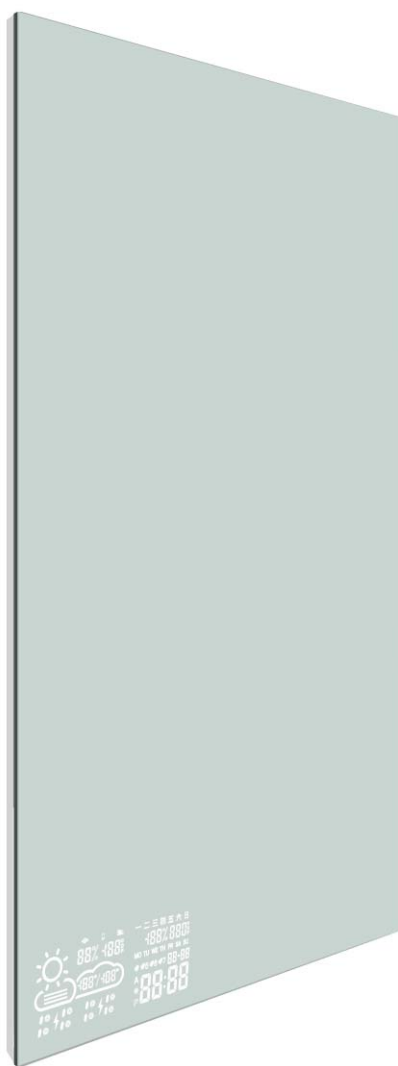

Smart Mirror

INSTALLATION AND OPERATING INSTRUCTION



Questions?

Please call or email us – our friendly associates are ready to help.

Tel: 0086 516 83567656

Email: info@byecold.com

READ BEFORE USE

- Thank you for purchasing this Byecold product.
- Please read the instructions carefully before attempting to install, operate or service the product.
- Please retain this booklet for future reference.
- Pictures for reference only, subject to our available products

SCOPE OF DELIVERY

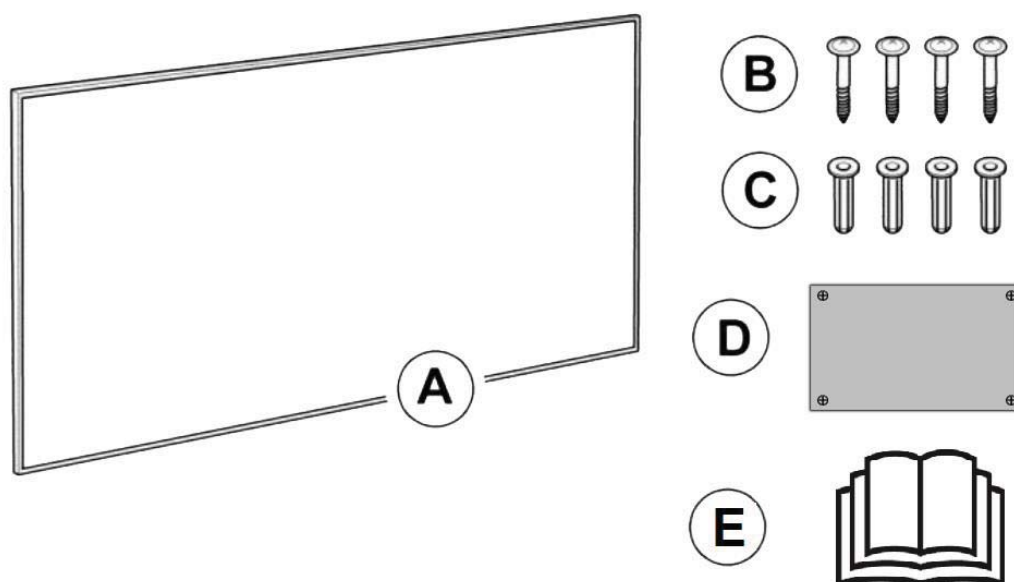

A: Smart Mirror × 1

B: Screw × 4

C: Dowel × 4

D: Drill template × 1

E: Manual × 1

CONTENTS

Product Introduction.....	
Safety Introduction.....	
Information about the device.....	
Installation.....	
Operation.....	
Maintenance.....	
Troubleshooting.....	
Warranty.....	

PRODUCT INTRODUCTION

Byecold smart mirror is a device which with that functions as a bathroom mirror with additional functions, such as displaying weather forecast, date and time, temperature and humidity, LED lighting, defogging etc. Users can select the product with different functions according to self-requirement. Please ignore the related operating instructions in this booklet if you didn't subscribe some functions when ordering.

SAFETY INTRODUCTION

The following instructions should be strictly observed in order to prevent injury to the users and other persons, or damage to property.



WARNING:

- Do not ceiling mount those panels designed for wall only! Or else it may cause burning and fire!
- This appliance can be used by children aged from 8 years and above and persons with reduced physical, sensory or mental capabilities or lack of experience and knowledge if they have been given supervision or instruction concerning use of the appliance in a safe way and understand the hazards involved.
- Children shall not play with the appliance. Cleaning and user maintenance shall not be made by children without supervision.
- Children of less than 3 years should be kept away unless continuously supervised.
- Children aged from 3 years and less than 8 years shall only switch on/off the appliance provided that it has been placed or installed in its intended normal operating position and they have been given supervision or instruction concerning use of the appliance in a safe way and understand the hazards involved. Children aged from 3 years and less than 8 years shall not plug in, regulate and clean the appliance or perform user maintenance.
- In order to avoid overheating and fire hazard, do not cover the device.
- This device may get hot when in use and for a short period after use. To avoid burns, do not let bare skin touch hot surfaces. Extreme caution is necessary when the device is used by or near children or infirm persons.
- Do not use the device with wet or damp hands.

- Never insert any objects or limbs into the device.
- Do not use the device in potentially explosive rooms.
- Do not use near open flames. Do not store near heat sources.
- Do not place any objects, e.g. clothing, on the device.
- Do not use the device outdoors. Do not place the device on wet or flooded ground.
- Do not unplug by pulling on the cable. To unplug, grasp the plug, not the cable.
- Do not stretch the cable or place the cable under strain.

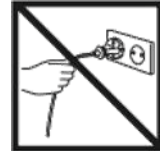

Keep cable away from heated surfaces.

- Do not stretch the cable or place the cable under strain. Do not run the cable under carpeting. Do not cover the cable with throw rugs, runners, or similar coverings. Do not route the cable under furniture or appliances. To avoid a tripping hazard arrange the cable away from traffic areas so that it will not be tripped over.
- Do not use on soft surfaces, such as a bed, where openings may become blocked.
- Keep combustible materials, such as furniture, pillows, bedding, papers, clothes and curtains, at least 0.9m (3 feet) from the front of the appliance and keep them away from the sides and rear when the appliance is plugged in.
- If the supply cord is damaged, it must be replaced by the manufacturer, its service agent or similarly qualified persons in order to avoid a hazard.
- If there is a loose fit between the plug and the socket or the plug becomes very hot, the socket may need to be replaced. Check with a qualified electrician to replace the socket.
- Turn off all controls before unplugging. Unplug before connecting any tool or accessory.
- Allow the device to cool down before transport and / or maintenance work.
- Do not privately disassemble the device or replace parts, otherwise it may cause mechanical failure, electric shock, fire or body injury.
- The warranty is not applicable for the product fault caused by private disassembly.



Warning:

Do not cover.

Insert the mains plug into an outlet that is properly installed and grounded.

Do not locate directly below a mains electricity supply socket.

STRUCTURE

(Front)

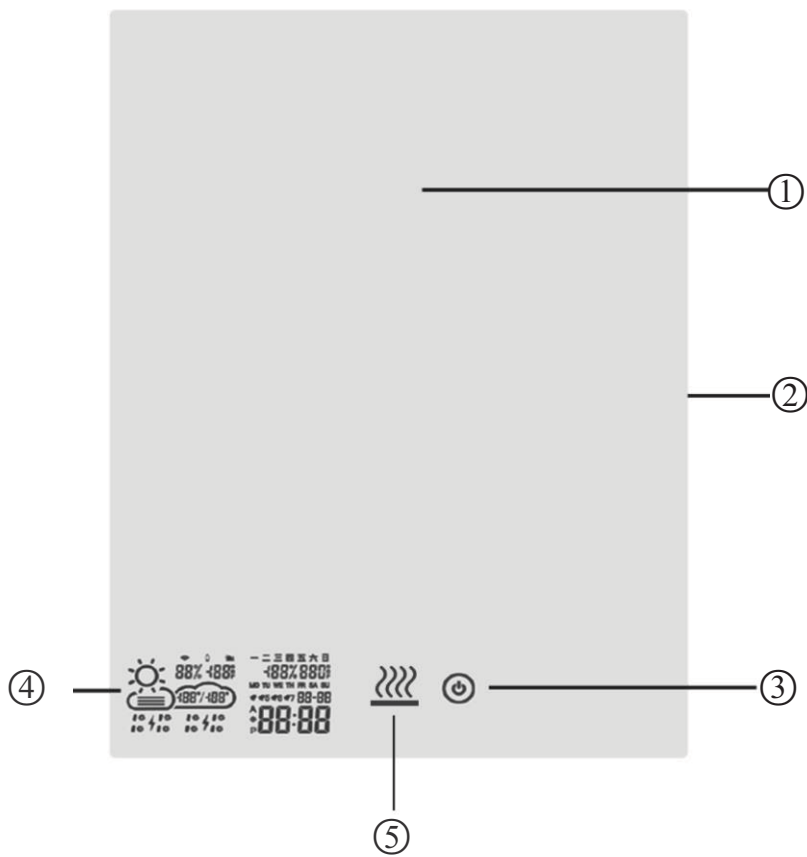

(Back)

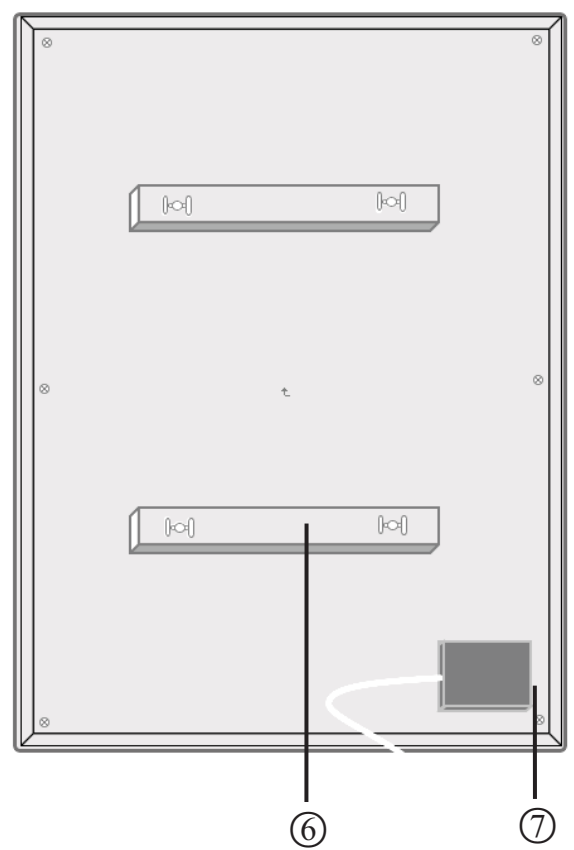

- ① Mirror Surface ② LED Strip Light
③ Touch Switch ④ Display Screen (Visible when double-click)
⑤ Defogging (Visible when single click) ⑥ Mounting Brackets
⑦ Temperature Humidity Sensor

INSTALLATION

- (1) Choose the mounting position, keep the required minimum distances;
- (2) Mark the positions for the bore holes onto the drilling template (D) if there are no existing marks. Stick the drilling template on the wall;

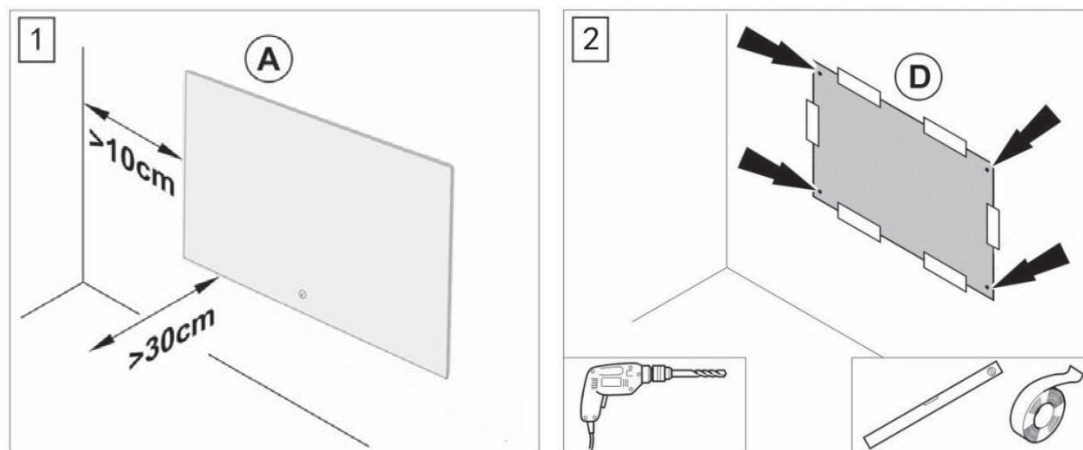

- (3) Drill the holes. Insert the screws into the dowels and fasten the screws. The screws should protrude approx. 1.5 cm from the dowels;
- (4) Tear off the back protective film, Hang the mirror (A) on the screws and move it to one direction.

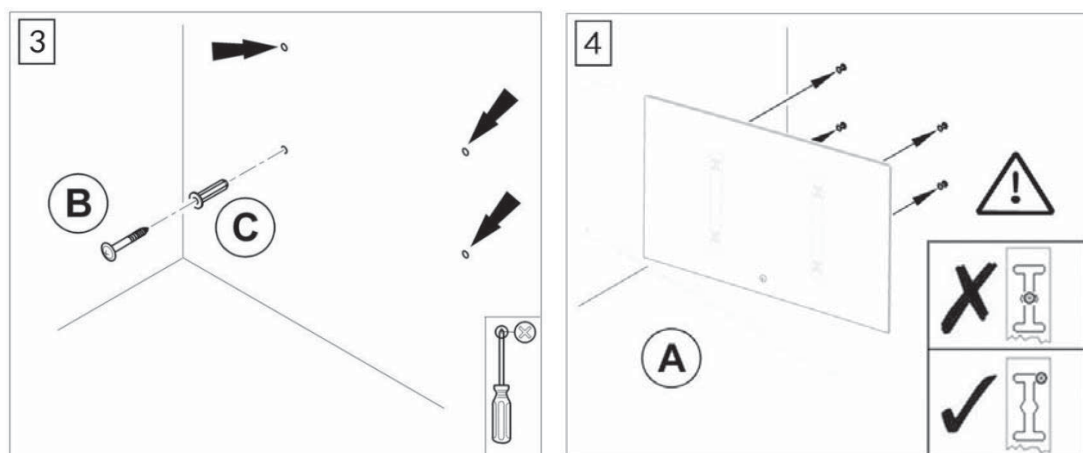

Note: please tear off the front and back protective film once you start to use.

OPERATION

START-UP:

1. Check if the power cord is intact.
2. Check if the power supply voltage is consistent, the power socket is required to have a grounding terminal and good grounding performance.
3. Whether the power cord plug and socket are matched, the socket can withstand 220-240V/50HZ, 10A. If it is lower than this value, it cannot be used to avoid accidents.

FUNCTIONAL OPERATING INSTRUCTIONS:

1. After the power is turned on, the backlight of the touch button is always on;
Click the touch button once, the surrounding LED lights up, touch again, the light goes out. If the LED lighting is not selected when ordering, click the touch button is invalid;
2. Double click the touch button once, the weather display screen is turned on, and double click again to close;
3. Long press the touch button to turn on the heating or defogging function, the blue heating indicator next to the touch button lights up, long press again to turn off heating/Defogging. If the function of heating or fogging is not selected when ordering, Long press the touch button is invalid.

WEATHER DISPLAY OPERATING INSTRUCTIONS:

1. Ensure that the installation location has a good WIFI signal, and make the operating of mobile phone and smart mirror APP connected to the same WIFI hotspot;
2. Double click the touch switch to start the screen and wait for the screen to display the SCAN status;
3. Scan the QR code of the following figure (1) and install the APP according to the prompts;

Note: This App only supports Android phone operation for the time being. The weather display WIFI needs to use the Android phone only for the first time and when you occasionally changes its settings later.

For IOS operating system, please search and install the APP named "WifiClock" in App Store



Figure (1)



WifiClock

Figure (2)

4. After the installation is successful, find the WifiClock application icon on the mobile phone desktop and open it, as shown in the figure above (2);
5. After opening the app, the following interface is displayed, click to add a WIFI clock;

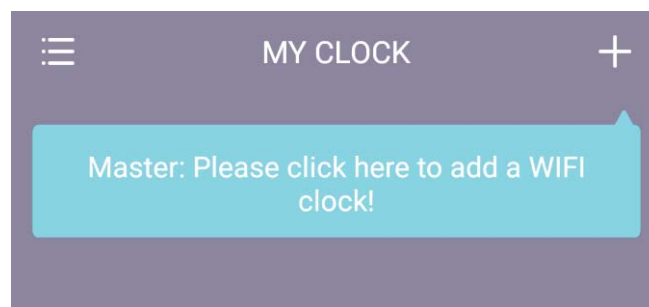

6. Next select the WIFI hotspot and enter the wireless password. The screen will display the configuration, waiting for about 60 seconds, at the same time, the mirror screen displays JOIN, then PAIR is set successfully.

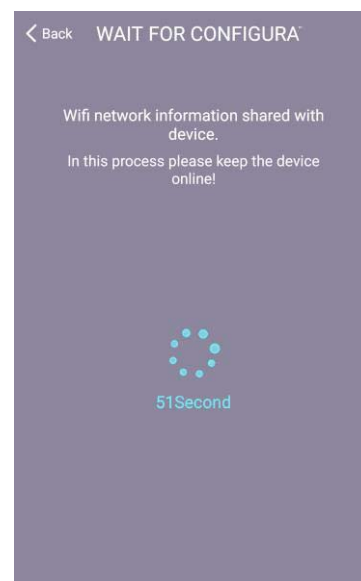
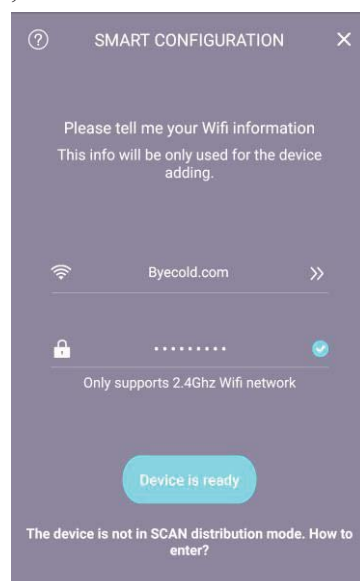

7. After the pairing is successful, the following interface is displayed. A mobile phone can add several WIFI clock terminals.

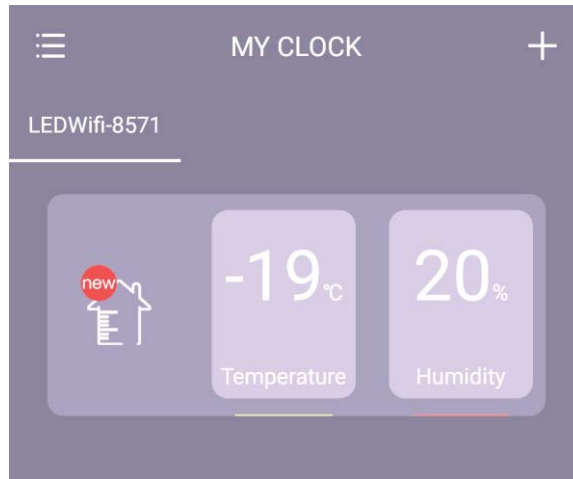

8. For each WIFI clock device, you can make the following settings.

1) Basic setting: You can set the switch button sound. This button sound refers to whether the buzzer inside the mirror is buzzing when the phone is operated. 24 hours/12 hours display selection; day and month mode selection; temperature unit selection; digital tube display brightness adjustment on the mirror.

2) Alarm setting: Users can set several groups of alarms through the mobile phone. Until the time, the buzzer alarm inside the mirror will sound.

3) Weather setting: After the weather scroll screen is turned on, the screen will scroll the weather of the day and tomorrow (d2); the area setting is used to select the area where the weather is to be displayed. The default is automatically set to the local area where the network IP belongs. If the automatic positioning is not successful, you need to manually set the area; server selection means that if the user finds that the displayed weather is quite different from the actual weather, you can replace another server to get a more accurate weather display; today's weather selection refers to whether the screen display is real-time weather or the total forecast of the day.

Note: The weather information source of this APP application is Yahoo weather, and there may be that the weather update is not timely.

4) Sleep mode: Refers to setting the digital light screen display timing, the screen system will automatically reduce the brightness during sleep, to achieve the purpose that energy saving or not affect the user's sleep;

5) Firmware version: Refers to the current software version, the system will automatically update the version if necessary;

6) Delete device: Refers to the mobile phone is no longer connected to the device, after

deleting, you need to restart the connection.

7) When the WIFI hotspot is replaced, you need to restart the device to reconnect. The specific operation is to cut off the total power supply (this does not mean double-clicking the touch button to close the screen, closing the screen and not disconnecting the power supply) three times or more. Each power-on needs to hear the “Patter” inside the mirror before the next power-off. After three or more power-offs, double click the touch switch to turn on the screen. The SCAN status is displayed and set up by the mobile phone.

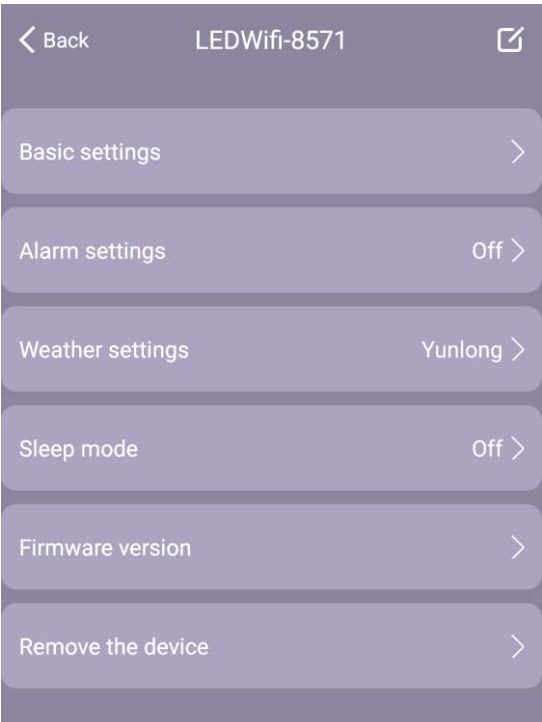

8)The device displays 11 different icons, including sunny, overcast, cloudy, light rain, heavy rain, thunderstorm, shower, light snow, heavy snow, sleet and haze / fog. The icons is shown in the following table:

Weather	Icon	Weather	Icon
Sunny		Shower	
Overcast/Cloudy		Light snow	
Cloudy to clear		Heavy snow	
Light rain		Sleet	
Heavy rain		Foggy	
Thunderstorm		Unknown	

MAINTENANCE

- ☑ The appliance must be switched off and unplugged before taking regular cleaning and care. Otherwise, it may cause electric shock..
- ☑ The appliance needed only external cleaning and care regularly.
- ☑ Please use some medicinal alcohol clean the surface with damped soft cloth. Never clean it under running water. Do not use thinner, toluene,benzene, acidic/alcoholic cleaning agents, or any chemical clothes on the appliance.
- ☑ After regular care and cleaning, well pack it into the original packing box, then put it to dry and cool environment for storage.
- ☑ Wind and keep dry the cable when not in use.

TROUBLESHOOTING

The device has been checked for proper functioning several times during production. If malfunction occur nonetheless, check the device according to the following list.

Problem	Reason	Measure
The touch button does not light	The device does not start	Check the power connection
The device makes noises after switch-on	Some parts are loose caused by transportation	It's a normal process. No measure are required.
The surface bulges slightly	The material expands due to heating	It's a normal process. No measure are required.
Indoor Temperature / humidity are displayed inaccurately	The sensor maybe covered	Make sure that the sensor is placed at a right position,should not be covered or touched by other materials.
The device is unable to connect WIFI	Wifi signal is poor or network failures	Restart the router and device.
The real-time weather is displayed inaccurately	Yahoo data is not updated	Connect another sever in your APP.

Warranty Card

NAME _____ TEL _____

ADD _____

MODEL _____ ORDER NO. _____

Date _____

Failure Description

THANK YOU FOR CHOOSING TO BUY A BYECOLD APPLIANCE.

Customers can contact us for repairing or replacement of your Byecold appliance if it is found to be defective due to faulty materials, workmanship or function within 1 years of purchase or delivery.

Byecold does not guarantee the repair or replacement of a product where a defect is the result of:

- Damage caused by not carrying out the recommended appliance maintenance.
- Accidental damage, faults caused by negligent use or care, misuse, neglect, careless operation or handling of the appliance which is not in accordance with our Operating Manual.
- Use of the appliance for anything other than normal domestic household purposes.
- Faulty installation .
- Repairs or alterations carried out by parties other than Byecold or its authorised agents.

If you are in any doubt as to what is covered by your guarantee, please contact us.



XUZHOU BYECOLD TECHNOLOGY CO.LTD

 No.666,Mingzhu Industry Zone, Zhaodun Town, Pizhou City, Jiangsu

 www.byecold.com

 TEL: +86 516 83567656

FCC Statement

This equipment has been tested and found to comply with the limits for a Class B digital device, pursuant to part 15 of the FCC rules. These limits are designed to provide reasonable protection against harmful interference in a residential installation. This equipment generates, uses and can radiate radio frequency energy and, if not installed and used in accordance with the instructions, may cause harmful interference to radio communications. However, there is no guarantee that interference will not occur in a particular installation. If this equipment does cause harmful interference to radio or television reception, which can be determined by turning the equipment off and on, the user is encouraged to try to correct the interference by one or more of the following measures:

- Reorient or relocate the receiving antenna.
- Increase the separation between the equipment and receiver.
- Connect the equipment into an outlet on a circuit different from that to which the receiver is connected.
- Consult the dealer or an experienced radio/TV technician for help.

To assure continued compliance, any changes or modifications not expressly approved by the party.

Responsible for compliance could void the user's authority to operate this equipment. (Example- use only shielded interface cables when connecting to computer or peripheral devices).

This equipment complies with Part 15 of the FCC Rules. Operation is subject to the following two conditions:

- (1) This device may not cause harmful interference, and
- (2) This device must accept any interference received, including interference that may cause undesired operation.

FCC Radiation Exposure Statement:

The equipment complies with FCC Radiation exposure limits set forth for uncontrolled environment. This equipment should be installed and operated with minimum distance 20cm between the radiator and your body.

Any Changes or modifications not expressly approved by the party responsible for compliance could void the user's authority to operate the equipment.