

USER MANUAL FOR CERTIFICATION

Getting started

- 1 Find the app at www.orbitkey.com/tracker
 - 2 Follow the easy in-app steps to set up Orbitkey Bluetooth Tracker using the Chipolo app.
- More info and customer support available at:
www.chipolo.net/support

Replacing the battery

- 1 Slide the bottom case outwards to reveal the battery case.
- 2 Replace the battery with a new CR1620 type battery, placing the battery (+) up.
- 3 Close the Orbitkey Bluetooth Tracker by sliding the bottom case back through the allocated slot.

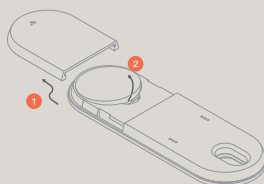

Product disposal

At the end of its service life, this product should not be treated as household or general waste. Its should be handed over to the applicable collection point for recycling of electrical and electronic equipment, or returned to the supplier for disposal.

Requirements

IOS devices running version 9.0 and later, and Android devices running version 4.4 and later. Complete list of supported devices available at www.chipolo.net/devices

Specification

Tracker range:	up to 50m (160 ft) - in open space -
Sound output:	90 - 95 dB
Temperature range:	-10 c ~ 60 c
Voltage range:	1.8V ~ 3V
Frequency range:	2.4Ghz ISM band
Battery type:	CR1620
Battery life:	up to 6 months

Customer support

For additional details or assistance about the product quality, contact us at:
support@orbitkey.com

For software and connection, contact:
support@chipolo.net

2-year warranty applies.

FCC statement

This device complies with part 15 of FCC Rules. Operation is subject to the following two conditions:
1. This device may not cause harmful interference.
2. This device must accept any interference received, including interference that may cause undesired operation.

Any changes or modifications not expressly approved by the party responsible for compliance, may void the authorization to operate this equipment.

NOTE

This equipment has been tested and found to comply with the limits for a Class B digital device, pursuant to part 15 of the FCC Rules. These limits are designed to provide reasonable protection against harmful interference in a residential installation. This equipment generates uses and can radiate radio frequency energy and, if not installed and used in accordance with the instructions, may cause harmful interference to radio communications. However, there is no guarantee that interference will not occur in a particular installation. If this equipment does cause harmful interference to radio or television reception, which can be determined by turning the equipment off and on, the user is encouraged to try to correct the interference by one or more of the following measures:

- Reorient or relocate the receiving antenna.
- Increase the separation between the equipment and receiver.
- Connect the equipment into an outlet on a circuit different from that to which the receiver is connected.
- Consult the dealer or an experienced radio/TV technician for help.

The device has been evaluated to meet general RF exposure requirement. The device can be used in portable exposure condition without restriction.