

ANC TWS TA-02
USER MANUAL

Thank you!

Thank you for choosing the ANC earbuds TA-02!
Please read this manual carefully and follow the instructions listed in order to optimize the use of your new earbud and enjoy music&calls

What's included

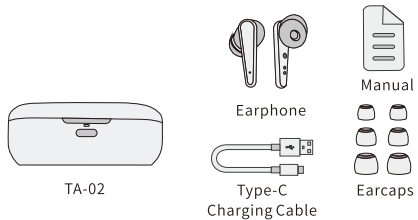

Product Description
Earphone

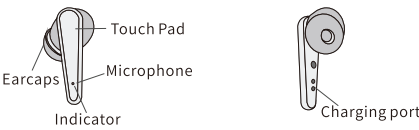

Start to Use
Charging

- Remove the protective film from the earbuds when using for the first time.
- Fully charge both the earbuds and the charging case before the first-time using.
- To prevent damage, use the provided Type-C cable.
- Fully dry off the earbuds and the USB port before charging.

-Charge the Earbuds
Charging: place the earbuds in the charging case

LED behaviour (Earbuds)		
L/R Earphone	Red light is always on	Being Charging
L/R Earphone	Red light off	Full Charged

-CHARGE THE CASE
Please use the attached Type-C Charging cable and with the power adapter to charge.

Check the battery(Charging Case)

The indicator would indicate the battery while open the lid
The indicator would indicated the battery while press the function button on the charging case

Steady Blue for 1 second	Battery>40%
Steady Red for 1 second	10%<Battery<40%
Red light flashes three times	Battery<10%

Wearing

1. Choose the ear tips that fit your ears the best.
2. Insert the earbuds into the inner canal of your ears.
3. Turn and find the most comfortable position.

Powering On/Off

The earphones will auto power on when open the charging case; and will auto power off after putting the earphone back to the charging case.

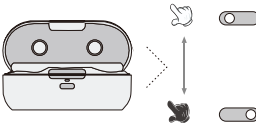

Auto Power off by below situation:

- .Dead battery
- .Take out from the charging case without connecting with device and ANC off Over 5 mins
- .The distance cause disconnect by over 5 mins

prompt tone

Power on	/
Power off	Power Off
Low battery	Battery low

Connect	Pairing
Transparency/Noise reduction mode	Ambient sound/ANC ON/ANC OFF
Paired successfully	TWS connected
Voice assistant	"du"
change Next/Previous song	"du"
Disconnect	sound disconnected
Connection succeeded	sound connected
Incoming call	you have incoming call
Reject the call	Call Rejected

TWS pairing connection of left and right earphones

The earphone will be auto pairing and by default binaural mode when take out from the charging case

LED behaviour (Earbuds)

L/R Earphone	Blue lights flashing	Pairing
Right Earphone	Red and blue lights flickered alternately	Pairing Succeeded
Left Earphone	Extinct	Pairing Succeeded
Right Earphone	Red and blue lights flickered alternately	Pairing with a Bluetooth device
L/R Earphone	Slowly flashing blue lights	The bluetooth device has been connected

Bluetooth Pairing with your Device

The earphone will be auto pairing and by default binaural mode when take out from the charging case

Function operation

Binaural mode		
Power on pairing (Earphone)	When the charging case lid is opened, the earphone will automatically turn on and return to the connected earphone if it has not been connected to other Bluetooth devices.	
Earphone connection	There will be have sound connected voice after the earphone pairing successfully with the device.	
Auto connect	The earphone will be connected back to the last connected device When it turn on.	
Battery display	After the earphone connected your device successfully, it can be supports the display of battery power of IOS system and some Android phones.	
Turn off	Put the earphone into the charge case and close the lid	
Turn on	Open the charge case lid and the earphone will turn on automatically	

Hang up the phone	Call active: Touch the left or right earbuds 1 second
Reject the call	Incoming call status: Touch the left or right earbuds 1 second
Answer the call	Incoming call status: Click the left or right earbuds 1time
Cancel the call	Call status: Touch the left or right earbuds 1 second
Next song	Touch right earbuds 1second
Previous song	Touch left earbuds 1 second
Music play/pause	Click right earbuds 2times
Normal mode	The earphone is on normal mode by default, during the Binaural mode touch the left or right earbuds 2seconds to change Normal mode/Transparency mode/Noise reduction mode.
Transparency mode	Touch left or right earbuds 2seconds on the Binaural model, there will have Ambient sound prompt tone from Normal mode to Transparency mode.
ANC on	Touch left or right earbuds 2seconds on the Binaural model, there will have ANC on prompt tone from Transparency mode to Noise reduction mode.
ANC off	Touch left or right earbuds 2seconds on the Binaural model, there will have ANC off prompt tone from ANC mode to Normal mode.
Voice assistant	Double-click the left earbuds when the earphone is connected the phone.

Single ear use

Earphone connect	There will have sound connected prompt tone when the earphone pairing the mobile phone successfully
Automatic connect	The earphone will pair with final device connection automatically when it's turn on
Hang up the phone	Call active: Touch the earbuds 1 second
Reject the call	Incoming call status: Touch the earbuds 1 second
Answer the call	Incoming call status: Click the earbuds 1time
Cancel the call	Call status: Touch the earbuds 1 second
Music play/pause	Double-click left/right earbuds
Battery display	After the earphone connected successfully, it can be supports the display of battery power of IOS system and some Android phones.
Voice assistant	Double-click the earbuds when the earphone is connected the phone.
Transparency mode	There is no transparency mode and ANC mode on monaural mode ANC mode

Turn off	Put the earphone into the charge case and close the lid
Turn on	Open the charge case lid and the earphone will turn on automatically

Others

Binaural mode	The earbuds will be pairing automatically when we open the charging case lid, it's Binaural mode by default.
Factory data reset	Place the earbuds into the charging case and open the lid, long press the button on the charge case around 6s, till the LED indicators in the charging case flash 5times and extinct, and the earbuds Led indicators will flash red and blue light simultaneously.

Earphone Reset:

If the earbuds are not able to connect each other or to the device, please reset the earphones by below operating:

1. Place the earbuds into the charging case, open the lid, long push button on the charging case over 6s, till all the LED indicators are flash 5times, let go after lights off.
2. The indicator flash at the same time on the earbuds, till left earbuds indicator light off, right earbuds indicator flashing alternately in blue and red color, the earbuds reset pairing successfully.
3. All paired data will be deleted after the earphones reset.

Specification

- Product model: TA-02
- Chip model: BES2300ZP
- Bluetooth version: Bluetooth V5.0, support protocol HFP/HSP/A2DP/AVRCP/SPP
- Communication distance: ≥ 10 meters (accessibility)
- Noise reduction depth: -25dB or above
- Noise reduction bandwidth: 20-3KHZ
- The speaker sensitivity: 97 ± 1.5 dB At 1KHz 1mW
- Frequency range: 20Hz-20KHZ
- Charging current: charging warehouse ≈ 400 mA (wired) / charging warehouse ≈ 200 mA (wireless); headphones ≈ 25 mA
- Battery specifications: rechargeable polymer lithium battery 28mAh / charging warehouse battery 400mAh
- Play time: (varying from volume to volume and content) 3 hours (a total of 18 hours with a charging bin)

FCC Caution:

This device complies with part 15 of the FCC Rules. Operation is subject to the following two conditions: (1) This device may not cause harmful interference, and (2) this device must accept any interference received, including interference that may cause undesired operation.

Any Changes or modifications not expressly approved by the party responsible for compliance could void the user's authority to operate the equipment.

Note: This equipment has been tested and found to comply with the limits for a Class B digital device, pursuant to part 15 of the FCC Rules. These limits are designed to provide reasonable protection against harmful interference in a residential installation. This equipment generates uses and can radiate radio frequency energy and, if not installed and used in accordance with the instructions, may cause harmful interference to radio communications. However, there is no guarantee that interference will not occur in a particular installation. If this equipment does cause harmful interference to radio or television reception, which can be determined by turning the equipment off and on, the user is encouraged to try to correct the interference by one or more of the following measures:

- Reorient or relocate the receiving antenna.
- Increase the separation between the equipment and receiver.
- Connect the equipment into an outlet on a circuit different from that to which the receiver is connected.
- Consult the dealer or an experienced radio/TV technician for help.

The device has been evaluated to meet general RF exposure requirement. The device can be used in portable exposure condition without restriction.