



Electric toothbrush

Model: SP-1231

Toothbrush: FCC ID: 2AT33-1, Clock: FCC ID: 2AT33-2

Instruction Manual

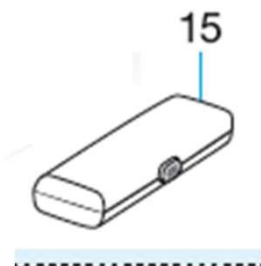
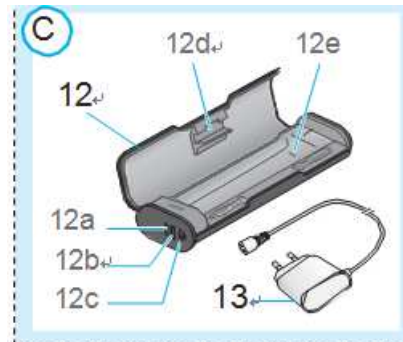
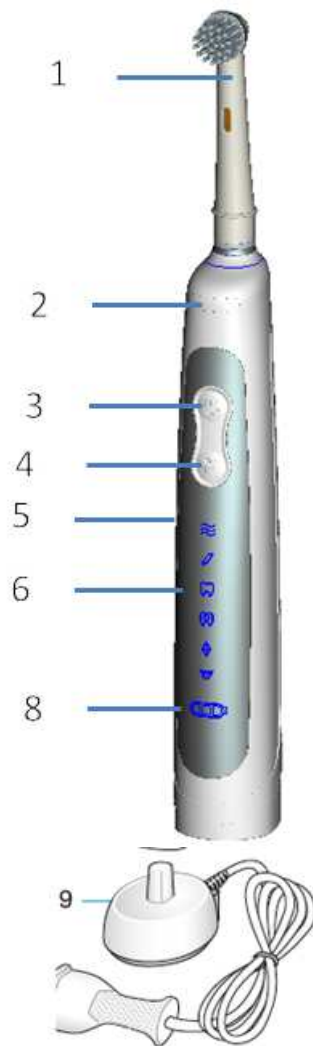

IMPORTANT SAFEGUARDS

When using electrical products, especially when children are present, basic safety precautions should always be followed, including the following:

READ ALL INSTRUCTIONS BEFORE USING

DANGER– To reduce the risk of electrocution:

1. Do not use while bathing.
2. Do not place or store product where it can fall or be pulled into a tub or sink.
3. Do not place in or drop into water or other liquid.
4. Do not reach for a product that has fallen into water. Unplug immediately.

WARNING– To reduce the risk of burns, electrocution, fire, or injury to persons.

1. Close supervision is necessary when this product is used by, on, or near children or invalids.
 2. Never operate this product if it has a damaged cord or plug, if it is not working properly, if it has been dropped or damaged, or dropped into water. Return the product to a service center for examination and repair.
 3. Keep the cord away from heated surfaces.
 4. Never use while sleeping or drowsy.
 5. Never drop or insert any object into any opening or hose.
 6. Do not use outdoors or operate where aerosol (spray) products are being used or where oxygen is being administered.
 7. For use only with ZD006C050100US charger.
- Usage by children under age 3 is not recommended. Tooth- brushes can be used by children and persons with reduced physical, sensory or mental capabilities or lack of experience and knowledge, if they have been given supervision or in- struction concerning use of the appliance in a safe way and understand the hazards involved.
 - Cleaning and maintenance shall not be performed by children.
 - Children shall not play with the appliance.
 - Use this product only for its intended use as described in this manual. Do not use attach- ments which are not recom- mended by the manufacturer.
 - Do not open and disassemble device. For battery recycling please dispose whole device according to local environmental regulations. Opening the handle will destroy the appliance and invalidate the warranty.
 - When unplugging, always hold the power plug instead of the cord. Do not touch the power plug with wet hands. This can cause an electric shock.
 - If you are undergoing treatment for any oral care condition, consult your dental professional prior to use.

- This toothbrush is a personal care device and is not intended for use on multiple patients in a dental practice or institution.
- Replace brush head every 3 months or sooner if brush (head) becomes worn.
- Your charging travel case is provided with a special cord set (smart plug), which has an integrated Safety Extra Low Voltage power supply. Do not exchange or tamper with any part of it, otherwise there is risk of an electric shock. Only use the special cord set provided with your appliance.

SAVE THESE INSTRUCTIONS

For Household Use only.

This appliance has a polarized plug (one blade is wider than the other). As a safety feature, this plug will fit in a polarized outlet only one way. If the plug does not fit fully in the outlet, reverse the plug. If it still does not fit, contact a qualified electrician. Do not attempt to defeat this safety feature.

Important Information

- Your Oral-B toothbrush can be used with your smartphone (find details under «Connecting your toothbrush to your Smartphone»).
- To avoid electromagnetic interference and/or compatibility conflicts, deactivate the radio transmission of your toothbrush handle (5) before using it in restricted surroundings, such as aircrafts or specially marked areas in hospitals.
- Deactivate radio transmission by simultaneously pressing the on/off (3) and mode button (4) for 2 seconds until the radio transmission display (7) goes off. Follow the same procedure to reactivate transmission again.
- Persons with pacemakers should always keep the toothbrush more than (15 centimeters) from the pacemaker while turned on. Anytime you suspect interference is taking place, deactivate the radio transmission of your handle.

Description

- 1 Brush head
- 2 Smart Ring
- 3 On/off button
- 4 Brushing mode button
- 5 Handle
- 6 Brushing mode display
- 7 Radio transmission display (with *Bluetooth*® wireless technology)
- 8 Charge level display
- 9 Charger

Accessories (depending on model):

- 12 Charging travel case
- 12a Charge indicator light
- 12b USB port
- 12c Smart plug port
- 12d Inner lid (with smartphone holder)
- 12e Removable inlay
- 13 Smart plug
- 15 Travel case

Note: Content may vary based on the model purchased.

Specifications

For voltage specifications refer to the bottom of the charging unit.

120 V ~

60 Hz

1.4 W

Toothbrush:

Battery: 3.7V, 650mAh Li-ion

Travel case Adapter parameter:

Input: 100 – 240 V ~ 50/60Hz 0.3A

Output: 5.0 VDC, 1.0A

Charging and Operating

Your toothbrush has a waterproof handle, is electrically safe and designed for use in the bathroom.

- You may use your toothbrush right away or charge it briefly by placing it on the plugged-in charger (9).

Note: In case the battery is empty (no lights illuminated on charge level display (8) while charging or no reaction when pressing the on/off button (3)), charge at least for 30 minutes.

- The charge level is indicated on the charge level display (8). Flashing lights indicate that the battery is charging

(picture 1); once it is fully charged, the lights turn off. A full charge takes about

12 hours and enables up to 12 days of regular brushing (twice a day, 2 minutes). Note: At a very low charge level, the lights might not flash immediately; it can take up to 30 minutes.

- If the battery is running low, a red light is flashing on the charge level display and the motor is reducing its speed. Once the battery is empty, the motor will stop; it will need at least a 30-minute charge for one usage.
- You can always store the handle on the plugged-in charging unit to maintain it at full power; a battery overcharge is prevented by device.

Note: Store handle at room temperature for optimal battery maintenance. Caution: Do not expose handle to temperatures higher than 50 °C.

Using your toothbrush

Brushing technique

Wet brush head and apply any kind of tooth-paste. To avoid splashing, guide the brush head to your teeth before switching on the handle (picture 2). When brushing your teeth with one of the Oral-B oscillating-rotating brush heads, guide the brush head slowly from tooth to tooth, spending a few seconds on each tooth surface (picture 3). With any brush head start brushing the outsides, then the insides and finally the chewing surfaces. Brush all four quadrants of your mouth equally. You may also consult your dentist or dental hygienist about the right technique for you.

In the first days of using any electric tooth-brush, your gums may bleed slightly.

In general, bleeding should stop after a few days. Should it persist after 2 weeks, please consult your dentist or dental hygienist.

Timer

You can choose between «Professional» or «2-Minute» timer.

The «2-Minute» timer signals with a long stuttering sound and a flashing light of the Smart Ring (2) that the professionally recommended 2-minute brushing time has been reached.

The «Professional» timer signals with a short stuttering sound and a flashing light of the Smart Ring at 30-seconds intervals to move to the next quadrant of your mouth (picture

3). A long stuttering sound and a flashing light indicate the end of the professionally recommended 2-minute brushing time.

The timer memorizes the elapsed brushing time, even when the handle is briefly switched off during brushing. The timer resets if pausing longer than 30 seconds, briefly pressing the mode button (4) during pause or placing the handle on the plugged-in charger.

Note: During the use of special Oral-B™ App features, the visual timer light may be deactivated.

Timer setup:

Your toothbrush comes with the «Professional» timer activated. To change this, press and hold the mode button (4) for 2 seconds. Toggle between timer selection by pressing the on/off button (3). Confirm selection by pressing the mode button.

- 2 LED's illuminated indicate «2-Minute» timer
- 4 LED's illuminated indicate «Professional» timer

Charging Travel Case

- To charge your handle (5) place it on the pin in the charging travel case (12) and connect it to an electric outlet, using the extra smart plug (13) provided.
- The flashing light (12a) of the charging travel case indicates that the handle is charging. Once the handle is fully charged the light turns off. A full charge can take up to 12 hours (picture C1).
Note: You may use the USB port (12b) to charge an electric device while the charging travel case is plugged in. The handle can only be charged with the smart plug (13) (12c) not via USB port.
- The inner lid of the travel case has a built-in smartphone holder (12d), which can hold your smartphone while using (picture C2). Before use, make sure your phone fits the stand and keeps stable.
- The removable inlay (picture C3) (12e) of the travel case is dishwasher-safe (picture 5). The outer case should be cleaned with a damp cloth only. Make

Cleaning



DANGER! Risk of electric shock!

- Before cleaning the battery charger, pull the mains plug out from the mains socket.
- Do not immerse the toothbrush, battery charger, Smart plug and Charging Travel Case in water!
The battery charger and Smart plug must be completely dry before you reconnect it to the wall socket.
- To ensure the hygienic functionality of the toothbrush heads they must be rinsed thoroughly after every use.
- Remove the toothbrush head once per week and clean it in hot water.
- Rinse the toothbrush as well and wipe it dry.
- Wipe the battery charger and Charging Travel Case with a damp cloth if necessary, and rub it dry.

Storage

Keep the appliance away from children and store it in a upright position in a clean and dry place.

Disposal Instructions



Waste electrical devices marked with this sign must not be disposed of with your household waste, but – according to the EU directive on Waste Electric And Electronic Equipment of 24th March 2005 – are to be collected separately. Therefore, please return this device at the end of its life cycle to special collection points for disposal or your local dealer.

Your Window Cleaner is packed in a retail box. Such boxes are recyclable waste, i.e. they are reusable or recyclable.

The product sends out the data of the toothbrush through the Bluetooth 4.0 protocol, and lists the corresponding usage on the LCD display.

Battery disposal



Used batteries do not belong in the domestic garbage. You are legally obligated to dispose of the batteries. Dispose of them through your electrical dealer or your local recycling centre. Only dispose of fully discharged batteries. The purpose of this obligation is to ensure that batteries are disposed of in a non-polluting manner.

When you open the housing and dispose of the batteries, the appliance will be irreparably damaged!

- Disassemble the window cleaner.
- Remove the screws and pull the two halves of the housing apart
- Remove the batteries from the housing.
- Use a hemp snipper to cut the cable that leads to the blue battery.
- Remove the battery and dispose of it in an environmentally friendly manner.



Electric toothbrush Bluetooth clock

Model: SP-1231

Instruction manual

Before operating this toothbrush, please read these instructions and save this manual for future reference.

IMPORTANT

- Periodically check the cord for damage. If cord is damaged, take the charging unit to an Oral-B Service Centre. A damaged or non-functioning unit should no longer be used. Do not modify or repair the product. This may cause fire, electric shock or injury.
- This product is not intended for use by children under age three. Children from 3 to 14 years and persons with reduced physical, sensory or mental capabilities or lack of experience and knowledge can use the toothbrush, if they have been given supervision or instruction concerning use of the appliance in a safe way and understand the hazards involved.
- Cleaning and maintenance shall not be performed by children.
- Children shall not play with the appliance.
- Use this product only for its intended use as described in this manual. Do not use attachments which are not recommended by the manufacturer.
- Replace brush (head) every 3 months or sooner if brush head becomes loose due to damage.

SmartGuide batteries

- Batteries may leak if empty or not used for a long time. Avoid skin contact whilst handling leaking batteries.
- Keep away from children. Do not swallow. If swallowed, seek medical advice at once.
 - Remove fully discharged batteries immediately. Replace all batteries at the same time. Do not mix used and new batteries, different brands or types. Do not disassemble, recharge or dispose of in fire.

The SmartGuide (i) comes with a demonstration mode. Deactivate this mode by removing the compartment cover in the back (picture A, page 3) and push the «set» or «h/min» button. A flashing «12:00» indicates that you can now adjust the clock time.
Note: If the SmartGuide display is blank before first use (no active demonstration mode/no batteries inserted) the batteries will need to be replaced/ inserted before continuing. Batteries are supplied. And push the «set» or «h/min» button.

Use Consumer grade, non-rechargeable carbon-zinc or alkaline batteries.

Electric toothbrush Bluetooth clock

Battery: 3.0VDC (2XAAA batteries)

Protection Class: III

Operating temperature: <45°



Environment friendly disposal

You can help protect the environment!

Please remember to respect the local regulations: hand in the non-working electrical equipments to an appropriate waste disposal centre. The packaging material is recyclable. Dispose of the packaging in an environmentally friendly manner and make it available for the recyclable material collection-service.

The product receives data from the toothbrush via the Bluetooth 4.0 protocol and lists the corresponding usage on the LCD display.

Manufacturer :ZHONGSHAN SUNPOWER SMART HOME ELECTRICAL COMPANY LIMITED

Address : QiChong Community, ShaLang, West District, 528400 Zhongshan, People's Republic of China

Warning: Changes or modifications to this unit not expressly approved by the party responsible for compliance could void the user's authority to operate the equipment.

This device complies with Part 15 of the FCC Rules. Operation is subject to the following two conditions : (1) this device may not cause harmful interference, and (2) this device must accept any interference received, including interference that may cause undesired operation.

Note: This equipment has been tested and found to comply with the limits for a Class B digital device, pursuant to part 15 of the FCC Rules. These limits are designed to provide reasonable protection against harmful interference in a residential installation. This equipment generates, uses and can radiate radio frequency energy and, if not installed and used in accordance with the instructions, may cause harmful interference to radio communications. However, there is no guarantee that interference will not occur in a particular installation. If this equipment does cause harmful interference to radio or television reception, which can be determined by turning the equipment off and on, the user is encouraged to try to correct the interference by one or more of the following measures:

- Reorient or relocate the receiving antenna.
- Increase the separation between the equipment and receiver.
- Connect the equipment into an outlet on a circuit different from that to which the receiver is connected.

—Consult the dealer or an experienced radio/TV technician for help.