

AIRSHIP

Obstacle Avoidance Drone



User's Guide for Model DR350B v2354-01



Warnings & Precautions

Important Safety Instructions

- Read and follow all instructions.
- Keep these instructions for future reference.
- Heed all Warnings.
- Intended for children ages 14 and higher. Adult supervision is required.
- Only use attachments/accessories specified by the manufacturer.
- Before flying, always check the body, rotors, and battery for any damage or obstructions.
- Battery should be free from cracks or swelling.
- Keep the rotors clear of any obstructions and body parts to avoid potential damage and injury.
- Manufacturer and dealer assume no liability for accidental damages from improper use or installation of parts, or from damage incurred from worn or broken parts.
- Pilots are responsible for their actions and any damage caused from improper use.
- Pilots should keep the craft in sight at all times during flight. If you lose sight of the craft at any time, power down and cease flight immediately.
- Only fly in large, open areas that are free from obstacles or potential hazards, such as trees, power lines, ceiling fans, and the like.
- Flying over bodies of water is not recommended.

- Flying at night is not recommended.
- Never try to retrieve the craft from areas you cannot safely reach, such as rooftops or trees.
- Never leave the craft unattended while it is powered on or while the battery is charging.

FCC Warnings

Warning: Changes or modifications to this unit not expressly approved by the party responsible for compliance could void the user's authority to operate the equipment.

NOTE: This equipment has been tested and found to comply with the limits for a Class B digital device, pursuant to Part 15 of the FCC Rules. These limits are designed to provide reasonable protection against harmful interference in a residential installation. This equipment generates, uses, and can radiate radio frequency energy and, if not installed and used in accordance with the instructions, may cause harmful interference to radio communications. However, there is no guarantee that interference will not occur in a particular installation. If this equipment does cause harmful interference to radio or television reception, which can be determined by turning the equipment off and on, the user is encouraged to try to correct the interference by one or more of the following measures:

Warnings & Precautions

- Reorient or relocate the receiving antenna.
- Increase the separation between the equipment and receiver.
- Connect the equipment into an outlet on a circuit different from that to which the receiver is connected.
- Consult the dealer or an experienced radio/TV technician for help.

This device complies with Part 15 of the FCC Rules.

Operation is subject to the following two conditions:

1. This device may not cause harmful interference, and
2. This device must accept any interference received, including interference that may cause undesired operation.

Additional Warnings & Precautions

- **WARNING:** To reduce the risk of fire or electric shock, do not expose this apparatus to rain, moisture, dripping, or splashing.
- **CAUTION:** Use of controls or adjustments or performance of procedures other than those specified may result in personal injury.
- **WARNING:** Changes or modifications to this unit not expressly approved by the party responsible for compliance could void the user's authority to operate the equipment.
- **CAUTION:** Danger of explosion if battery is

incorrectly replaced. Replace only with the same or equivalent type.

- Lithium batteries, like all rechargeable batteries, are recyclable and should be recycled or disposed of according to state and local guidelines. They should never be disposed of in normal household waste, and they should never be incinerated, as they might explode. Contact your local government for disposal or recycling practices in your area.
- **WARNING:** Shock hazard - Do Not Open.
- Battery shall not be exposed to excessive heat such as sunshine, fire, or the like.
- **WARNING: DO NOT INGEST BATTERY, CHEMICAL BURN HAZARD.** If you think batteries might have been swallowed or placed inside any part of the body, seek immediate medical attention.
- If the coin/button cell battery supplied with this product is swallowed, it can cause severe internal burns in just 2 hours and can lead to death.
- Batteries should be recycled or disposed of as per state and local guidelines.
- Only use the included power supply/power charger or a UL/ETL certified power supply of the same power output specifications.

Table of Contents

Airship Drone

Features–5

Includes–5

Overview

Features & Layout–6

Charging the Battery

Battery Charging Procedure–8

Flying

Step 1–10

Step 2–11

Remote–12

Gyroscope Calibration–13

Tips for Safe Operation–13

Troubleshooting

Guide–14

Customer Support

Contact Information–15

International Support–15

Warranty–15

Airship Drone

Features

- Built-in obstacle avoidance sensors
- LED lights
- Built-in, rechargeable lithium-polymer battery power
- Remote control distance: up to 16 ft.
- Operating time: 5-6 minutes
- Charge time: 60-80 minutes

Includes

- Remote control with built-in CR2032 button cell battery
- USB cable for battery recharge
- User's guide

Overview

Features & Layout

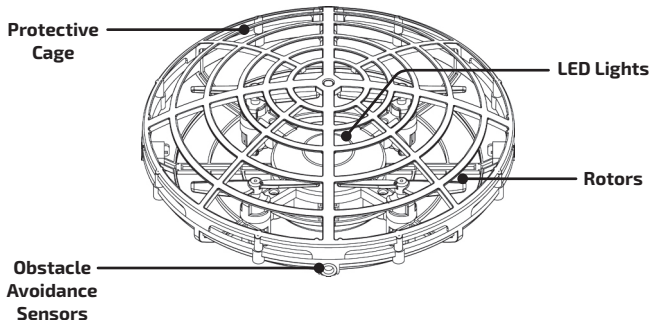

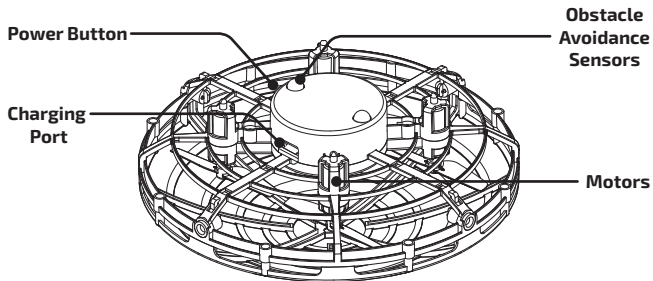

Charging the Battery

Battery Charging Procedure

The craft's battery must be charged before it can be flown. **Before charging, be sure the craft is powered OFF to avoid the risk of injury or damage.**

Connect the charging cable (included) to the USB port of a powered ON computer or USB power adapter (not included), then connect the charging plug to the unit. **Be sure to correctly match the plug to the charging port or damage may occur.** Charge fully before use for maximum performance and flight time. The charging time is approximately 60-80 minutes. The flying time is approximately 5-6 minutes.

While charging, the USB plug will display a red light.

When charging is complete, the light will turn OFF.

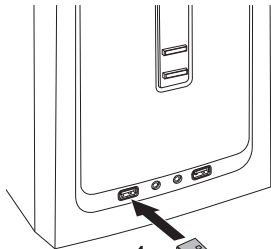

1

REMINDER: Do not charge overnight. Do not leave unattended while charging.

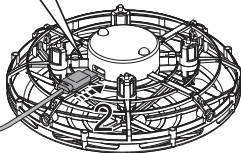
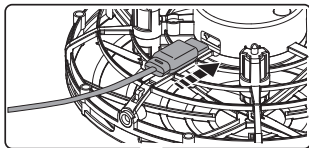

Flying

Step 1

When the drone powers ON, it automatically enters Rotation Mode, indicated by a green light. In this mode, the craft will spin around its axis as it flies. To fly in Non-Rotation Mode, press the power button again after powering on. The indicator light will turn blue, and the craft will fly without spinning.

It is necessary for the craft's gyroscopes to calibrate before flying. Power ON the craft and place it on a flat surface. The navigation lights will blink as the gyro sensors align. When the lights turn solid, the craft is ready to fly. Lightly toss it in the air, and it will begin to fly.

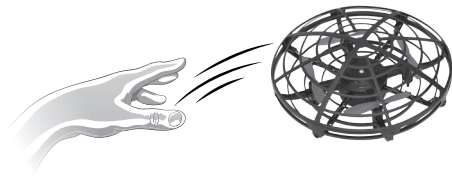

Step 2

While the craft is in the air, it will spin in a circle and hover automatically. You can control it just by "pushing" with your hand. The sensors on the drone will detect your hand, and it will move in the opposite direction.



Flying

Remote

You can use the remote to make the drone take off and land. Be sure the drone is powered on and calibrated (see Step 1), then press the button on the remote to take off.

Use the remote to land the drone automatically. Do not grab it out of the air, for risk of injury or damage.

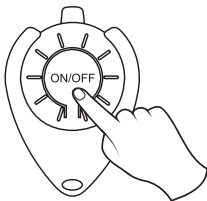

Gyroscope Calibration

Take the drone in your hand and shake it back and forth a few times to put it into Gyroscope Calibration Mode. When the LED lights start to blink, the sensors are ready to be calibrated. Place the drone on a flat level surface during the calibration period. When the LED lights have turned solid, the calibration is complete.

Tips for Safe Operation

- It is recommended to only fly indoors. Do not fly this unit outside.
- Avoid areas with obstacles like ceiling fans, delicate furniture, etc.
- Try to avoid walls and ceilings, as the craft may be drawn towards them if closer than 2-3 feet.
- If you get into trouble, use the remote to land the craft and power down.
- If anything obstructs the rotors, wait for them to stop spinning. Power off the craft and safely clear the obstruction, then check for possible damage before flying again.

Troubleshooting

Guide

PROBLEM	POSSIBLE CAUSES	SOLUTION
Craft flies erratically.	<ul style="list-style-type: none">• Gyroscopes may be misaligned.	<ul style="list-style-type: none">• Recalibrate the gyroscopes (see pg. 13).
Craft suffers from mechanical trouble.	<ul style="list-style-type: none">• Obstruction in rotors or protective frame.	<ul style="list-style-type: none">• Safely clear the obstruction.
LED lights ON but craft does not fly.	<ul style="list-style-type: none">• Low battery power.	<ul style="list-style-type: none">• Recharge the battery.

Customer Support

Contact Information

Website: **www.gpx.com**

Email Support: **prodinfo@dpiinc.com**

Email Parts: **partsinfo@dpiinc.com**

Phone Support: **1-888-999-4215**

Warranty

See included 30 Day Warranty for warranty information. Warranty and the most up-to-date version of this User's Guide can also be found at: **www.gpx.com**

International Support

To download this User's Guide in English, Spanish, and French, or to get answers to frequently asked questions, visit the support section at: **www.gpx.com**

Para descargar este Manual del Usuario en inglés, español y francés, o para obtener respuestas a preguntas frecuentes, visite la sección de apoyo en: **www.gpx.com**

Pour télécharger ce guide de l'utilisateur en anglais, espagnol ou français, ou pour obtenir des réponses à des questions fréquemment posées, consultez la rubrique d'assistance sur: **www.gpx.com**



***Protect for Today
Sustain for Tomorrow***

Copyright © 2019 Digital Products International (DPI, Inc.)

All other trademarks appearing herein are the property of their respective owners.

Specifications are subject to change without notice.