

# User Guide

---

## M08F

Portable printer

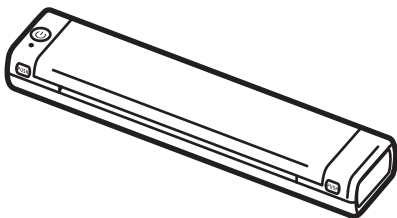

**HVIN: M08FT2**

**English**

# 1. Product Introduction

## 1.1 Packing List

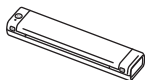

Printer  
×1



Quick Start Guide  
×1



Velvet Pouch  
×1



Type-C Cable  
×1



Single-sided Thermal  
Paper- 10 sheets×1

## 1.2 Printer Parts Instruction

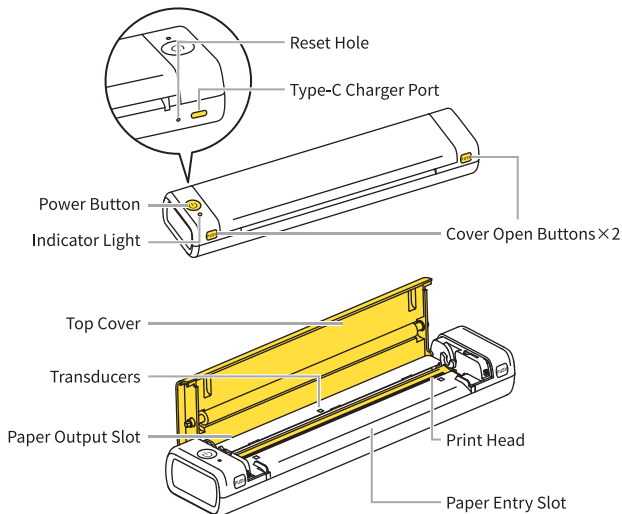

## 2. Getting Started

### 2.1 Downloading the App

**Method 1:** Search for the "Phomemo" app on App Store® or Google Play™ for download and installation.



Phomemo

**Method 2:** Scan the QR code to download the app. You can scan the code using your cell phone's camera, the built-in QR code scanning feature of your browser, or a dedicated QR code scanning app.



ⓘ As the Safari browser on Apple devices does not support direct QR code scanning, please use your device's built-in QR code scanner instead.

## 2.2 Paper Installation Guide

- 01** Long press the Power Button for 3 seconds until the Indicator Light is green to power up the printer.

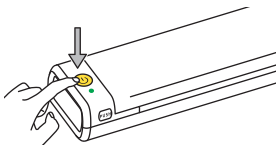

- 02** Simultaneously press the Cover Open Buttons with both hands.

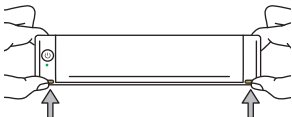

- 03** Open the Top Cover.

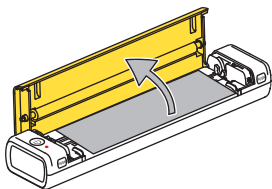

- 04** Remove the protective paper.

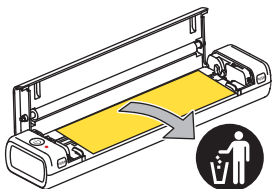

❗ If your printer version does not include the disposable protective paper, please skip this step.

- 05** Put the Top Cover back down, and press down on both of its ends at the same time until you hear a click, indicating the cover is securely closed.

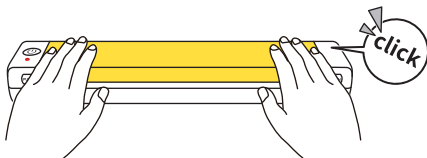

- 06** Insert the paper with the text side up into the Paper Entry Slot until the printer automatically pulls it in and the Indicator Light is lit green, signaling paper insertion is complete.

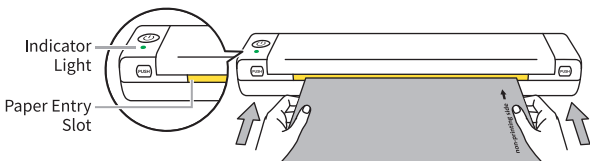

❗ The printed content will not appear on the side that reads "non-printing side."

## 2.3 User Guide: Printing via Mobile App

01 Open the "Phomemo" app.



02 Grant permissions.

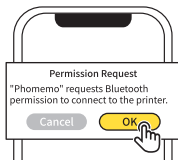

03 Wait for the printer to be searched.

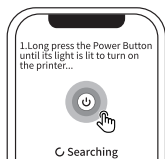

04 Tap [Connect Now].

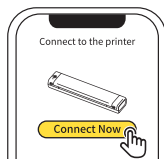

05 The printer is connected.  
Tap [Paper loaded, starting printing].

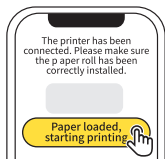

06 Edit your first image, and tap [ ] after you finish editing.



07 Confirm the preview of the image, and tap [Print].

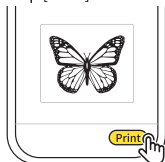

08 Printing is completed.



09 Retrieve the printout.

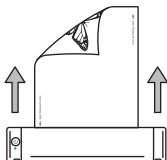

! The software interface is for illustration purposes only. Please refer to the actual operation page for accurate information.

### 3. Cleaning and Maintenance

❗ Disconnect the printer from the power supply before starting any cleaning or maintenance.

If you encounter issues such as blank lines, blurry print, or missing words, it may be caused by dirt on the Print Head. Please follow these steps:

- 01** If you have just finished printing, wait for at least 30 minutes for the Print Head to cool down completely.
- 02** Use a cotton swab dipped in alcohol or a dry alcohol-soaked cotton ball to gently wipe the Rubber Roller and the Print Head left and right 5 times each, removing dust and stains from the surfaces.
- 03** Wait 5-10 minutes for the alcohol to evaporate completely before closing the Top Cover and completing the cleaning process. You may now continue using the printer.

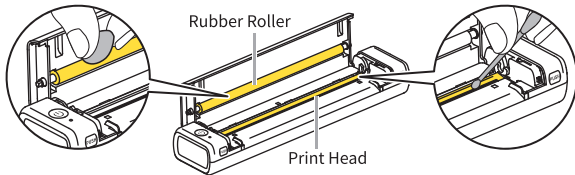







**Print Head Warning:** HOT component! Touching it when it is hot can cause burns to your fingers. Please wait for at least 30 minutes after turning off the power before touching it.

## 5. Additional Instructions

### 5.1 Button Instructions

Button Type	Operation	Function
 Power Button	Long press for 3s	Power on/off
	Double press when printer is on	Print a self-test page

### 5.2 Indicator Light Instructions

Status	Meaning	Advised Action
 Solid Green Light	Functioning/Fully charged	/
 Flashing Green Light	Charging while printer is on	/
 Solid Red Light	No paper installed	Install paper
	Printer overheated	Pause printing for 5-10 min
	Top Cover open	Close Top Cover
 Flashing Red Light	Low battery	Charge battery for 1h(or at least 20 min for quick usage)
 No light after long pressing Power Button for 3s	Battery depleted	Charge for 4h
 Alternately Flashing Red and Green Light	Charging while printer is off	/

## 4. Charging Instructions

1. Please prepare your own power adapter (DC 5V/2A) with a Type-A port.
2. Insert the Type-C end (flat end) of the USB cable into M08F's Type-C Charger Port and plug the Type-A end (wide end) into the Type-A port of the power adapter.
3. After connecting the printer to an outlet using the power adapter, please check the status of the Indicator Light: a light flashing alternately between red and green indicates that the printer is off, while a flashing green light signals that the printer is on.
4. To ensure quick usage, please charge the printer for at least 20 minutes. For a complete charge, wait for 4 hours or until the Indicator Light is solid green.
5. As the printer may heat up during charging, avoid placing it on materials such as cotton or linen.
6. Once the battery is fully charged, please unplug the charger promptly.

⚠ Avoid using the printer while charging. Using the printer while charging may lead to reduced charging speed, compromised print quality, and shortened battery life.

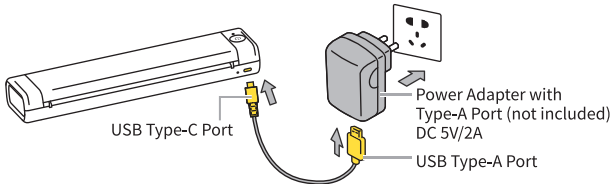



## 5.3 Permission Description

### For iOS users

1. The app requires access to the Internet.

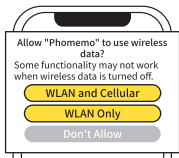

2. The app requires Bluetooth permission.

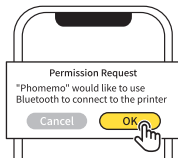

### For Android users

1. The app requires Bluetooth permission.

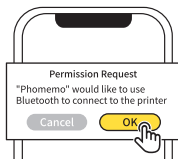

2. The app requires permission to search for nearby Bluetooth devices.



❗ For Android 12 and above, the app requires permission to search for nearby Bluetooth devices; for systems below Android 12, the app requires GPS permission in order to search for nearby Bluetooth devices.

3. Bluetooth Pairing Request.

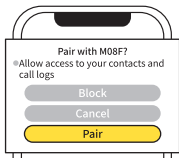

❗ You can simply tap "Pair" without checking "Allow access to your contacts and call history."

## 6. More Connection Methods

### 6.1 Connecting via QR Code

01 Open the "Phomemo" app.



02 Tap [Menu] at the top right corner.

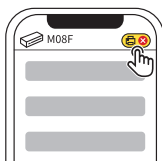

03 Tap [Scan QR Code].



04 Scan the QR code on the printer.

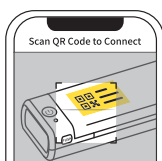

! Scan the QR code on the Top Cover of the printer for a fast connection with the printer.

05 Device connected.

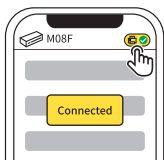

### 6.2 Connecting via Bluetooth

01 Open the "Phomemo" app.



02 Tap [Menu] at the top right corner.



03 Go to Bluetooth Connections and search for the printer.



04 Select your printer.

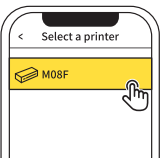

! Turn on Bluetooth permission to quickly find and connect to the printer.

05 Device connected.

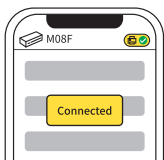

## 7. Information to User

Warning: Operation of this device in residential environments may cause radio interference.

### 7.1 FCC WARNING

This device complies with part 15 of the FCC Rules. Operation is subject to the following two conditions: (1) this device may not cause harmful interference, and (2) this device must accept any interference received, including interference that may cause undesired operation.

Any changes or modifications not expressly approved by the party responsible for compliance could void the user's authority to operate the equipment.

Note: This equipment has been tested and found to comply with the limits for a Class A digital device, pursuant to part 15 of the FCC Rules. These limits are designed to provide reasonable protection against harmful interference when the equipment is operated in a commercial environment. This equipment generates, uses, and can radiate radio frequency energy and, if not installed and used in accordance with the instruction manual, may cause harmful interference to radio communications. Operation of this equipment in a residential area is likely to cause harmful interference in which case the user will be required to correct the interference at his own expense. The device has been evaluated to meet general RF exposure statement.

The device can be used in portable exposure condition without restriction.

## 7.2 ISED NOTICE (Canada)

- English:

This device contains licence-exempt transmitter(s)/receiver(s) that comply with Innovation, Science and Economic Development Canada's licence-exempt RSS(s). Operation is subject to the following two conditions:

- (1) This device may not cause interference.
- (2) This device must accept any interference, including interference that may cause undesired operation of the device.

ISED RF exposure statement:

The device has been evaluated to meet general ISED RF exposure requirement. The device can be used in portable exposure condition without restriction.

- French:

L'émetteur/récepteur exempt de licence contenu dans le présent appareil est conforme aux CNR d'Innovation, Sciences et Développement économique Canada applicables aux appareils radio exempts de licence. L'exploitation est autorisée aux deux conditions suivantes :

- 1) L'appareil ne doit pas produire de brouillage;
- 2) L'appareil doit accepter tout brouillage radioélectrique subi, même si le brouillage est susceptible d'en compromettre le fonctionnement

ISED Déclaration d'exposition aux RF:

L'appareil a été évalué pour répondre aux exigences générales d'exposition aux RF d'ISED. L'appareil peut être utilisé dans des conditions d'exposition portable sans restriction.

## 7.3 BATTERY WARNING

- 1, Disposal of a battery into fire or a hot oven, or mechanically crushing or cutting of a battery, that can result in an explosion.
- 2, Leaving a battery in an extremely high temperature surrounding environment that can result in an explosion or the leakage of flammable liquid or gas
- 3, The battery subjected to extremely low air pressure that may result in an explosion or the leakage of flammable liquid or gas.
- 4, Replacement of a battery with an incorrect type that can result in an explosion or the leakage of flammable liquid or gas.
- 5, Battery cannot be subjected to extremely high or low temperatures, low air pressure at high altitude during use, storage or transportation.



## WARNING

Please pay attention to electrical safety. Do not disassemble, crush or puncture the battery. This product is not a toy.

Bitte achten Sie auf elektrische Sicherheit. Zerlegen, zerquetschen oder durchstechen Sie die Batterie nicht. Dieses Produkt ist kein Spielzeug.

Veuillez noter la sécurité électrique. Ne pas démonter, écraser ou piquer la batterie. Ce produit n'est pas un jouet.

Si prega di prestare attenzione alla sicurezza elettrica. Non smontare, schiacciare o perforare la batteria. Questo prodotto non è un giocattolo.

Preste atención a la seguridad del consumo de electricidad. No retire, triture o pinche la batería. Este producto no es un juguete.

Lütfen elektrik güvenliğine dikkat edin. Bateriyi dağıtma, yıkma veya yumruklama. Bu ürün oyuncak değil.

Var uppmärksam på elsäkerheten. Ta inte isär, krossa eller punktera batteriet. Den här produkten är ingen leksak.

Let op elektrische veiligheid. Demonteer, verpletter of prik de batterij niet. Dit product is geen speelgoed.

Proszę zwrócić uwagę na bezpieczeństwo elektryczne. Nie demontuj, nie miażdż ani nie przebijaj akumulatora. Ten produkt nie jest zabawką.

---

## Special Notes

---

The company assumes full responsibility for the revision and explanation of this manual, exercising utmost diligence to guarantee its accuracy. Nevertheless, please note that any technical improvements to the product may not be separately notified, and that the images of the product, accessories, software interfaces, etc. in this manual serve solely as illustrations and references. Due to product updates and upgrades, the actual product may vary slightly from the images. Please refer to the physical product for accurate representations.