

User Guide

A42

Label Maker

HVIN:A42

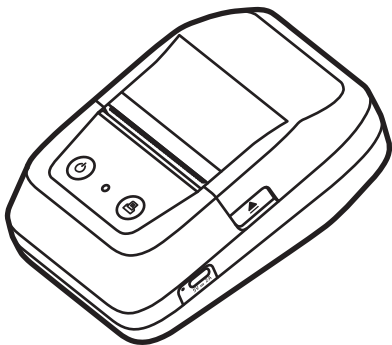

English

1. Product Introduction

1.1 Packing List



Printer
×1



Quick Start Guide
×1



Type-C Cable
×1



100-Pc 40*30mm
Paper Roll ×1

ⓘ The Paper Roll and Paper Roll Spindle have been installed in the printer. However, if you have purchased a bundled printer package, it does not include a 40*30mm-100pc Paper Roll.

1.2 Printer Parts Instruction

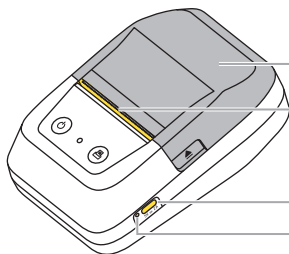

Top Cover

Paper Exit

Type-C Charger Port

Reset Hole

Manual Cutter

Paper Guides

Paper Compartment

Power Button

Indicator Light

Feed Button

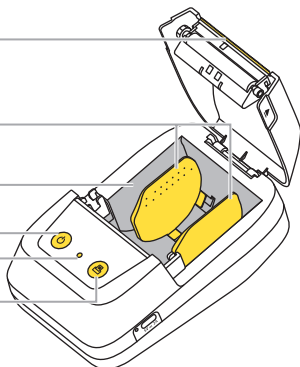

2. Getting Started

2.1 Downloading the App

Method 1: Search for the "Print Master" app on App Store® or Google Play™ for download and installation.



Print Master

Method 2: Scan the QR code to download the app. You can scan the code using your cell phone's camera, the built-in QR code scanning feature of your browser, or a dedicated QR code scanning app.



ⓘ As the Safari browser on Apple devices does not support direct QR code scanning, please use your device's built-in QR code scanner instead.

2.2 User Guide

- 01** Remove the protective film.



⚠ This step is required for first use.

- 02** To turn on the printer, long press the Power Button for 3 seconds until the Indicator Light turns green.

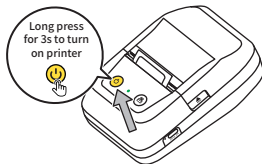

- 03** Open the "Print Master" app.



- 04** Grant permissions.

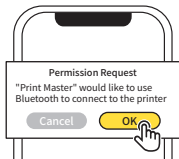

⚠ For more information about app permissions, see [6.2 Permission Description](#) in this guide.

- 05** Tap [Auto Connect].

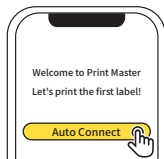

- 06** Searching for printer.



⚠ You can find instructions for manual connection on the [Home] page. For detailed instructions, see [6.1 Manual Connection](#) in this guide.

07 Connected.

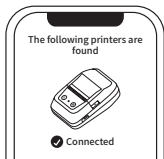

08 Edit your first label, and tap [Print] after you finish editing.



09 Printing is completed.



10 Tear off the label along the Paper Exit.



11 Remove the liner.

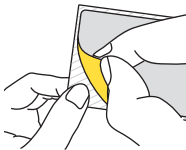

12 Attach the label to a dry, flat surface.



3. Replacing the Paper Roll

- 01** To turn on the printer, long press the Power Button for 3 seconds until the Indicator Light turns green.

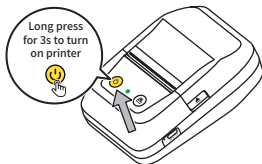

- 02** Open the "Print Master" app.



- 03** Tap [Scan].

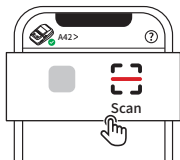

⚠ Please use [Scan] after connecting the printer to the app. Otherwise, scanning will fail and the editing page will not be displayed.

- 04** Take out the unused paper roll.

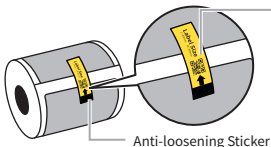

This QR code is for demonstration only. Please scan the actual QR code on your paper roll.

⚠ If you have purchased boxed paper rolls separately, or if there is no QR code on the paper roll, please see [4. Identifying Label Sizes](#) in this guide for instructions on how to quickly access the editing page.

05 Scan the QR code on the Anti-loosening Sticker of the paper roll.

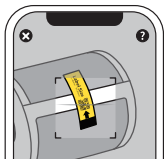

06 Paper roll size has been identified. Enter the editing page.

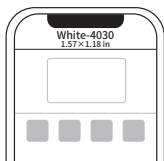

07 Hold both sides of the Top Cover and pull it upwards to open it, as illustrated.

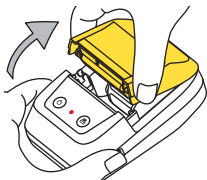

08 Remove the existing paper roll in the Paper Compartment.

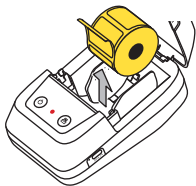

09 Remove the Anti-loosening Sticker from the paper roll.

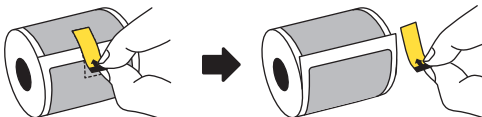

10 As shown in the figure, pull the Paper Guide to one side.

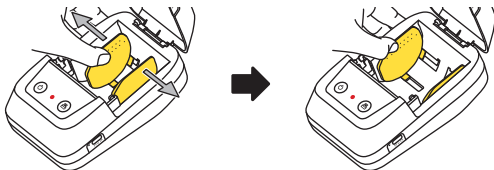

- 11** Place the paper roll with the printing side facing down in the Paper Compartment.

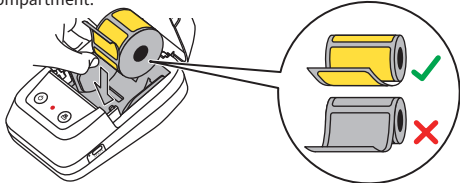

① Make sure the paper roll is placed in the right direction.

- 12** Release the Paper Guide, and the printer will automatically detect the size of the paper roll.

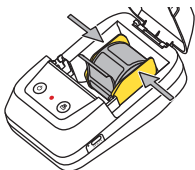

- 13** Extend the label paper out above the Paper Outlet and then close the Top Cover.

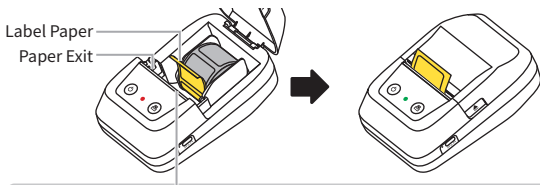

① The Label Paper faces the Power Button and is higher than the Paper Exit.

- 14** The Paper Exit will auto-calibrate the label and adjust the paper roll to the right position.

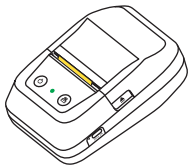

4. Identifying Label Sizes

4.1 Scanning the QR Code

01 Go to "Home" and tap [Scan].

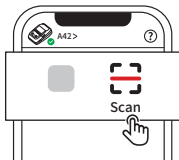

02 Aim the scanning frame at the QR code on the paper roll box.



03 Enter the editing page.

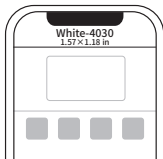

- ⚠ • Please connect the printer to the app before you scan the QR code. Otherwise, the app won't be able to identify the label size and redirect to the editing page.
- For instructions on manually connecting to the printer, see [6.1 Manual Connection](#) in this guide.

4.2 Finding Label Specifications

If there is no QR code on the paper roll box, please enter the label size manually in the app. You can identify the label size in the following ways:

- 01** Find label specifications on the information side of the paper roll box.



- 02** Click on [New Label] on the app homepage and select [Newly created by blank label].

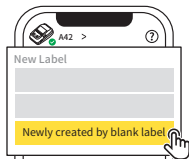

- 03** Input corresponding specifications.

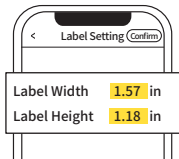

- 04** Enter the editing page.

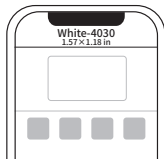

4.3 Measuring the Label

- 01** Measure the length and width of a single label with a ruler.

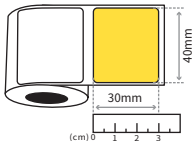

- 02** Click on [New Label] on the app homepage and select [Newly created by blank label].



- 03** Input corresponding specifications.

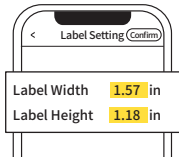

- 04** Enter the editing page.

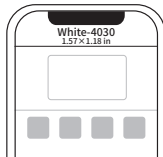

5. App User Guide

5.1 Manual Connection

- 01 Select your printer.



- 02 Click on the top left corner to connect to the printer

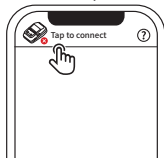

- 03 Searching for printer.



- 04 Connected.

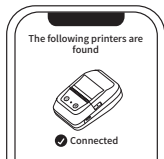

5.2 Permission Description

For iOS users

1. The app requires access to the Internet.

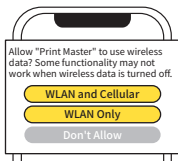

2. The app requires Bluetooth permission.

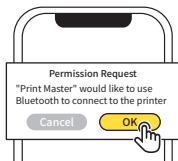

For Android users

1. The app requires Bluetooth permission.

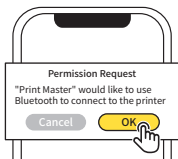

2. The app requires permission to search for nearby Bluetooth devices.



! For Android 12 and above, the app requires permission to search for nearby Bluetooth devices; for systems below Android 12, the app requires GPS permission in order to search for nearby Bluetooth devices.

3. Bluetooth Pairing Request.



! You can simply tap "Pair" without checking "Allow access to your contacts and call history."

6. Safety Instructions

6.1 Manual Cutter and Print Head Instructions

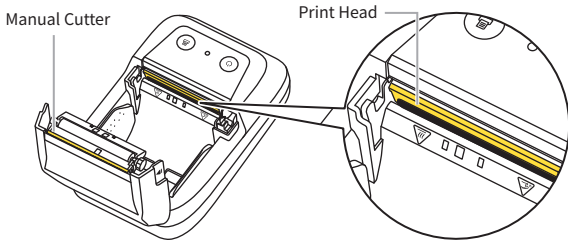

Warning: This cutter has sharp edges. Do not touch the edges of the cutter.



Warning: The component can be HOT! Touching it when it is hot can cause burns to your fingers. Before you touch the Print Head, please wait for at least 30 minutes after turning off the printer.

6.2 Charging Instructions

1. Please prepare your own power adapter (DC 5V/2A) with a Type-A port.
2. Insert the Type-C end (flat end) of the USB cable into A42's Type-C Port; insert the Type-A end (wide end) of the USB cable into the Type-A port of the power adapter.
3. Upon connecting the printer to an outlet using the power adapter, please check the status of the Indicator Light. A slow flashing green light when the printer is off or a fast flashing green light when the printer is on indicates that the printer is successfully charging.
4. When the battery is depleted, charge for 20 minutes for quick usage. For a full charge, please charge for 2-3 hours or until the Indicator Light turns solid green.
5. As the printer may heat up during charging, avoid placing it on materials such as cotton or linen. Once the battery is fully charged, please unplug the charger promptly.

⚠ Avoid using the printer while charging, as this may lead to reduced charging speed, compromised print quality, and shortened battery life.

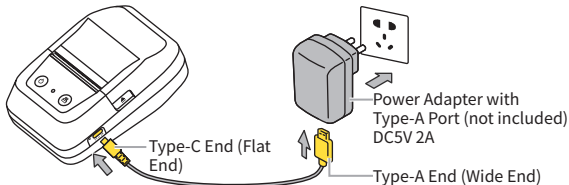

7. Cleaning and Maintenance

ⓘ Please make sure the printer is turned off before performing any cleaning or maintenance.

If you encounter issues such as blank lines, blurry print, or missing characters, it may be caused by dirt on the Print Head. Please follow these steps:

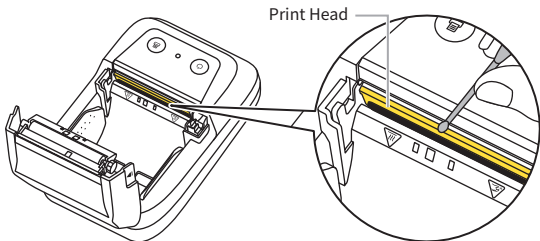

- 01** If you have just finished printing, wait for at least 30 minutes for the Print Head to cool down completely.
- 02** Use a cotton swab dipped in alcohol or a print head cleaning pen (purchased separately) to gently wipe the surface of the Print Head about 5 times to remove any dust and stains.
- 03** Wait 5-10 minutes for the alcohol to evaporate completely. Thus, the cleaning is done, and you can continue using the printer.



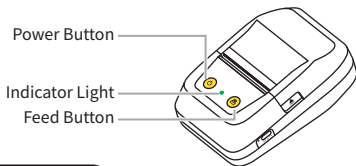



8. Button and Indicator Light Instructions



9.1 Button Instructions

Button Type	Operation	Function
 Power Button	Long press for 3s	Power on/off
	Double press when printer is on	Print a self-test page
	Click during paper feed	Pause paper feed
	Click during printing	Cancel printing
 Feed Button	Click when powered on	Paper feed positioning

9.2 Indicator Light Instructions

Status	Meaning	Advised Action
 Solid green Light	Functioning normally and fully charged	/
 Flashing green Light	Charging	/
 Solid Red Light	No paper roll detected/ Faulty	Reinstall paper roll
 Flashing Red Light	Low battery	Charge battery for 1h
 No light after long pressing Power Button for 3s	Battery depleted	Charge battery for 4h

① For instructions on reinstalling the paper roll, see [3. Replacing the Paper Roll](#) in this guide; for charging instructions, see [7.2 Charging Instructions](#) in this guide.

9. Information to User

9.1 FCC WARNING

1. This device complies with Part 15 of the FCC Rules. Operation is subject to the following two conditions:

- (1) This device may not cause harmful interference, and
- (2) This device must accept any interference received, including interference that may cause undesired operation.

2. Any Changes or modifications not expressly approved by the party responsible for compliance could void the user's authority to operate the equipment.

NOTE: This equipment has been tested and found to comply with the limits for a Class A digital device, pursuant to part 15 of the FCC Rules. These limits are designed to provide reasonable protection against harmful interference when the equipment is operated in a commercial environment. This equipment generates, uses, and can radiate radio frequency energy and, if not installed and used in accordance with the instruction manual, may cause harmful interference to radio communications. Operation of this equipment in a residential area is likely to cause harmful interference in which case the user will be required to correct the interference at his own expense.

FCC Radiation Exposure Statement

The device has been evaluated to meet general RF exposure requirement. The device can be used in portable exposure condition without restriction.

9.2 ISED NOTICE(Canada)

CAN ICES(A)/NMB(A)

- English:

This device contains licence-exempt transmitter(s)/receiver(s) that comply with Innovation, Science and Economic Development Canada's licence-exempt RSS(s). Operation is subject to the following two conditions:

- (1) This device may not cause interference.
- (2) This device must accept any interference, including interference that may cause undesired operation of the device.

- French:

L' émetteur/récepteur exempt de licence contenu dans le présent appareil est conforme aux CNR d' Innovation, Sciences et Développement économique Canada applicables aux appareils radio exempts de licence. L' exploitation est autorisée aux deux conditions suivantes:

- 1) L' appareil ne doit pas produire de brouillage;
- 2) L' appareil doit accepter tout brouillage radioélectrique subi, même si le brouillage est susceptible d' en compromettre le fonctionnement

IC RF exposure statement:

The device has been evaluated to meet general IC RF exposure requirement. The device can be used in portable exposure condition without restriction.

IC Déclaration d'exposition aux RF:

L'appareil a été évalué pour répondre aux exigences générales d'exposition aux RF d'IC. L'appareil peut être utilisé dans des conditions d'exposition portable sans restriction.

9.3 Trademarks



Bluetooth®

The Bluetooth®/MD word mark and logos are registered trademarks owned by Bluetooth SIG, Inc. and any use of such marks by Zhuhai Quin Technology Co., Ltd. is under license. Other trademarks and trade names are those of their respective owners.

Apple, the Apple logo, iPhone, iPad, iPod, and iPod touch are trademarks of Apple Inc., registered in the U.S. and other countries. App Store is a service mark of Apple Inc.

Android and Google Play are trademarks of Google Inc. Google and Google Logo are registered trademarks of Google Inc.



WARNING

Please pay attention to electrical safety. Do not disassemble, crush or puncture the battery. This product is not a toy.

Bitte achten Sie auf elektrische Sicherheit. Zerlegen, zerquetschen oder durchstechen Sie die Batterie nicht. Dieses Produkt ist kein Spielzeug.

Veuillez noter la sécurité électrique. Ne pas démonter, écraser ou piquer la batterie. Ce produit n'est pas un jouet.

Si prega di prestare attenzione alla sicurezza elettrica. Non smontare, schiacciare o perforare la batteria. Questo prodotto non è un giocattolo.

Preste atención a la seguridad del consumo de electricidad. No retire, triture o pinche la batería. Este producto no es un juguete.

Lütfen elektrik güvenliğine dikkat edin. Batiriyi dağıtma, yıkma veya yumruklama. Bu ürün oyuncak değil.

Var uppmärksam på elsäkerheten. Ta inte isär, krossa eller punktera batteriet. Den här produkten är ingen leksak.

Let op elektrische veiligheid. Demonteer, verpletter of prik de batterij niet. Dit product is geen speelgoed.

Proszę zwrócić uwagę na bezpieczeństwo elektryczne. Nie demontuj, nie miażdż ani nie przebijaj akumulatora. Ten produkt nie jest zabawką.

Special Notes

The company assumes full responsibility for the revision and explanation of this manual, exercising utmost diligence to guarantee its accuracy. Nevertheless, please note that any technical improvements to the product may not be separately notified, and that the images of the product, accessories, software interfaces, etc. in this manual serve solely as illustrations and references. Due to product updates and upgrades, the actual product may vary slightly from the images. Please refer to the physical product for accurate representations.