

User Manual

Product Parameter.

Product Name: BLUETOOTH SELFIE STICK
Product Mode: Phantom999
Remote-control distance: $\leq 10\text{M}$
Rated Input: DC5V/200mA
Battery Capacity: 50mAh
Maximum Extended Length: 900mm
Main Material: Aluminum Alloy, ABS
Stretching Friction Strength: 1KG-2.5KG
Enterprise Standards: Q/SSX 001-2017
Working Temperature: $-10^{\circ}\text{C}\sim+40^{\circ}\text{C}$
Supported System: Android/ IOS
Maximum weight: 1kg
Shooting modes: horizon/ vertical shooting supported, build-in tripod
Size: 31.5x190mm
Net Weight: 183g

Bluetooth Pairing

No need to download any software on our smart-phone , just turns on the Bluetooth function, search the selfie stick device to recognize "Phantom", and click to pair. If your phone's volume button has been set for shutter, and you can't use it properly, please download 360Camera or MeiTu Camera App etc., and set the volume button for camera shutter in APP Settings to take photo.

Power On

Press the power button for three seconds, the blue flash light twinkle and the selfie stick goes in to the pairing status. The blue light off after the device paired successfully. Open the phone camera, press the selfie stick camera button to take photos and the blue light will blink. Press the power button for three seconds, the blue flash light twinkle and the selfie stick goes in to the pairing status. The blue light off after the device paired successfully. Open the phone camera, press the selfie stick camera button to take photos and the blue light will blink.

Power Off

Press the power button for 5 seconds to shutdown. The selfie stick shuts off automatically after 60s latter if it was not being connected to the phone.

Sleeping Mode

If the device unused in 300s after being paired successfully, it turns into sleeping mode, press the button to wake up.

Take Photos

Press the selfie stick shutter button to take photo. Wake it up first if the device in sleeping mode.

Charging

Plug in the USB charge cable for charging and the red light on. The light goes off after fully charged. Some power bank with end-of-charge current design and be incompatible with our device sometimes, so we recommend charge the device via use the charger directly.

How to open and close clamp, switch horizon shooting to vertical shooting mode.

Step 1: Pull the clamp out from the top of Selfie Stick

Step 2: open the clamp outward as the above image shows

Step 3: The top cap pop open automatically when the clip fully open

Step 4: It's the horizon shooting mode when we open the clip, rotate the clip

90° counter-clock-wise switch to vertical shooting mode as the following instruction shows

Step 5: Pull down the clamp to close

Step 6: Press down the top cap to the home position.

Step 7: Press down the clamp into the selfie stick body shell.

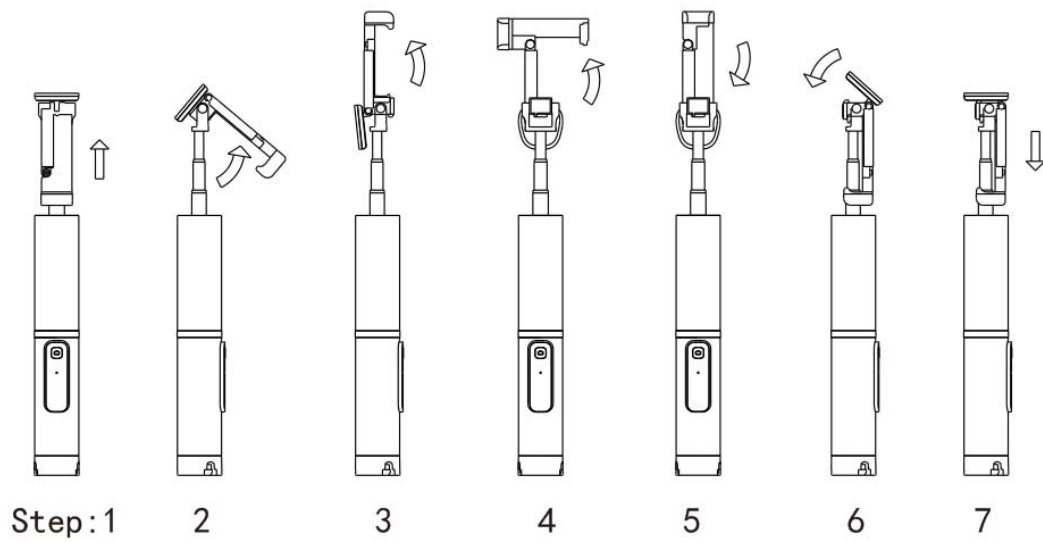

How To Use Built-in Tripod

Built-in telescopic tripod, pull out from the selfie stick bottom and extend fully as the following steps, fixed in groove.

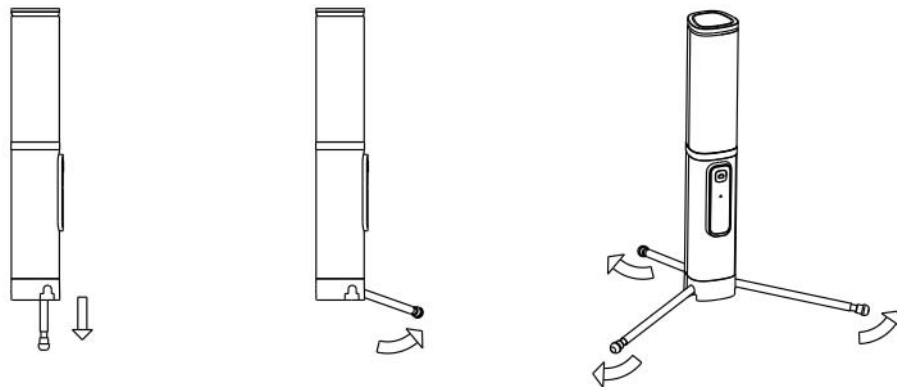

How To Take out the Bluetooth Remote Control

Take out the Bluetooth Remote Control as the instruction shows.

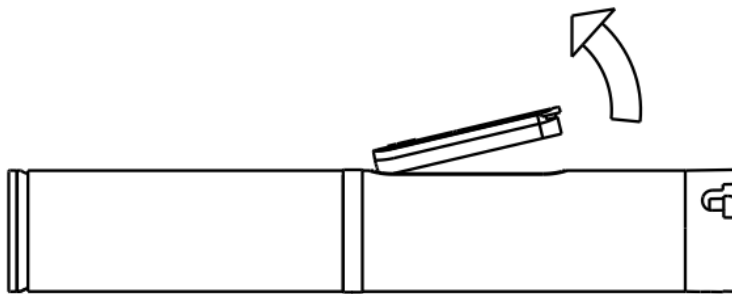

Accessories:

Selfie Stick *1 User Guide*1 USB Cable *1

Warranty

1. Please keep your service card safe for maintenance certificate.
2. Warranty period is 1 year since the acquisition date.
3. During warranty period, if there are any problems or malfunction about this product in the case of normal use and maintenance, after verification, we will provide free repair and component replacement. The following situations are not included in warranty. We provide free repair and component replacement during warranty period. Damage or malfunction caused by the following situations are not included in warranty (even though during warranty period), we assume no obligation to provide free warranty.
 1. Devices, components is beyond the warranty period.
 2. Damage caused by abnormal use such as any use, maintenance or wrong installation not according to the requirements of the product manual.
 3. Damage caused by non-production manufacturer authorization server disassembly.
 4. Damage caused by accidents or man-made reasons (Error in operation, scratch, transfer, bump, inappropriate voltage and current input, etc).
 5. Damage caused by force major such as fires, floods and lightning.

The picture is only for reference, please make the object as the standard. We reserve the right for final explanation.

FCC Statement

Changes or modifications not expressly approved by the party responsible for compliance could void the user's authority to operate the equipment.

This equipment has been tested and found to comply with the limits for a Class B digital device, pursuant to Part 15 of the FCC Rules. These limits are designed to provide

reasonable protection against harmful interference in a residential installation. This equipment generates uses and can radiate radio frequency energy and, if not installed and used in accordance with the instructions, may cause harmful interference to radio communications. However, there is no guarantee that interference will not occur in a particular installation. If this equipment does cause harmful interference to radio or television reception, which can be determined by turning the equipment off and on, the user is encouraged to try to correct the interference by one or more of the following measures:

- Reorient or relocate the receiving antenna.
- Increase the separation between the equipment and receiver.
- Connect the equipment into an outlet on a circuit different from that to which the receiver is connected.
- Consult the dealer or an experienced radio/TV technician for help

This device complies with part 15 of the FCC rules. Operation is subject to the following two conditions (1) this device may not cause harmful interference, and (2) this device must accept any interference received, including interference that may cause undesired operation.