

IMPORTANT

Please be aware the QR CODE on the Fan is your important assets, it is unique way to associate the Fan to your account, and NON-scanable after it was scanned by Non-owner, Please take care of your property.

If it was maliciously occupied, please contact us urgently in accordance with our approval procedure.

3D FAN DISPLAY HANDBOOK

3D Hologram FanDisplay Solution Leader

3D FAN DISPLAY 3D FAN DISPLAY

3D China Fan Display Leading Brand

*Before you use this machine,
please read the instructions carefully.*



Download "Fan Display" from IOS App Store and Google Play

Wechat mini program

※ Scan the QR code to down load, some cellphone may need to go to setting to put the APP to be verified APP.

1.1.Product Overview











Welcome to use F1 Fan display advertising device, we will help you to create a cutting edge global reach advertising display solution, before you use the device, please read this manual carefully, it will direct you to setup your device to cloud smoothly, and provide guideline on APP use.

To Setup and run Fan display device, you will need:

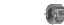
- 1.Fan Display device
- 2.Cellphone in Android 4.0 / IOS 8.0 above (Website platform coming soon)
- 3.FanDisplay APP (Google play App store/iOS App store/Wechat mini-program)
- 4.WIFI Router + Cellphone Hotspot (Good 4G LTE network)



1.2.BOM List Packaging Detail

Host ×1 	 ×3  ×3  ×8  ×4  ×3  ×3
Power Supply ×1 	Pendant   ×2  ×2

3D FAN DISPLAY 3D FAN DISPLAY

1.3. Specification

Item	Model	F1-50H	F2-100H
Display Size		50CM	100CM
Wattage		70W	140W
Maximum Resolution		500K Pixels	1200K Pixels
Frame Rate		24frames/s	
CPU		Quad-core CortexTM-A7	
Brightness		1600cd/m2	
LED Quality		512 (128×4)	1024 (256×4)
System		Android	
Video Format		M P 4 、 A V I 、 RMVD、 MPEG	JPG、 MP4、 AVI、 RMVD、 MPEG
ROW		8G	
Display Angle		176°	
Material		ABS+PC/SECC	ABS+PC/AL
Theoretical Lifetime		30000H	
Control Method		APP (Android, IOS) , Mini-program, Web	
Blades		4	
Input Voltage		100-240VAC,50/60HZ	
Product Size		φ 50cm*H10.3cm	φ 100cm*H10.3cm
Weight		0.8KG	1.7KG
Packaging Size		325×208×142 (mm)	550×270×170 (mm)
Working Temperature		-20° c~50° c	
Use Environment		Indoor/outdoor (protective cover)	
Installation Method		Wall, Hoisting, Mounting	

3.1. Assembly

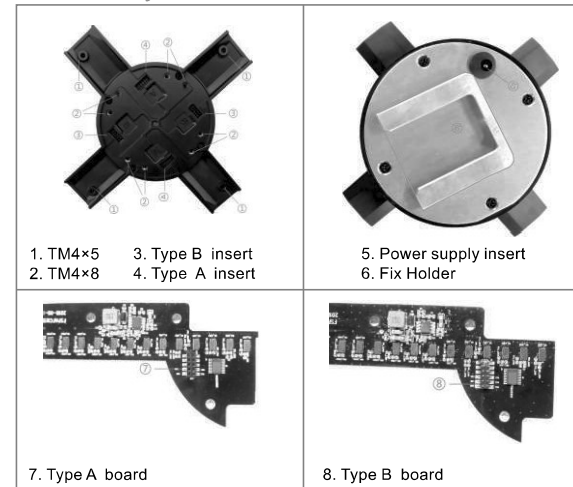

3.2. Assembly Process

1. Assemble the PCB LED Board (pay attention to math A/B end), follow instruction below:

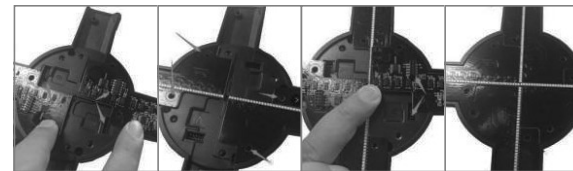

Lock the screw after LED board inserted to the base, pay attention 8 longer screw and 4 shorter screw for different position as below (red arrow for shorter TM4x5, Blue arrow for TM4x8):

3D FAN DISPLAY 3D FAN DISPLAY

3.2. Assembly Process

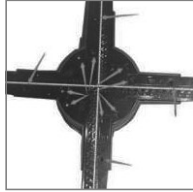

⊘ Screw must be lock tightly to avoid accident!

2. Install the holder on the wall/proper structure (Use M6 screw to lock the device to stable structure), make sure it was well fixed!

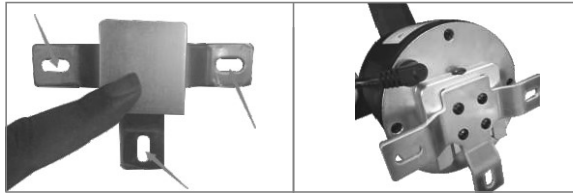

Hang the device to the holder, lock with screw, now the device is ready to setup to Cloud.

3D FAN DISPLAY USER MANUAL – APP

3.1. APP Registration

Open FanDisplay APP and click "Register now" and add the information on the following page and click "Register". (A verification code will be sent to your email for you to add, if you didn't get verification code, please go to login page login directly, and please feedback to us, we are fixing the bug for some country can not get the code in time)

※ **Note: only email available for registration.**

If you have been used Wechat mini-program, to make sure all device under the same account, please login wechat mini-program to bind your email first, set password and then go to APP to login directly

Binding email in Wechat mini-program : "Me"→ ID → "Binding email"→ Input email and verification code (you can neglect this step if WIFI unavailable)

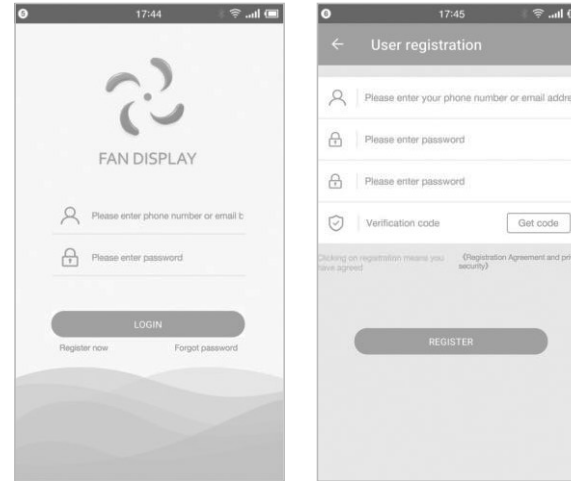

Device Add:

Login to the APP and click "MANAGE", then click the "+" button at the upright corner, a scan screen will open for you to scan the QR code on the Fan Display to add the Unit to your control list (**Note: More than One units can be added, device can be share to the other user by owner who scan first, but can not scan it anymore unless the owner delete the device**)



3.2. Device network

Please be aware this device was designed to auto connect to a defined WIFI, to setup the device to local router network, we recommend to use cellphone which must have good 4G LTE network to share hotspot in default setting for 1st time setup.

Default WiFi Name: fsp
Default WiFi Password: fsp123456
No Caps "fsp"

3D FAN DISPLAY 3D FAN DISPLAY

2.3.1 Device Network Routing

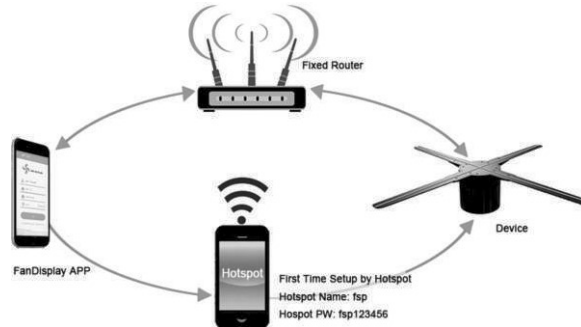

1. IOS Hotspot setting:

- Step 1: "Setting"->"General" -> "About" -> "Name" (Set iPhone name as "fsp")
- Step 2: "Setting" -> "Hotspot" -> "Password" (Set password as "fsp123456")

2. Android Hotspot setting:

Routine: Setting -> Hotspot (Change Hotspot name to be "fsp" and password to be "fsp123456")

Remark: This process only needs in 1st time setup or change to a different router, Android hotspot setting depends on specific android device.

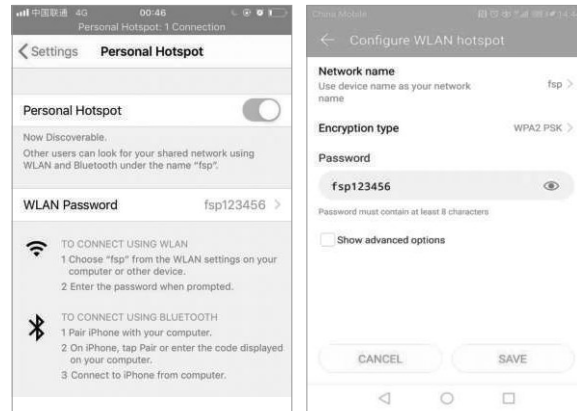

iOS Hotspot setting

Android Hotspot setting

After display is connected with default "fsp" then you can you connect it with WIFI available.

Login the APP, go to Homepage, click "Network Configuration" to continue setup,

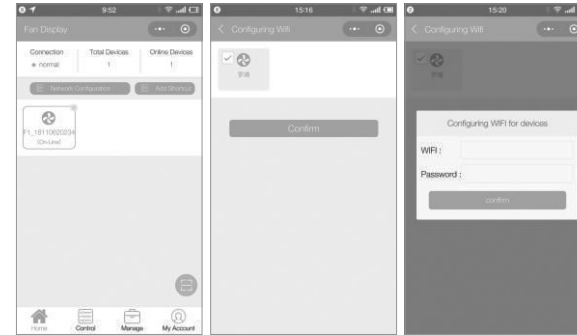

Choose the device (can more multiple choices) to setup, Input WIFI name and password, you device will be connected to the internet with 3~5 minutes.

While connecting to your WIFI, the screen pauses and restart automatically showing colored pictures like Red Green Blue (RGB)

3.1.APP introduction

You will see APP as below after login, read this guideline:



Home page:



1. An overview of device qty and online status
2. Icon can add device
3. Add shortcut to home page
4. Configure the device to local wifi router wifi connection from Hotspot

3D FAN DISPLAY 3D FAN DISPLAY



Manage:

This page shows the devices that could managed
1. Through "Delete" button, could delete devices

2. Click devices name, could change devices name and etc. Operate
Under the "Device" page, at the right corner 
scan to add devices
Under the "Group" page, at the right corner  scan to add group

3. Click Group name, add new devices or use existing devices

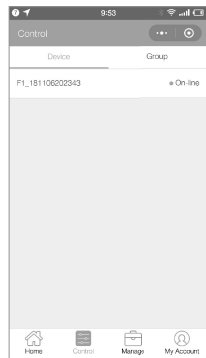

Control:

Through click devices name to control them

1. Switch "on/off" button
2. Mode setting
3. Click "Add Video", to add new video
4. Order, Delete, Play video

3.6.1 Share Device

Sharing method: The device owner click "+" icon to scan the QR code of "be shared user"

Be shared user must show ID QR code from: "me" → ID Name → My QR code



1) Owner to scan be shared user: click "me" then click "My share" → "my share account" → click  → "scan" to scan the QR code of be shared user.

2) Share by email or phone (while is far away): click "me", then click "my share" → "Add my shared account" → click  → "Enter email or phone number share" → input the user email or phone number who you want to share with.

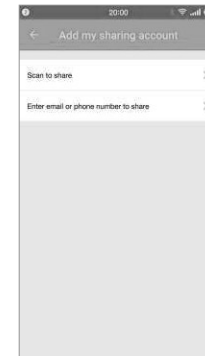
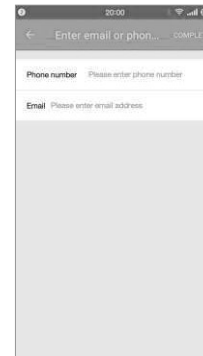

Remark: As the Fan Display was designed to connect to cloud by wifi, the connection situation will be various due to internet connection factors, please be patient, if the APP doesn't response, please check wifi connection, we highly recommend the wifi router must keep within 10meter and no wall between the device and router.

3D FAN DISPLAY 3D FAN DISPLAY

Warning

- 1) Safety is most priority of installation consideration
- 2) Make sure audience (including Child&Adult) unable to touch during device working
- 3) Device must install on high position to avoid audience touch, otherwise need cover protection.
- 4) The Display must be well fixed on stable structure.
- 5) Make sure the spinning range is clean before turn on the device.
- 6) Please be aware the LED board component will be easy to damage if scratch hard.
- 7) Please clean device with soft cloth.
- 8) Personal dis-assembly without agreement will not be allowed and warranty will be end automatically.

FCC Warning

This device complies with part 15 of the FCC rules. Operation is subject to the following two conditions: (1) this device may not cause harmful interference, and (2) this device must accept any interference received, including interference that may cause undesired operation.

Changes or modifications not expressly approved by the party responsible for compliance could void the user's authority to operate the equipment.

NOTE: This equipment has been tested and found to comply with the limits for a Class B digital device, pursuant to part 15 of the FCC Rules. These limits are designed to provide reasonable protection against harmful interference in a residential installation. This equipment generates uses and can radiate radio frequency energy and, if not installed and used in accordance with the instructions, may cause harmful interference to radio communications. However, there is no guarantee that interference will not occur in a particular installation. If this equipment does cause harmful interference to radio or television reception, which can be determined by turning the equipment off and on, the user is encouraged to try to correct the interference by one or more of the following measures:

-Reorient or relocate the receiving antenna.

- Increase the separation between the equipment and receiver.
- Connect the equipment into an outlet on a circuit different from that to which the receiver is connected.
- Consult the dealer or an experienced radio/TV technician for help.

Radiation Exposure Statement

This equipment complies with FCC radiation exposure limits set forth for an uncontrolled environment. This equipment should be installed and operated with minimum distance 20cm between the radiator and your body.