



MusicStudio

User Manual

MS-ASE

www.ilya-tech.com

STEP 1

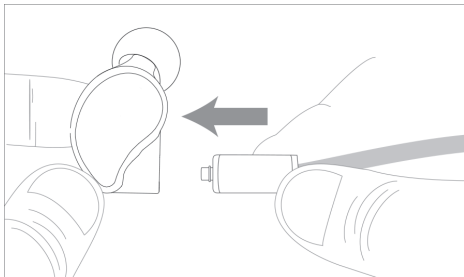

To detach the cable, grasp the earpiece and cable connector firmly, and pull straight apart.

STEP2

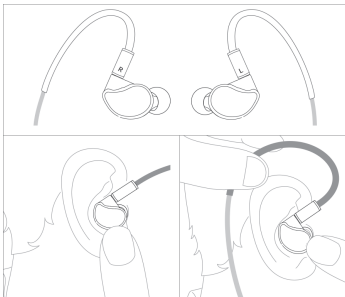

Identify the right and left earpieces. Straighten the memorywire and put each earpiece in the corresponding ear. Adjust each earpiece until it fits flush in your ear and the eartip seals the ear canal.

WARRANTY

ILYA-TECH warrants this product to be free of defects in material or workmanship for a period of one(1) years from the date of original retail purchase. This warranty is available only to the original purchaser, and only if purchased from an authorized ILYA-TECH distributor or reseller. If your product is found to be defective during the warranty period, ILYA-TECH will, at its sole option, either repair the product or replace the product with a new or factory reconditioned or substantially equivalent model. This limited warranty does not apply to loss, theft, or any defects attributable to damage beyond the reasonable control of ILYA-TECH including damage caused by abuse, misuse, misapplication or modifications performed by anyone other than ILYA-TECH. This warranty applies only to the external shell of the product, the internal components and cable. Eartips are not covered by the warranty.



INFORMATION

Used wisely, your new earphones will provide years of enjoyment. Noise-induced hearing loss is preventable but often undetected until it is too late. ILYA-TEACH recommend you avoid prolonged exposure to excessive noise. Used responsibly, your earphones can help prevent noise-induced hearing loss. If you have questions, contact your audiologist or hearing care professional.

Be sure to observe the following guidelines:

- Do not turn up the volume so high that you can't hear what's around you.
- You should use extreme caution or temporarily discontinue use in potentially hazardous situations.
- Do not use while operating a motorized vehicle as it may create a traffic hazard and is illegal in many areas.

FCC Statement

This device complies with Part 15 of the FCC rules. Operation is subject to the following two conditions: 1) this device may not cause harmful interference, and 2) this device must accept any interference received, including interference that may cause undesired operation.

Note: This equipment has been tested and found to comply with the limits for a Class B digital device, pursuant to part 15 of the FCC Rules. These limits are designed to provide reasonable protection against harmful interference in a residential installation. This equipment generates uses and can radiate radio frequency energy and, if not installed and used in accordance with the instructions, may cause harmful interference to radio communications. However, there is no guarantee that interference will not occur in particular installation. If this equipment does cause harmful interference to radio or television reception, which can be determined by turning the equipment off and on, the user is encouraged to try to correct the interference by one or more of the following measures:

- Reorient or relocate the receiving antenna.
- Increase the separation between the equipment and receiver.
- Connect the equipment into an outlet on a circuit different from that to which the receiver is connected.
- Consult the dealer or an experienced radio/TV technician for help.

Changes or modifications not expressly approved by the party responsible for compliance could void the user's authority to operate the equipment.

FCC Radiation Exposure Statement

This device complies with FCC RF radiation exposure limits set forth for an uncontrolled environment. This transmitter must not be co-located or operating in conjunction with any other antenna or transmitter.



SUZHOU ILYA ELECTRONIC TECHNOLOGY CO., LTD.

www.ilya-tech.com

(The production is authorized by ILYA-TECH)