



**Welcome to start
Your mobile payment solutions**

POS Terminal PT7003

Quick Reference Guide



Introductions

Thank you for purchasing a PT7003 product from Tousei.

This quick reference guide is designed to help users effectively operate the device.

1. Please read this reference guide carefully before using the device for safe and proper use.
2. This device may only be used in countries where it is sold.
3. The components and colors of this device in this reference guide may differ from the actual product.
4. Features and specifications are subject to change without prior notice.
5. Some screens or illustrations used in this reference guide may differ from the actual screens of the device.
6. Except where noted, device illustrations used in the reference guide are the PT7003 model.

Notice Before Using Device

1. This device is qualified for the standard of the safety of human body against electromagnetic wave.
2. Use only specified original batteries and standard power adapter. Keep indoors the temperature between 0~40°C (32~104°F). **The guarantee duration of the battery is 6months from the sales.**
3. When charging the battery, you must use the supplied standard power adapter. If the original adapter is not used, the battery life may decrease and may explode. (In this case you cannot receive the free repair service.)
4. Please make sure that nothing rests on the power cord when connecting the power cord, and the location where the power cord will not be stepped on or cause to stumble.
5. Please backup the data and information from your device. During the repair or upgrade, there is a slight possibility of your data being erased.
6. When a device is not in use for a long time, please charging device and unplug the power cord and place it at a safe place where it won't drop. Even for fully charged battery, the lifetime can be decreased because of its own properties of voltage decrease.
7. Do not remodel, take apart, or repair the device. If not the case, you will not be able to get your free repair service. Only authorized agent or service center has access to the device.
8. Do not press power button on the device if the device is wet or do not touch adapter or power cord with wet hands. There is risk of electric shock.
9. In case your device is wet, do not put your device in heaters, microwaves, or etc to dry- there is a risk of explosion or it can be the cause of malfunction. (Please note there is a label in the device that changes color when it gets wet. In this case you will not be able to get your free repair service.)
10. This device is not waterproof. Do not use in places of high temperature and high humidity. The following can be the causes of malfunction: getting wet from the rain, spilling drinks, and taking it in with you at the high temperature places.
11. Do not place the device in a high temperature, heating equipment or direct sunlight.
12. Do not use your device at an explosive danger zone.
13. Do not place this device on an unstable stand or table, lest it fall, causing unnecessary damage and personal injury.
14. Do not place credit cards, phone cards, bankbook, and tickets next to the device. The magnetic forces of the device can damage the information of listed item.
15. Do not place your device at a dusty place. Keep your power cord away from any heating device. Unplug the power cord when cleaning. If there are any dusts or residue clean the power cords pins thoroughly.
16. Do not paint your device and Do not place heavy or sharp objects on the LCD screen or on the device. It can damage your screen or your device's exterior.

Cleaning the device

1. Please make sure that the machine is turned off before cleaning the device.
2. Please use a soft and lint-free and dry cloth to clean the device.
3. If the stain is difficult to remove, please use a clean, soft and lint-free cloth stained with a little ammonia-free non-alcoholic ingredient, and non-abrasive cleaner to wipe the surface of the shell.
4. Do not directly spray cleaning fluids or spilled on the device.

Package Contents

Please make sure all the above components are included.

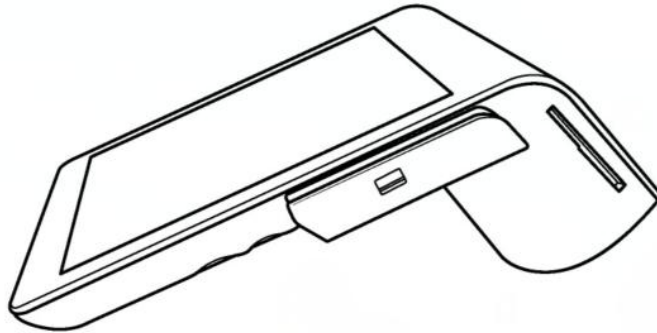

POS Terminal Device

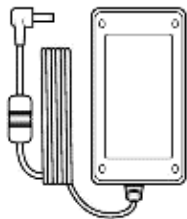

Adapter

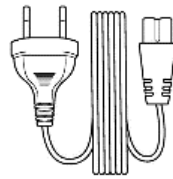

Power cord



Thermal paper

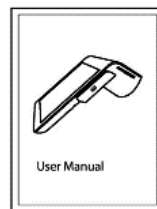

Quick Reference Guide

Device Features

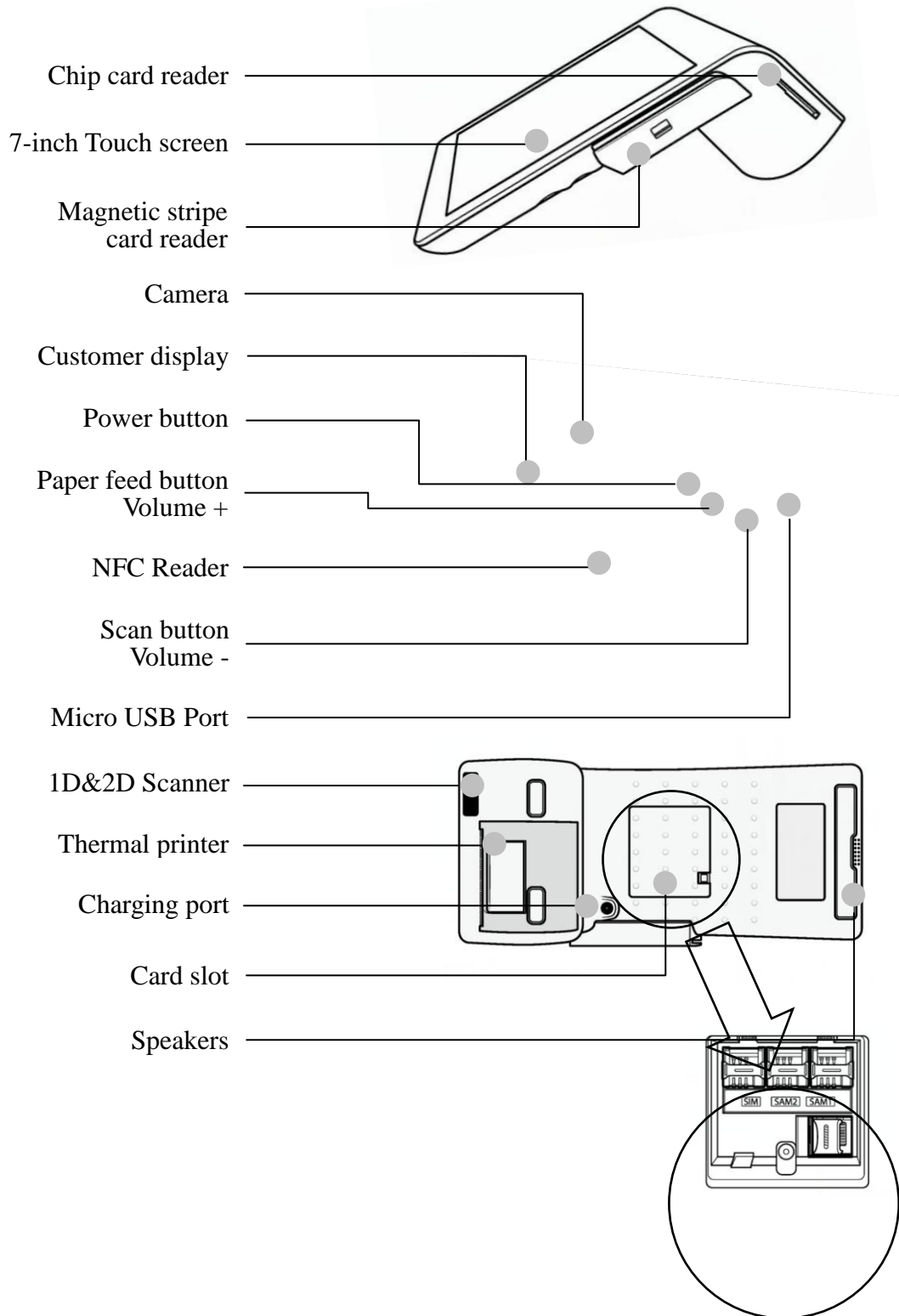

Charge in your POS terminal Device

1. Plug in the battery charger in the Device charging port.
2. Attach the power cord to the power brick and plug the power cord into a power source.
3. The charger lamp is red, (The lamp will be green fully charged), A battery icon will appear on the screen.
4. Press and hold the power button until the Android logo appears on the screen.
5. POS terminal should now be powered on.

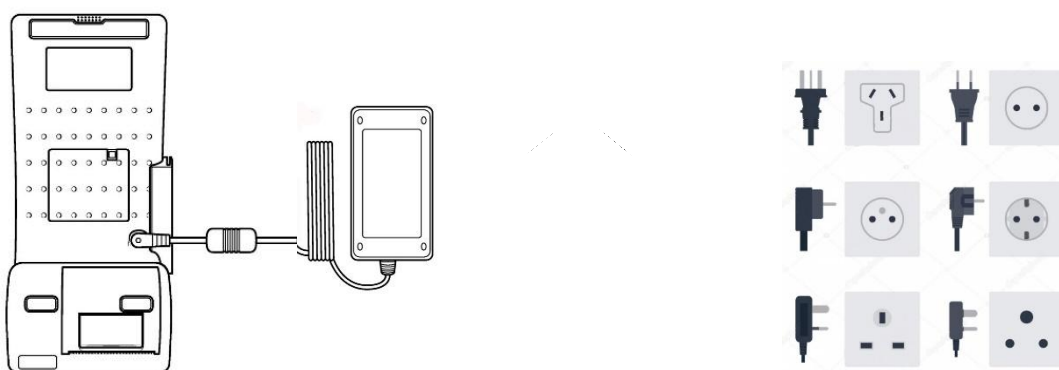

Connect the POS Terminal to a Network

Once your PT7003 has started, select your primary language for your device

■ Connect Device via 4G

For the PT7003 device support 4G/3G/2G net, which can be chose via local net situation,

Install the SIM card in the slot, POS device will automatically connect via the 4G network, restart the machine. Please wait about a minute for the SIM card to verify that it's connected to the 4G network. Tap Next when the mark appears.

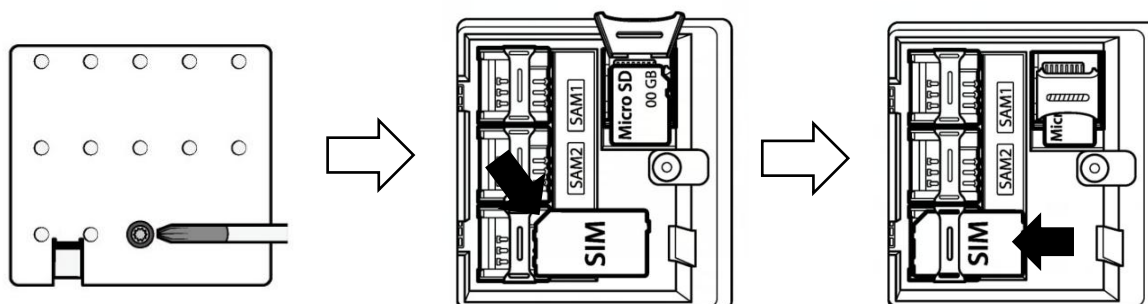

Quick Reference Guide 7
Insert the SIM card into the SIM card slot with the card meeting the angled edge.

■ Connect Device via Wi-Fi

1. On the setting screen, tap Wi-Fi
2. Tap on to set Wi-Fi on (Blue).
3. Select your wireless network from the list of available wireless network.
4. Enter in your wireless network password.
5. Tap connect.

■ Connect Device via Bluetooth

1. On the Setting screen, tap Wi-Fi.
2. Tap on to set Wi-Fi on (Blue).
3. Select your Bluetooth from the list of available Bluetooth.
4. Connect the external device via Bluetooth.

Function operation display

■Installing a micro SD card

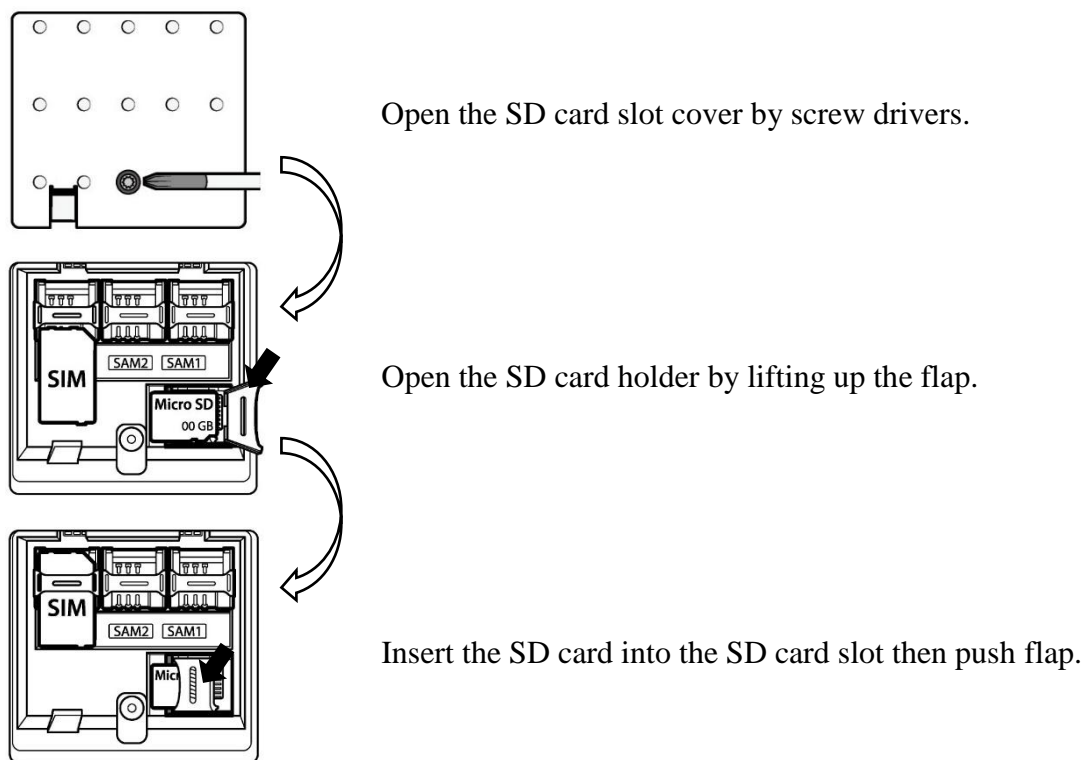

■ Insert paper roll into printer

To make sure your printer is ready, load the paper into your device and press Print test receipt.

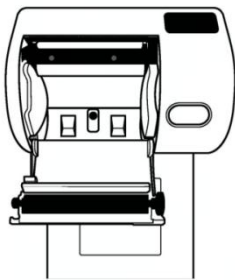

- Open the printer cover by lifting up the latch lever.
- Remove any remaining core of a fully used paper roll.

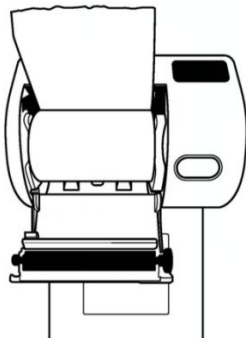

- Insert the roll paper as shown in the image.
(Make sure to put paper roll in the right direction)
- Make sure the paper sticks out of tray.

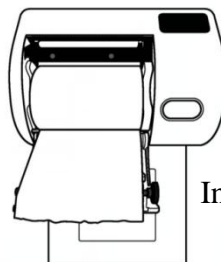

Incorrect Example

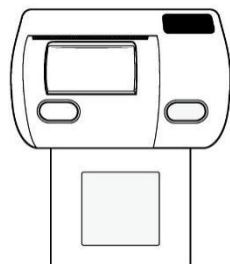

- Close the printer cover.
- Again, make sure the paper sticks out of tray.

■ Using Magnetic stripe card readers

1. Make sure the card with the magnetic stripe facing inward.
 2. Swipe the card from top to bottom quickly and slightly.
- (When swiping the card, the recommended swiping speed is 100 ~ 120mm/sec)

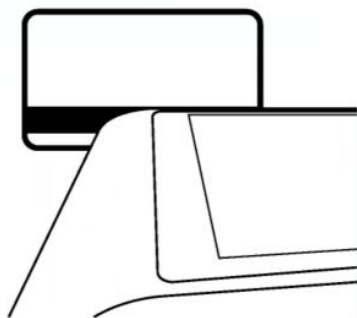

Correct Example
Magnetic stripe facing inward

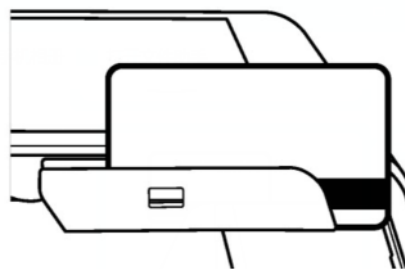

Incorrect Example

Incorrect Example
Magnetic stripe facing outside

■ Using Chip card readers

1. Insert the card with the chip facing down.
2. Remove the card when prompted by the device, then follow the next step.

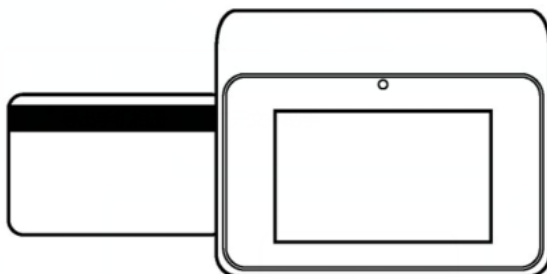

Correct Example
Chip facing down

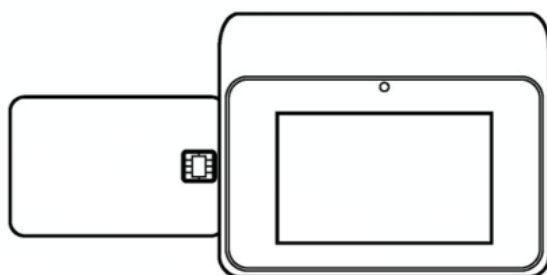

Incorrect Example
Chip facing up

■ Using NFC readers

1. Tap chip cards with contactless capabilities with contactless payments on the NFC marks.
2. Reading distance within 40mm from the NFC marks.

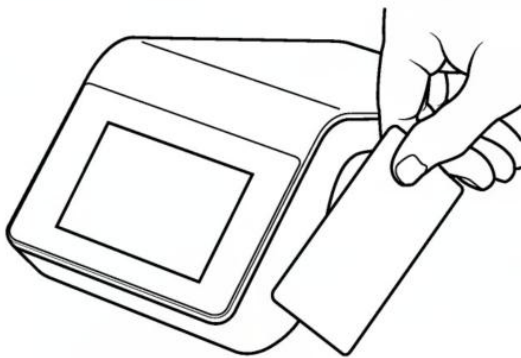

■Barcode Scanning

1. Point the scanner window toward the barcode at intervals of approximately 10cm from the item or the receipt, and press the scan button or scan application to read the barcode.
2. If the scanner window is perpendicular (0°) to the barcode, it is impossible to read barcode due to characteristics of the laser barcode engine. Thus, scan at a little inclined angle, not a right angle.

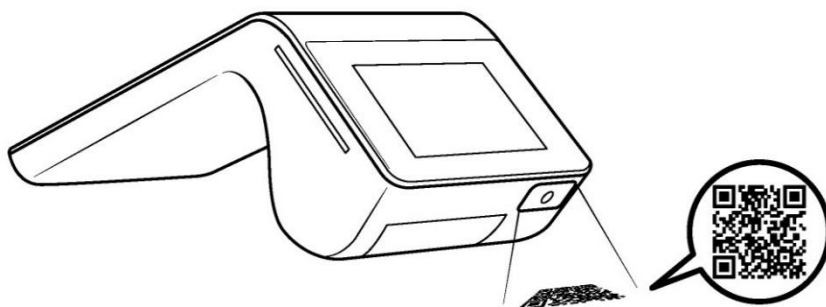

When scanning barcode, do not direct the scanner window toward eyes of a man/ an animal. It may cause damage to the retina and eyesight damage.

Device specifications

Operation system	Android 7.0
Application CPU	ARM Cortex A53 Quad core 1.3GHZ
Storage memory	RAM 1GB+Flash ROM 8GB
Dual display	7.0" IPS TFT LCD, HD 800×1280 pixel 3.5" 320×480 pixel
Touch screen	Capacitive Multi Touch Screen
Communication	LTE (RED) : B1/B3/B7/B20/B40 (Optional) LTE (FCC ID) : B5/B7/B41 (Optional) WCDMA/GSM/CDMA (RED/FCC ID)
Wi-Fi	802.11a/b/g/n, 2.4GHz &5GHz (B1/B4)
Bluetooth	V4.2 (Support BLE)/V3.0/V2.1
GPS	GPS, A-GPS(Optional)
Magnetic stripe card	1/2/3 track, two-way card (Optional)
Smart card	EMV Standards
NFC	ISO/IEC 14443 Type A/B, Mifare® standard
Printer	Thermal Direct 58mm, 40mm/sec , MaxØ35mm
Front camera	5MP fixed (Optional)
Scanner	1D&2D barcodes scanner (Optional)
Card slots	1SIM Card slot, 2PSAM or SAM Card slots
Extended Storage	1 Micro SD/TF Card slot
Physical interface	Micro USB
Physical keys	1 Power, 1 Volume
Speaker	Built in 1.0W
Certification	EMV L1, L2, CE, FCC
Dimension & Weight	255*121*91mm, 800g (include battery)
Battery	Built in Li-Ion Polymer, 7.4V/3,900 mAh
Charging	Adapter DC 9.0V/ 2.5A

Common Troubleshooting

Items	Solution
Can't open device	Check if the battery is dead and need to charge it.
The battery does not charge properly.	<ol style="list-style-type: none"> 1. Ensure that your device and the charging cable are connected is functioning correctly. 2. If the battery does not charge completely, it may be dead or defective. (The warranty period for battery replacement is 6months.)
I dropped the device in the water.	Turn off the device. Place the device in a dry place. Let them dry completely for a considerable period of time, and then turn the device back on. If it does not turn back on, contact our service center.
Device gets too hot to touch.	It is normal for the device to warm up while it is performing an intense workload or charging. It should cool down if you stop using the device for a certain amount of time. If the problem continues, contact our service center. It may result in a burst battery or fire.
Read magnetic stripe card failed	<ol style="list-style-type: none"> 1. Check if the magnetic strip is facing inward. 2. Check if there is something wrong in the swipe slot. 3. Check if the card is weakened or degaussed. 4. Swipe the card at a constant speed and close the bottom of the slot.
Read IC card failed	<ol style="list-style-type: none"> 1. Check if the chip is facing inward. 2. Check if the IC chip card insert into the bottom. 3. Check the IC card whether is scratch-ed or damaged.
Read NFC failed	<ol style="list-style-type: none"> 1. Check the frequency band of the NFC in advance. 2. Check the position and distance.
The printer can't work	<ol style="list-style-type: none"> 1. Check whether have the paper or not. 2. Check if the direction of the paper roll is correct.
Scanning failed	Try to align barcode scanning.

Warranty Information

Warranty certificate

Tousei warrants this device against defects in materials or workmanship for 12months parts from the original ship date. During this period, Tousei will repair or replace defective parts with new or reconditioned parts at Tousei option, without additional charges.

Warranty Conditions

1. This warranty extends only to products distributed and/or sold by Tousei.
2. No warranty extension will be granted for any replacement part(s) furnished to the purchaser in fulfillment of this warranty.
3. Tousei and its authorized agent or service center accepts no responsibility for any software programs, data or information stored on any media or any parts of any product returned for repair.
4. All pre-installed software programs are licensed to customers under non-Tousei software vendor's term and conditions provided with the packages.
5. This warranty does not cover any third-party software or virus-related problems.
6. Tousei makes no warranty either expressed or implied regarding third-party (non-Tousei) software.

Warranty Limitation and Exclusion

1. The case of the device has been opened by anyone other than Tousei repair department or authorized repair centers.
2. The device is modified or disassembled by anyone other than Tousei repair department or not under supervision by an authorized Tousei support specialist.
3. The serial number of the device is removed or unable to be deciphered.
4. Any catastrophic event independent of the normal functioning of the hardware such as flooding or other water damage, fire, transient power surges or insufficient line voltage.
5. Any device failure caused by installing or operating device under conditions not in accordance with installation and operation guidelines or damaged by contact with tools or surroundings.

6. The device is damaged in shipping due to poor packaging.

RMA (Returning Merchandise Authorization) Policy

1. If repairs are required, the customer must clearly and in detail record the devices problem on the RMA request form or email.
2. In all cases, Tousei has the right to evaluation and inspect the faulty device. Tousei will evaluation the device according to the description of the problem on the RMA request form or in the email.
3. After evaluation, Warranty or Out-of-Warranty status will be determined.
4. If the description of the problem is the same as listed on the RMA request form or in the e-mail, the device will be repaired under warranty at no charge and shipped back to the customer.
5. If the description of the problem is different from the problem listed, or damaged from delivery, we will contact the customer. After evaluation, the customer shall be notified of the repair cost. If the customer desires an expedited method of return, the device will be shipped collect on delivery.

Safety Regulatory

FCC Part 15

This device complies with part 15 of the FCC Rules. Operation is subject to the condition that this device does not cause harmful interference (1) this device may not cause harmful interference, and (2) this device must accept any interference received, including interference that may cause undesired operation.

FCC Part 15 Class B-specific

Note: This equipment has been tested and found to comply with the limits for a Class B digital device, pursuant to part 15 of the FCC Rules. These limits are designed to provide reasonable protection against harmful interference in a residential installation. This equipment generates, uses and can radiate radio frequency energy and, if not installed and used in accordance with the instructions, may cause harmful interference to radio communications. However, there is no guarantee that interference will not occur in a particular installation. If this equipment does cause harmful interference to radio or television reception, which can be determined by turning the equipment off and on, the user is encouraged to try to correct the interference by one or more of the following measures:

- Reorient or relocate the receiving antenna.
- Increase the separation between the equipment and receiver.
- Connect the equipment into an outlet on a circuit different from that to which the receiver is connected.
- Consult the dealer or an experienced radio/TV technician for help.

FCC Warning

Changes or modifications not expressly approved by the party responsible for compliance could void the user's authority to operate the equipment.

This transmitter must not be co-located or operating in conjunction with any other antenna or transmitter.

The product comply with the FCC portable RF exposure limit set forth for an uncontrolled environment and are safe for intended operation as described in this manual. The further RF exposure reduction can be achieved if the product can be kept as far as possible from the user body or set the device to lower output power if such function is available.

FCC ID: 2ASHJPT7003

For FCC SAR Description:

This POS Terminal meets the government's requirements for exposure to radio waves. The guidelines are based on standards that were developed by independent scientific organizations through periodic and thorough evaluation of scientific studies. The standards include a substantial safety margin designed to assure the safety of all persons regardless of age or health.

FCC RF Exposure Information and Statement The SAR limit of USA (FCC) is Extremity for Limit 4.0W/kg And Trunk for Limit 1.6 W/kg. Device types: PT7003 (FCC ID: 2ASHJPT7003) has also been tested against this SAR limit. The highest SAR value reported under this standard during product certification for properly is 3.292W/kg of extremity with the distance 0mm and 1.448W/kg of Trunk with the distance 10mm. The use of similar accessories should not contain metallic components in its assembly. The use of accessories that do not satisfy these requirements may not comply with FCC RF exposure requirements, and should be avoided.

WEEE (Waste Electrical and Electric Equipment)

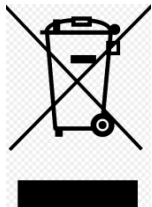

Correct disposal of this product (Waste Electrical & Electronic Equipment)
(Applicable in countries with separate collection systems)

This marking on the product, accessories or literature indicates that the product and its electronic accessories (for example, charger, headset, USB cable) should not be disposed of with other household waste at the end of their working life. To prevent possible harm to the environment or human health from uncontrolled waste disposal, please separate these items from other types of waste and recycle them responsibly to promote the sustainable reuse of material resources.



Battery Warning

To reduce risk of fire or burns ,do not open,do not disassemble,do not crush ,do not puncture,do not dispose in fire or water,do not short external contacts.



RF Specification for RED:

Function	Operation Frequency	Max RF outputpower:	Limit
BLE	2402MHz~2480MHz	5.11 dBm	20 dBm.
BT BR+EDR	2402MHz~2480MHz	GFSK: 2.53dBm; Pi/4 DQPSK: 2.66dBm; 8-DPSK: 2.86dBm.	20 dBm.
2.4G WIFI 802.11b/g/n(HT20,HT40)	802.11b/g/n(20MHz): 2412~2472MHz; 802.11n(40MHz):2422~2462MHz	802.11b: 13.58dBm; 802.11g: 9.84dBm; 802.11n20: 9.99dBm; 802.11n40: 9.99dBm;	20 dBm.
5.2G WIFI 802.11a/n (HT20,HT40)	802.11a/n20: 5180~5320MHz; 802.11n40: 5190~5310MHz;	802.11a: 11.34dBm; 802.11n20 : 11.47dBm; 802.11n40: 11.25dBm;	23 dBm.
5.8G WIFI 802.11a/n (HT20,HT40)	5745-5825 MHz for 802.11a/n(HT20); 5755-5795 MHz for 802.11n(HT40);	802.11a: 11.79dBm; 802.11n20 : 11.79dBm; 802.11n40: 11.60dBm;	13.98 dBm.
GSM/GPRS/EGPRS 900	TX(Uplink):880M-915MHZ; RX(Downlink):925M-960MHZ	32.11dBm;	class 4 (33±3dBm)
GSM/GPRS/EGPRS 1800	TX(Uplink): 1710M-1785MHZ; RX(Downlink): 1805M-1880MHZ	29.21dBm;	class 1 (30±3dBm)
WCDMA B1	TX(Uplink):1920-1980MHz; RX(Downlink):2110-2170MHz	22.59dBm	24 (dBm) +1,7/-3,7 (dB)
WCDMA B8	TX(Uplink): 880-915MHz; RX(Downlink):925-960MHz	21.73dBm	24 (dBm) +1,7/-3,7 (dB)
LTE FDD B1	TX(Uplink):1920-1980MHz; RX(Downlink):2110-2170MHz	22.27dBm	23(dBm)±2,7(dB)
LTE FDD B3	TX(Uplink) :1710-1785MHz; RX(Downlink):1805-1880MHz	23.85dBm	23(dBm)±2,7(dB)
LTE FDD B7	TX(Uplink) :2500-2570MHz; RX(Downlink):2620-2690MHz	23.89dBm	23(dBm)±2,7(dB)
LTE FDD B20	TX(Uplink) :832-862MHz; RX(Downlink):791-821MHz	24.18dBm	23(dBm)±2,7(dB)
LTE TDD B40	Uplink & Downlink: 2300 MHz to 2400 MHz	23.87dBm	23(dBm)±2,7(dB)

For NFC:

Freq.	Corrected Level @3m	Limit
(MHz)	(dBuA/m)	(dBuA/m)
13.56	58.62	83

For RX mode:

Function	Operation Frequency
GPS Receiver	1.57542GHz

Product Name: POS Terminal**Model number:** PT7003**Operating Temperature:** 0° C to 40° C

This device was tested for typical body. To comply with RF exposure requirements, a minimum separation distance of 5mm must be maintained between the user's body and the Smart phone, including the antenna. The similar accessories used by this device should not contain any metallic components. Body operations that do not meet these requirements may not comply with RF exposure requirements and should be avoided. Use only the supplied or an approved antenna.

This device in compliance with the essential requirements and other relevant provisions of Directive 2014/53/EU. All essential radio test suites have been carried out.

1. CAUTION : RISK OF EXPLOSION IF BATTERY IS REPLACED BY AN INCORRECT TYPE.

DISPOSE OF USED BATTERIES ACCORDING TO THE INSTRUCTIONS

2.The product shall only be connected to a USB interface of version USB 2.0

3. Adapter shall be installed near the equipment and shall be easily accessible.

4. The plug considered as disconnect device of adapter

5. For PT7003:

Hardware Version: V1.02

Software Version: V1.05

Please note: Any modification to HW/FW will lead to non-compliance with the essential requirement of RED.

Care for the environment! Must not be discarded with household waste!

This product can be used across EU member states. The frequency bands 5150 MHz~5250 MHz Only indoor use.

	BE	BG	CZ	DK	DE	EE
	IE	EL	ES	FR	HR	IT
	CY	LV	LT	LU	HU	MT
	NL	AT	PL	PT	RO	SI
	SK	FI	SE	UK		



Tousei Anlinx Co.,Ltd.

Address: 2nd floor, #248, HuaQing road, QingHu, LongHua district, Shenzhen City, China
518109

Technology support link: www.tousei.com.cn/download/
Common Trouble Shooting: www.tousei.com.cn/contact-us/