

Model number: Tokinomo V4

Trademark: Tokinomo

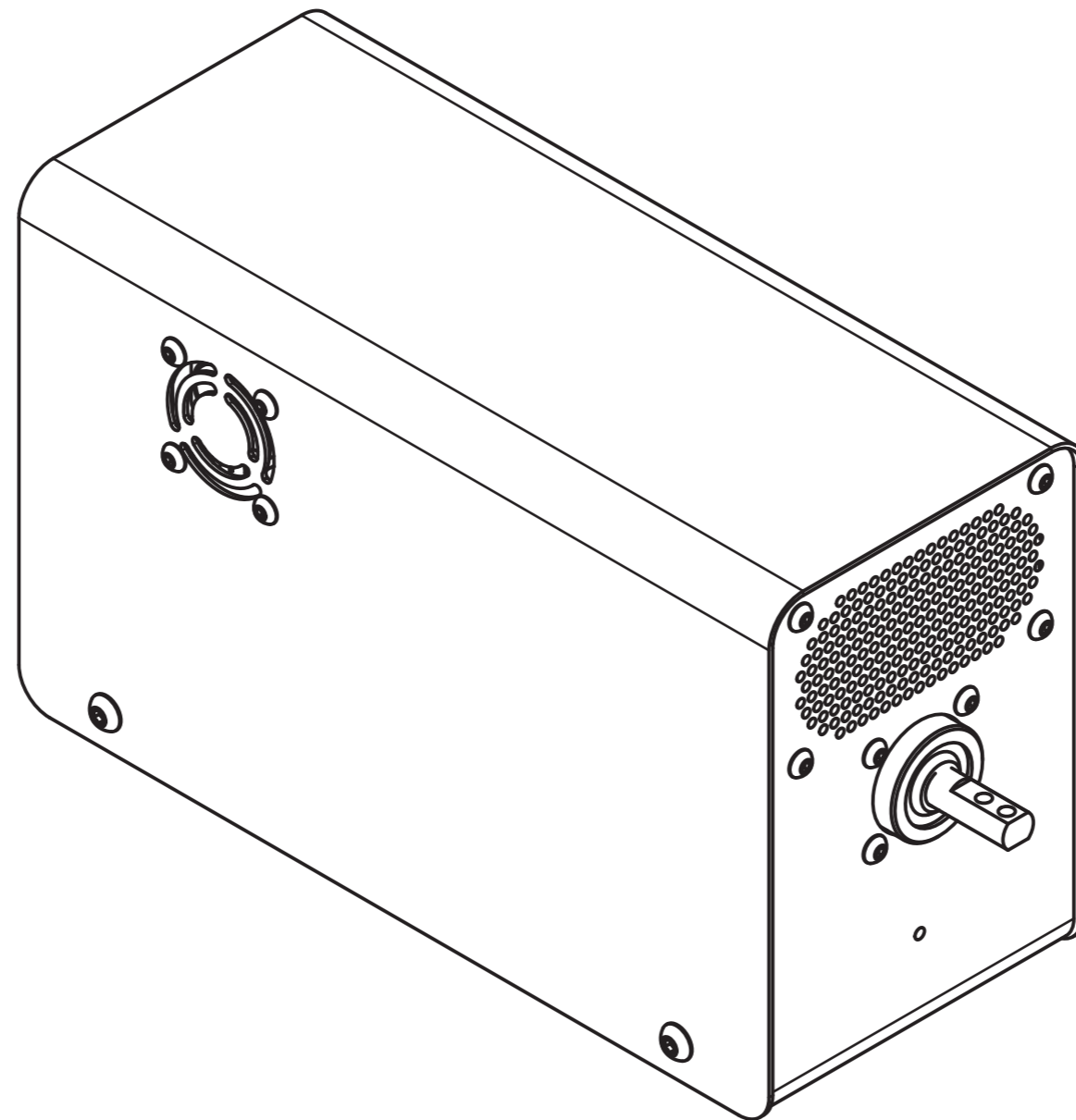
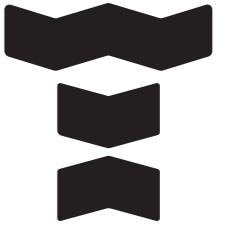

How to operate the **V4** device

FCC Statement



- Contains FCC ID: 2ASEI-TOKIV4
- Contains FCC ID: 2AI4I-AP6212
- This equipment has been tested and found to comply with the limits for a Class B digital device, pursuant to part 15 of the FCC Rules. These limits are designed to provide reasonable protection against harmful interference in a residential installation. This equipment generates, uses and can radiate radio frequency energy and, if not installed and used in accordance with the instructions, may cause harmful interference to radio communications. However, there is no guarantee that interference will not occur in a particular installation. If this equipment does cause harmful interference to radio or television reception, which can be determined by turning the equipment off and on, the user is encouraged to try to correct the interference by one or more of the following measures:
 - Reorient or relocate the receiving antenna.
 - Increase the separation between the equipment and receiver.
 - Connect the equipment into an outlet on a circuit different from that to which the receiver is connected.
 - Consult the dealer or an experienced radio/TV technician for help.
- This device complies with FCC radiation exposure limits set forth for an uncontrolled environment and it also complies with Part 15 of the FCC RF Rules. This equipment must not be co-located or operating in conjunction with any other antenna or transmitter. Endusers and installers must be provide with antenna installation instructions and consider removing the no-collocation statement.
- This device complies with Part 15 of the FCC Rules. Operation is subject to the following two conditions:
 - (1) this device may not cause harmful interference, and
 - (2) this device must accept any interference received, including interference that may cause undesired operation.
- Any changes or modifications not expressly approved by the party responsible for compliance could void the user's authority to operate the equipment.

FCC Radiation Exposure Statement

- This product complies with FCC and ISED radiation exposure limits set forth for an uncontrolled environment. The antenna should be installed and operated with minimum distance of 20 cm between the radiator and your body.

IN THE BOX

Magnetic Led Lamp
(12V, USB B cable)

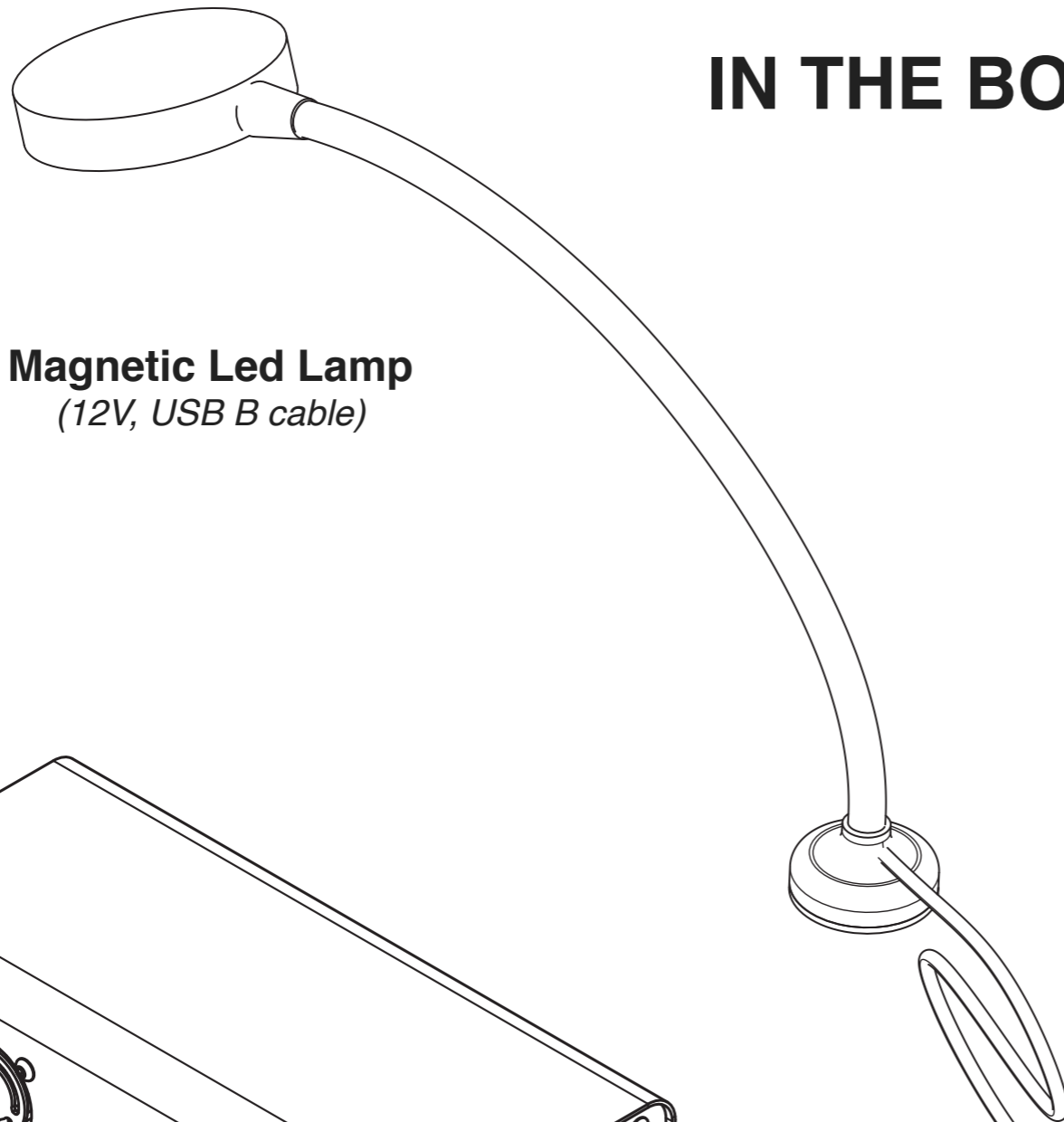

Motion Sensor
(5V, USB A cable)

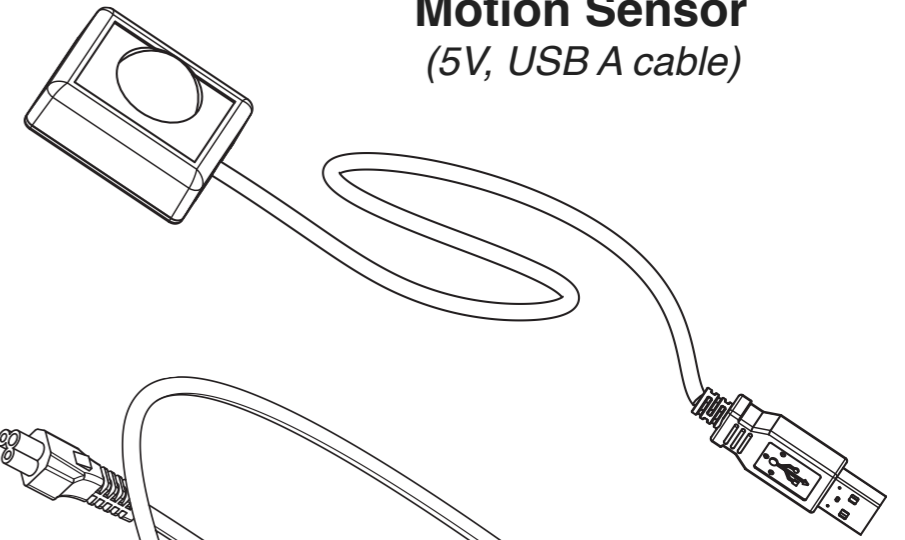

Power Cable

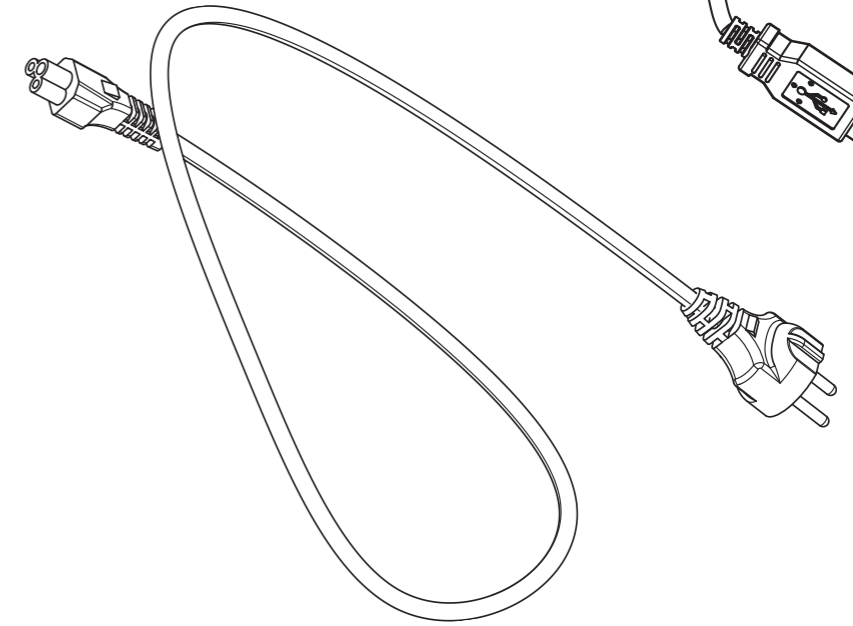

V4 Device

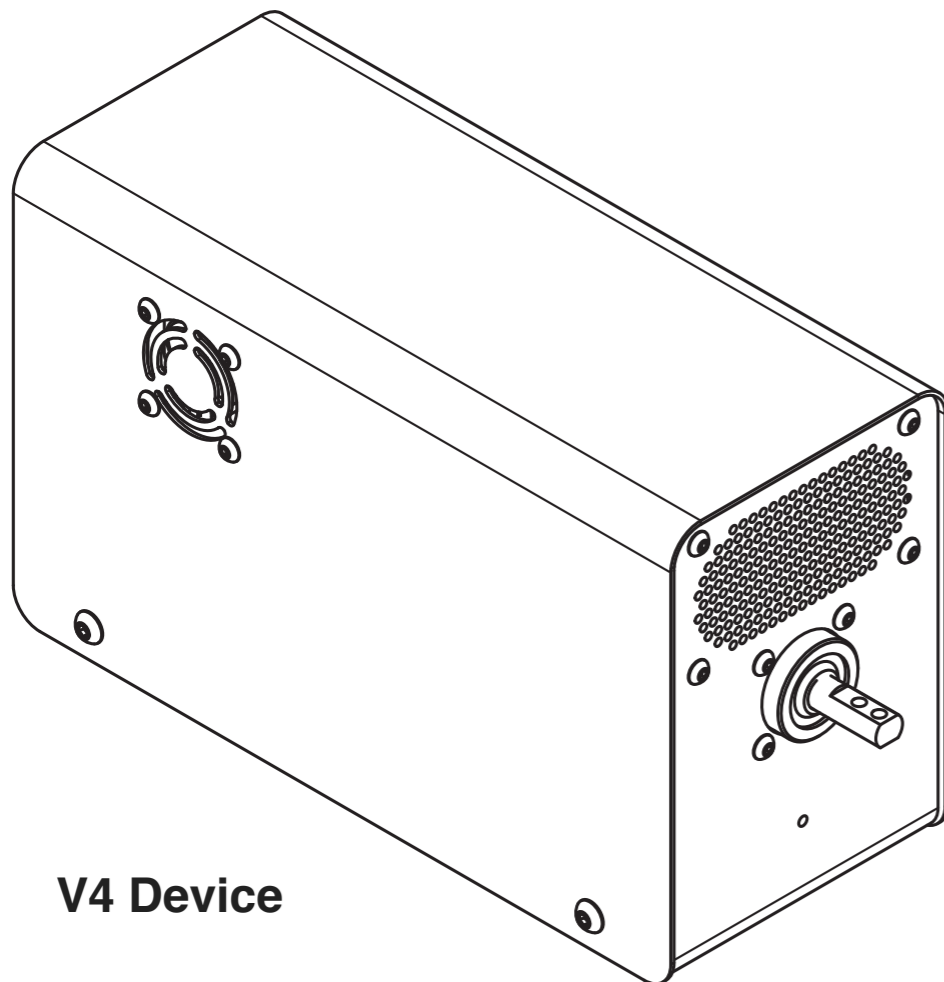

Power Adapter
(12V, 3A, 2.1mm socket)

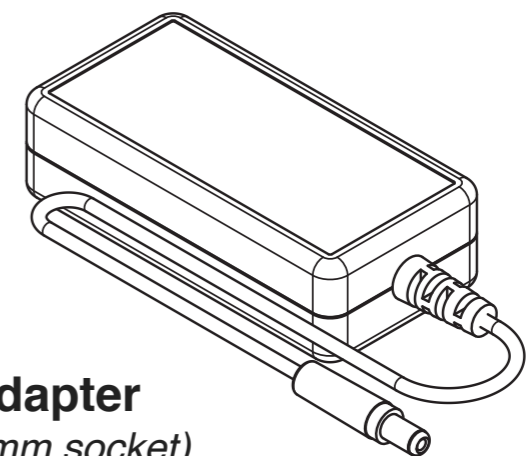

BACK VIEW

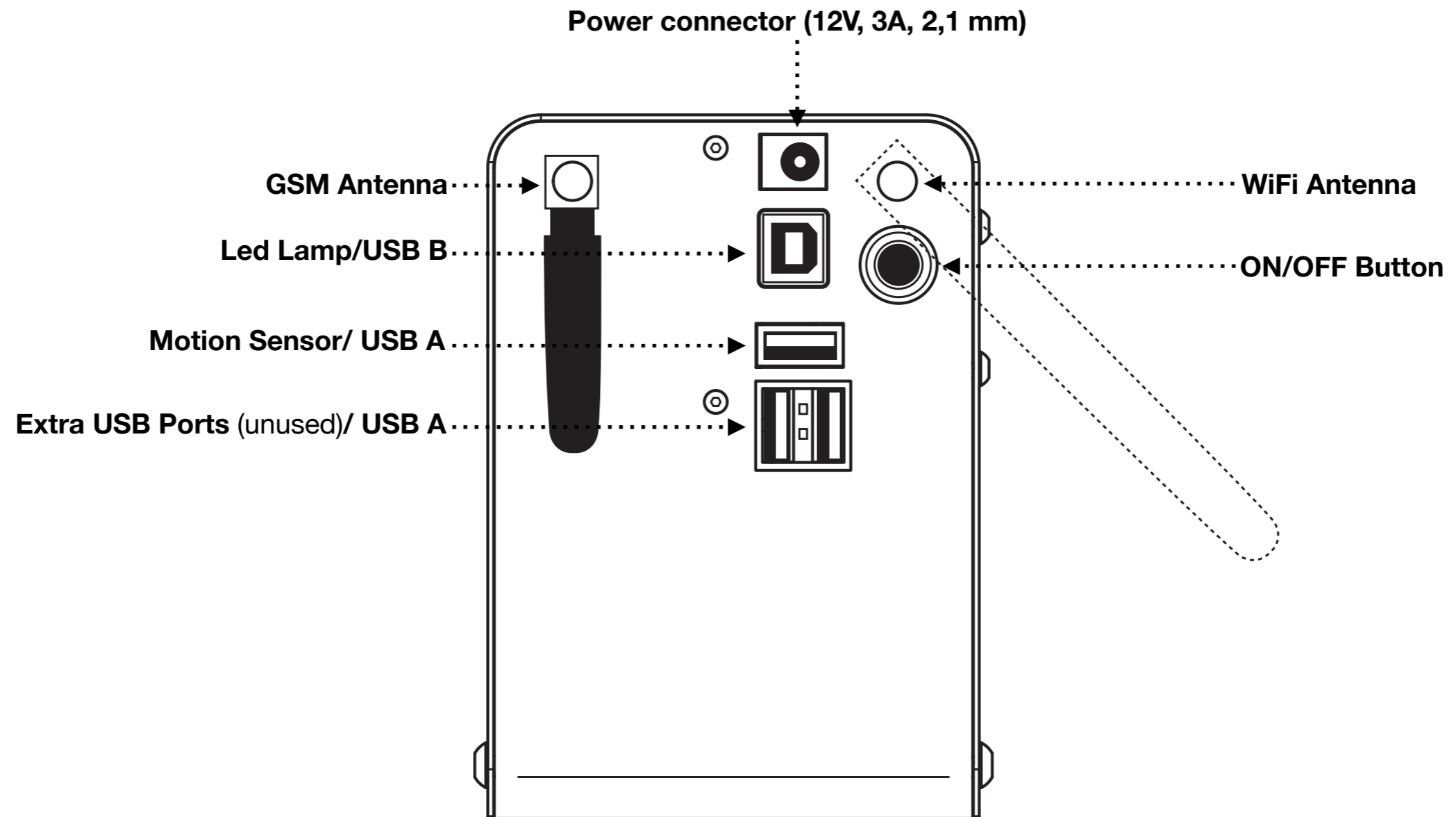

Operating the V4 Device

STEP 1

Insert the Motion Sensor cable into the USB **A horizontal** socket

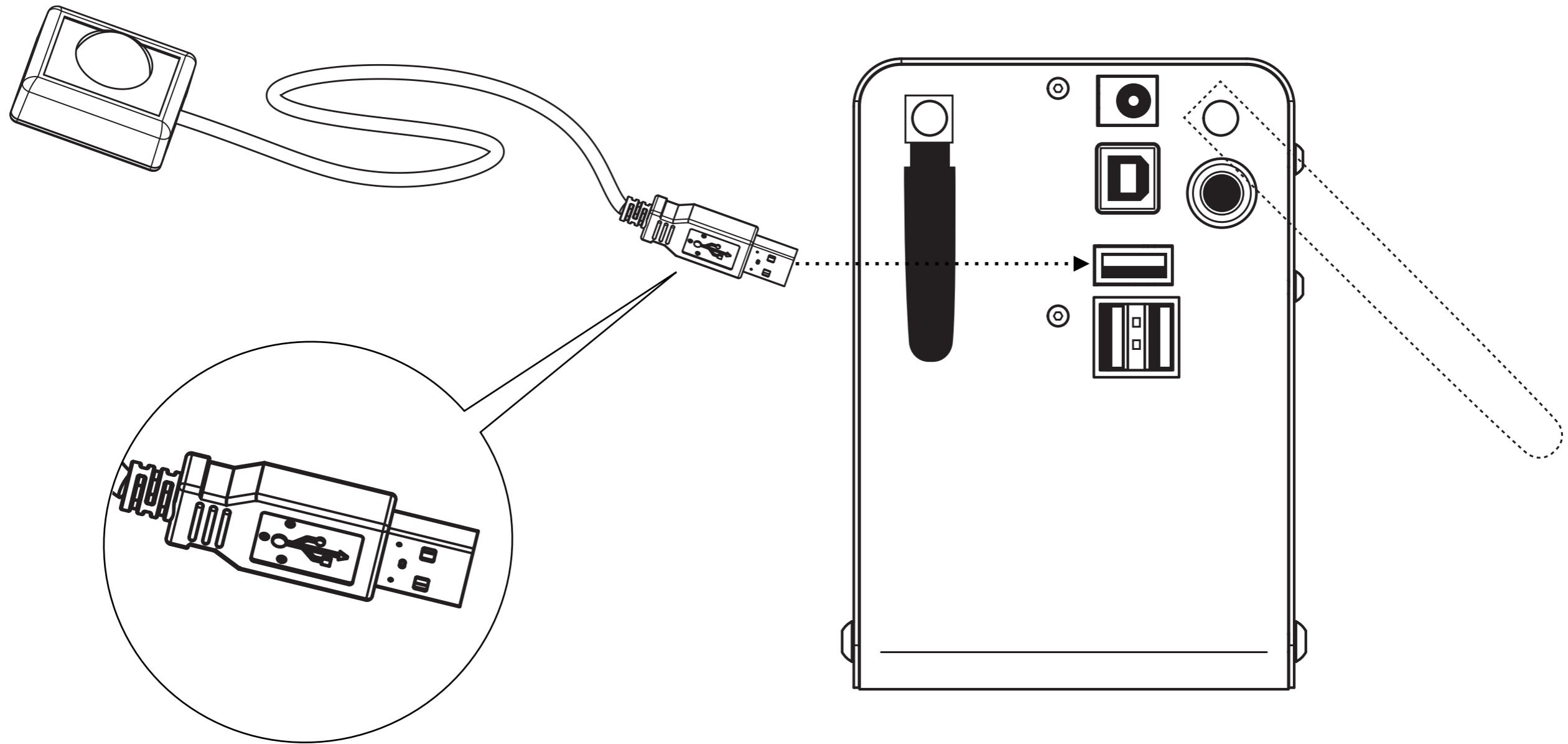

STEP 2

Insert the Led Lamp cable into the USB **B** socket

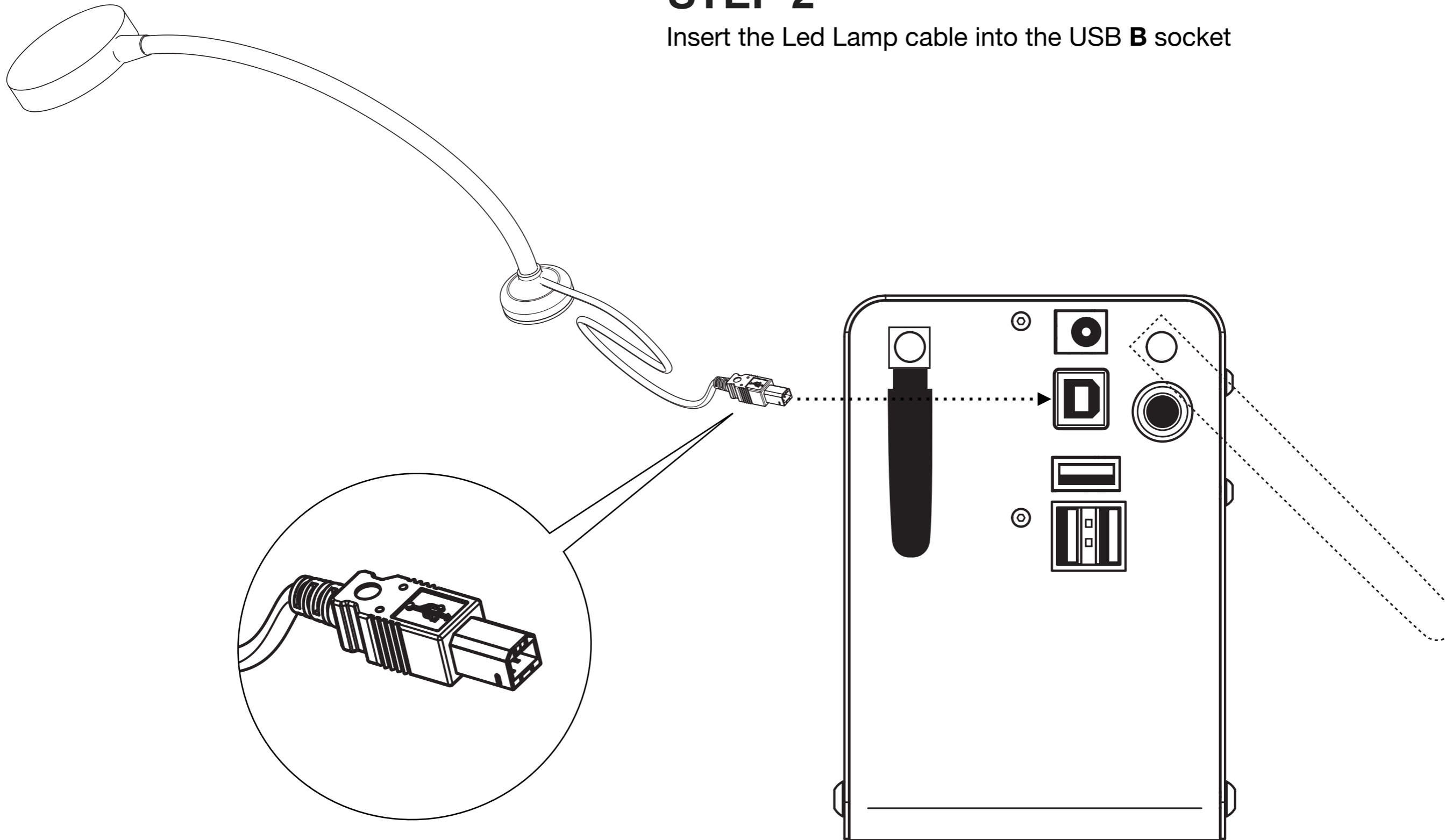

STEP 3

Insert the Power Cable into the Power Adaptor

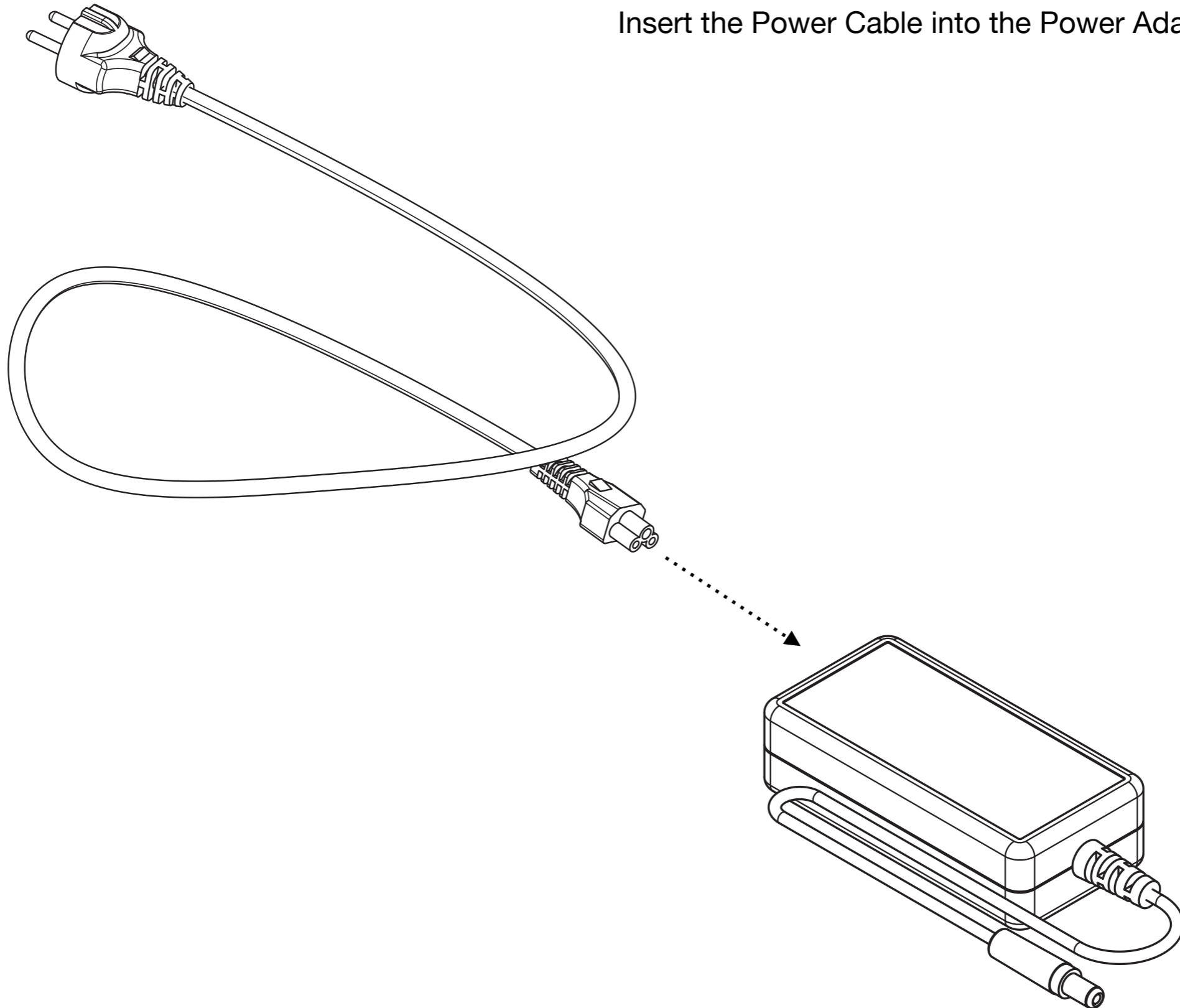

STEP 4

Insert the Power Adapter cable into the power connector.



**CAUTION: USE ONLY A 12V, minimum 3A,
CERTIFIED POWER SOURCE**

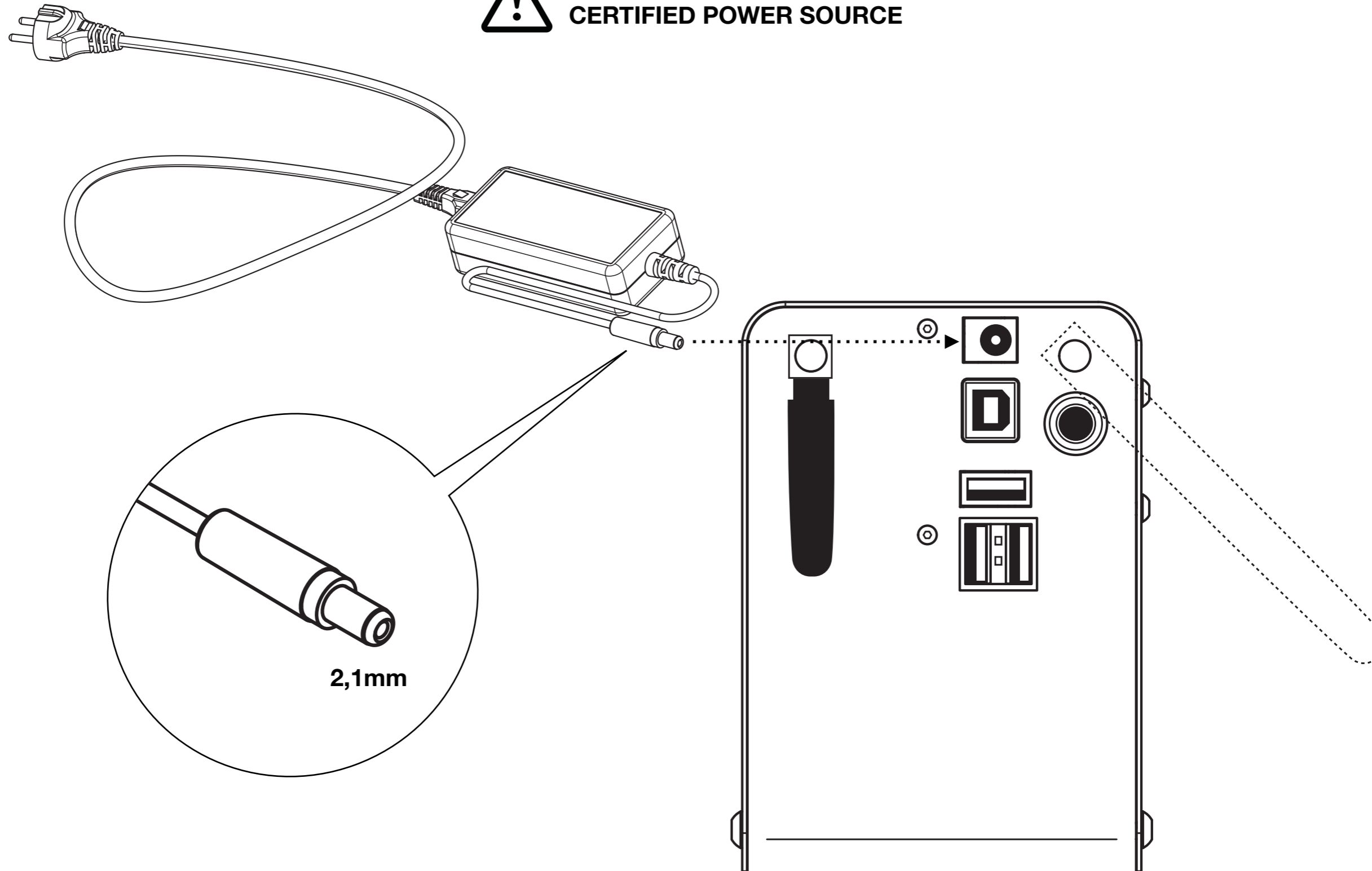

STEP 5

Insert the Power Cable into the Plug

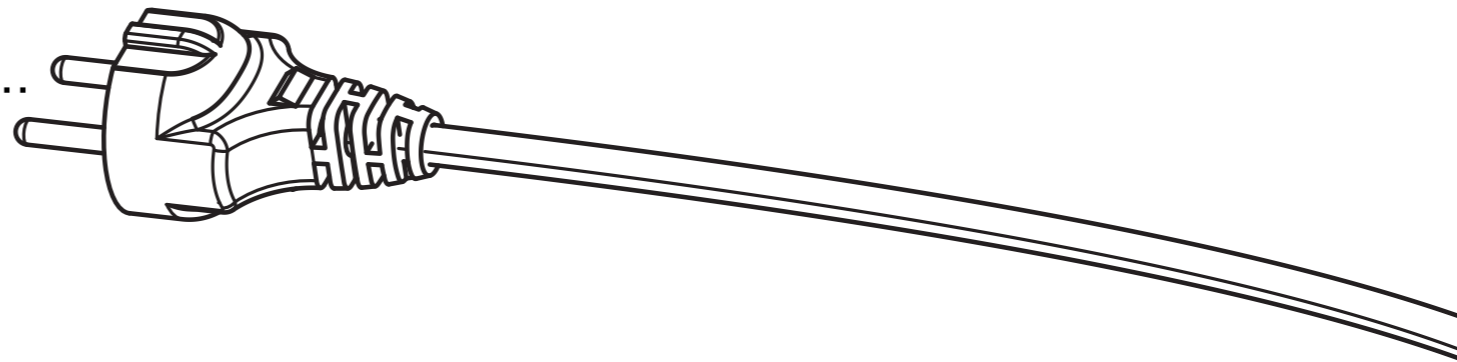
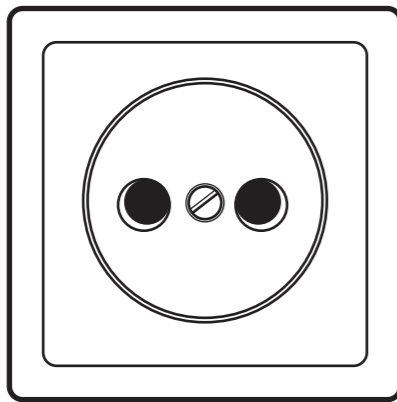

STEP 6

Push the ON/OFF button of the device and wait 1-2 minutes, after which the device will start operating normally

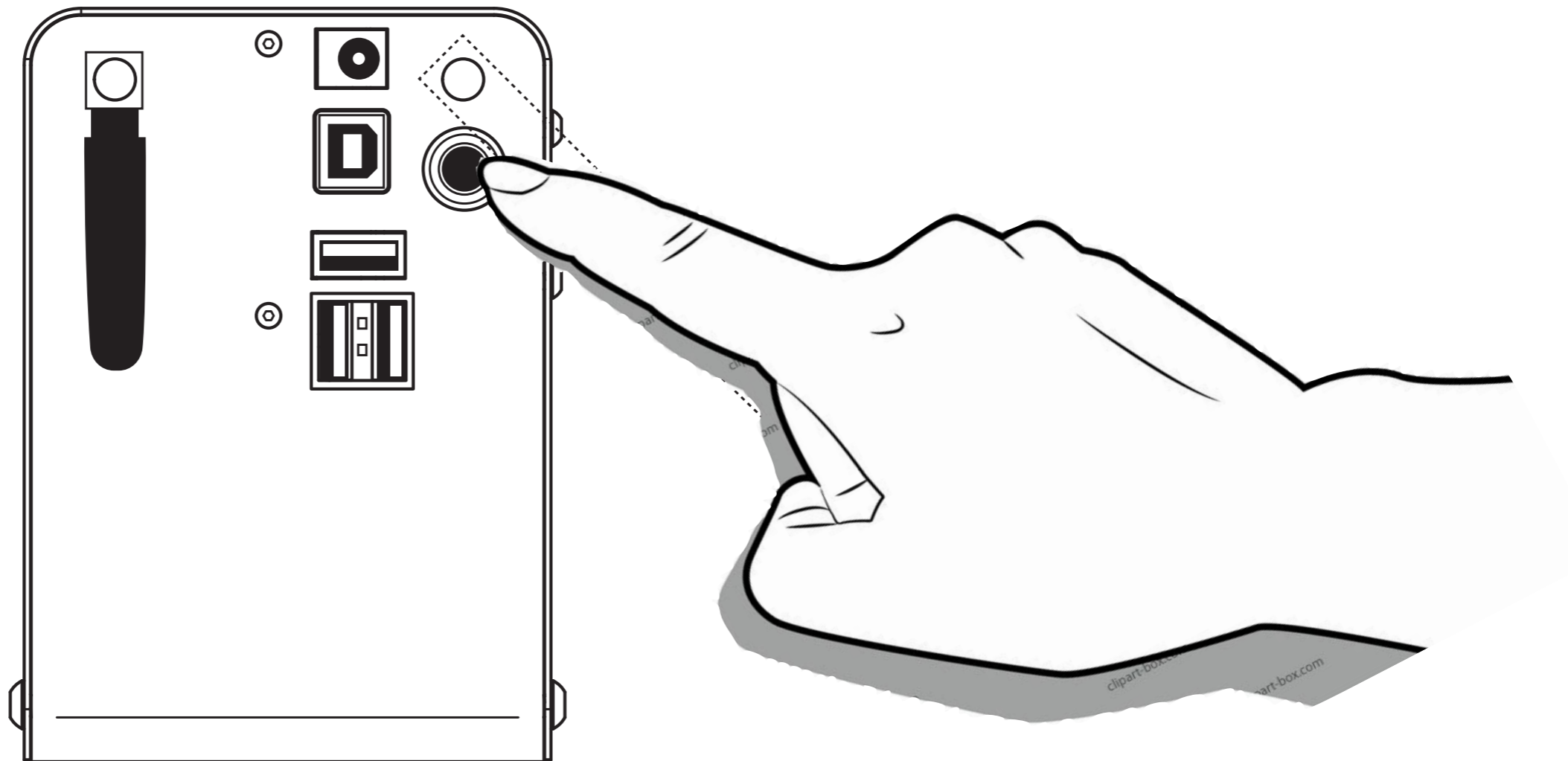

STEP 7 - Shutting down

To shut down the device press the ON/OFF button for 3 seconds, then release.

It will initiate the shutdown sequence.

In case that after more than 30 seconds the device did not shut down, press the ON/OFF button for 6 seconds.

This will do a hard shutdown of the device.

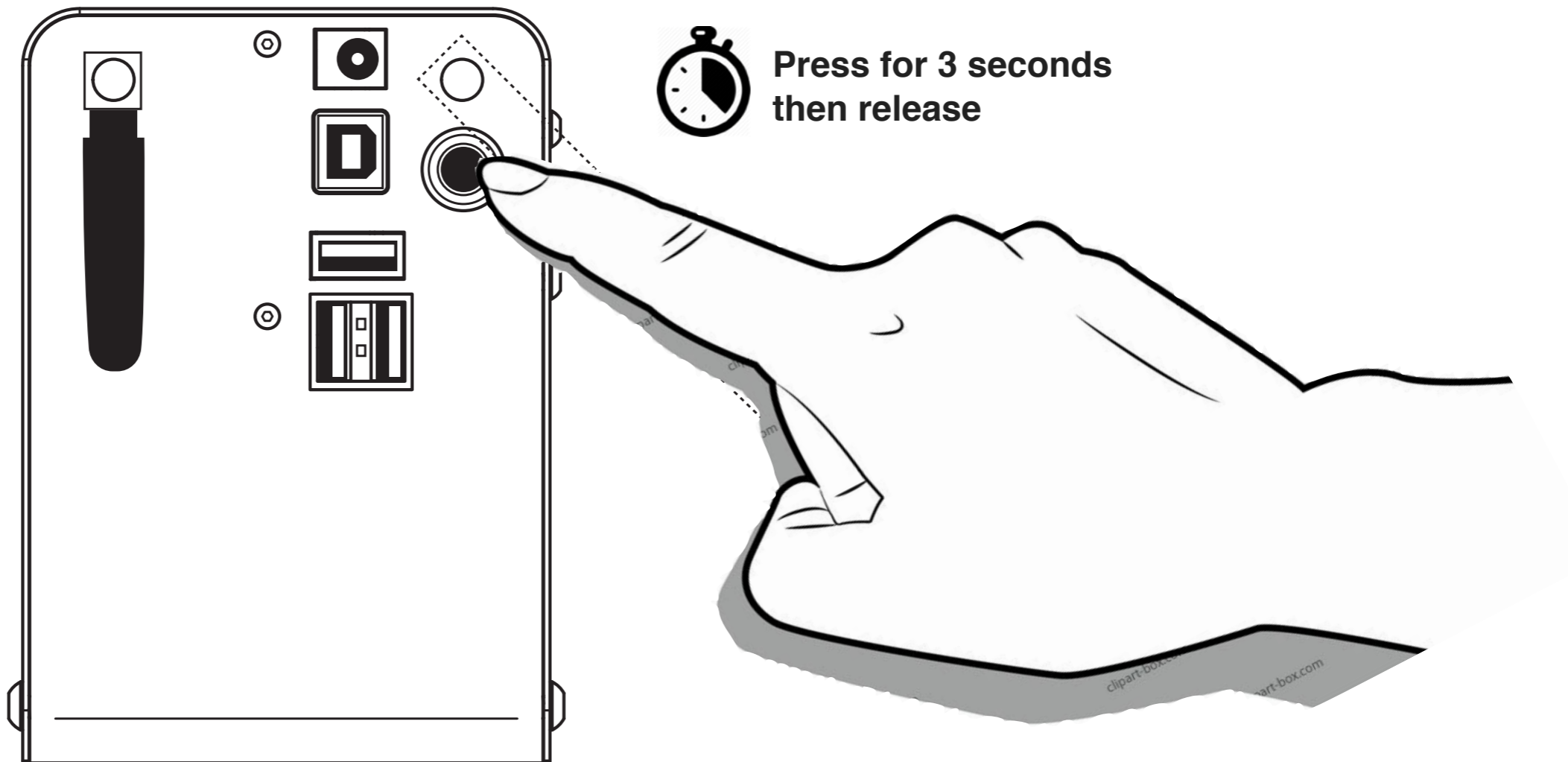

Led Codes

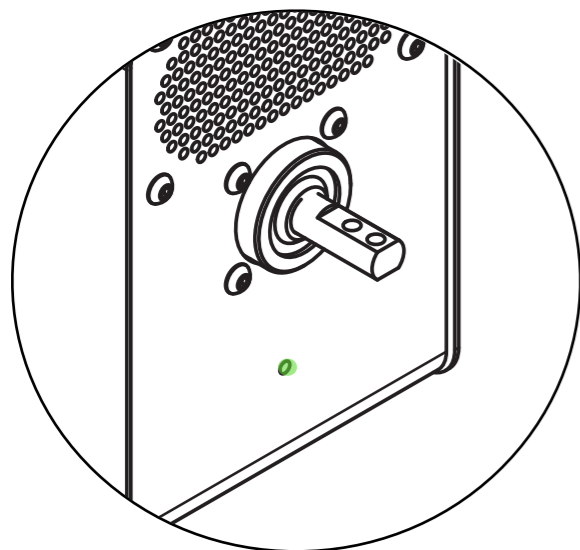

Continuous green

The device works perfectly and it is connected to WiFi

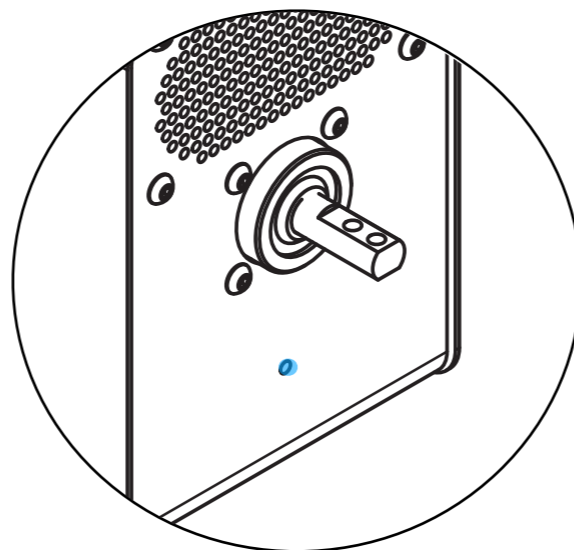

Continuous blue

The device works but it is connected to neither WiFi, nor to GPRS

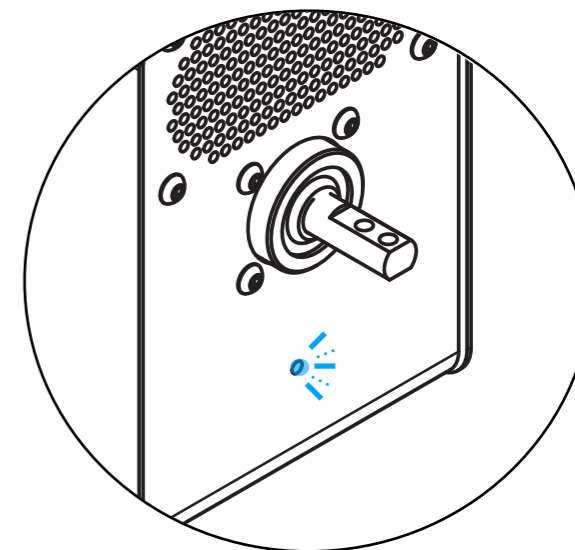

Flashes blue - 3 seconds interval

The device is in sleep mode

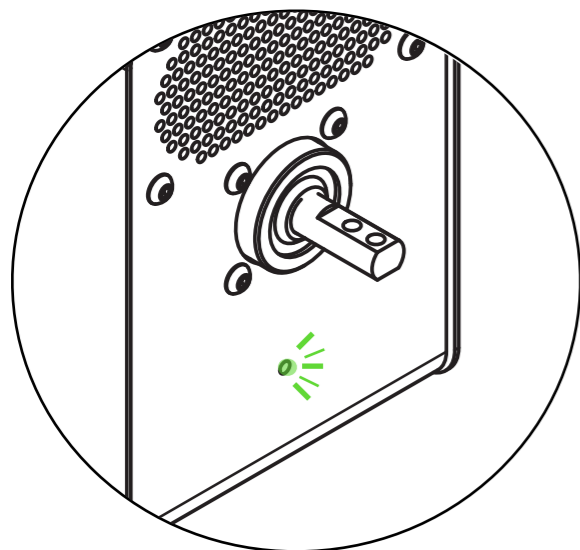

Flashes green

The device works perfectly and it is connected to GPRS

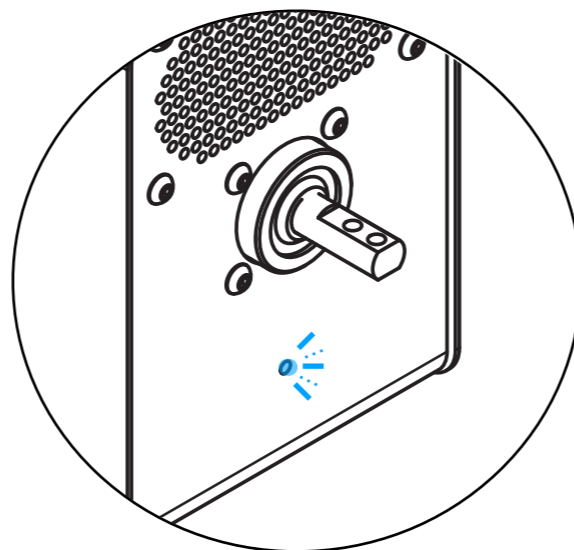

Flashes blue - 1 second interval
The hotspot is active. You have 3 minutes to connect to it via mobile or desktop App

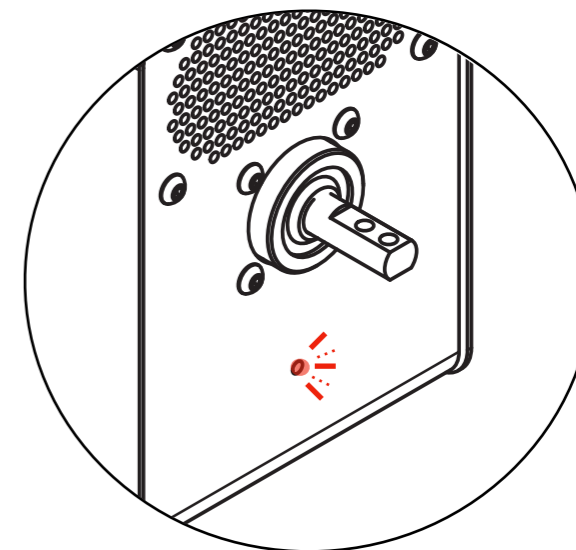

Flashes red

If it flashes for more than 1 minute, it means the device has an issue and you should contact us

Using the Tokinomo Application

- Open Google Play on any Android operated mobile or tablet and search for Tokinomo Mobile
- Open AppStore on iPhone and iPad and search Tokinomo Mobile
- A similar app is also available for MacOS and Windows as a Desktop version



Turn on the device and wait until the led in front starts flashing in the **blue** colour.
It will flash for 3 minutes during which you can connect to the device. If no connection is made, the hotspot created by the device will terminate and normal operation will begin.

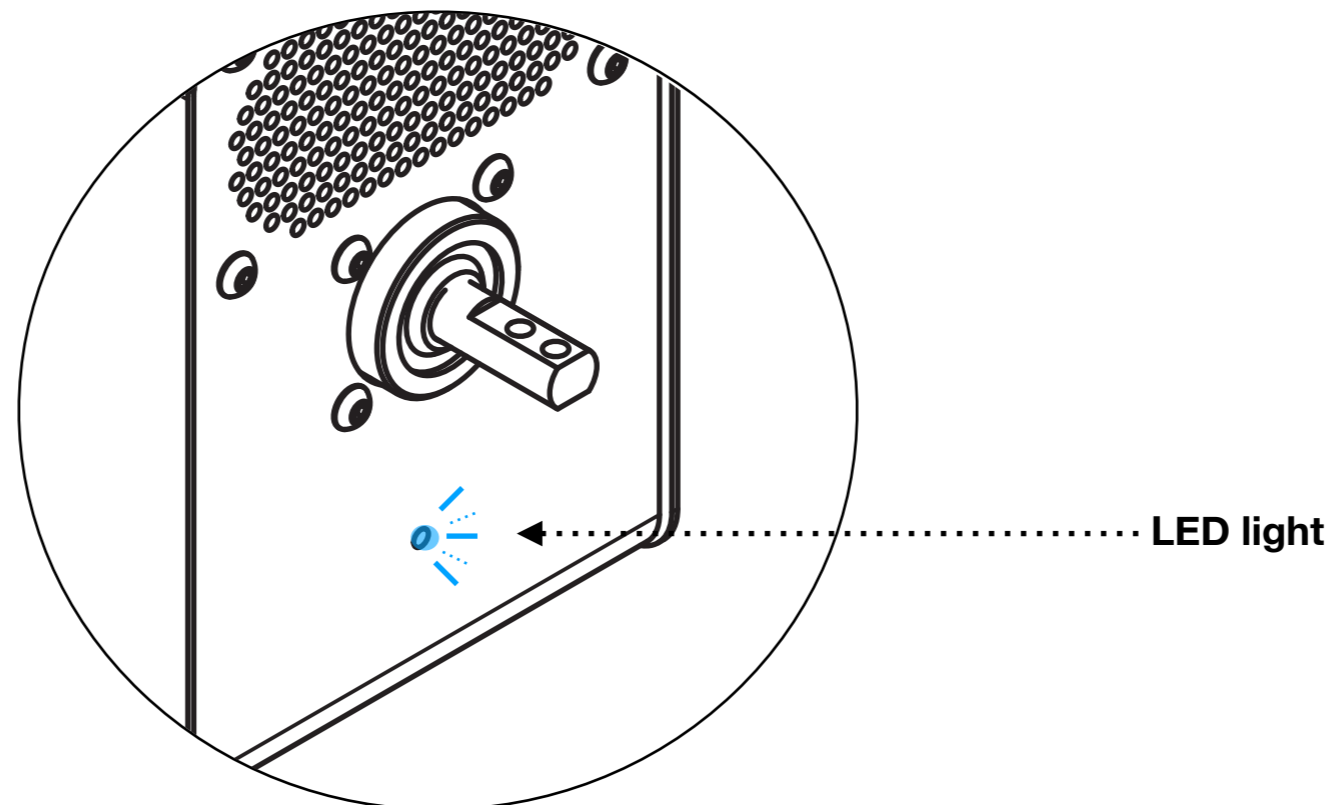



- Open the app
- Turn on the device
- When it starts to flash blue every 1 second, input the device number and press ***“Connect”***



CONNECT TO WIFI

- Select the network you wish to connect to
- Input the password of the network
- Press ***“Send to Device”***
- If successful the front led will become green

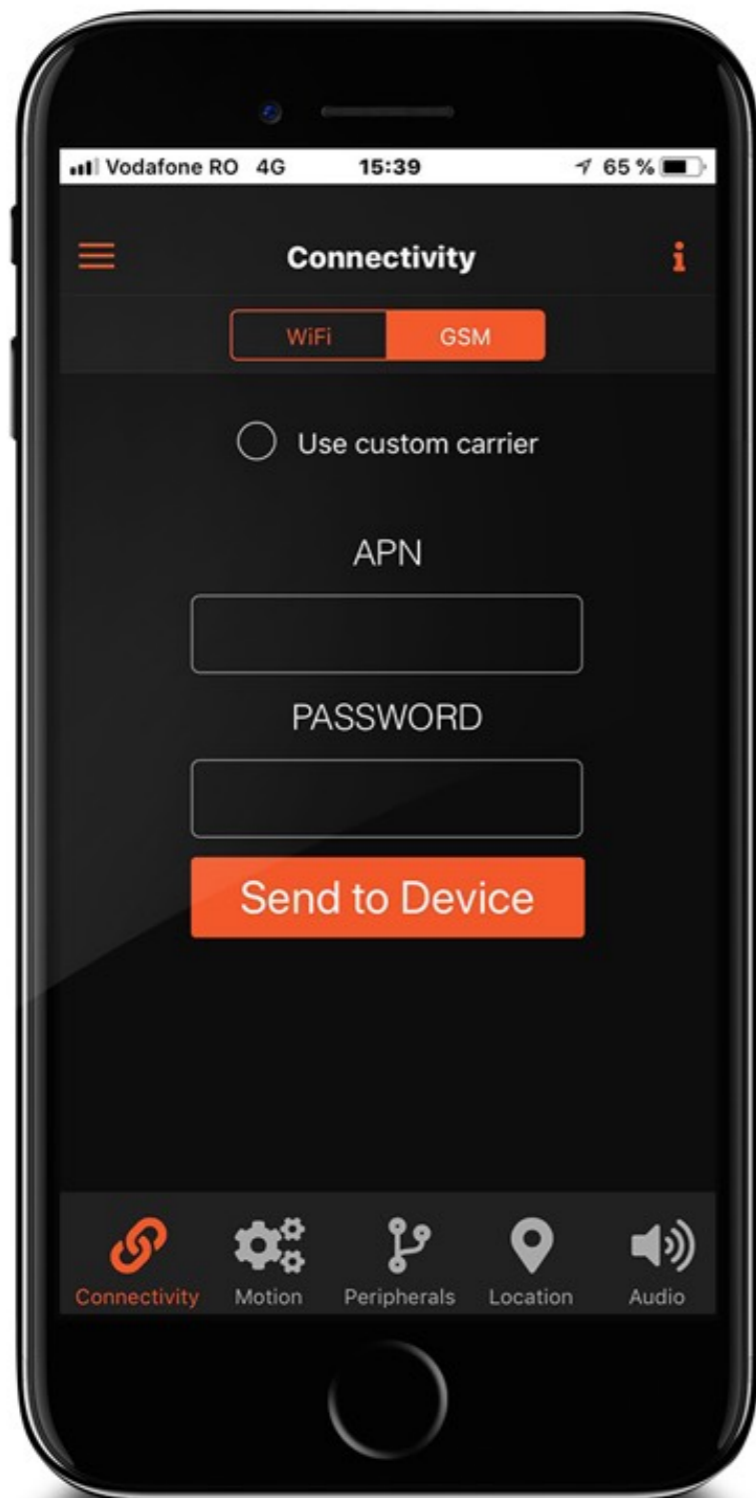

CONNECT TO GSM/GPRS

- In case you wish to use a custom carrier select ***“Use custom carrier”*** (make sure you inserted the sim first into the device - see page 41)
- Input the APN of the carrier
- Input the password of the carrier
- Press ***“Send to Device”***
- If successful the front led will flash in green

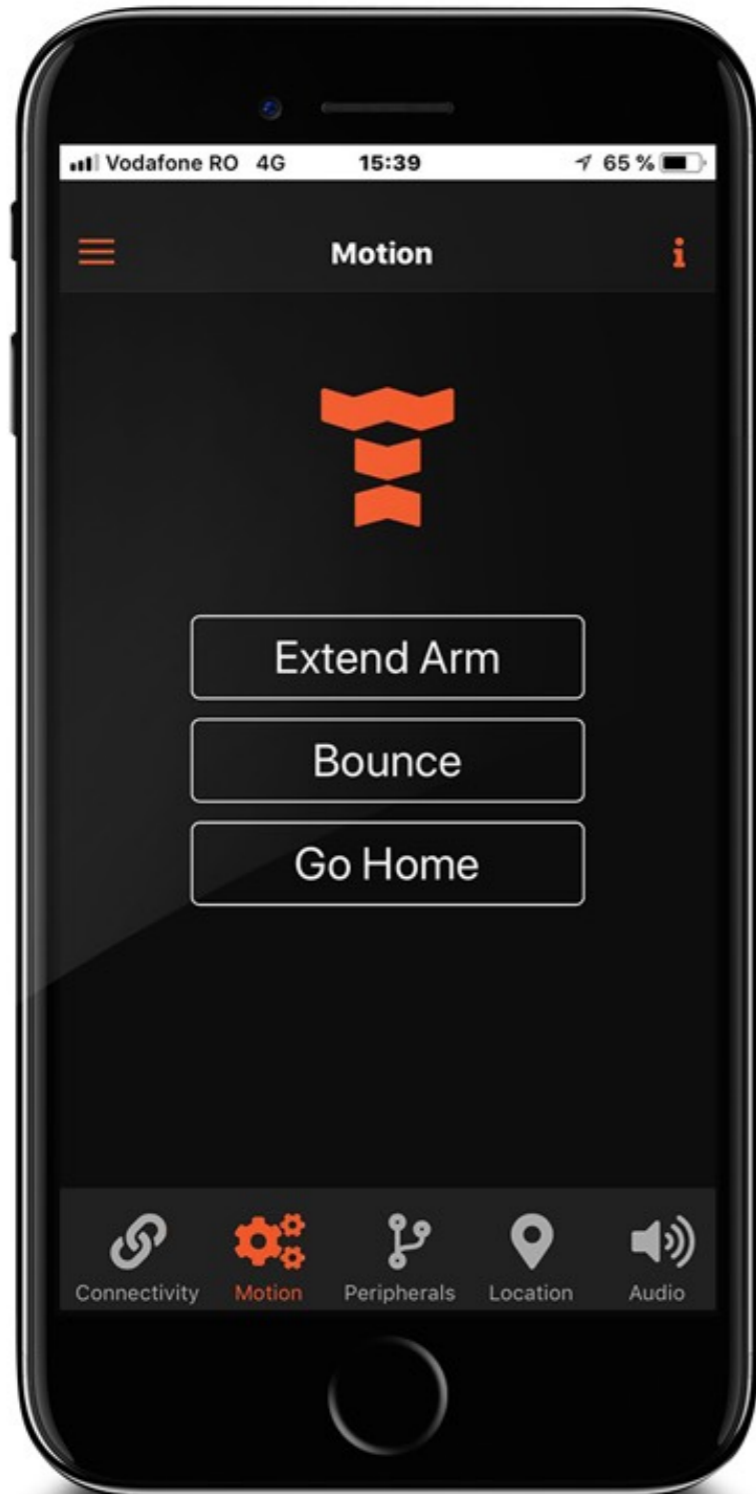

TESTING THE MOTION

- Press “**Extend Arm**” - the arm will extend and stop
- **Bounce** - the arm will go back and forth
- **Go Home** - The arm will go in home position (the product will be on the shelf again)

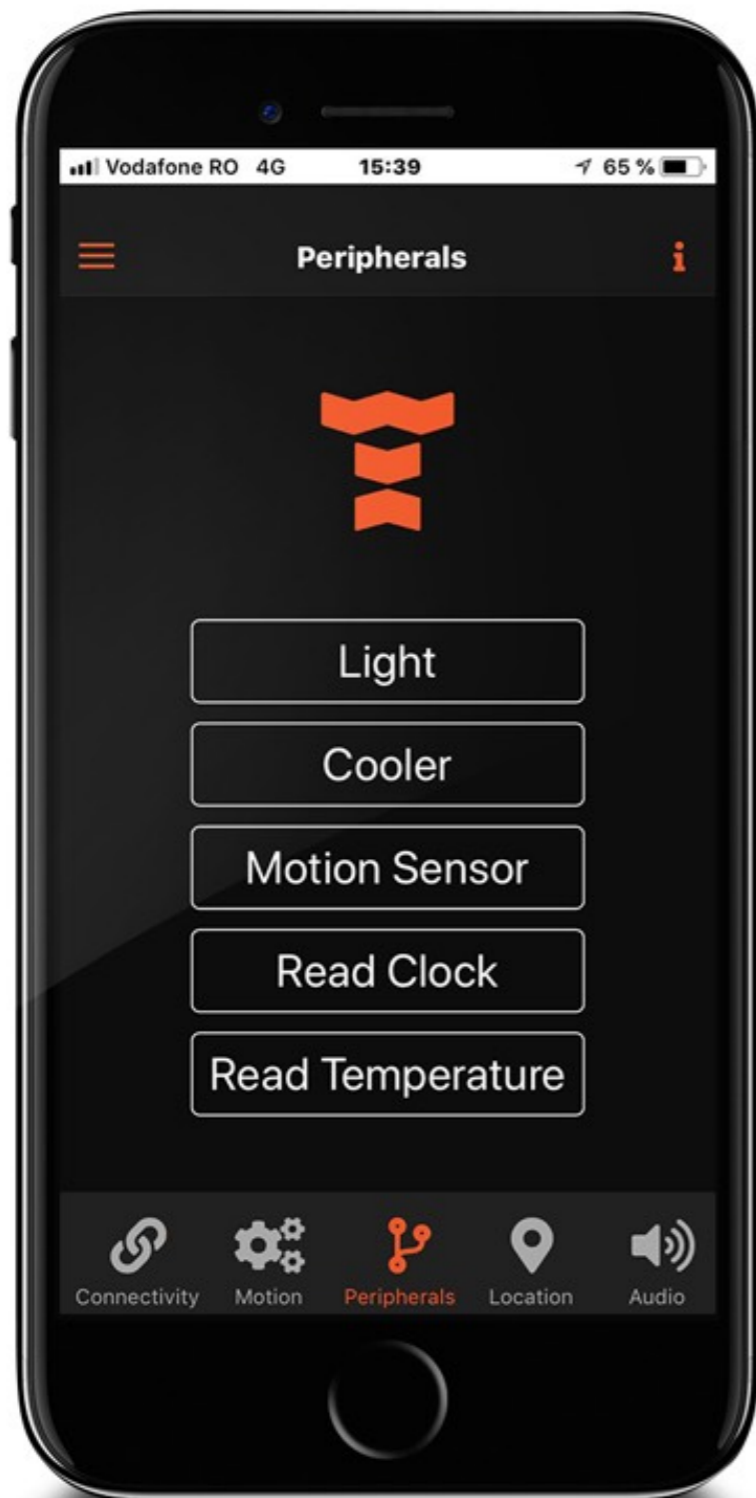

TESTING THE PERIPHERALS

- Press “**Light**” - the Magnetic Led Lamp will be lit
- **Cooler** - the cooler will start spinning
- **Motion Sensor** - you may check if the motion sensor works or not
- **Read Clock** - you can read the time on the device and check if it corresponds to your timezone
- **Read Temperature** - reads the inside temperature (below 50°C is OK)

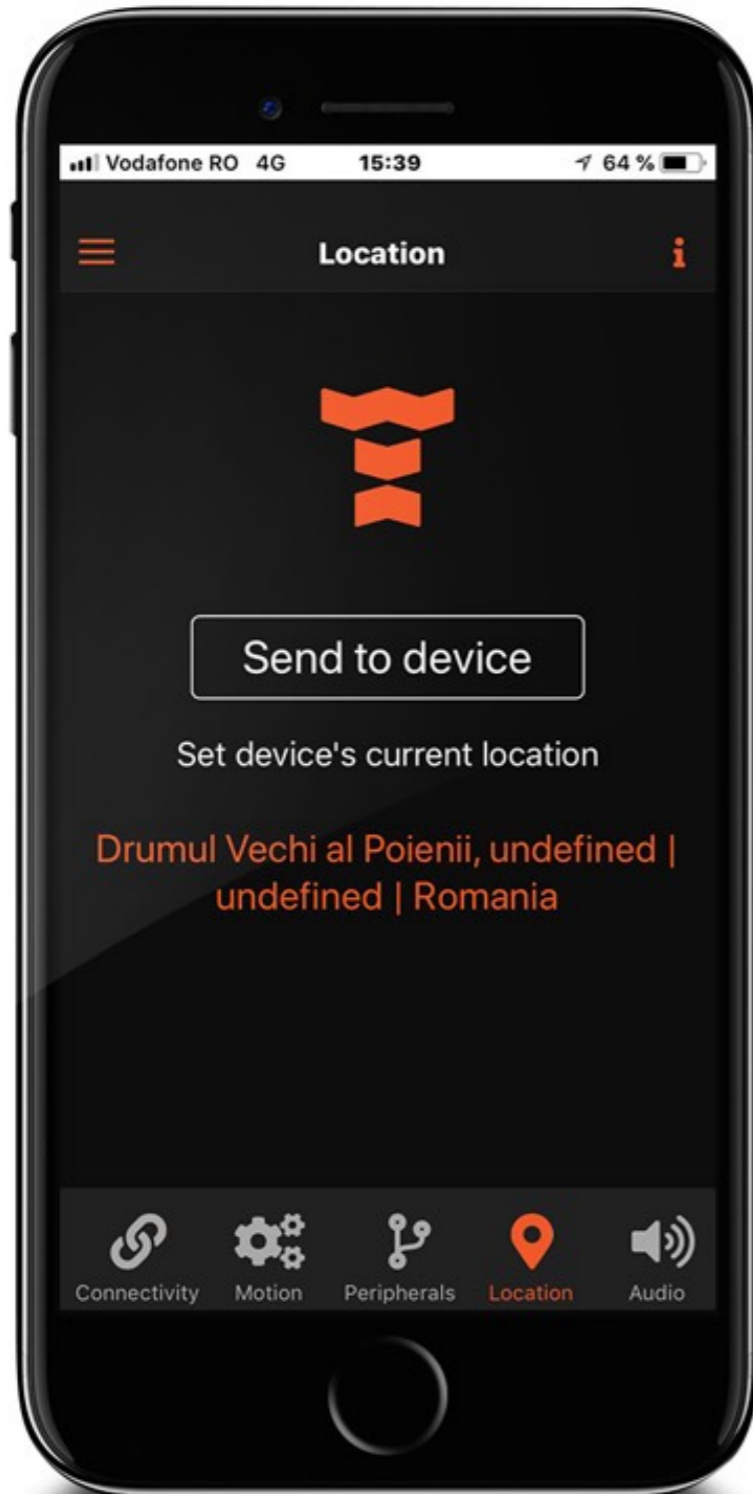

PIN POINT THE LOCATION

- When you are about to install a certain device in a specific store it may be useful to know its whereabouts, especially when you are dealing with multiple devices
- When **“Send to device”** is pressed, the device will know its location and will send it automatically to the Tokinomo Cloud.
- Therefore it will be very easy to know exactly what device is at which location.

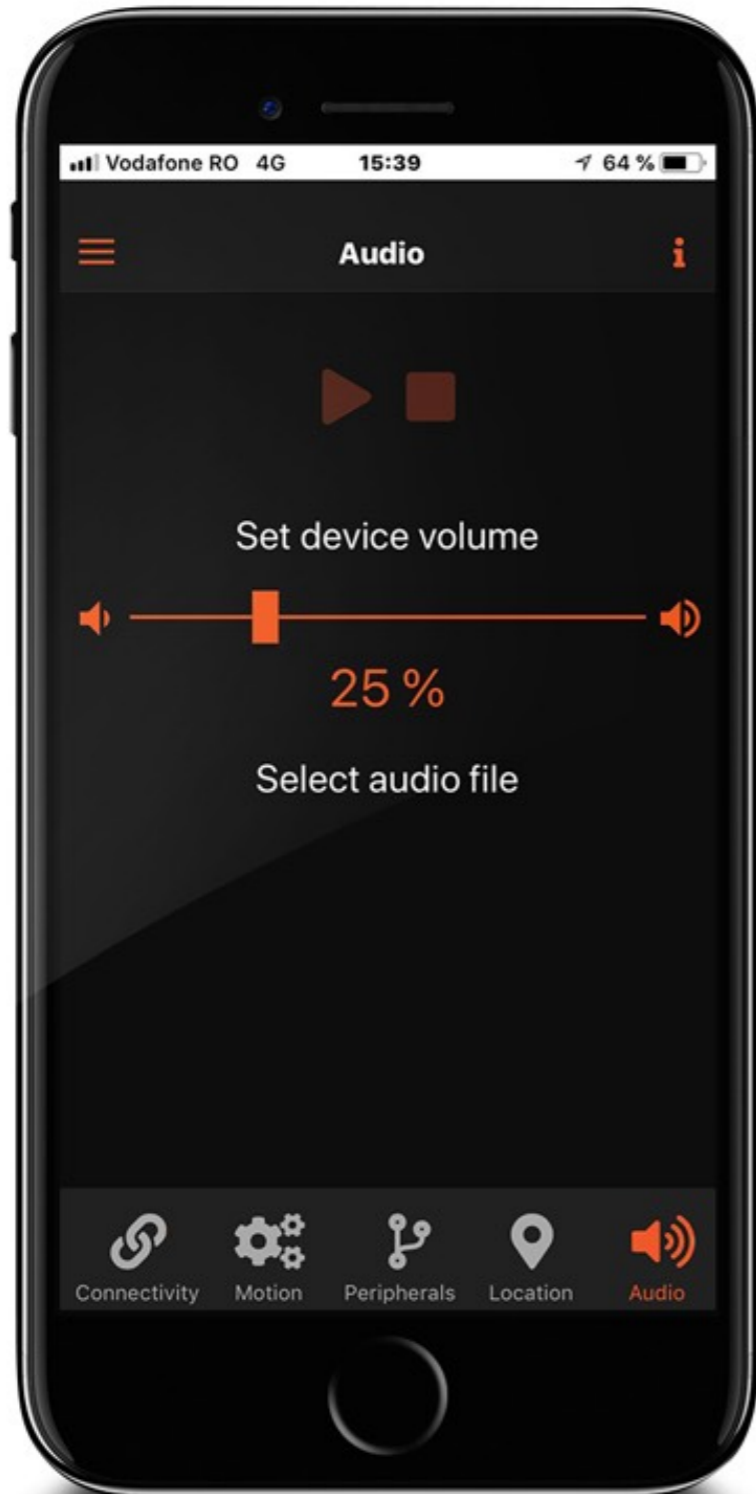

AUDIO

- When you are about to install a device in a store it may be useful to set the appropriate volume level which specifically suits that particular location.
- You may set the volume level interactively in real time from this tab
- You may also check if the correct audio files have been downloaded and they are not corrupted

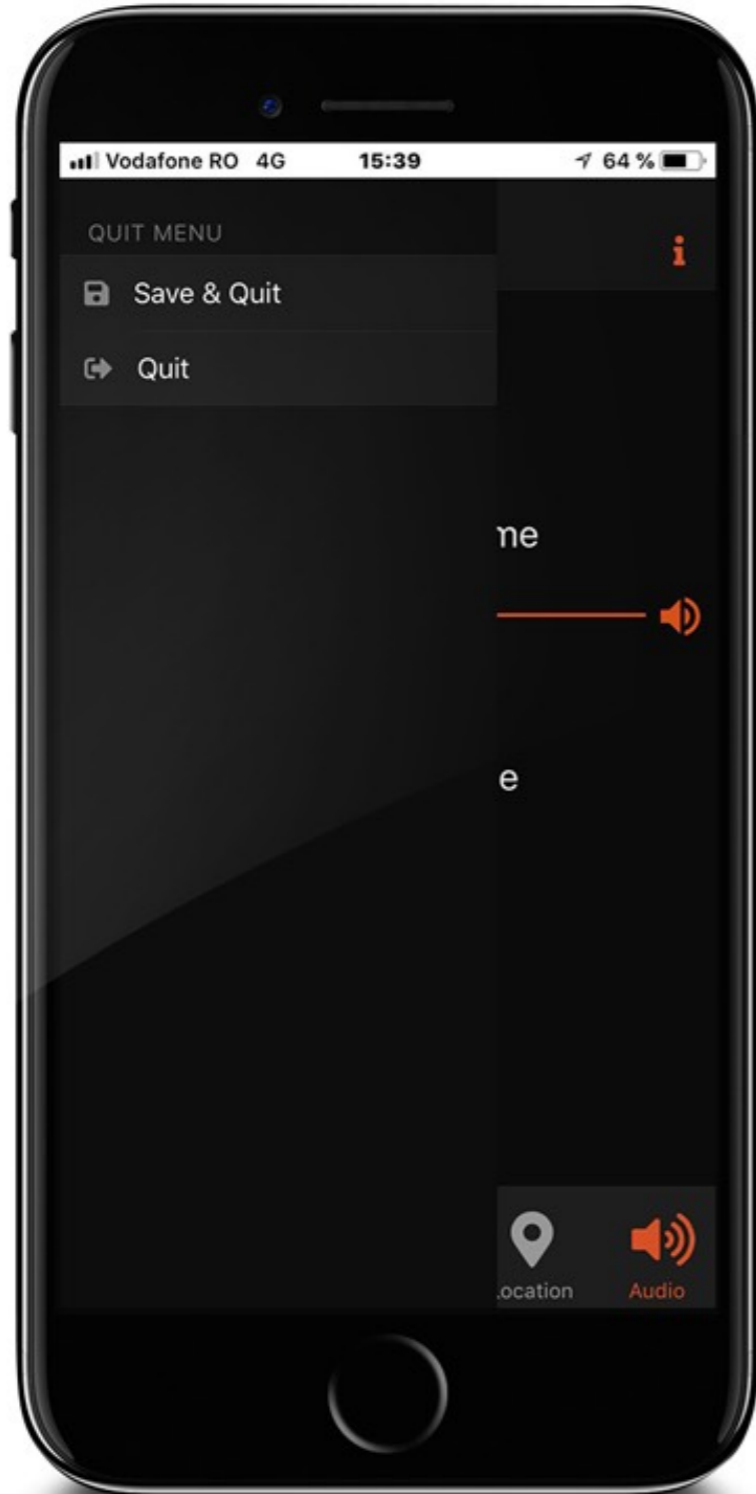

SAVING SETTINGS

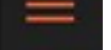
- Press the 3 lines on the top-left side 
- If you wish to save the changes you've made, press "**Save&Quit**"
- If you wish to disconnect without saving, press "**Quit**"

Debugging&Maintenance

In this chapter you will learn how to perform basic maintenance operations.

In case the Tokinomo technicians instruct you to open the case, you may do this by using a 2,5 hex key to unscrew the 4 screws of the lid.

The cooler wire is attached to the lid. Gently slide the lid so that you do not damage it.

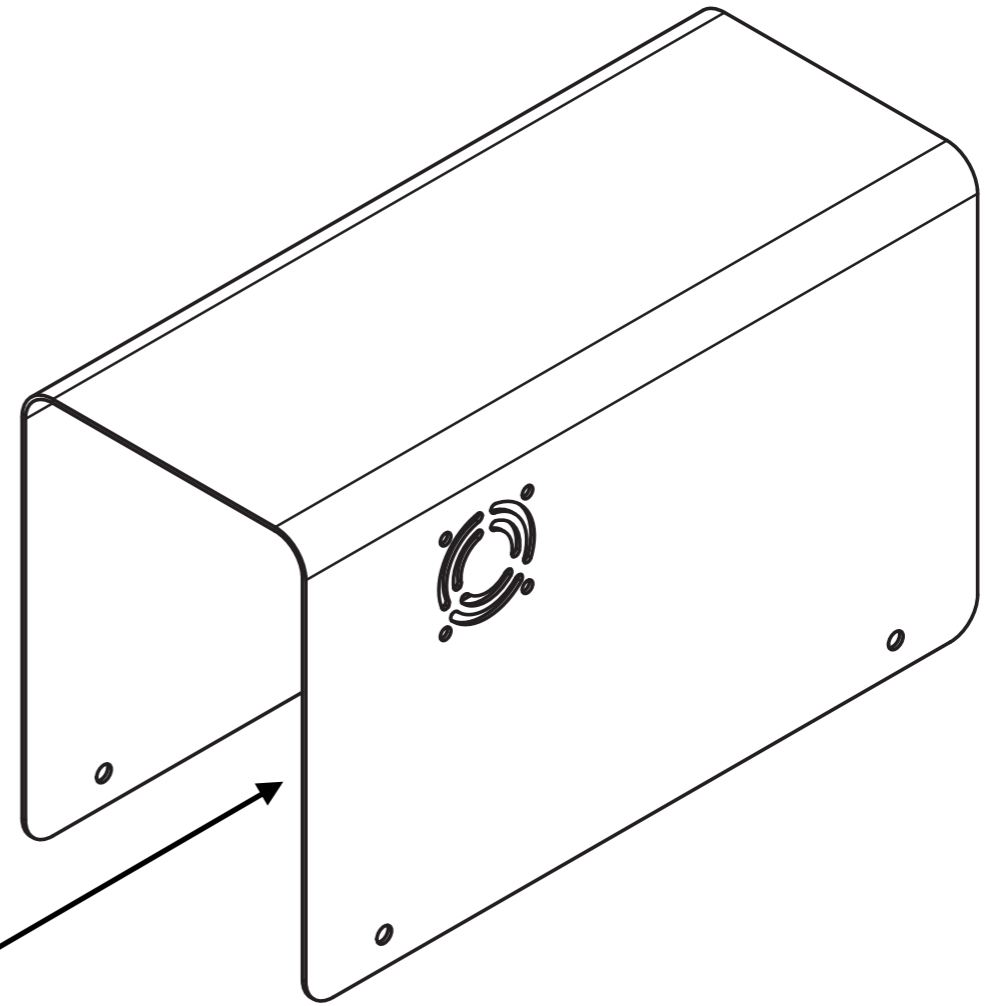
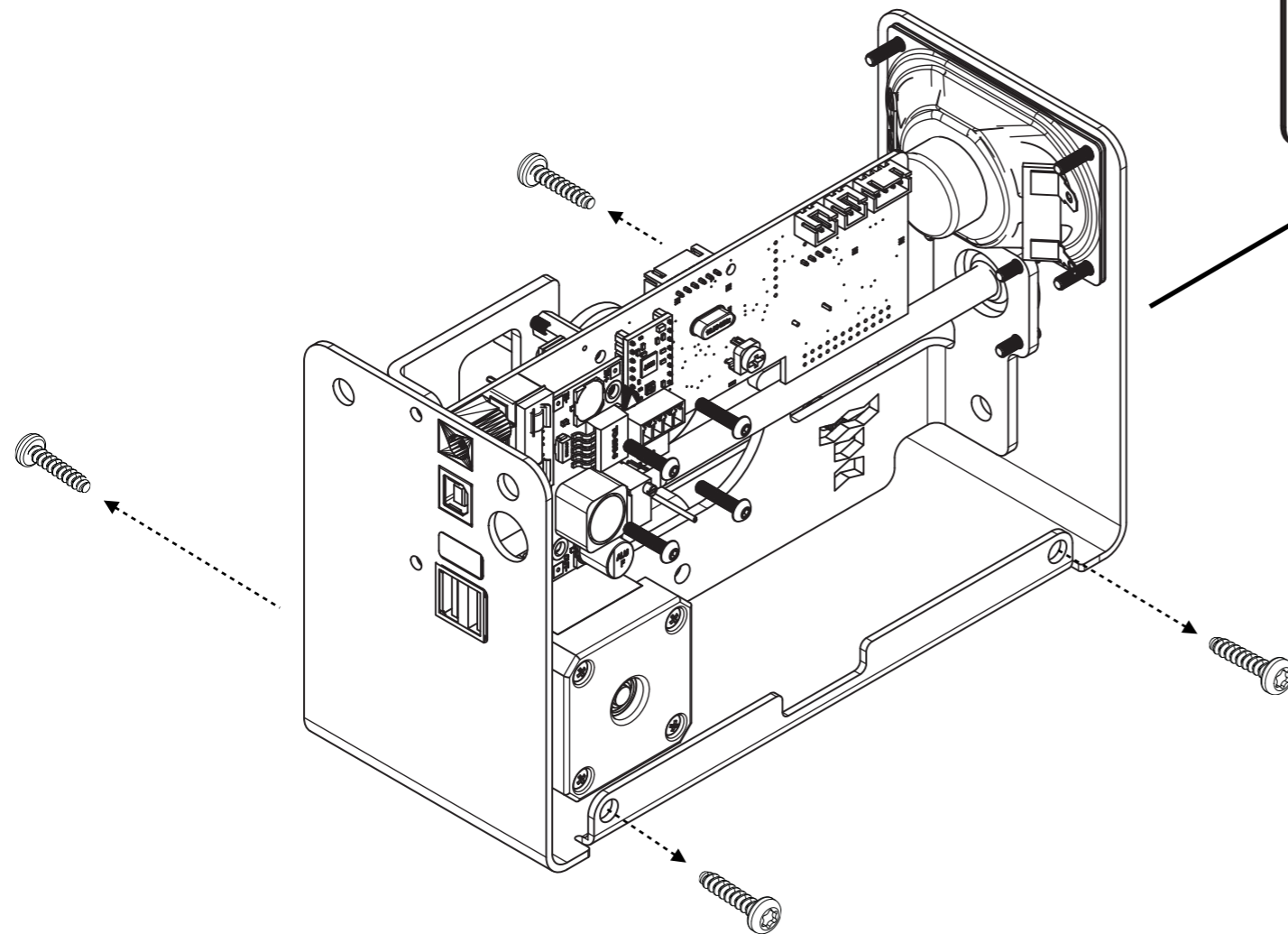

2,5 Hex key



You may need to insert a new MicroSD card. Do it like in the illustration below.

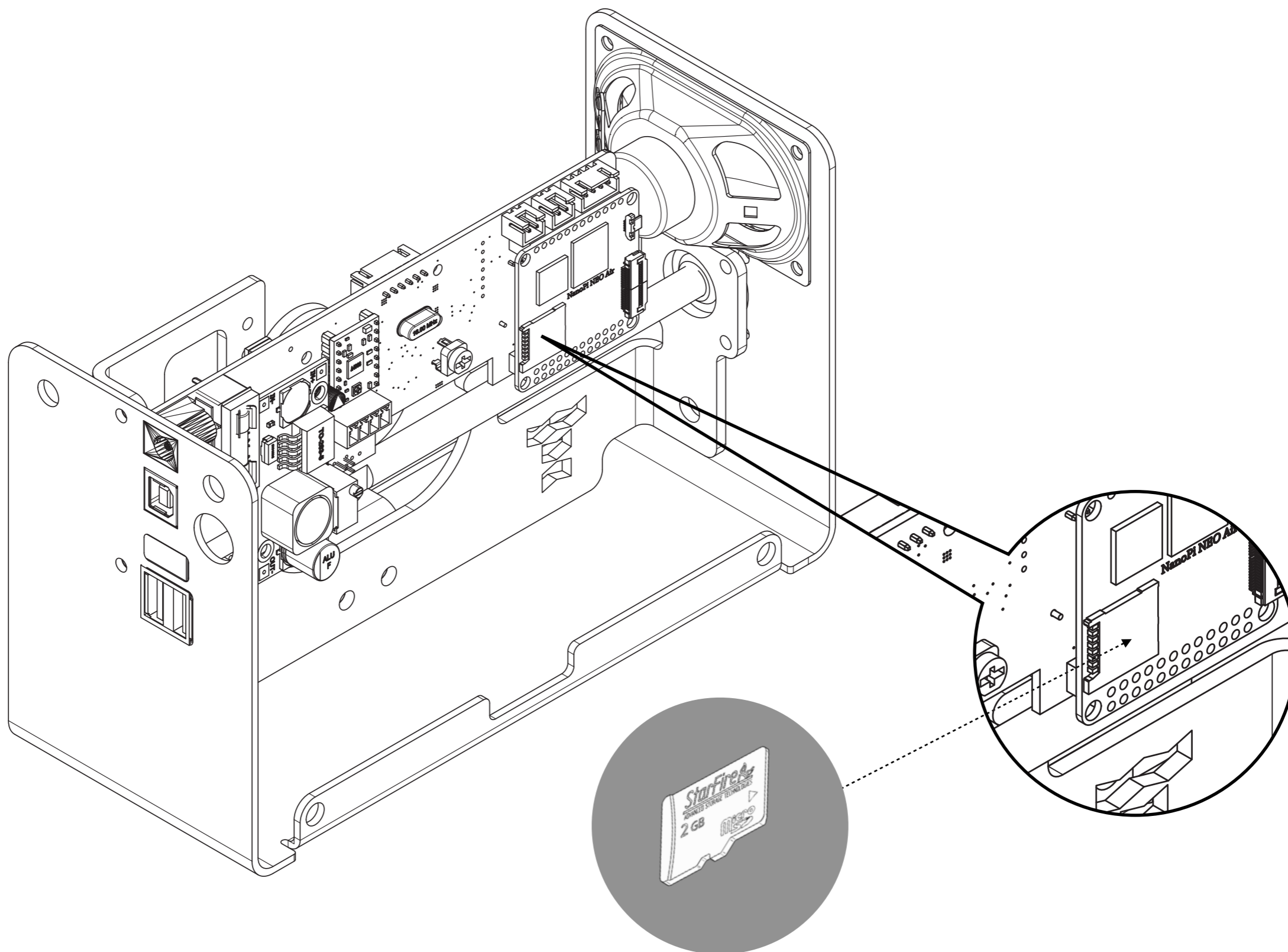

You may need to insert a new Sim card into the GPRS modem.
Do it like in the illustration below.

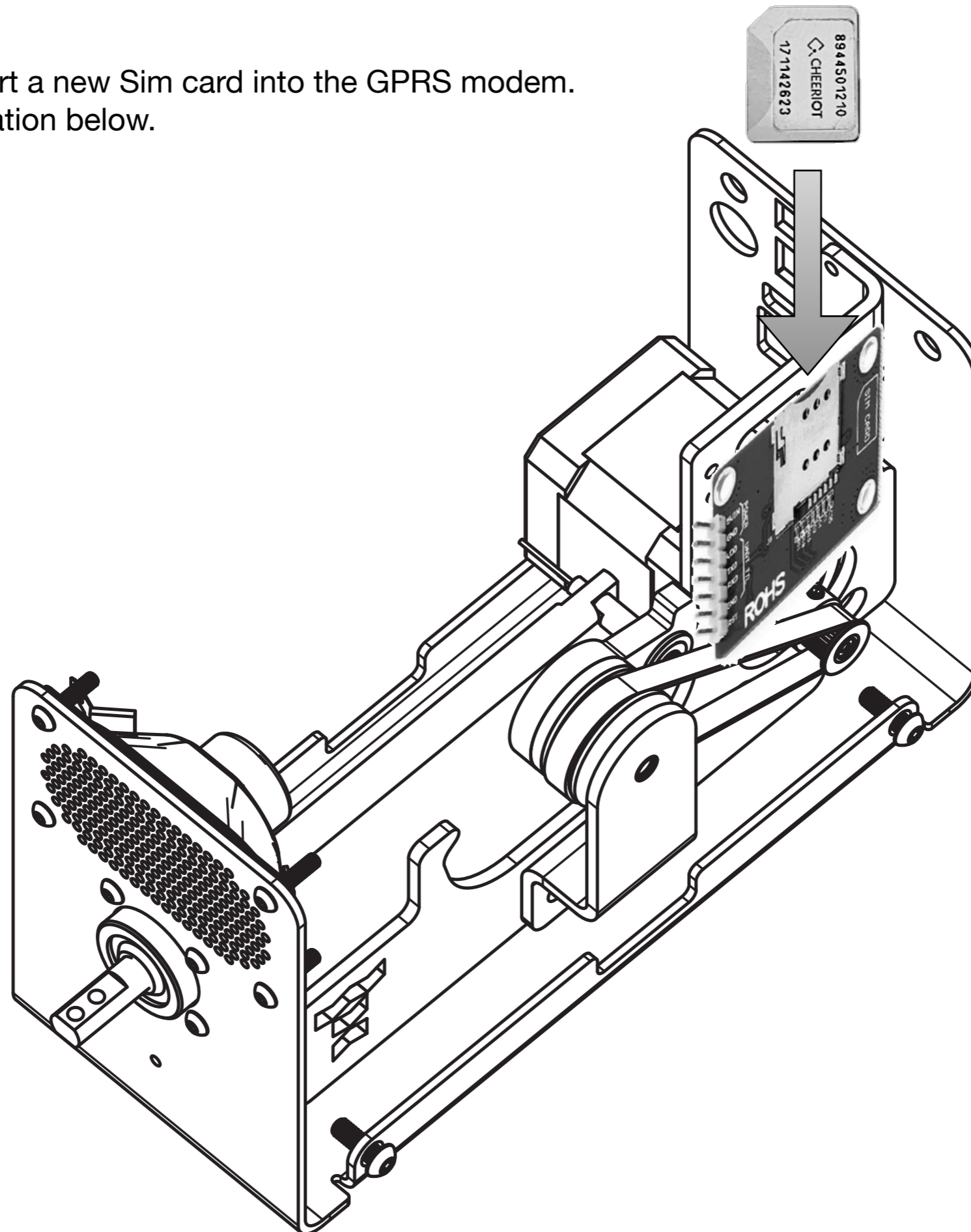

In time, the transmission belt may loosen. You can tension the belt by moving the motor 1 or 2mm to the back of the device. Un-tight the 2 Phillips screws, move the motor and tight the screws back.

Make sure not to over-tight it. You may check by manually moving the arm of the device.

If the belt is too tight, the belt will slide little by little to the left, touching the small pulley's flange. If the belt is tensioned correctly, the belt will stay parallel, not touching the flange of the pulley.

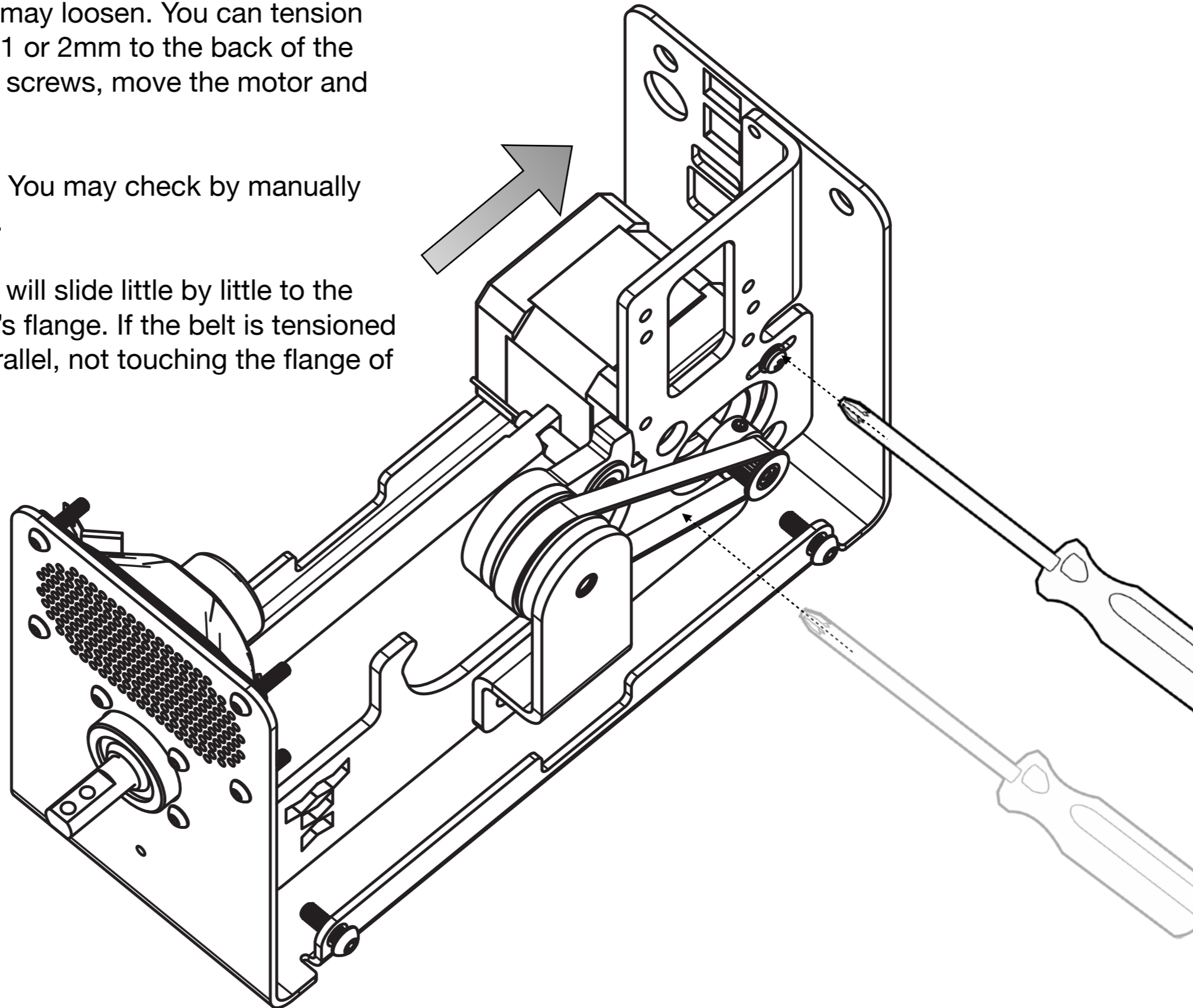

In case the Tokinomo technicians will tell you to change the motor driver, look for the purple little component. Using your thumb and index fingers, gently pull the old driver and replace it with the new one (provided by Tokinomo).

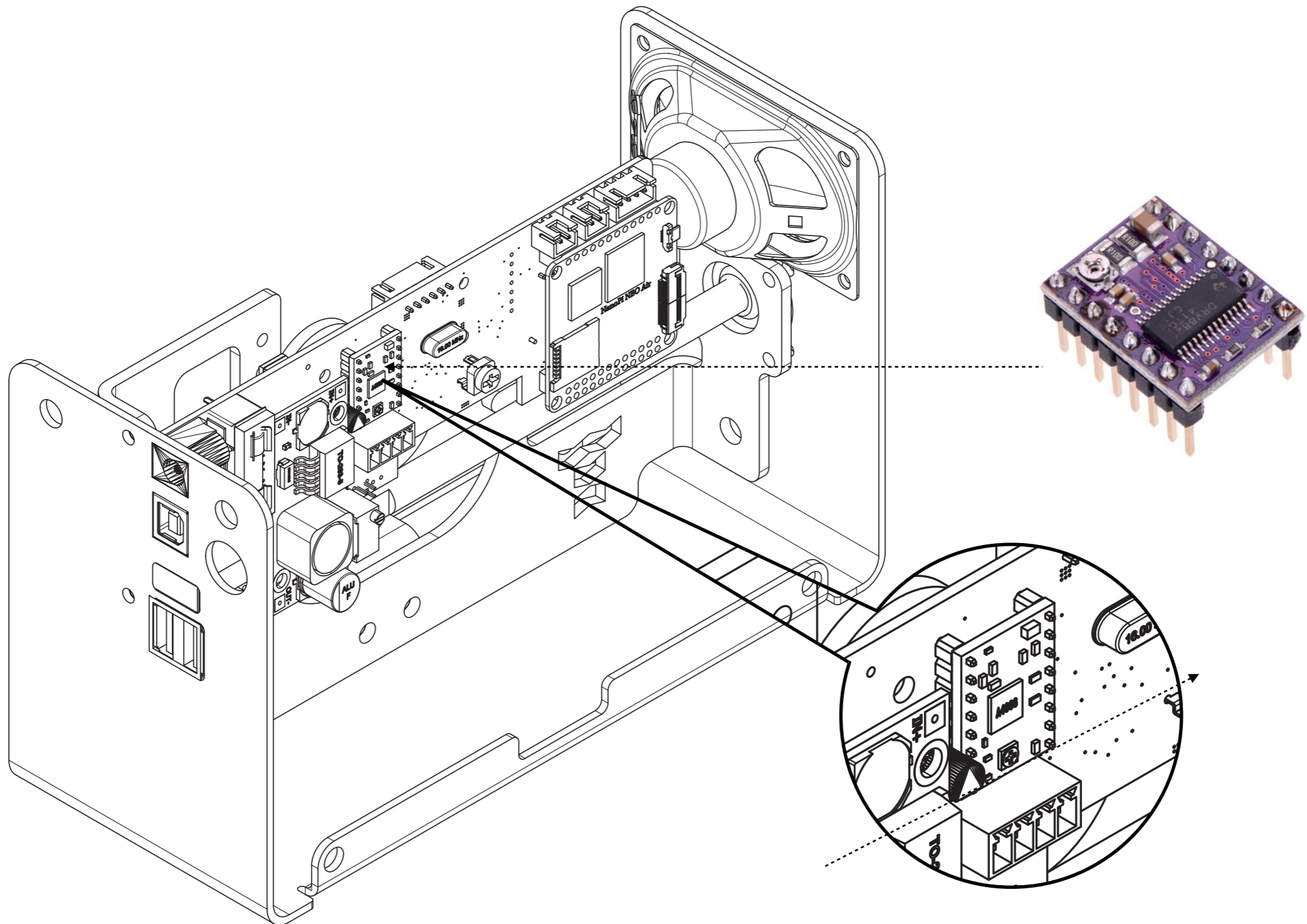

When done, slide the lid from front to back.
Tight the screws back using the same 2,5 hex key,



DO NOT ATTEMPT TO PUT THE LID FROM THE TOP AS IT MAY DAMAGE THE CONNECTORS

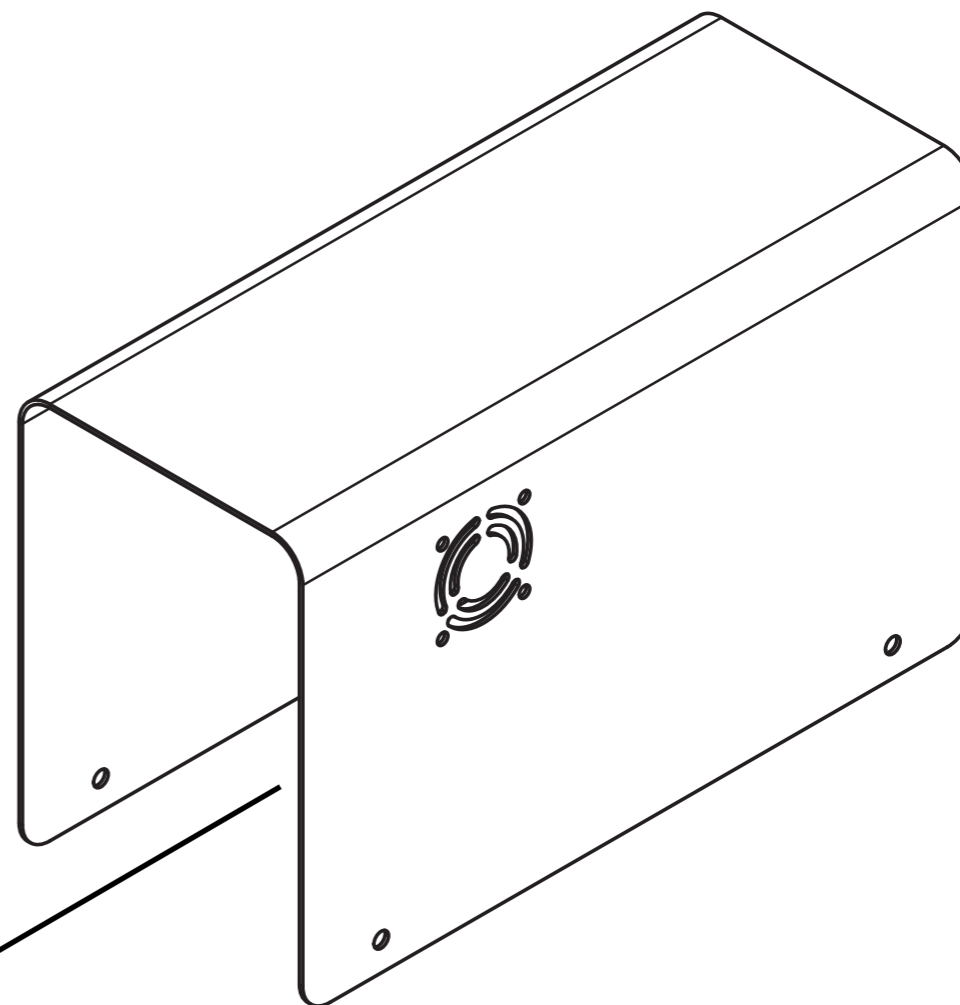
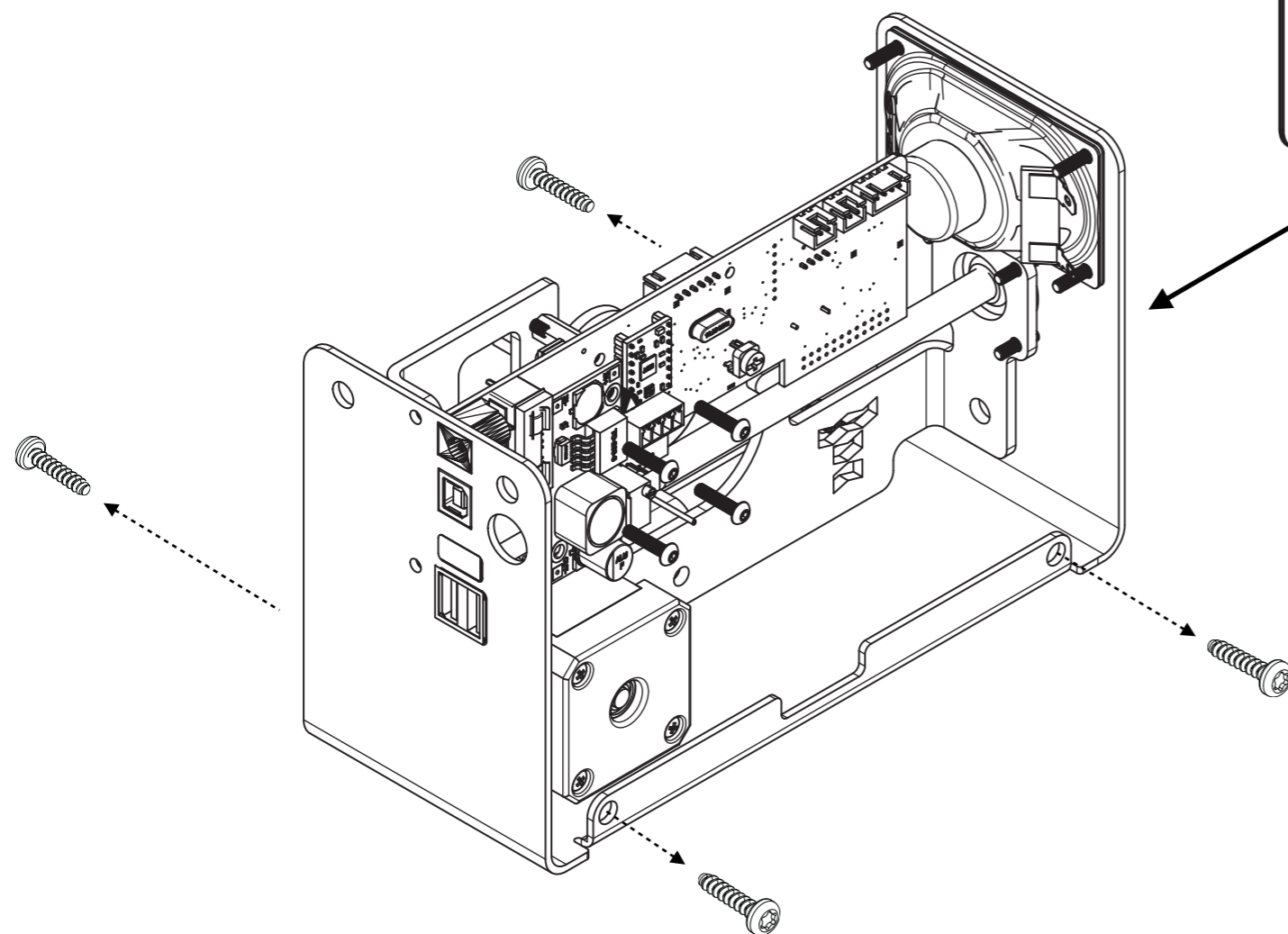

2,5 Hex key

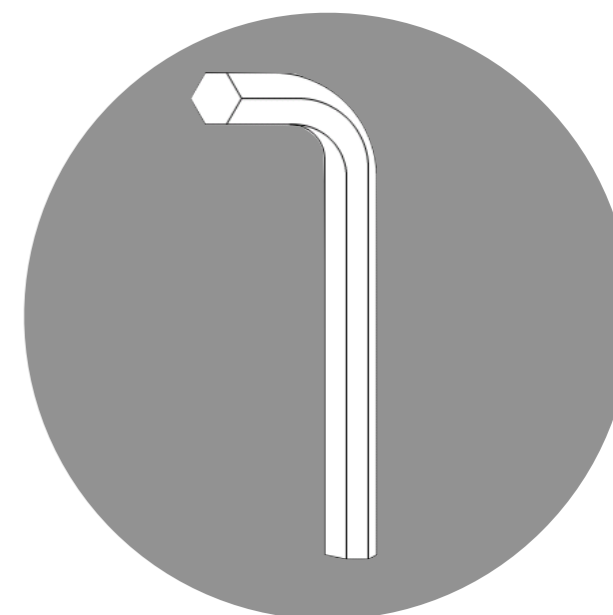



THANK YOU AND GOOD LUCK!

TOKINOMO MARKETING SA
42-44 Despot Voda Street, 4th floor, Apt.11, 2nd district,
PO 020656, Bucharest, Romania
hello@tokinomo.com

2021 © All rights reserved. This document is the property of Tokinomo Marketing SA and all the informations contained in it are confidential. They are to be used only for the purpose of operating the Tokinomo devices and are not to be distributed to third parties, except for the strict purpose of legally and safely operating the Tokinomo devices during demos and campaigns.