

CD Stereo Shelf System

Model No. CD25



User's Manual & Quick Start Guide

5-Year (Extendable to 6 Years) Warranty & USA-Based Tech Support

For tech support, email us at: support@soundbeast.rocks

Extend your warranty to 6 years for free by registering at:
www.SoundBeast.rocks/register/

SOUNDBEAST®
www.SoundBeast.rocks

Table of Contents

Warranty Information	2
Safety Warnings & Precautions	4
Device Diagram	6
Quick Start Guide	8
Troubleshooting	15
Technical Specifications	17
Need Further Assistance?	18

Warranty Information

Browse All of Our Products!

If you're looking for fun, unique, and easy-to-use technology, we've got it! Please visit our website to browse all of our products: www.SoundBeast.rocks

5-Year Warranty

Your purchase comes with a **5-year warranty**. This means that if anything goes wrong with the unit (other than accidental damage on the part of the end user) within the first five years of ownership, we will exchange the unit for free – 100% at *our* cost.

Contact us at Support@SoundBeast.rocks with any issues.

Extend Your Warranty To 6 Years For FREE!

Get a FREE extra year of warranty just by registering your product at: www.SoundBeast.rocks/register/



What's in the Box?

- CD Stereo Shelf System
- Power Cord
- Remote Control
- User Manual

Safety Warnings & Precautions

Safety Warnings

- **Electric Shock Hazard:** Do not open the product's case. There are no user-serviceable parts inside. Refer servicing to qualified service personnel.

	The presence of a lightning flash with an equilateral triangle warns of uninsulated dangerous voltage inside the product that could cause an electric shock.
	The exclamation point within a triangle indicates important operating and maintenance instructions.

- **Avoid Blockages:** Do not block any ventilation openings. Install in accordance with the manufacturer's instructions.
- **Moisture and Liquid Hazards:** Avoid using or storing the device in humid places or areas prone to water splashes. Never place the device in bathrooms or similar damp environments.
- **Laser Radiation:** This unit contains a laser component. Do not open the CD compartment lid or defeat safety interlocks as it may expose you to dangerous laser radiation. Avoid direct eye exposure to the laser beam while it is operating.
- **Handling Optical Media:** Handle discs carefully by their edges to prevent damage. Only use discs that are clean and free from scratches. Never attach labels or stickers to discs.
- **Excessive Volume:** To prevent possible hearing loss, do not listen to this device at high volume levels for long periods of time.

CLASS 1 LASER PRODUCT
LUOKAN 1 LASERLAITE
KLASS 1 LASERAPPARAT



- **Digital Audio Symbol:** When using this device, use only compact discs (CDs) with the following symbol:



Safety Precautions

- **Read and Retain Instructions:** Always read and keep the safety and operating instructions for future reference.
- **Installation Requirements:** Install the product following the manufacturer's guidelines. Avoid placing the product in areas exposed to direct sunlight, extreme heat, excessive dust, or near any water source.
- **Ventilation:** Ensure the product is well-ventilated. Avoid covering ventilation openings with any items that could restrict airflow.
- **Power Sources:** Operate the product only from the power source indicated on the device. If unsure about your home's power supply, contact a professional.
- **Power Cord Safety:** Place power cords where they will not be walked on or pinched by objects. Always grasp the plug, not the cord, when disconnecting from an outlet.
- **Heat Sources:** Keep the product away from heat sources such as open flames, radiators, stoves, or other equipment that generates heat.
- **Water and Moisture:** Do not use this product near water or expose it to rain or moisture.
- **Object and Liquid Entry:** Prevent objects and liquids from getting inside the product. Do not place objects filled with liquids, like vases, on or near the product.
- **Battery Safety:** Handle batteries carefully by following the product instructions. Remove batteries if the device will not be used for an extended period.
- **Cleaning:** Disconnect the product from the outlet before cleaning. Use a dry cloth for dusting. Do not use chemical solvents.



Device Diagram

Device Controls

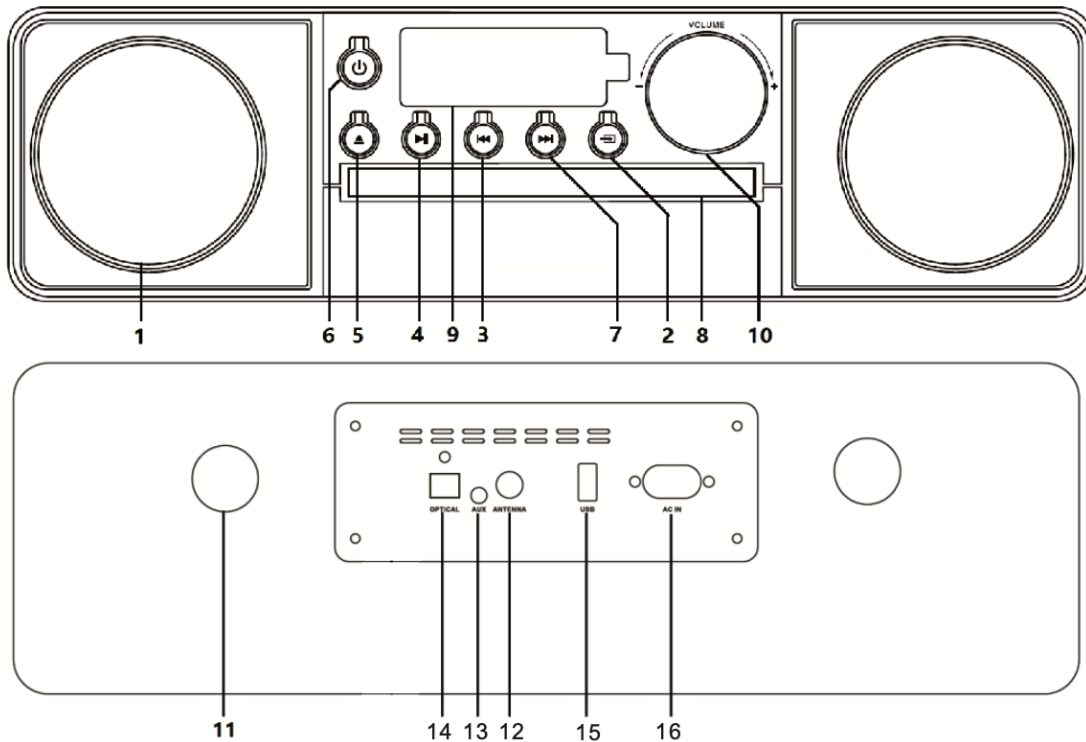

1. Speaker Driver	9. Display
2. “Mode” Button	10. Volume Knob
3. “Previous” Button	11. Bass Reflex Pipe
4. “Play/ Pause” Button	12. FM Antenna Socket
5. “Eject” Button	13. “AUX IN” Jack
6. “Standby” Button	14. Optical Input Port
7. “Next” Button	15. USB Port
8. CD Door	16. AC Power Input

Remote Control Functions

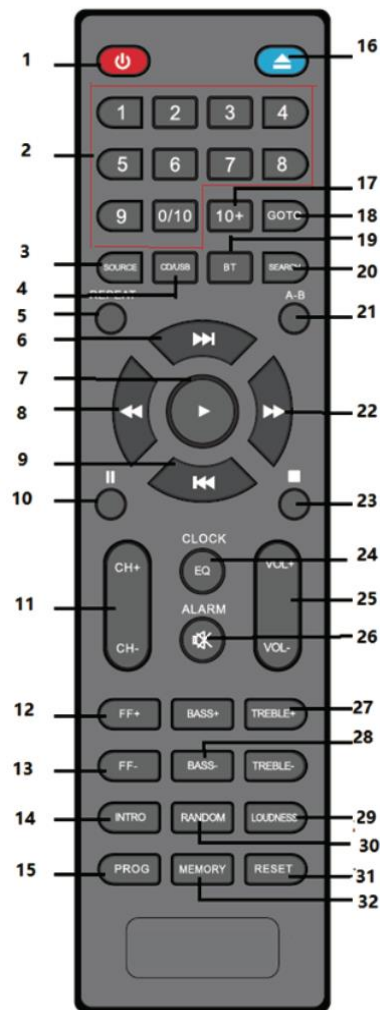

- | | |
|--|-------------------------|
| 1. Power On/Off | |
| 2. Digits Buttons | |
| 3. Source | |
| 4. CD/USB | |
| 5. Repeat (includes Repeat All, Repeat One, Repeat Folder, Repeat Off) | |
| 6. Next | |
| 7. Play | |
| 8. Fast-rewind | |
| 9. Previous | |
| 10. Pause | |
| 11. Channel +/- | |
| 12. FM Frequency + | |
| 13. FM Frequency - | |
| 14. Introduce | |
| 15. Program | |
| 16. Eject | |
| 17. 10+ Digit | |
| 18. GoTo | |
| 19. Bluetooth | |
| | 20. Search (FM Scanner) |
| | 21. A-B Repeat |
| | 22. Fast-Forward |
| | 23. Stop |
| | 24. Clock/ EQ |
| | 25. Volume +/- |
| | 26. Alarm/ Mute |
| | 27. Treble +/- |
| | 28. Bass +/- |
| | 29. Loudness |
| | 30. Random On/Off |
| | 31. Reset |
| | 32. Memory |

Quick Start Guide

Section 1: Setting Up Your Device

Step #1: Plug the device into a wall outlet to connect to power. The display will light up with dashes, indicating the device is in "standby" mode. The "Power" button will turn on the device.

Step #2: Install Batteries in Remote Control

- Open the battery compartment to insert two AAA batteries, making sure to align battery polarity correctly.
- Close the compartment securely.

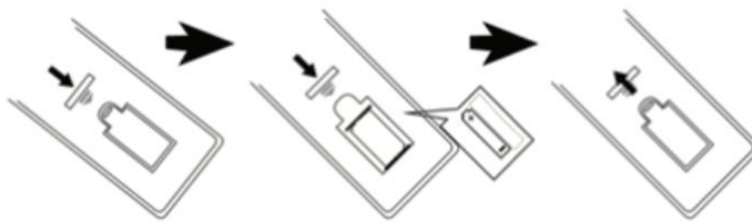

- Optimal use of remote control:
 - Operate within 22 feet of the device without obstructions for best performance.
 - Replace batteries when performance decreases.

Section 2: Using Your Device

Step #3: Use the "Power" button on the device or remote to switch the device on or off and to control standby mode.

Note: This device automatically enters standby mode after 30 minutes of no audio input to conserve energy.

Step #4: Mute and unmute sound using the "Mute" button. Adjust volume with the "VOL +/-" buttons or the volume knob.

Note: Low volume may be interpreted as no audio input, triggering standby mode. Increase volume or restart audio to continue playback.

Step #5: Change audio sources by pressing the "SOURCE" button to cycle through options (CD, USB, FM radio, LINE IN, Bluetooth, HDMI, Optical).

Step #6: Adjust sound settings using the "EQ" button for different modes like Jazz, Rock, Pop, Classic. Manage bass and treble with respective buttons.

Step #7: To load and play CDs, open the CD tray with the "Eject" button, place a CD inside, and close the tray to start playback automatically.

To Create a Playlist: You can program up to 20 tracks for CDs and MP3 discs, and up to 99 tracks for WMA/MP3 discs.

- In CD mode, press "Stop," then "Program" to begin.
- Use the "Previous/Next" or numerical buttons to select tracks, then press "Program" to confirm each selection.
- Continue this process until the display reads "FULL."
- Press "Play" to start your custom playlist.
- To cancel the playlist, press "Stop" twice or eject the CD.

Step #8: To navigate tracks and settings, use playback controls like "Play/Pause," "Stop," "Previous/Next," and special functions like Repeat and Shuffle.

Other Ways To Play Music

- **Bluetooth:** Switch to Bluetooth mode by pressing the "SOURCE" button and pair with external devices by selecting "SoundBeast CD25" from the device list.
 - **Pairing:** Select "SoundBeast CD25" from the list to pair. The display will stabilize on "BT" once successfully connected.
 - **Playing Music:** Choose and play music from your Bluetooth device. The sound will be output through the micro system.
 - **Track Selection:** Use the "Previous/Next" buttons to navigate through tracks during playback.
 - **Bluetooth Mode Functions:** You can control "Play/Pause," "Mute," and adjust EQ settings in Bluetooth mode. For detailed instructions, refer to the previous section of this manual.

Notes:

- Not all Bluetooth devices may pair successfully due to differences in design and brand.
- Optimal Bluetooth range is within 32 feet without obstacles.
- The system can only pair with one Bluetooth device at a time.

- Disconnect the current pairing before attempting to pair with another device, as "SoundBeast CD25" may not appear in the device list if still connected.
- **USB Playback:** Insert a USB drive with compatible audio files into the USB port; select USB mode by pressing the "SOURCE" button to start playback.
 - In USB mode, you can control playback with functions like "Play/Pause," "Stop," "Mute," "Repeat," track selection, equalizer settings, "Fast-Forward," and "Rewind." Refer to the previous section of this manual for detailed instructions.

Notes:

- Using a USB extension cable for connection is not recommended as it may cause noise or intermittent sound due to data loss.
 - Playback of all MP3/WMA formatted music is not guaranteed.
 - The maximum supported USB device size is 32GB.
 - Some USB sticks may require more time to start playback; this is normal and not a malfunction.
-
- **FM Radio:** Press the "SOURCE" button to select FM mode.
 - **Auto Scan and Preset Stations:**
 - Initiate an automatic scan for stations by shortly pressing the "Search" button on the remote or

holding the "Play/Pause" button on the unit for 2 seconds. The device can store up to 40 preset stations.

- To access these presets, use the "Previous" and "Next" buttons on the unit or the "Channel +/-" or numerical buttons on the remote.
- **Manual Tuning and Auto Scan:**
 - Manually adjust the frequency in increments of 0.1 MHz using the "FF+/-" buttons.
 - For automatic scanning, hold the "FF+/-" or "Previous/Next" buttons for 2 seconds. The unit will scan and play the first available station it finds.
- **Saving Stations Manually:**
 - After finding a station you wish to save, press the "Memory" button on the remote.
 - The preset number will flash on the display. Use the "Channel +/-" buttons to choose where to save the station.
 - Press "Memory" again to confirm and save the station. Repeat these steps to save additional stations.
- **Accessing a Specific Frequency:**
 - Press the "GOTO" button on the remote, then enter the FM frequency using the numerical buttons (e.g., 1-0-4-3). The unit will tune to and play that specific station.

Note: Only available preset stations will be displayed on the unit.

- **Optical Input:** Use an optical cable to connect to respective ports for audio output from compatible devices. Press the "SOURCE" button to select HDMI or Optical.
- **AUX IN/Line In Operation:** Use "SOURCE" button to select Line In; connect an external player via the AUX cable to the LINE IN port and play audio through the micro system.

How to Set the Clock & Alarm

- **Setting the Clock:**
 - In standby mode, press and hold the "Clock" button on the remote for a few seconds to start setting. The display will show a 24-hour time format.
 - Press the "Channel +/-" button to choose between a 12-hour or 24-hour format, then press the "Clock" button to confirm.
 - Adjust the hour by pressing the "Channel +/-" button, then confirm by pressing the "Clock" button.
 - Next, the minutes will flash. Adjust by using the "Channel +/-" button and finalize by pressing the "Clock" button again.
- **Setting the Alarm:**
 - While viewing the clock display, press and hold the "Alarm" button on the remote for a few seconds.
 - The alarm source (CD, USB, or FM) will appear. Select your preferred source with the "Channel +/-" button and press the "Alarm" button to confirm.
 - Continue to set the hour, minute, and wake-up volume using similar steps, confirming each with the "Alarm" button.

- An “alarm icon” displays after successful alarm setup. Press the "Alarm" button shortly in standby mode to toggle the alarm on or off and to review settings.

Notes:

- Clock and alarm settings are retained only while the main power is on. Reset if power is interrupted.
- At the set alarm time, the unit will automatically start playback (CD, FM radio, USB). Press the "Standby" button to stop playback.

Troubleshooting

1. The Unit Won't Power On

- **Step 1:** Make sure the AC power cord is properly connected to the wall outlet.
- **Step 2:** When powered on, the display will light up with dashes, indicating the device is in "standby" mode. The "Power" button will turn on the device for use.
- **Step 3:** If the problem persists, contact customer support for assistance.

2. No Sound Output

- **Step 1:** Try adjusting the volume to see if there's any change.
- **Step 2:** Ensure you've selected the correct audio source or playback mode.
- **Step 3:** If in Bluetooth mode, turn up the volume on your phone or tablet.
- **Step 4:** If the issue continues, please reach out to customer support.

3. CD Not Playing or Sound is Intermittent

- **Step 1:** Try playing another CD that is in good condition and supported format (CD/CD-R-RW/MP3/WMA).
- **Step 2:** Clean the CD if it has dirt or scratches that might prevent it from playing properly.
- **Step 3:** Contact customer support if the CD still cannot be read or if playback issues persist.

4. Background Noise During FM Playback

- **Step 1:** Move the unit closer to a window to enhance signal strength.
- **Step 2:** Try switching to a different FM station if the noise continues.

5. Intermittent Sound During Bluetooth Playback

- **Step 1:** Move your Bluetooth device closer to the unit to strengthen the connection.
- **Step 2:** Turn off the Bluetooth function and then pair your device again.

6. General Remote Control Issues

- **Step 1:** Point the remote directly at the unit's sensor and make sure there are no obstructions between them.
- **Step 2:** Replace the batteries if there are no improvements.

Technical Specifications

Product Name & Model	CD Stereo Shelf System
Product Model	Model CD25
Power Source	AC 110-240V, 50/60 Hz
Power Consumption	60W
Standby Power Consumption	<0.5W
Output Power	RMS 2 x 25W
Bluetooth	Version 5.3, effective within 32 feet
USB	5V, 500mA, USB 2.0, supports up to 32GB storage devices
Optical Input	1x input for digital audio
CD Compatibility	CD, CD-R/RW, MP3, WMA
FM Frequency Range	88.1-107.9 MHz
Antenna Impedance	75 ohm

Need Further Assistance?

Having trouble? No worries—we're here to assist you! Our dedicated support team is committed to providing you with the help you need.

How to Reach Us:

- Email us at support@soundbeast.rocks. We strive to respond to all inquiries within 24 to 48 hours. If you haven't heard from us within this timeframe, please check your SPAM folder.

When Contacting Us, Please Include:

- **Product Information:** Specify the product model you are using.
- **Issue Description:** Provide a detailed description of the issue you are experiencing. The more details you provide, the better we can assist you.
- **Order Number:** Provide your order number and where you purchased the product from.

Our goal is to ensure your satisfaction and resolve any issues you encounter swiftly. Thank you for choosing SoundBeast!

SOUNDBEAST®

www.SoundBeast.rocks
support@soundbeast.rocks

FCC STATEMENT :

This device complies with Part 15 of the FCC Rules. Operation is subject to the following two conditions:

- (1) This device may not cause harmful interference, and
- (2) This device must accept any interference received, including interference that may cause undesired operation.

Warning: Changes or modifications not expressly approved by the party responsible for compliance could void the user's authority to operate the equipment.

NOTE: This equipment has been tested and found to comply with the limits for a Class B digital device, pursuant to Part 15 of the FCC Rules. These limits are designed to provide reasonable protection against harmful interference in a residential installation. This equipment generates uses and can radiate radio frequency energy and, if not installed and used in accordance with the instructions, may cause harmful interference to radio communications. However, there is no guarantee that interference will not occur in a particular installation. If this equipment does cause harmful interference to radio or television reception, which can be determined by turning the equipment off and on, the user is encouraged to try to correct the interference by one or more of the following measures:

- Reorient or relocate the receiving antenna.

- Increase the separation between the equipment and receiver.

- Connect the equipment into an outlet on a circuit different from that to which the receiver is connected.

- Consult the dealer or an experienced radio/TV technician for help.

FCC Radiation Exposure Statement:

This equipment complies with FCC radiation exposure limits set forth for an uncontrolled environment. This equipment should be installed and operated with minimum distance 20cm between the radiator & your body.