

WIFI SMART SIREN USER MANUAL



Please read this manual carefully before use.

■ Features

- Based on the TUYA smart home platform, work with most of the TUYA smart based smart products.
- On-site high-decibel alarm, flashing lights and other alarm modes.
- Home Arm, Away Arm, Disarm
- Low-battery detection
- System power off detection.
- Tamper detection.
- Built-in battery.

■ Download the app and register

Search for "TuyaSmart" or scan the QR code below to download the app and register.



■ How to connect WIFI network.#1:

"Default mode"

- ① Open the APP homepage, press "+" in the upper right corner to add devices → select "ALL devices" → select "Alarm system"

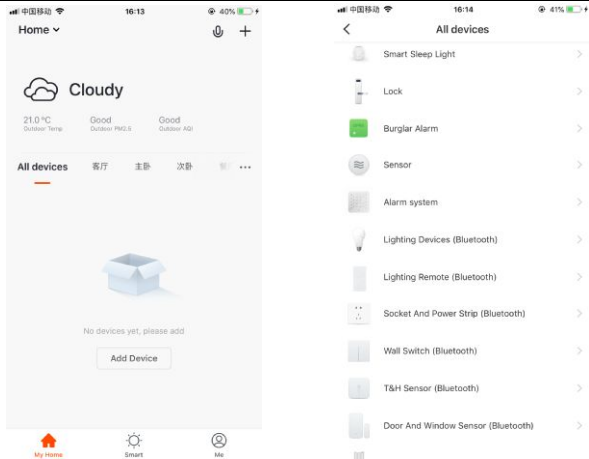

- ② Re-open the smart siren switch, re-connect the power, press and hold the REST button for 5 seconds, the indicator flashes quickly, ready to connect WIFI.



③ “Confirm indicator quickly blink” → Enter WiFi password (2.4G WiFi only) → OK

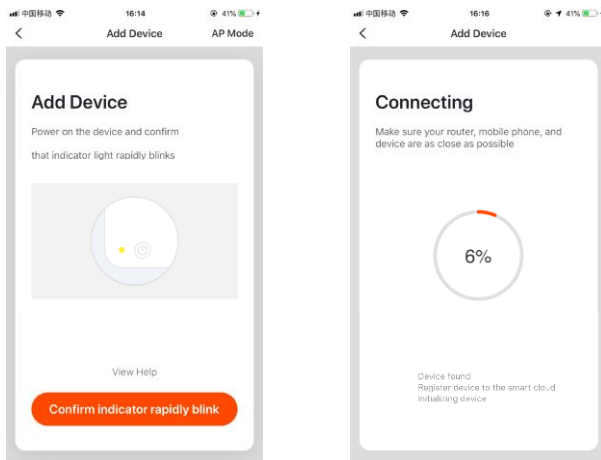

■ How to connect WIFI network, #2:
"compatibility mode"

If the default way to connect WIFI is unsuccessful, you can select "AP Mode".

- ① Open the APP homepage, press "+" in the upper right corner to add devices → select "ALL devices" → select "Alarm system"

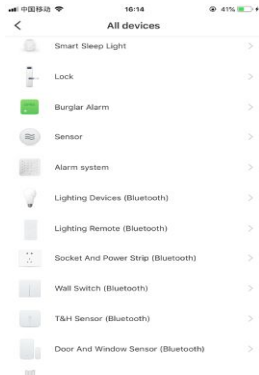
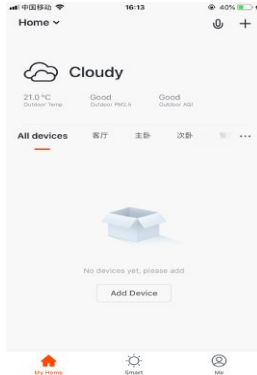

- ② Click on "AP Mode" at the top right of the app.

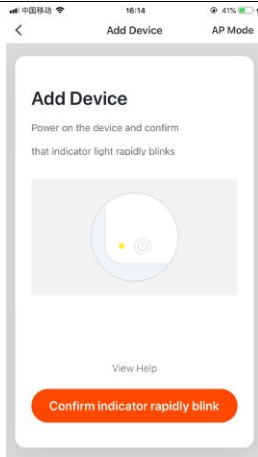

- ③ Re-open the smart siren switch, re-connect the power, press and hold the REST button for 5 seconds,

the indicator light flashes quickly, continue to press and hold the REST button for 5 seconds, the indicator light flashes slowly, ready to connect.



④ "Comfirm indicator slowly blink" → Enter the network password (2. 4G Wi Fi only) → OK → Go connect.

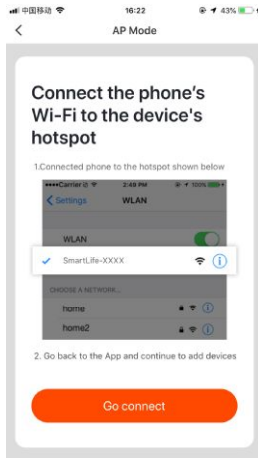
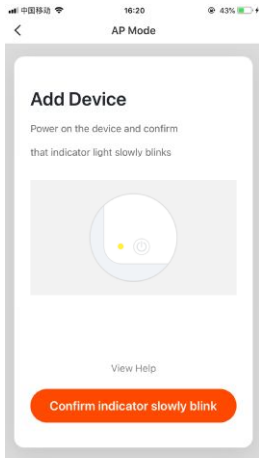

- ④ Find "SmartLife-xxx" in the wifi list of your mobile and click Connect → Return to "TuyaSmart" APP.

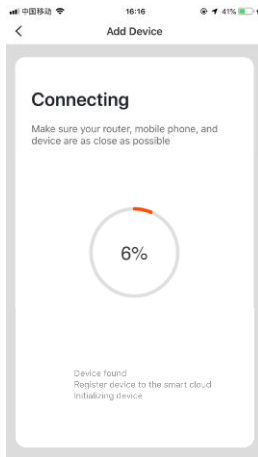
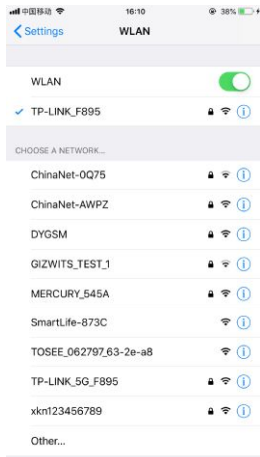

■WIFI connection notes:

1. Does not support 5G router..
2. If the above two way connection both fail , please try to restart the router.
3. Siren host and mobile phone as close as possible to the router.

■ Add detectors and remotes:

- ① Click on the APP homepage "accessories" → select "The detector" or "The control" → click on "add"

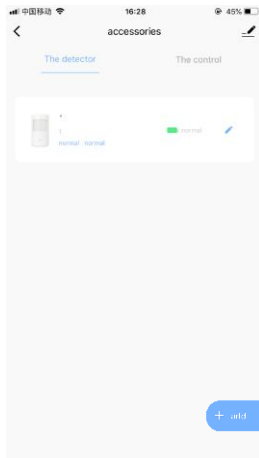
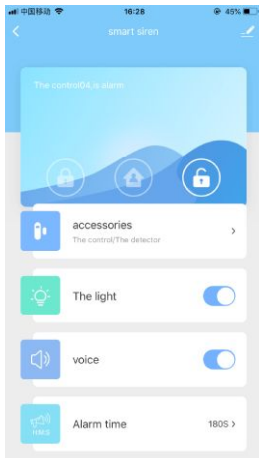

- ③ Click "OK" → smart siren light keep on → accessories send signals → smart siren light flash 3 times, adding is successful.

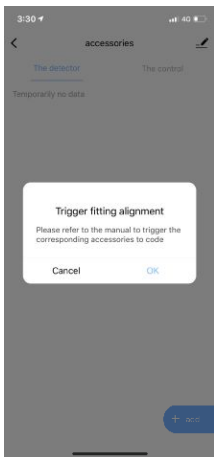

■ Edit the accessory name:

In order to make it easier to distinguish different alarm events, you can edit the accessories' name (within 20 characters).

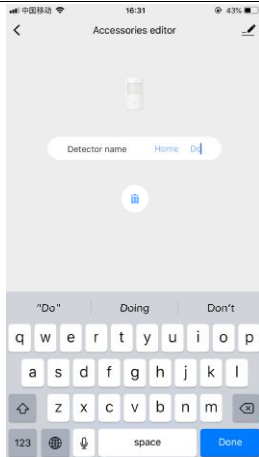
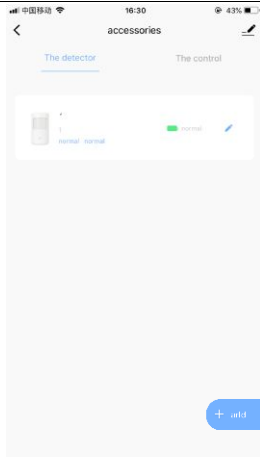

■ Specifications:

Arm: alarm with sound and light flash

Home Arm: only light flash to alarm

Disarm: only SOS alarm available

Remote controls: max 8

Detectors: max 24

Volume: high / medium / low

Beep time: 1-180 seconds adjustable

Timing control: arm / home arm / disarm

Accessories frequency: 433Mhz (can be customized to any frequency between 300-912M)

FCC Statement

This device complies with Part 15 of the FCC Rules.

Operation is subject to the following two conditions:

(1) This device may not cause harmful interference.

(2) This device must accept any interference received, including interference that may cause undesired operation.

2. Changes or modifications not expressly approved by the party responsible for compliance could void the user's authority to operate the equipment.

Note: This equipment has been tested and found to comply with the limits for a class B digital device, pursuant to Part 15 of the FCC Rules. These limits are designed to provide reasonable protection against harmful interference in a residential installation.

This equipment generates uses and can radiate radio frequency energy and, if not installed and used in accordance with the instructions, may cause harmful interference to radio communications. However, there is no guarantee that interference will not occur in a particular installation. If this equipment does cause harmful interference to radio or television reception, which can be determined by turning the equipment off and on, the user is encouraged to try to correct the interference by one or more of the following measures:

- Reorient or relocate the receiving antenna.
- Increase the separation between the equipment and receiver.
- Connect the equipment into an outlet on a circuit different from that to which the receiver is connected.
- Consult the dealer or an experienced radio/TV technician for help.

This equipment complies with FCC radiation exposure limits set forth for an uncontrolled environment. This equipment should be

installed and operated with minimum distance 20cm between the radiator & your body.

- --This device is acting as slave and operating in the 2.4 GHzband. Ad Hoc function is supported but not able to operate on non-US frequencies.
- Operation of this device is restricted to indoor use only.
- FCC ID: 2AS8R-V18