



## OWNER'S MANUAL

Visit the Bestway  
**YouTube** channel



[bestwayusa.com](http://bestwayusa.com)

©2024 Bestway Inflatables & Material Corp. All rights reserved.

Trademarks used in some countries under license from / Manufactured by Bestway Inflatables & Material Corp.,

No. 208 Jin Yuan Wu Road, Shanghai, 201812, China (Tel: +86 21 69135588).

Represented in North America by Bestway (USA) Inc., 3435 S. McQueen Road, Chandler, AZ 85286, United States of America.

[www.bestwayusa.com](http://www.bestwayusa.com)

## IMPORTANT SAFETY INSTRUCTIONS

# IMPORTANT SAFETY INSTRUCTIONS READ ALL INSTRUCTIONS



## WARNING

- **INGESTION HAZARD:** This product contains a button cell or coin battery.
- **DEATH** or serious injury can occur if ingested.
- A swallowed button cell or coin battery can cause **Internal Chemical Burns** in as little as **2 hours**.
- **KEEP** new and used batteries **OUT OF REACH of CHILDREN**
- **Seek immediate medical attention** if a battery is suspected to be swallowed or inserted inside any part of the body.



This device complies with part 15 of the FCC Rules. Operation is subject to the following two conditions:

- (1) This device may not cause harmful interference, and
- (2) this device must accept any interference received, including interference that may cause undesired operation.

Attention that changes or modification not expressly approved by the party responsible for compliance could void the user's authority to operate the equipment.

**NOTE:** This product has been tested and found to comply with the limits for a Class B digital device, pursuant to Part 15 of the FCC Rules. These limits are designed to provide reasonable protection against harmful interference in a residential installation.

This product generates, uses, and can radiate radio frequency energy and, if not installed and used in accordance with the instructions, may cause harmful interference to radio communications. However, there is no guarantee that interference will not occur in a particular installation. If this product does cause harmful interference to radio or television reception, which can be determined by turning the equipment off and on, the user is encouraged to try to correct the interference by one or more of the following measures:

- Reorient or relocate the receiving antenna.
- Increase the separation between the equipment and receiver.
- Connect the equipment into an outlet on a circuit different from that to which the receiver is connected.
- Consult the dealer or an experienced radio/TV technician for help.

## IMPORTANT SAFETY INSTRUCTIONS

---

### Battery Precaution **for Remote Control**

- Ensure batteries are installed correctly with regard to polarity (+ and -).
- Do not short-circuit the battery.
- Never attempt to recharge primary batteries as this may cause leakage, fire, or explosion.
- Rechargeable batteries are to be removed from this product before being charged.
- Never attempt to disassemble or open batteries as this can lead to electrolyte burns.
- Remove batteries from equipment which is not to be used for an extended period of time.
- Exhausted batteries are to be removed from this product.
- Do not dispose of product and its batteries in fire. Check your local regulations for proper disposal instructions.
- Batteries shall not be exposed to excessive heat such as sunshine, fire or the similar.
- Keep batteries out of the reach of children.
- Only use 1 x CR2032 (1 x 3V DC) batteries.
- Remove and immediately recycle or dispose of used batteries according to local regulations and keep away from children. Do NOT dispose of batteries in household trash or incinerate.
- Even used batteries may cause severe injury or death. Call a local poison control center for treatment information.
- Non-rechargeable batteries are not to be recharged.
- Do not force discharge, recharge, disassemble, heat above 95°F / 35°C or incinerate. Doing so may result in injury due to venting, leakage or explosion resulting in chemical burns.
- Remove and immediately recycle or dispose of batteries from equipment not used for an extended period of time according to local regulations.
- Always completely secure the battery compartment. If the battery compartment does not close securely, stop using the product, remove the batteries, and keep them away from children.
- **Remove and immediately recycle or dispose of used batteries according to local regulations and keep away from children. Do NOT dispose of batteries in household trash or incinerate.**
- **Even used batteries may cause severe injury or death.**
- **Call a local poison control center for treatment information.**
- **Non-rechargeable batteries are not to be recharged.**
- **Do not force discharge, recharge, disassemble, heat above 95°F / 35°C or incinerate. Doing so may result in injury due to venting, leakage or explosion resulting in chemical burns.**

### Battery Precaution For LED Light

- This product contains rechargeable Ni-MH battery.
- **The battery is sealed inside the lamp permanently and can not be removed.**
- **Do not throw the product into fire.**
- **Full charge time: at least 7h.**

## PRODUCT SPECIFICATIONS

Battery:	AA Ni-MH 1500mAh 1.2V
Solar Charging Panels:	Solar panels 2V 500mA
Light Mode:	4-color LED light (3 light patterns with 9 color options: 4 fixed & 5 combinations)
Remote control Distance :	15 m (no block) wireless remote control
Chlorination Barrel Capacity:	Holds 3 chlorine or bromine tablets up to 3 in. / 7.6 cm in diameter (not included)
Waterproof Rating	IP68, 2m
Working Hours:	6-8 hours
Charging Time:	7-10 hours (depends on sunshine conditions)
Operation Temperature:	41°F / 5°C - 113°F / 45°C
Storage Temperature:	14°F / -10°C - 95°F / 35°C

## PARTS & TOOLS



Compare the parts in your box to the parts listed in this manual. Verify that the equipment components represent the model that you had intended to purchase.  
Before assembling the product, take a few minutes to become familiar with all the parts.

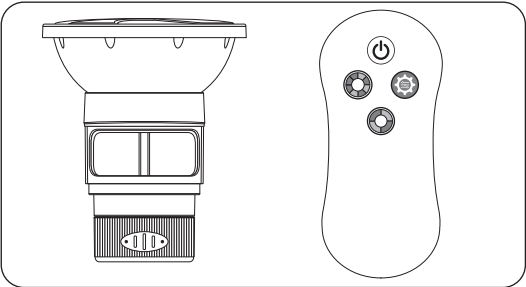

## SETUP INSTRUCTIONS

For installation instructions, follow the illustrations in the back of the manual. Drawings are for illustration purposes only. May not reflect actual product. Not to scale.  
The first time using, it need to be charged under the sunlight then will light up.  
After putting in the chlorine tablets, be sure to close the Chlorine Floater before putting them in the water to ensure that the chlorine tablets will not flow out in the water.  
Solar-powered light turns on automatically at night

## SETUP INSTRUCTIONS

### Button Function Description

**NOTE:** The product will not work if there is too much ambient light. It will only work in the dark.



Short press the button to turn on / off.



Short press the button to adjust the number of lights:  
Monochrome lights, Two-color lights and Four-color lights.



Short press the button to adjust the lighting modes:  
Steady, Fast flashing, Breathing cycle flashing.



Short press the button to adjust the color of  
Monochrome lights and Two-color lights.



①

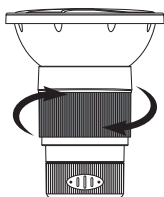

②

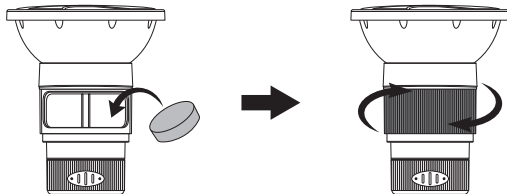

③

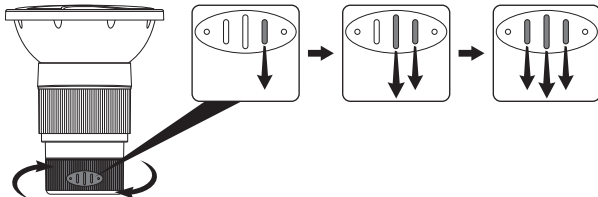

## MAINTENANCE & STORAGE

- Before storing, remove the product from the pool. Place it in a cool, dry location out of children's reach.
- Before you use it, please place the chlorine floater in the sun to fully charge.
- After fully charged, the light will light up automatically in the darkness environment.



www.bestwaycorp.com

### 增加如下警语

#### Battery Precaution for LED Light

- This product contains rechargeable Ni-MH battery.
- The light source of this luminaire is not replaceable; when the light source reaches its end of life the whole luminaire shall be replaced.

#### WARNING

- Keep the batteries away from children.
- The battery can cause severe or fatal injuries in 2 hours or less if it is swallowed or placed inside any part of the body.
- Medical attention should be sought immediately if it is suspected the battery has been swallowed or placed inside any part of the body.
- If you suspect your child has swallowed or inserted a button battery immediately call the 24-hour Poisons Information Centre on 13 11 26 for fast, expert advice.
- Examine devices and make sure the battery compartment is correctly secured, e.g. that the screw or other mechanical fastener is tightened.
- Do not use if compartment is not secure.
- Tell others about the risk associated with button batteries and how to keep their children safe.
- Do not ingest battery, Chemical Burn Hazard.
- CAUTION! Risk of fire or explosion if the battery is replaced by an incorrect type.
- Disposal of a battery into fire or a hot oven, or mechanically crushing or cutting of a battery, that can result in an explosion.
- Battery subjected to extremely low air pressure that may result in an explosion or the leakage of flammable liquid or gas.



©2024 Bestway Inflatables & Material Corp.

All rights reserved / Tous droits réservés / Todos los derechos reservados / Alle Rechte vorbehalten / Tutti i diritti riservati

Trademarks used in some countries under license from / Marques déposées utilisées dans certains pays sous licence de / Marcas comerciales utilizadas en algunos países bajo licencia de / Marken, abweichend in bestimmten Ländern unter Lizenz von / I marchi commerciali sono utilizzati in alcuni paesi su licenza Bestway Inflatables & Material Corp.

Manufactured by / Fabriqué par / Fabricado por / Produziert von / Prodotto da Bestway Inflatables & Material Corp., No. 208 Jin Yuan Wu Road, Shanghai, 201812, China.

Exported by / Exporté par / Exportado por / Exportiert von / Esportato da Bestway (Hong Kong) International Ltd./Bestway Enterprise Company Limited, Suite 713, 7/Floor, East Wing, Tsim Sha Tsui Centre, 66 Mody Road, Kowloon, Hong Kong.

Manufactured for, distributed and represented in the European Union by / Fabriqué pour, distribué et représenté dans l'Union européenne par / Fabricado, distribuido y representado en la Unión Europea por / Hergestellt für Vertrieb sowie Vertretung innerhalb der Europäischen Union durch / Fabricato per conto di, distribuito e rappresentato nell'Unione Europea da Bestway Europe S.p.a., Via Resistenza, 5, 20098 San Giuliano Milanese (Milano), Italy.

Represented in United Kingdom by Bestway Corp UK Ltd. 8 Wentworth Road, Heathfield Industrial Estate, Newton Abbot, Devon, TQ12 6TL.

Represented in Latin America by / Représenté en Amérique latine par / Representado en Latinoamérica por / Representado na América Latina por Bestway Central & South America Ltda, Salar Ascotan 1282, Parque Enea, Pudahuel, Santiago, Chile.

Represented in Australia & New Zealand by Bestway Australia Pty Ltd, Unit 2/98-104 Carnarvon St Silverwater, NSW 2128, Australia. (Tel: Australia: (+61) 2 9037 1388; New Zealand: 0800 142 101).

Represented in North America by / Représenté en Amérique du Nord par / Representado en Norteamérica por Bestway (USA) Inc., 3435 S. McQueen Road, Chandler, AZ 85286, United States of America.

www.bestwaycorp.com

This device contains licence-exempt transmitter(s)/receiver(s) that comply with Innovation, Science and Economic Development Canada's licence-exempt RSS(s). Operation is subject to the following two conditions: (1) This device may not cause harmful interference, and (2) this device must accept any interference received, including interference that may cause undesired operation.

L'appareil contient des émetteurs/récepteurs exempts de licence qui sont conformes aux CNR exempts de licence d'Innovation, Sciences et Développement économique Canada. L'exploitation est soumise aux deux conditions suivantes :

(1) l'appareil ne doit pas produire de brouillage,

(2) l'utilisateur de l'appareil doit accepter tout brouillage radioélectrique subi, même si le brouillage est susceptible d'en compromettre le fonctionnement.

## OWNER'S MANUAL

Hereby, BESTWAY declares that the radio equipment type #58943 is in compliance with Directive 2014/53/EU. The full text of the EU declaration of conformity is available at the following internet address:  
[www.bestwaycorp.com](http://www.bestwaycorp.com).



### Battery Precaution for Remote Control

- Ensure batteries are installed correctly with regard to polarity (+ and -).
- Do not short-circuit the battery.
- Never attempt to recharge primary batteries as this may cause leakage, fire, or explosion.
- Rechargeable batteries are to be removed from this product before being charged.
- Never attempt to disassemble or open batteries as this can lead to electrolyte burns.
- Remove batteries from equipment which is not to be used for an extended period of time.
- Exhausted batteries are to be removed from this product.
- Do not dispose of product and its batteries in fire. Check your local regulations for proper disposal instructions.
- Batteries shall not be exposed to excessive heat such as sunshine, fire or the similar.
- Keep batteries out of the reach of children.
- Only use 1x CR2032 battery.
- Do not ingest battery, Chemical Burn Hazard.
- This product contains coin cell battery. If the coin cell battery is swallowed, it can cause severe internal burns in just 2 hours and lead to death.

If instruction is missing, search it on the website. [www.bestwaycorp.com](http://www.bestwaycorp.com).

### Battery Information for Remote control

- Warning! Do not disassemble!
- Manufacturer: Zhaoqing New Leader Battery Industry Co. Ltd.
- Address: New Leader Industry Building, Tenth Area Chuang Ye Road, Ding Hu New Town, Zhao Qing City, Guangdong Province, China
- Country of origin: China

#### Instructions for removal and replacement of the battery

- Please remove and replace the batteries in a dry and clean environment.
- The removal and replacement of the batteries shall be operated by an adult.
- Open the battery department cover with the commercially available screwdriver specified in this instructions.

## DISPOSAL



Electrical products should not be disposed of with household waste. Please recycle where facilities exist. Check with your local authority or retailer for recycling advice.

## PRODUCT DESCRIPTIONS

Light

1.2V, 200mA, 0.24W

Battery:	AA Ni-MH 1500mAh 1.2V
Solar Charging Panels:	Solar panels 2V 500mA
Light Mode:	4-color LED light (3 light patterns with 9 color options: 4 fixed & 5 combinations)
Remote control Distance :	15 m (no block) wireless remote control
Chlorination Barrel Capacity:	Holds 3 chlorine or bromine tablets up to 3 in. / 7.6 cm in diameter (not included)
Waterproof Rating	IP68, 2m
Working Hours:	6-8 hours
Charging Time:	7-10 hours (depends on sunshine conditions)
Operation Temperature:	41°F / 5°C - 113°F / 45°C
Storage Temperature:	14°F / -10°C - 95°F / 35°C

## SETUP INSTRUCTIONS



### PARTS & TOOLS

Compare the parts in your box to the parts listed in this manual. Verify that the equipment components represent the model that you had intended to purchase.

Before assembling the product, take a few minutes to become familiar with all the parts.



### ASSEMBLY INSTRUCTIONS

For installation instructions, follow the illustrations in the back of the manual. Drawings are for illustration purposes only. May not reflect actual product. Not to scale.

- The first time using, it need to be charged under the sunlight then will light up.
- After putting in the chlorine tablets, be sure to close the Chlorine Floater before putting them in the water to ensure that the chlorine tablets will not flow out in the water.
- Solar-powered light turns on automatically at night

## Button Function Description

**NOTE:** The product will not work if there is too much ambient light. It will only work in the dark.



Short press the button to turn on / off.



Short press the button to adjust the number of lights:  
Monochrome lights, Two-color lights and Four-color lights.



Short press the button to adjust the lighting modes:  
Steady, Fast flashing, Breathing cycle flashing.



Short press the button to adjust the color of  
Monochrome lights and Two-color lights.

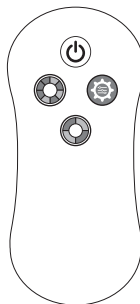

## MAINTENANCE & STORAGE

- Before storing, remove the product from the pool. Place it in a cool, dry location out of children's reach.
- Before you use it, please place the chlorine floater in the sun to fully charge.
- After fully charged, the light will light up automatically in the darkness environment.



