



EN



## Pivo Pod Max

Quick Start Guide

# Table of Contents

Package Content

Pod Overview

Specifications

Charging Method

Aligning the Panoramic Mount

LED Status Overview

How to Get Started

Remote Control Overview

Pairing the Remote Control

Remote Control Settings

Replacing the Remote Control Batteries

Creating a Pivo Account

Pairing Your Portable Device

Positioning Your Portable Device

Downloading the Pivo Apps

Declaration of Conformity

Additional Information

## Package Content

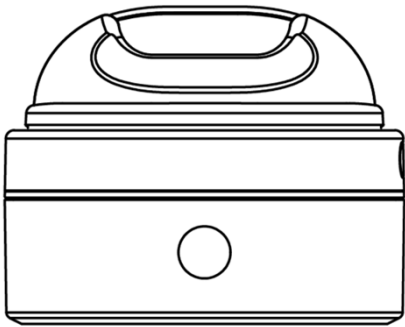

Pivo Pod Max

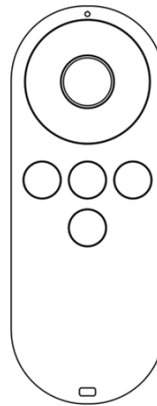

Pivo Remote Control 2.0

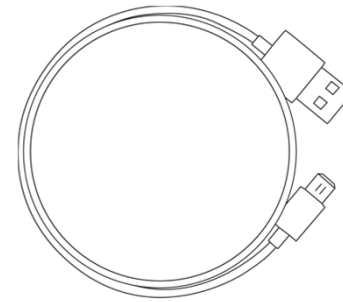

USB-C Charging Cable

## Pod Overview

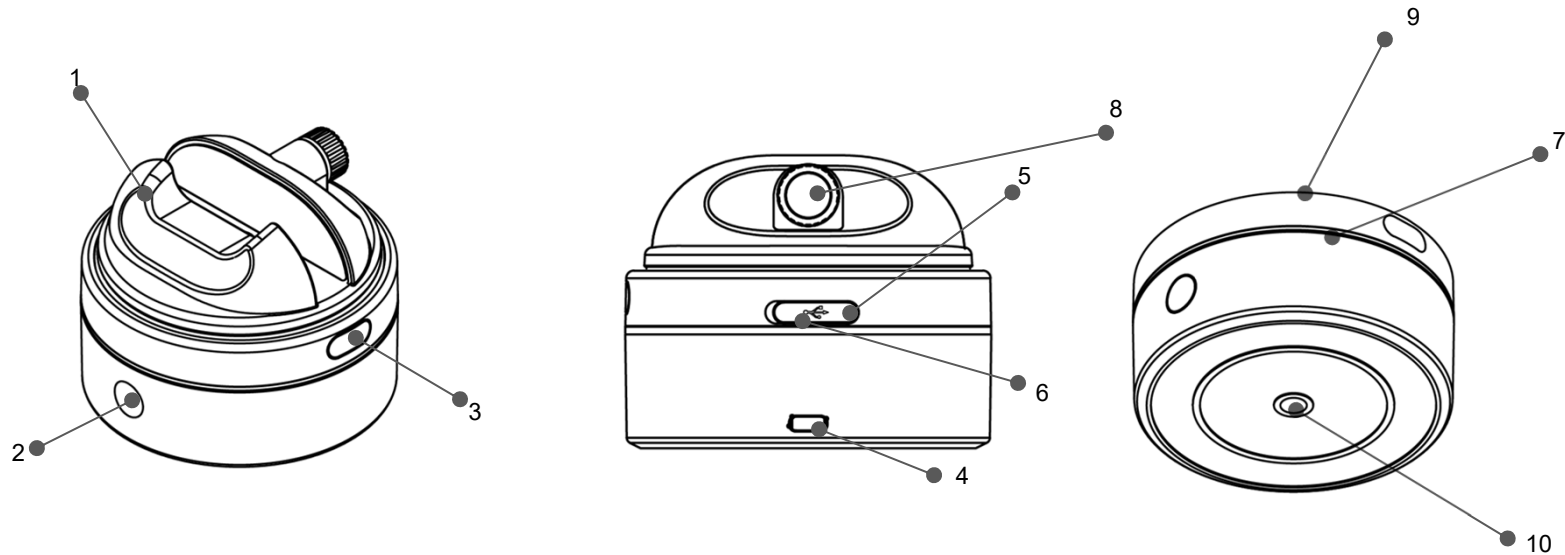

- |                        |                           |
|------------------------|---------------------------|
| 1. Panoramic Mount     | 6. USB-C Port (Top)       |
| 2. Power Button        | 7. LED Light Ring         |
| 3. Alignment Button    | 8. Grip Fastener          |
| 4. USB-C Port (Bottom) | 9. 1/4" UNC Thread Insert |
| 5. Reset Button        | 10. 1/4" UNC Thread Screw |

## Specifications

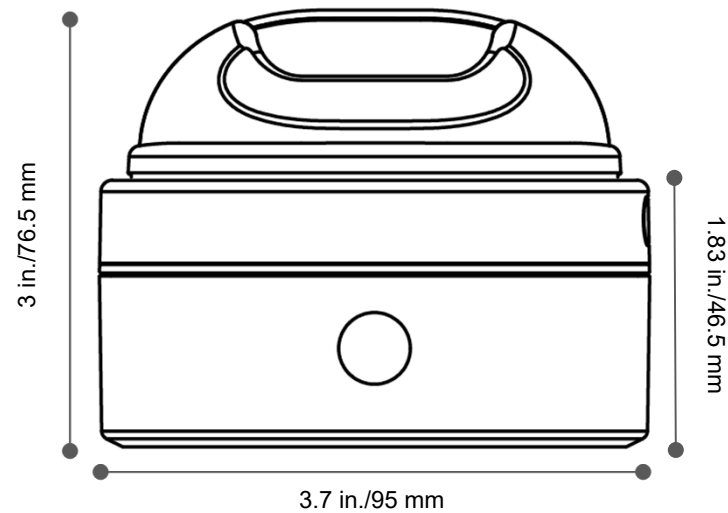

Height (with mount): 3 in./76.5 mm

Bluetooth: BLE (Bluetooth 5.2)

Height (without mount): 1.83 in./46.5 mm

Battery: 1400mAh

Maximum Payload: 70.54 oz/2 kg

Max Rotation Speed: 6 sec/rotation

Weight: 12.55 oz/356 g

Motor: Step Motor

## Charging Method

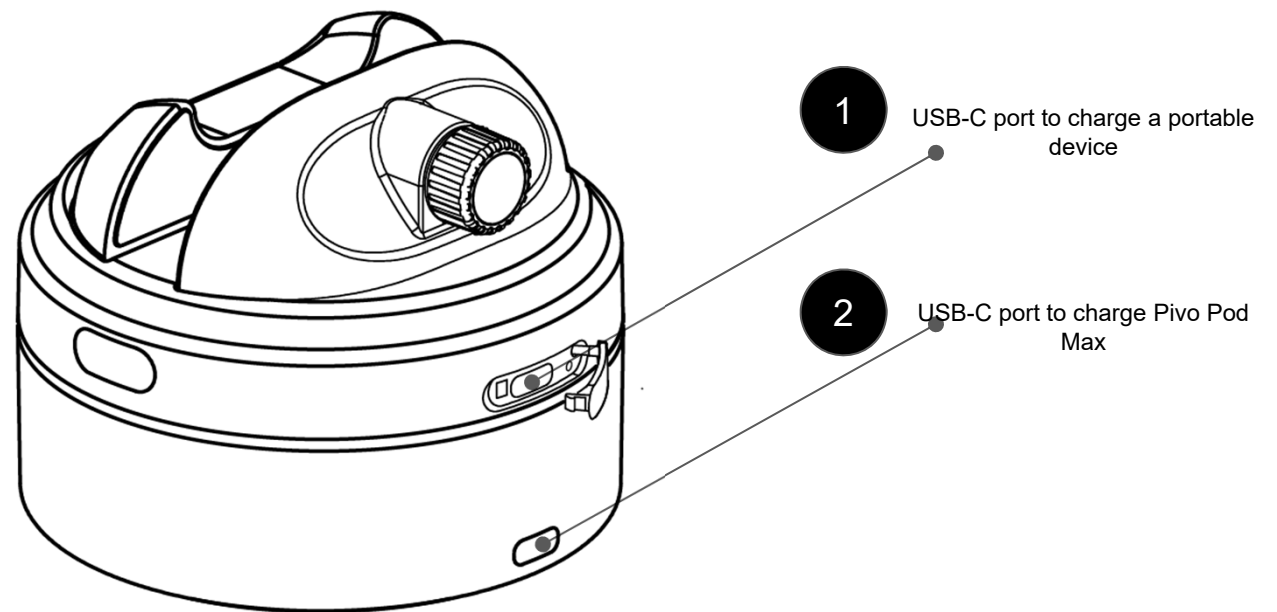

Notice: You can only charge your portable device when the Pivo Pod Max is also charging.

## Aligning the Panoramic Mount

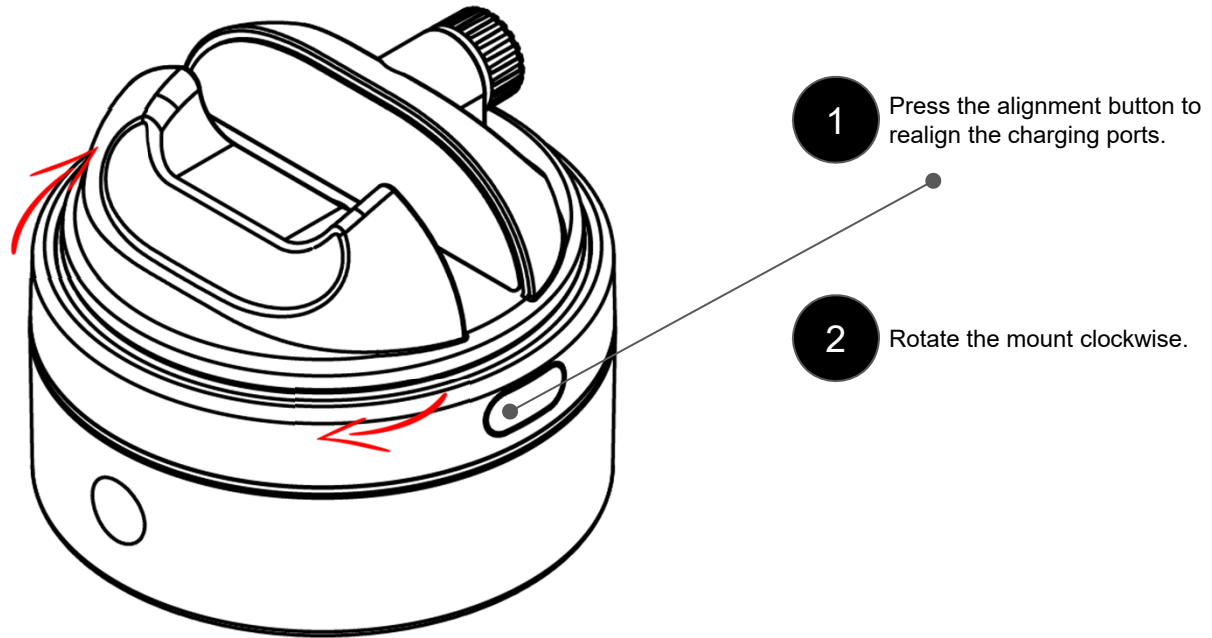

# LED Status Overview

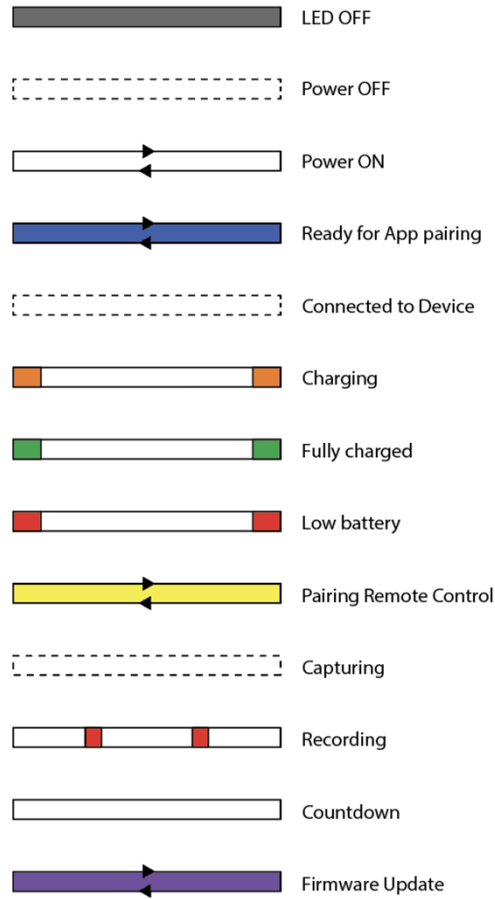

Power Off	○ Blinking White LED
Power On	○ Spinning White LED
Ready for Device Pairing	● Spinning Blue LED
Connected to Device	○ Blinking White LED
Charging	● Steady Orange LED
Fully Charged	● Steady Green LED
Low Battery	● Steady Red LED ON
Pairing Remote Control	● Spinning Yellow LED
Capturing	○ Steady White LED ON
Recording	● Blinking Red LED
F/W Update	● Spinning Purple LED

# Remote Control Overview

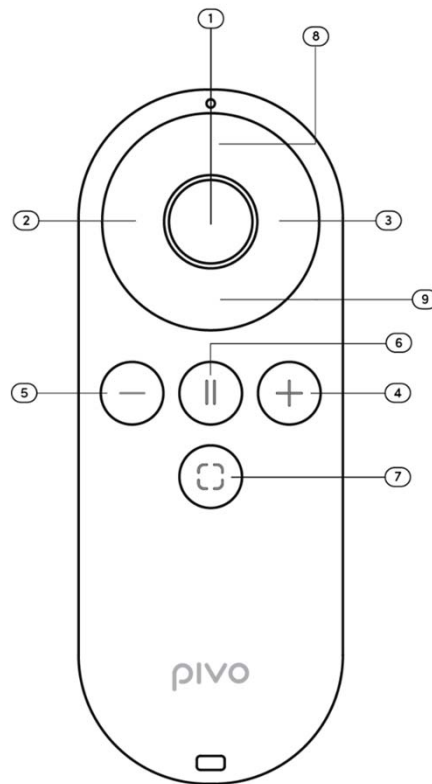

## When disconnected from Pivo Apps

1. Rotate a full rotation clockwise
2. Rotate clockwise
3. Rotate counter-clockwise
4. "+" Increase speed (single)  
"++" Max speed (double)
1. "-" Reduce speed (single)  
"--" Minimum speed (double)
1. Stop rotation
2. Rotate counter clockwise continuously (single)  
Rotate clockwise continuously (double)

## When connected to Pivo Apps

1. Capture and start/stop video recording
6. Select target
7. Reset tracking
8. Zoom-in
9. Zoom-out

# Remote Control Settings

With the Remote Control, you can operate various core settings of your Pod including: rotation speed, rotation direction, shooting mode, shutter button & more.

- Up to an 100 ft/30 m operating range
- Pairs with Pivo Pod Max and Pivo Pod X via Bluetooth



\* The Remote Control settings vary depending on the Pivo App in use. The settings for each Pivo App can be found on our Support Hub.

# Pairing the Remote Control

To use the Remote Control 2.0, it first needs to be paired.

How to pair Remote Control 2.0:

1. Turn on Pivo Pod Max.
2. Press the power button 2 times in quick succession. The LED light ring will turn yellow and spin for approximately 10 seconds.
3. Press and hold the center button of the Remote Control until there is a beeping notification and all the LED lights turn yellow.

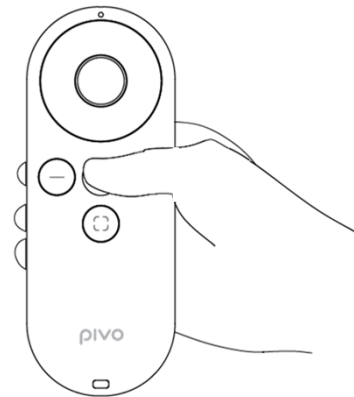
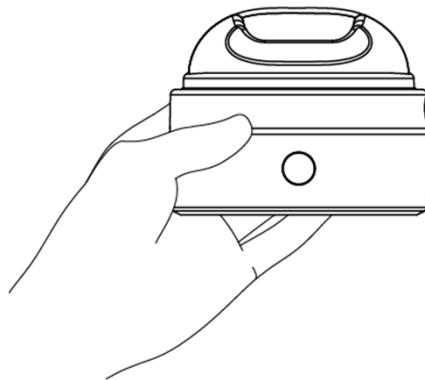

## Replacing the Remote Control Batteries

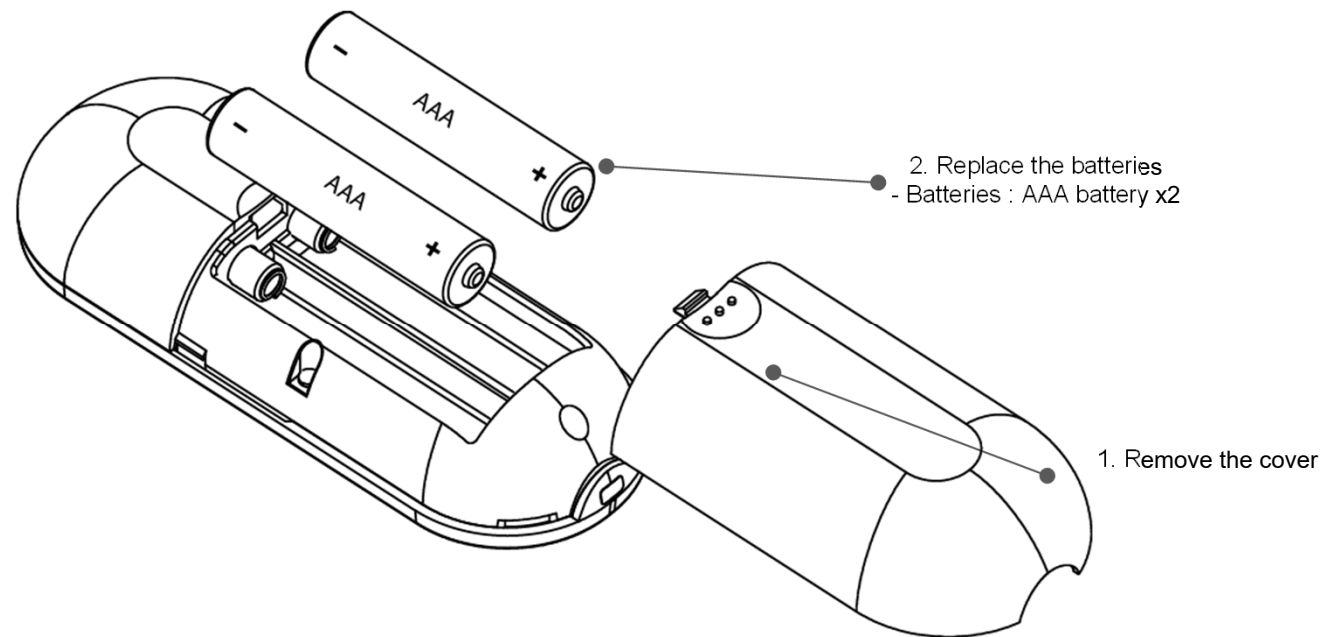

# Creating a Pivo Account

To create a Pivo Account follow these steps:

1. Go to the App Store/Google Play Store and download **Pivo+**.
2. Open the **Pivo+** app and tap "Sign up."
3. Create a Pivo account using a valid email address.
  - Enter your email address
  - Fill out the sign-up form
  - Confirm your registration by entering the verification code.
4. Tap "Allow" to give permission to the microphone, photo album, and voice recognition.

**Note:** Once you create a Pivo Account, your ID and password will remain the same for all Pivo apps. Use this ID and password to sign into all Pivo apps.

## How to Get Started

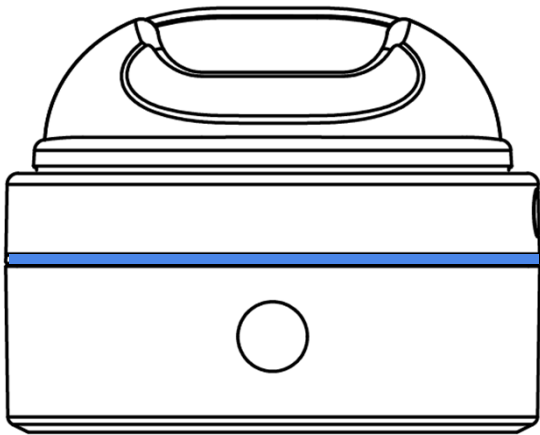

Press the power button **ONCE** to activate App Pairing Mode  
(When the Pod Max is first turned on, it will automatically go into App Pairing Mode)

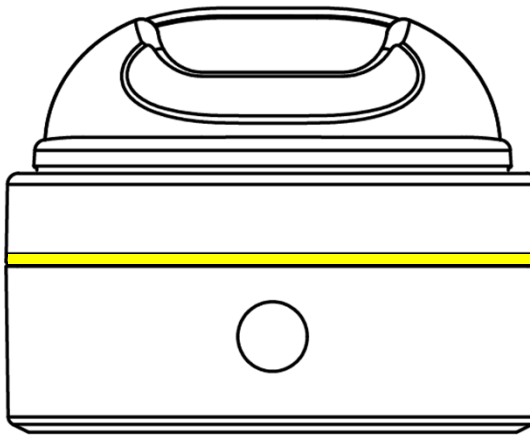

Press the power button **TWICE** to activate Remote Pairing Mode.

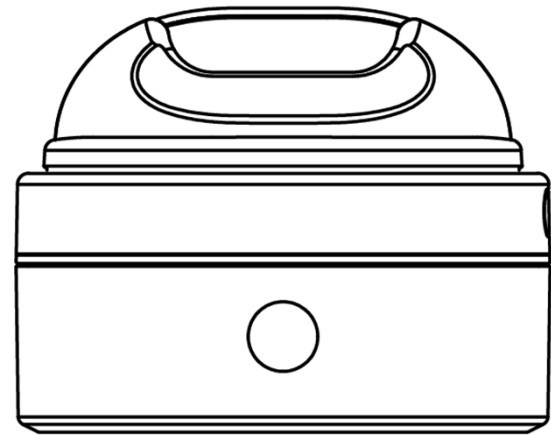

Hold down the power button for 2 seconds to turn the Pod ON or OFF.

# Pairing Your Portable Device

Pivo Pod Max should be paired with a Pivo app in order to use its features.

1. Press the Pivo Pod Max power button for approx. 2 seconds until it turns ON.
2. During pairing mode, the LED lights should be spinning blue.
3. Enable Bluetooth on your portable device.
4. Enter the Pivo app and tap “+” to begin searching for a Pivo device.
5. Tap Pivo Pod Max to pair.

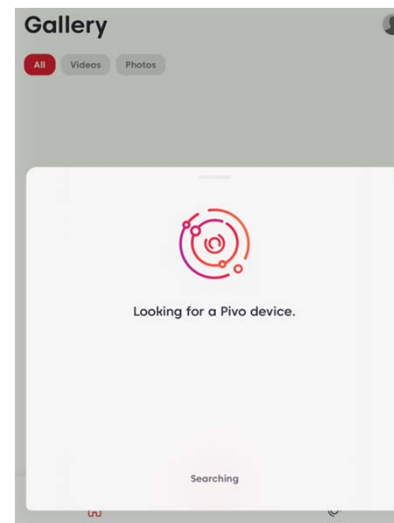
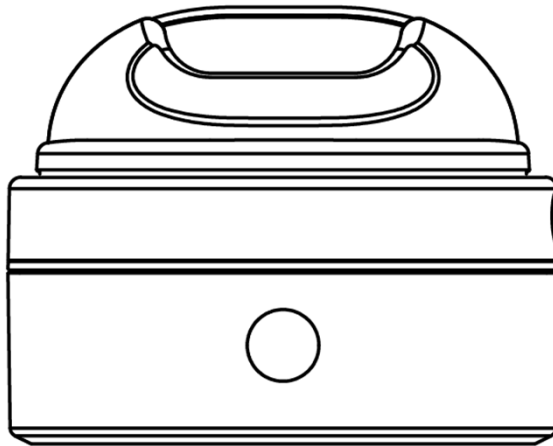

## Positioning Your Portable Devices

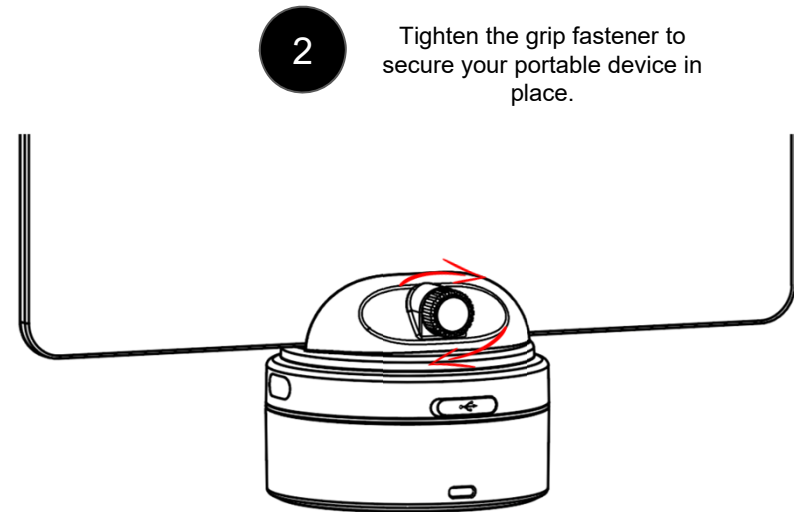
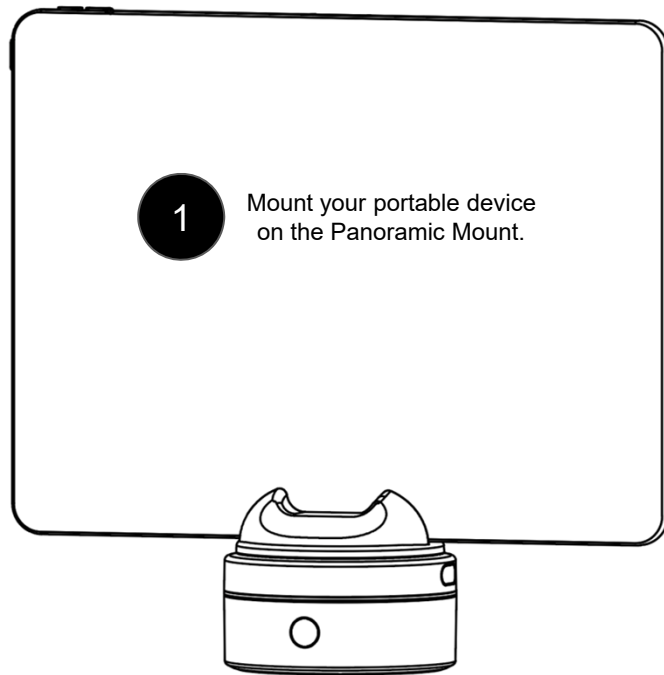

## Downloading the Pivo Apps



Google Play Store



App Store



Visit the Pivo Support Hub for more information on how to use the Pivo apps.

#### FCC Information to User

This equipment has been tested and found to comply with the limits for a Class B digital device, pursuant to Part 15 of the FCC Rules. These limits are designed to provide reasonable protection against harmful interference in a residential installation. This equipment generates, uses and can radiate radio frequency energy and, if not installed and used in accordance with the instructions, may cause harmful interference to radio communications. However, there is no guarantee that interference will not occur in a particular installation. If this equipment does cause harmful interference to radio or television reception, which can be determined by turning the equipment off and on, the user is encouraged to try to correct the interference by one of the following measures:

- Reorient or relocate the receiving antenna.
- Increase the separation between the equipment and receiver.
- Connect the equipment into an outlet on a circuit different from that to which the receiver is connected.
- Consult the dealer or an experienced radio/TV technician for help.

#### Caution

Modifications not expressly approved by the party responsible for compliance could void the user's authority to operate the equipment.

FCC Compliance Information : This device complies with Part 15 of the FCC Rules. Operation is subject to the following two conditions: (1) This device may not cause harmful interference, and (2) this device must accept any interference received, including interference that may cause undesired operation.

“CAUTION : Exposure to Radio Frequency Radiation.

Antenna shall be mounted in such a manner to minimize the potential for human contact during normal operation. The antenna should not be contacted during operation to avoid the possibility of exceeding the FCC radio frequency exposure limit.

#### French Example Canadian Compliance Statements

Le présent appareil est conforme aux CNR d'Industrie Canada applicables aux appareils radio exempts de licence. L'exploitation est autorisée aux deux conditions suivantes : (1) l'appareil ne doit pas produire de brouillage, et (2) l'utilisateur de l'appareil doit accepter tout brouillage radioélectrique subi, même si le brouillage est susceptible d'en compromettre le fonctionnement.

Cet appareil numérique de la classe B est conforme à la norme NMB-003 du Canada.

Cet appareil et son antenne (s) ne doit pas être co-localisés ou fonctionnant en conjonction avec une autre antenne ou transmetteur.