

NIIMBOT

Product Manual

Smart Label Printer

NIIMBOT K2

Please read the manual carefully before installing and using the product and keep it safe.

Contents

01 Statements

02 In the Box

03 Product Description

04 Operating Instructions

05 Software Downloads

06 Use and Maintenance

07 Troubleshooting

08 After-Sales Service Policies

09 Hazardous Substances

10 Product Parameters/Specifications

01 Statements

1. Wuhan NIIMBOT Intelligent Identification Technology Co., Ltd. is solely responsible for the amendment and interpretation of the manual and will try its utmost to ensure the accuracy of the manual. No additional notice will be issued in the event of technological upgrades. All images of products, accessories and software interfaces in this manual are for illustrative purposes only and shall be used for reference only. The actual products may differ slightly from the images due to product upgrades.
2. Wuhan NIIMBOT Intelligent Identification Technology Co., Ltd. is not responsible for any technical or textual errors and omissions and shall not be held accountable for any accidents or indirect damages arising from the provision, implementation or use of such material. Wuhan NIIMBOT Intelligent Identification Technology Co., Ltd. does not accept any responsibility in relation to selecting and using the software/hardware to obtain anticipated results.
3. This document contains proprietary copyrighted information. Wuhan NIIMBOT Intelligent Identification Technology Co., Ltd. reserves all rights thereof. Photocopying, copying or translating any content in this document into other languages is not permitted without prior consent in writing from Wuhan NIIMBOT Intelligent Identification Technology Co., Ltd.
4. Wuhan NIIMBOT Intelligent Identification Technology Co., Ltd. is the copyright holder of the content in this manual.

02 In the Box

Smart Label Printer ×1

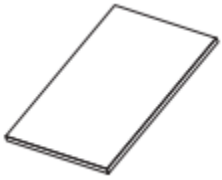

Product Manual ×1



Power Adapter ×1

03 Product Description

3.1 Component description

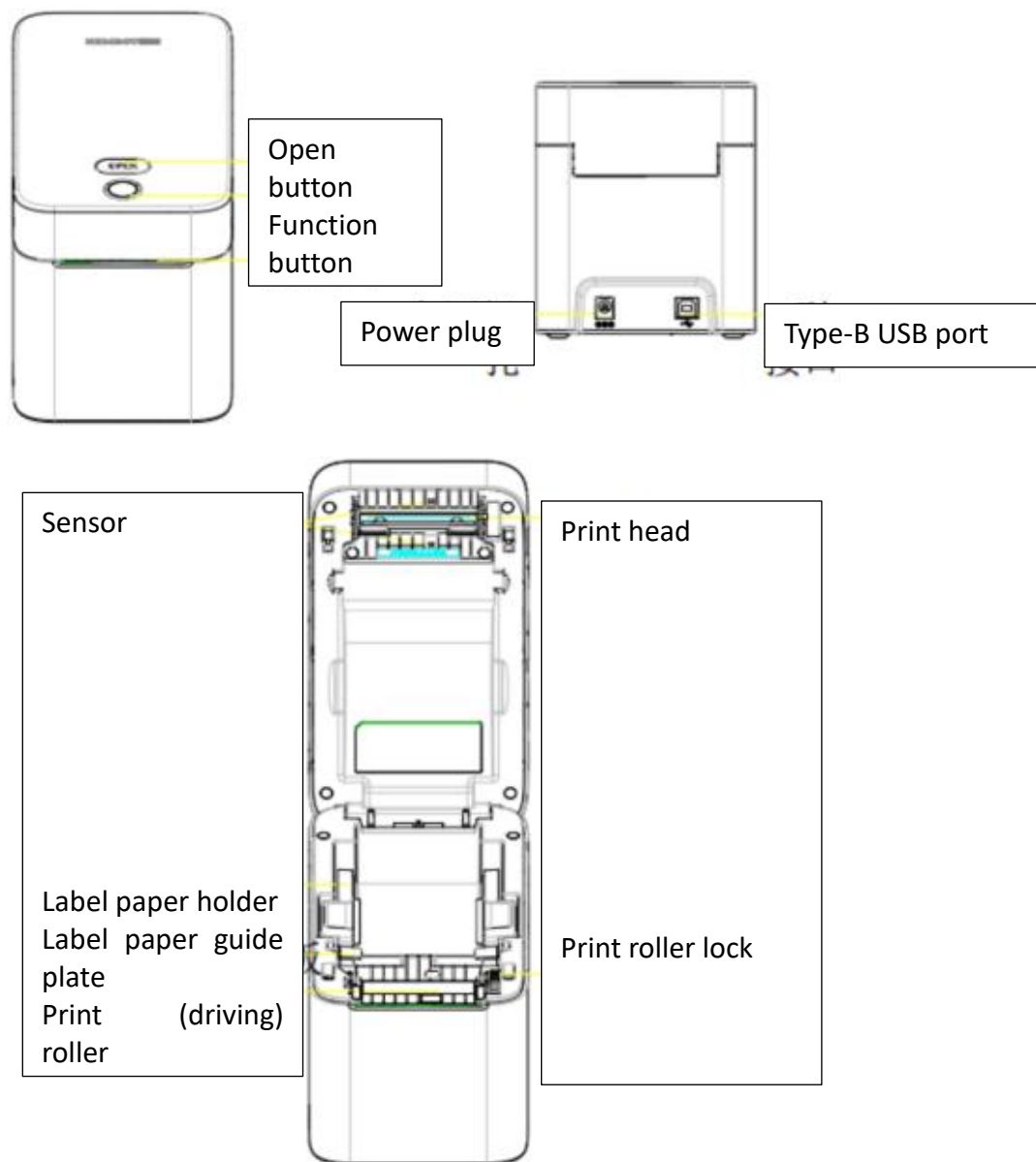

3.2 Button descriptions

Name	Action	Function
Open button	Press	Opens the paper compartment
Function button	Tap	Feeds one piece of paper when in Standby mode Cancels the print task when printing
	Tap and hold	Powers the printer on or off
	Double tap	Prints the self-test page

3.3 Status indicator descriptions

Color	Status	Description
-	Off	The printer is powered off
Blue	Solid	The printer is powered on, but not connected
	Flashing	Firmware upgrade in progress
Green	Solid	The printer is connected
	Slow flashing	Transmitting data
	Quick flashing	Printing
Red	Solid	Insufficient paper, compartment left open, stuck paper, etc. Refer to the "Troubleshooting" section

04 Operating Instructions

4.1 Switching the power adapter

Note: The product comes with power plugs for European, American and Australian power sockets. You can switch between them to suit your needs.



4.1.1 Press the power plug downward, and it will pop out automatically.



4.1.2 Insert the new power plug and press it in. The new power plug is fit into place when you hear a "click" sound.



4.2 Connecting to power supply

4.2.1 Connect the power cable to the DC connector of the printer.

4.2.2 Connect the other end of the power cable to an appropriate AC power socket.

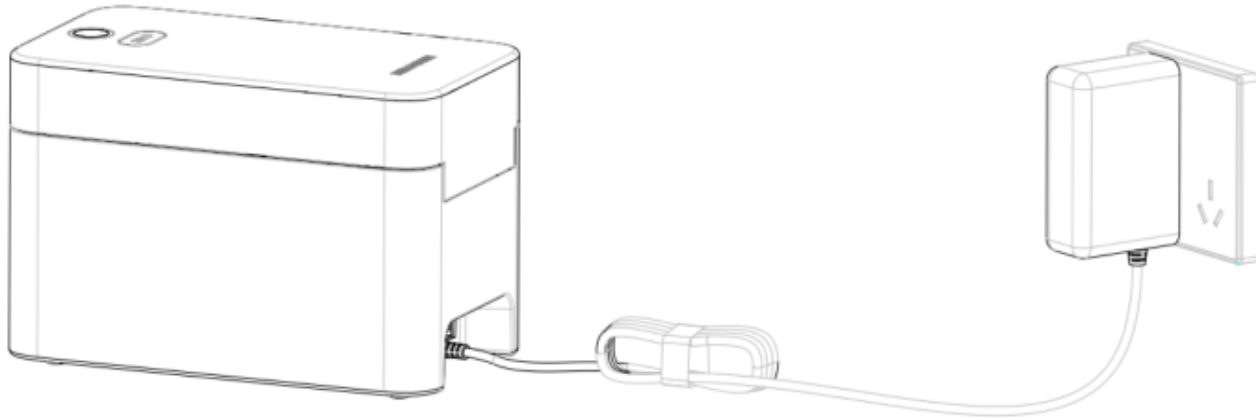

Note:

Please use the officially provided power adapter to avoid damaging the product or causing injuries.

If the printer is not in use for extended periods of time, please unplug the printer's power cable.

4.3 Loading the label paper

4.3.1 Face toward the front of the printer, press the "Open" button and pull up the compartment lid that pops up.

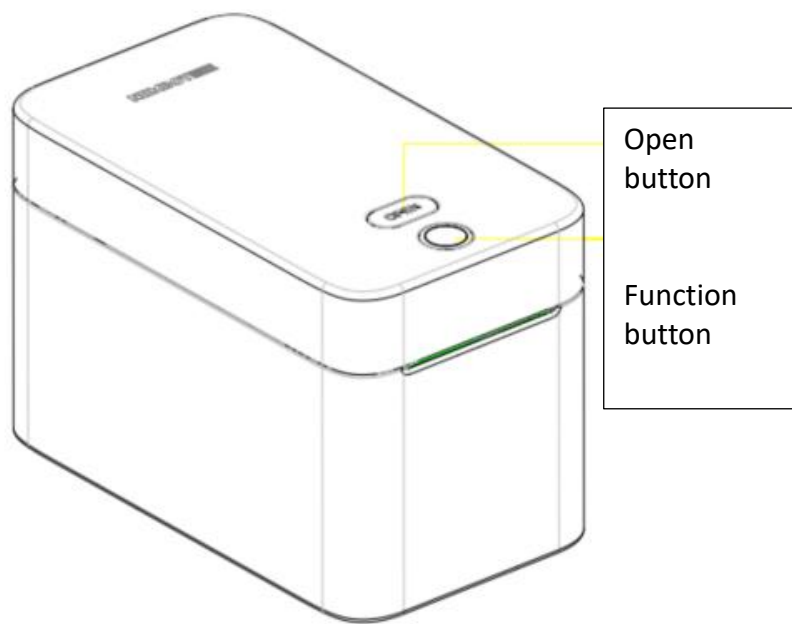

Note: Do not touch the paper cutter with your hands to avoid any injuries.

4.3.2 Open the label paper holder and adjust the orientation of the label paper roll so that the printing side will be facing upward when the paper runs through the print (driving) roller. Next, pull open the label paper guide plate, put the label paper roll onto the label paper holder and release the guide plate. Make sure the label paper roll is able to rotate freely. Do not put the label paper roll on the bottom of the paper compartment.

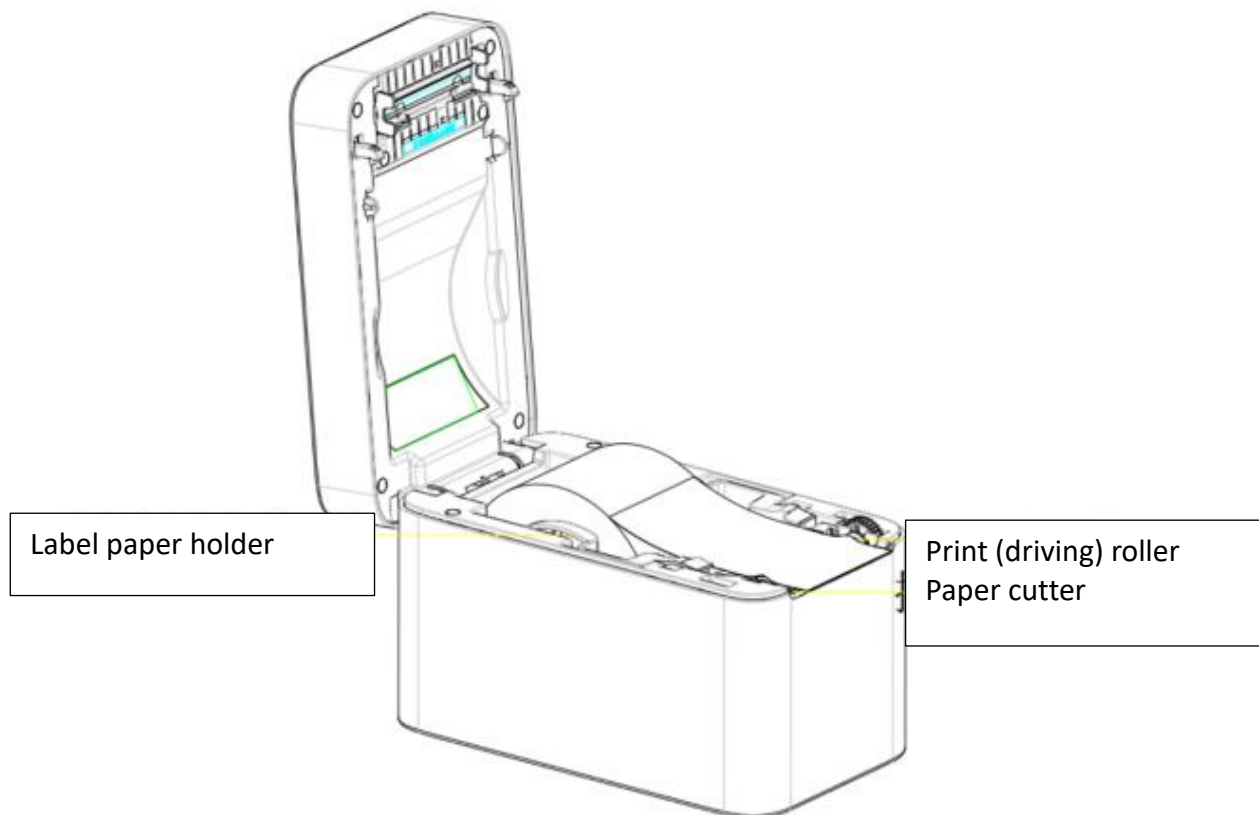

4.3.3 Run the label paper through the guide plate.

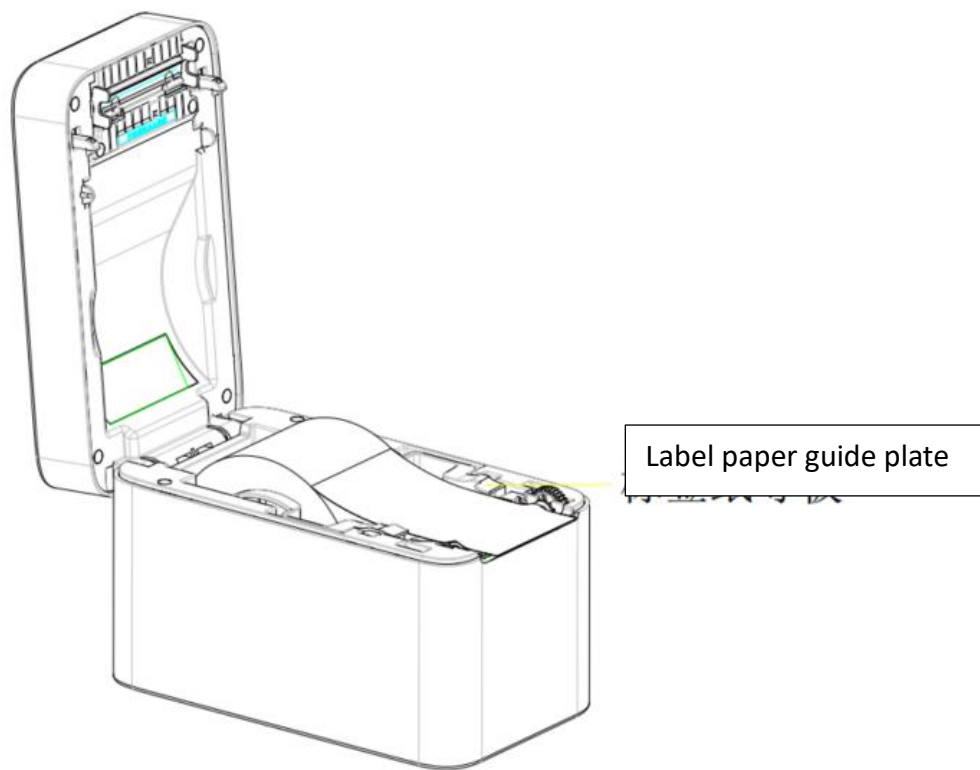

4.3.4 Close the paper compartment and press the lid gently until you hear a "click" sound. The lid is now locked, and the printer will retract the label paper automatically, indicating that the label paper has been loaded successfully.

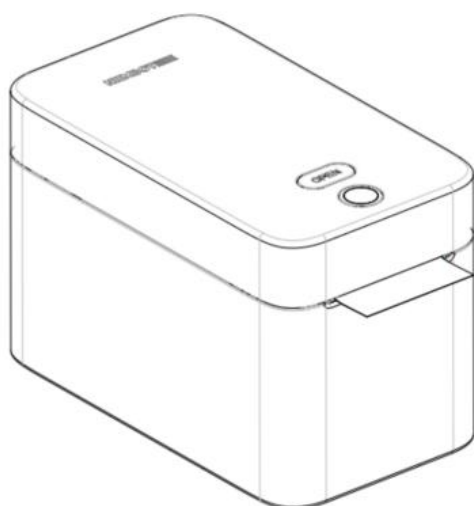

Note:

1. If you do not run the label paper through the guide plate, printed text may be offset.
2. If you do not pull the label paper out of the printer's paper outlet, the label paper may not be able to come out properly, resulting in printing failures.

05 Software Downloads

5.1 Downloading the mobile app

Before using this product, please download the NIIMBOT app from Google Play or the App Store.

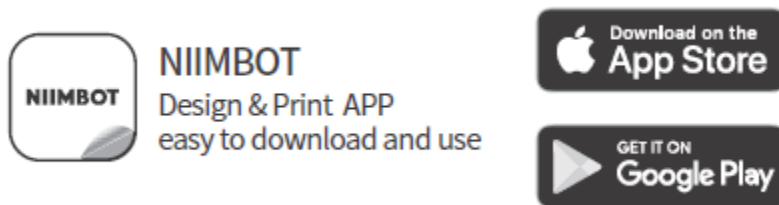

*You can find more user instructions in the NIIMBOT app.

Log in to the NIIMBOT app and go to My - Help Center - Hardware Operating Instructions for more details.

5.2 Downloading the desktop app

You can visit the NIIMBOT official website (www.niimbot.com) and go to the Apps page to download the NIIMBOT desktop app.

5.3 Establishing connection

5.3.1 USB connection

(1) This printer supports the following communication interface standard: USB Type-B cable.

(2) Steps:

(2.1) Connect the USB cable to the USB port on the back of the printer.

(2.2) Power on the printer.

5.3.2 Bluetooth connection

(1) Power on the printer.

(2) Open the NIIMBOT app.

(3) Select the printer and follow the in-app instructions to establish the connection.

5.4 Installing Windows drivers

You can visit the NIIMBOT official website (www.niimbot.com) and go to the Apps - Download Driver page to

download the drivers.

06 Use and Maintenance

Tip: We recommend that you maintain your printer regularly to guarantee its performance and extend its service life.

Note: Before cleaning the printer, make sure you have powered it off and unplugged the power adapter.

6.1 Cleaning the exterior

6.1.1 Use a soft, dry cloth to wipe off any dust and stains on the printer.

6.1.2 Wet the cloth to wipe off stubborn stains.

Note: Do not use paint thinners, benzene, alcohol or any other organic solvents, as they may deform the printer's casing or damage its appearance.

6.2 Cleaning the print head

6.2.1 Before cleaning the print head, make sure you have powered off the printer.

6.2.2 Use a cleaner pen to wipe the black area of the print head. Wipe from the middle area to the sides, so the glue that came from the sides can be wiped out of the way of the label paper.

6.2.3 After cleaning is finished, let the printer stand and dry for one minute before closing the paper compartment.

Warning: The print head will become hot when printing. To avoid damaging the print head or injuring persons, do not touch the print head.

Warning: The buildup of static electricity in human bodies may damage the print head and other electronic components of the printer. Be sure to comply with the anti-static procedures when handling the print head or electronic components in the paper compartment.

6.3 Cleaning the sensor

6.3.1 Dust may accumulate on the sensor. This can be wiped off gently. If necessary, you can use a dry cotton swab to wipe off the dust. If any glue or other dirt persists, you can use an alcohol swab to wipe this off.

6.3.2 Use a dry cotton swab to wipe off any residues following the first cleaning.

6.3.3 Repeat the above two steps as needed until all residues and stains are wiped off the sensor. After cleaning is finished, let the printer stand and dry for one minute before closing the paper compartment or loading the label paper.

6.4 Cleaning and replacing the print roller

6.4.1 Open the paper compartment and take out the label paper.

6.4.2 Pull the wings on both sides of the print roller bearing lock toward the front of the printer and rotate them

upward.

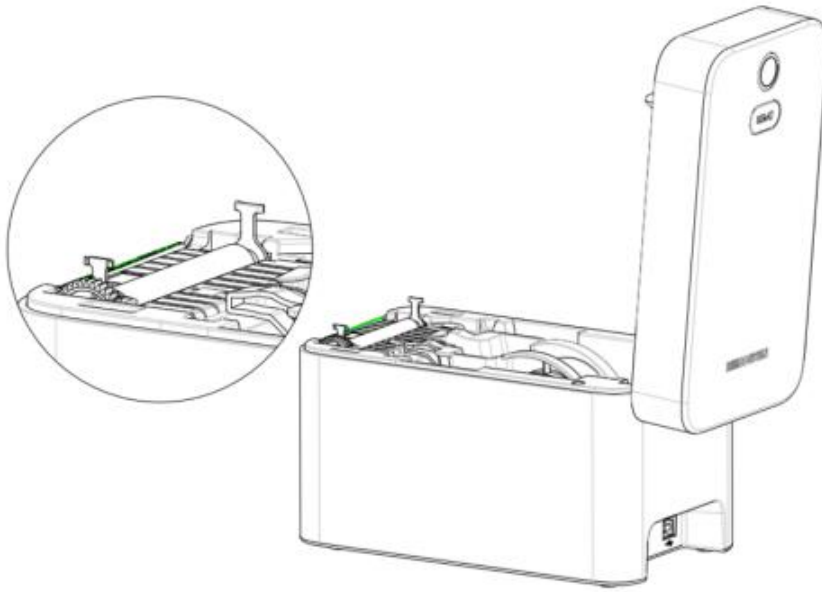

6.4.3 Pull the print roller upward and take it out of the bottom support of the printer.



6.4.4 Use alcohol swabs or lint-free cloths to clean the print roller. Wipe from the middle area to the ends repeatedly until the print roller surface is completely clean. In case of excessive sticky substances or tightly stuck label paper, use new swabs to clean the residues.

6.4.5 Fit the print roller back onto the bottom support of the printer.

6.4.6 Rotate the wings on both sides of the print roller bearing lock downward and fit them into place.

6.4.7 Let the printer stand and dry for one minute before closing the paper compartment or loading the label paper.

07 Troubleshooting

7.1 The red indicator is constantly on

Possible causes	Solutions
The paper compartment is not closed	Close the paper compartment
There is no label paper	Load the label paper. Please refer to Loading the label paper
The label paper is not pulled out of the paper compartment	Pull the label paper out of the paper compartment and close the paper compartment
The print head temperature is too high	Stop printing. Wait for the print head to cool down before printing again
A printing error occurred	Follow the in-app instructions

7.2 The printer cannot be found during Bluetooth connection

Possible causes	Solutions
The printer is not powered on	Connect to a power source and press the power button
The number of connected devices exceeds the limit	Disconnect other Bluetooth devices and discover again
Bluetooth is not enabled on your phone	Enable Bluetooth on your phone

7.3 The printer cannot be found during USB connection

Possible causes	Solutions
The printer is not powered on	Connect to a power source and press the power button
The USB cable is not connected	Refer to USB connection

7.4 The printer won't print or stops printing

Possible causes	Solutions
Power is off	If the indicator on the front of the printer is not lit up, make sure the power cable is plugged in
A paper feeding error occurred	Refer to Paper feeding faults
The USB cable has come loose	Make sure the USB cable at the back of the printer or on the computer is not loose
The Bluetooth connection is broken	Make sure the Bluetooth connection between the app and the printer is working normally

7.5 Printed labels are blurry

Possible causes	Solutions
The printing density is not set correctly	Adjust the printing density
The print head is dirty	Clean the print head Please refer to Cleaning the print head
The print roller is dirty or damaged	Clean or replace the print head. Please refer to Cleaning and replacing the print roller . If you need to purchase consumables, please contact Customer Service
The print head is worn	Please contact Customer Service to replace the print head
Non-NIIMBOT label paper is used	We recommend that you use NIIMBOT label paper

7.6 Nothing is printed on the label paper

Possible causes	Solutions
Non-heat-sensitive label paper is used	Use heat-sensitive label paper
The label paper is not loaded correctly	The label paper must be loaded with the printing side facing up toward the print head. Please refer to Loading the label paper

7.7 Paper feeding faults

Possible causes	Solutions
The label paper is not loaded correctly	Refer to Loading the label paper
The label paper is stuck	Open the paper compartment, pull the stuck paper out of the print roller and reload the paper
The label paper is used up	Replenish the label paper
The label type is set incorrectly	Make sure the label paper matches the type you selected in the app

10 Product Parameters/Specifications

10.1 Printer parameters

	Item	K2 parameter
Size	Dimensions (length × height × width)	210*140*120 mm
	Weight	1158 g
Printing	Print method	Heat-sensitive
	Resolution	203 dpi
	Print speed	Max 127 mm/s
	Effective printing width	56 mm
	Printing length	15–300 mm
	Print head service life	50 km
Communication port	Bluetooth	5.2 dual-module Bluetooth
	USB	Type-B USB
Power supply	Power adapter	Input: 100–240 V AC 50/60 Hz; Output: 12.0 V DC 2.5 A
Consumables	Type	Die-cut label
	Width	20–60 mm
	Length	15–350 mm
	Thickness	0.08–0.20 mm
	Paper roll diameter	Max 105 mm
	Paper roll internal diameter	25.4 mm, 40 mm
Programming language		JCPL
Software	Label design	NIIMBOT app (mobile and desktop)

	Driver	Windows 7, 10 and 11
Human-machine interaction	Button	Open button, Function button
	Indicator	Red, green and blue
Environment	Working environment	0–40°C, 10–85%, no condensation
	Storage environment	-10–60°C, 10–90%, no condensation

10.2 Label paper



Note: We strongly recommend that you use official NIIMBOT consumables for sustainable, high-quality printing. Official label products are specifically designed to improve printer performance and prevent premature wear and tear of the print head.

10.2.1 Verifying label material

- (1) You can use your nails or sharp objects to scratch the printing side of common heat-sensitive labels.
- (2) Official NIIMBOT heat-sensitive labels have improved anti-friction and water-proof performance.
- (3) Heat the label with a lighter and check whether black marks appear on the label.

Black marks on the label	Label material
Yes	Heat-sensitive paper. Compatible with this printer
No	Heat transfer paper. Carbon ribbons are required. Not compatible with this printer

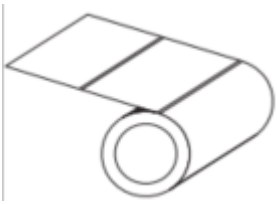
10.2.2 Label type description

Label type	Appearance	Feed method	Description
Non-continuous roll paper		Gaps	Labels are separated by gaps 
		Black marks	Labels are separated by pre-printed black marks on the back of the label paper

			
		Transparent	Labels are transparent and separated by gaps

70mm

110mm

L'émetteur/récepteur exempt de licence contenu dans le présent appareil est conforme aux CNR d'Innovation, Sciences et Développement économique Canada applicables aux appareils radio exempts de licence. L'exploitation est autorisée aux deux conditions suivantes :

- (1) L' appareil ne doit pas produire de brouillage;
- (2) L' appareil doit accepter tout brouillage radioélectrique subi, même si le brouillage est susceptible d' en compromettre le fonctionnement.

Radio Frequency Exposure Statement for IC:
This equipment complies with IC exposure limits set forth for an uncontrolled environment. This equipment can be used in portable exposure conditions.

Déclaration d'exposition aux radiofréquences pour IC:
Cet équipement est conforme aux limites d'exposition IC établies pour un environnement non contrôlé. Cet équipement peut être utilisé dans des conditions d'exposition portables.

American Responsible Party

Company name : AMERICAN JINGCHEN TECHNOLOGY CO., LTD
Address : 100 N HOWARD ST STE R, SPOKANE, WASHINGTON, 99201 USA
Tel : 323-510-4660
E-mail : zhanghong@niimbot.com

© 2024 NIIMBOT. All Rights Reserved.
NIIMBOT is a brand under Wuhan Jingchen Intelligent Identification Technology Ltd.

Declaration of conformity

Hereby, Wuhan Jingchen Intelligent Identification Technology Co., Ltd. declares that this device is in compliance with the essential requirements and other relevant provisions of Radio Equipment Directive (RED) 2014/53/EU. This product can be used across EU member states. This device can be used in European Union.
Herby, [Wuhan Jingchen Intelligent Identification Technology Co., Ltd.] declares that the radio equipment type [NIIMBOT K2] is in compliance with Directive 2014/53/EU.
The full text of the EU declaration of conformity is available at the following internet address:<http://www.niimbot.com>.

Konformitätserklärung

Hiermit erklärt Wuhan Jingchen Intelligent Identification Technology Co., Ltd. dass dieses Gerät mit den grundlegenden Anforderungen und anderen relevanten Bestimmungen der Funkanlagenrichtlinie (RED) 2014/53/EU übereinstimmt. Dieses Produkt kann in allen EU-Mitgliedstaaten verwendet werden. Dieses Gerät kann in der Europäischen Union verwendet werden. Hiermit erklärt [Wuhan Jingchen Intelligent Identification Technology Co., Ltd.], dass das Funkgerät des Typs [NIIMBOT K2] mit der Richtlinie 2014/53/EU konform ist. Der vollständige Text der EU-Konformitätserklärung ist auf der folgenden Website verfügbar: <http://www.niimbot.com>.

Déclaration de conformité

Par la présente, Wuhan Jingchen Intelligent Identification Technology Co, Ltd déclare que cet appareil est conforme aux exigences essentielles et aux autres dispositions pertinentes de la directive relative aux équipements hertziens (RED) 2014/53/UE. Ce produit peut être utilisé dans tous les États membres de l'Union européenne. Cet appareil peut être utilisé dans l'Union européenne. Par la présente, [Wuhan Jingchen Intelligent Identification Technology Co., Ltd] déclare que l'équipement radio de type [NIIMBOT K2] est conforme à la directive 2014/53/UE. Le texte intégral de la déclaration de conformité de l'UE est disponible sur le site web suivant : <http://www.niimbot.com>.

NIIMBOT

FCC Statement

This device complies with part 15 of the FCC Rules. Operation is subject to the following two conditions: (1) this device may not cause harmful interference, and (2) this device must accept any interference received, including interference that may cause undesired operation.

Any changes or modifications not expressly approved by the party responsible for compliance could void the user's authority to operate the equipment.

NOTE: This equipment has been tested and found to comply with the limits for a Class B digital device, pursuant to Part 15 of the FCC Rules. These limits are designed to provide reasonable protection against harmful interference in a residential installation. This equipment generates, uses and can radiate radio frequency energy and, if not installed and used in accordance with the instructions, may cause harmful interference to radio communications.

However, there is no guarantee that interference will not occur in a particular installation. If this equipment does cause harmful interference to radio or television reception, which can be determined by turning the equipment off and on, the user is encouraged to try to correct the interference by one or more of the following measures:

- Reorient or relocate the receiving antenna.
- Increase the separation between the equipment and receiver.
- Connect the equipment into an outlet on a circuit different from that to which the receiver is connected.
- Consult the dealer or an experienced radio/TV technician for help.

The device has been evaluated to meet general RF exposure requirement. The device can be used in portable exposure condition without restriction.

Declaración de conformidad

Por la presente, Wuhan Jingchen Intelligent Identification Technology Co., Ltd. declara que este dispositivo cumple los requisitos esenciales y otras disposiciones pertinentes de la Directiva sobre equipos radioeléctricos (RED) 2014/53/UE. Este producto puede utilizarse en todos los estados miembros de la UE. Este dispositivo puede utilizarse en la Unión Europea.
Por la presente, [Wuhan Jingchen Intelligent Identification Technology Co., Ltd.] declara que el equipo de radio tipo [NIIMBOT K2] cumple la Directiva 2014/53/UE. El texto completo de la declaración de conformidad de la UE está disponible en el siguiente sitio web: <http://www.niimbot.com>.

Dichiarazione di conformità

Con la presente, Wuhan Jingchen Intelligent Identification Technology Co., Ltd. dichiara che questo dispositivo è conforme ai requisiti essenziali e alle altre disposizioni pertinenti della Direttiva sulle apparecchiature radio (RED) 2014/53/UE. Questo prodotto può essere utilizzato in tutti gli Stati membri dell'Unione Europea. Questo dispositivo può essere utilizzato nell'Unione Europea.
Con la presente, [Wuhan Jingchen Intelligent Identification Technology Co., Ltd.] dichiara che il tipo di apparecchiatura radio [NIIMBOT K2] è conforme alla Direttiva 2014/53/UE. Il testo completo della dichiarazione di conformità dell'UE è disponibile sul seguente sito web: <http://www.niimbot.com>.

Canadian Statement

This device contains licence-exempt transmitter(s)/receiver(s) that comply with Innovation, Science and Economic Development Canada's licence-exempt RSS(s). Operation is subject to the following two conditions:

- (1) This device may not cause interference.
- (2) This device must accept any interference, including interference that may cause undesired operation of the device.