

1. Prior to assembly, Status Verification

A) If you have already mounted a mechanical deadbolt. Please remove the existing deadbolts from the door and replace them with our smart deadbolt. Installation is drilling-free.

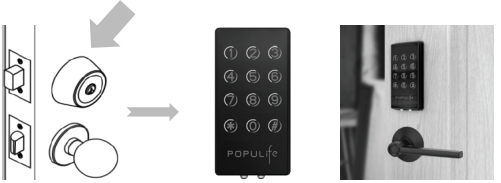

B) Verify the door's opening direction: if it is fastened in the left, push the toggle to the left. And if it fastened in the right, push it to the right.

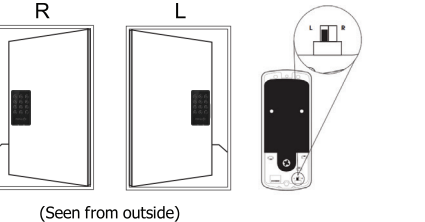

C) Kindly confirm the door's interior thickness. (Must be between 35mm to 55mm)



2. Parts & Components Layout

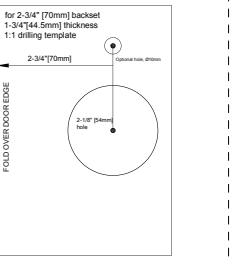
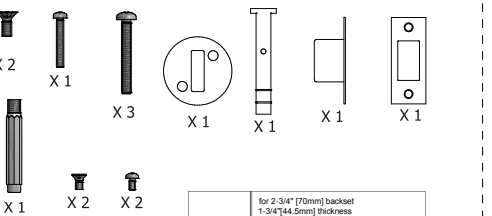
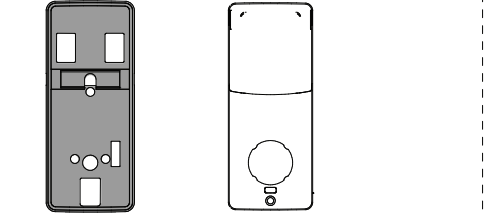
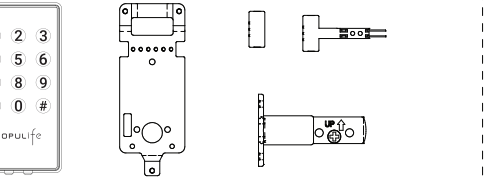

3. General Assembly

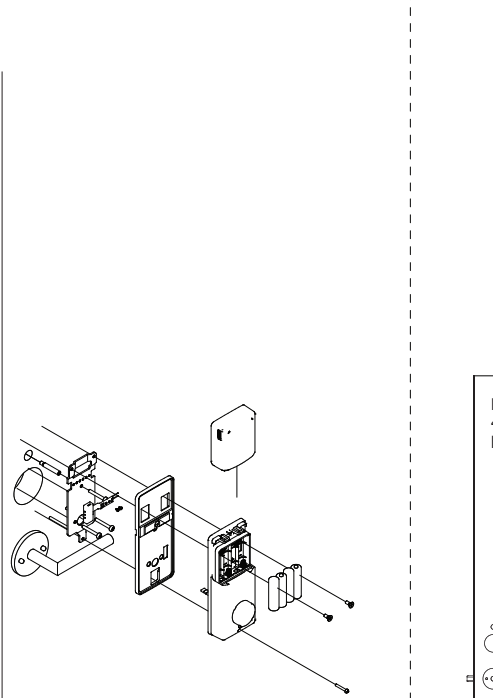

4. Set-Up

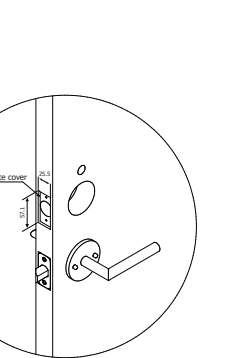

Leave an allowance of 4 inches between the handle and the drilled hole.



5. Insert the bolt

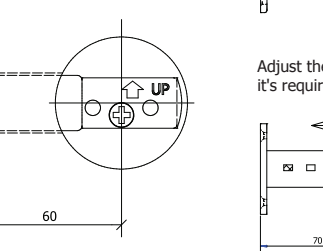
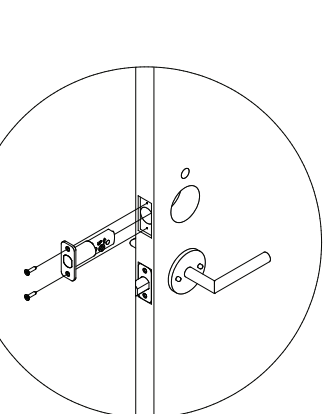

6. Touch-screen installation

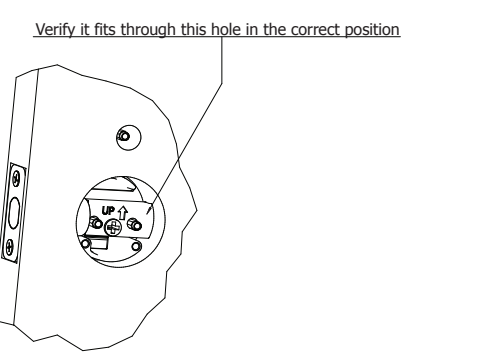
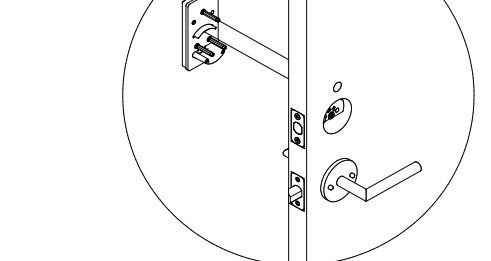
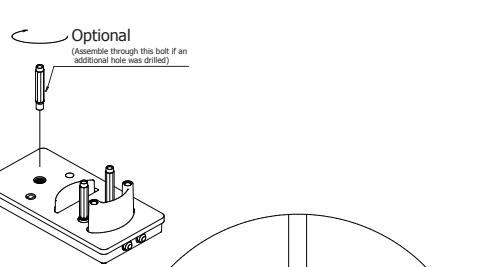

7. Back-side assembly

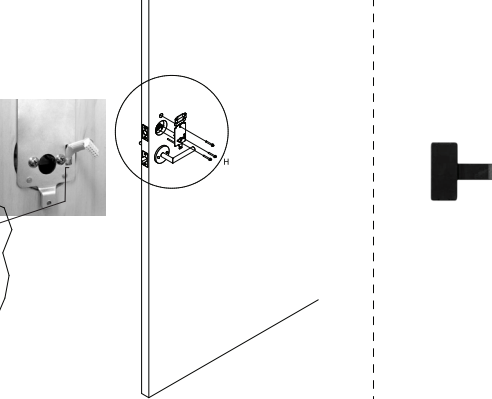
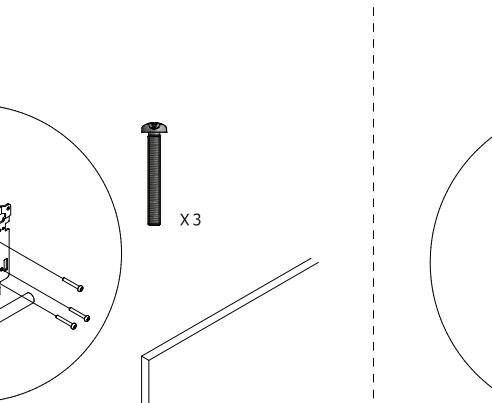

8. Sensor

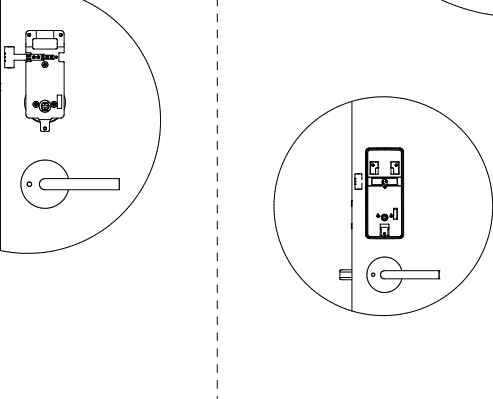
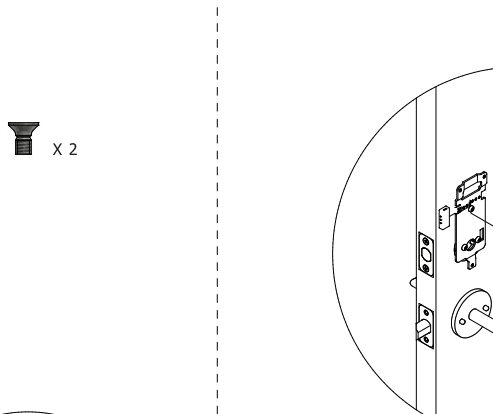

9. Rubber Pad

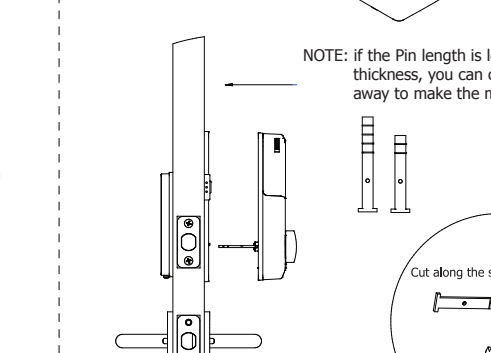
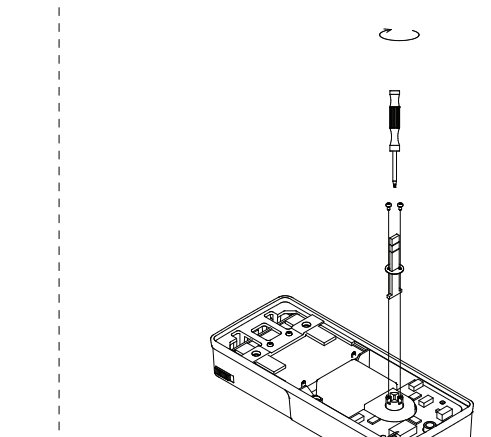

10. Access handle

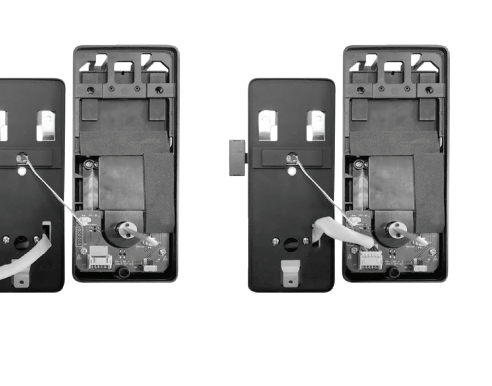
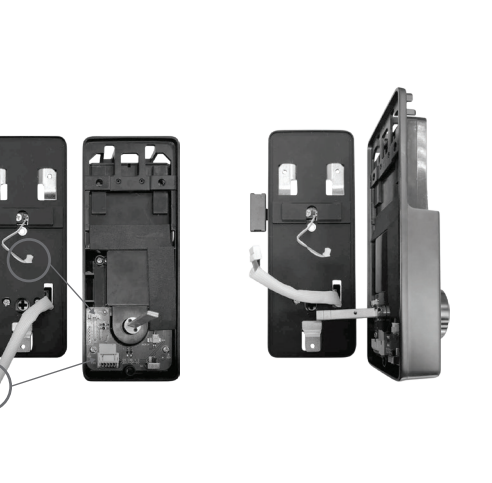

11. Attach the touchscreen's wires to the right port as shown below

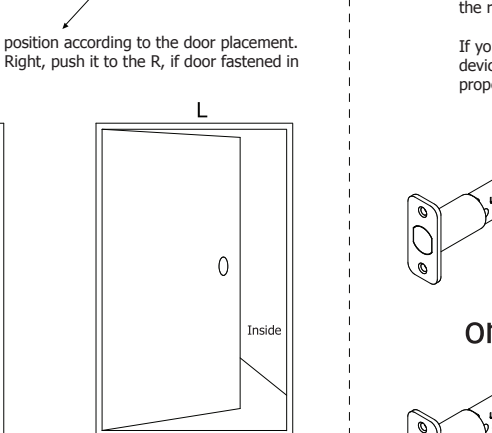
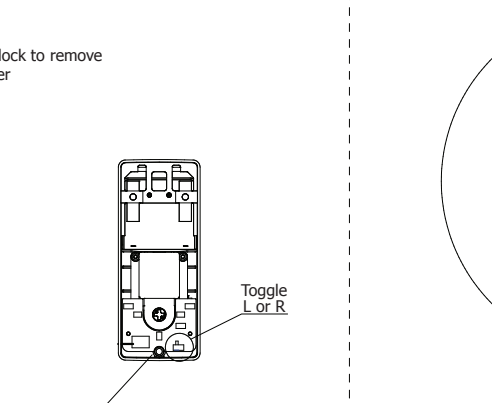

12. Remove the battery cover and set the toggle base as mentioned in Page 2. B)

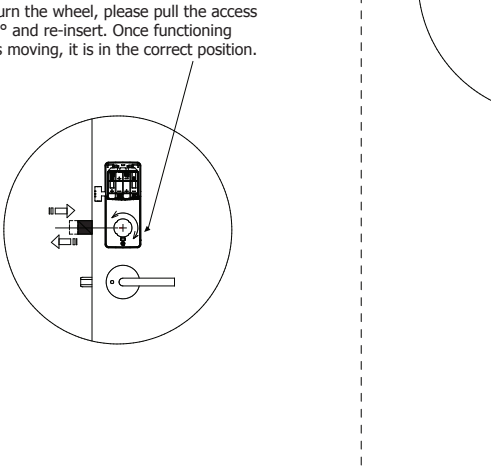
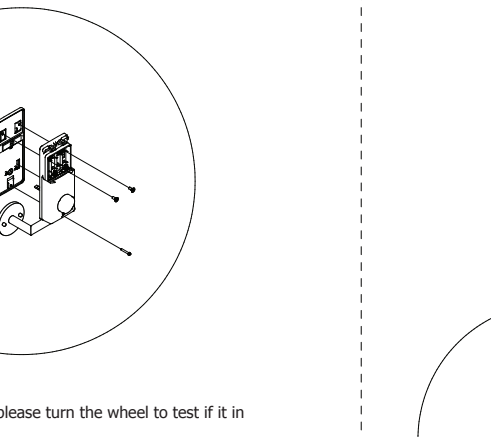

13. Rear Lock

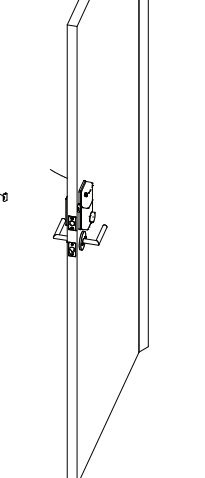
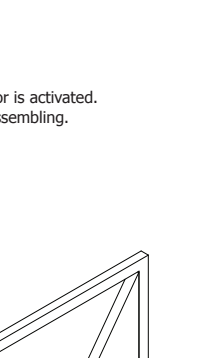

\*NOTE: The door will lock itself once sensor is activated. Do NOT insert the battery while assembling.



## 15. Strike plate and cover onto frame

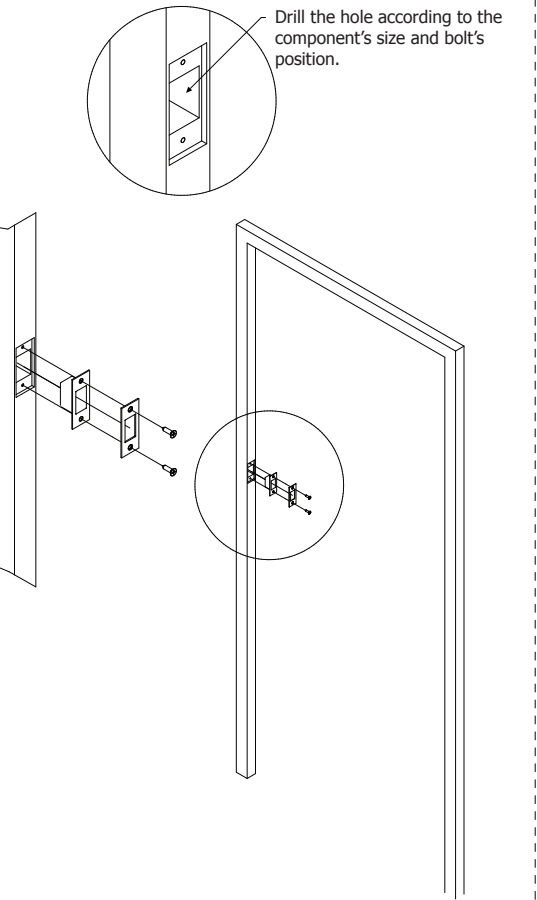

## 16. Batteries

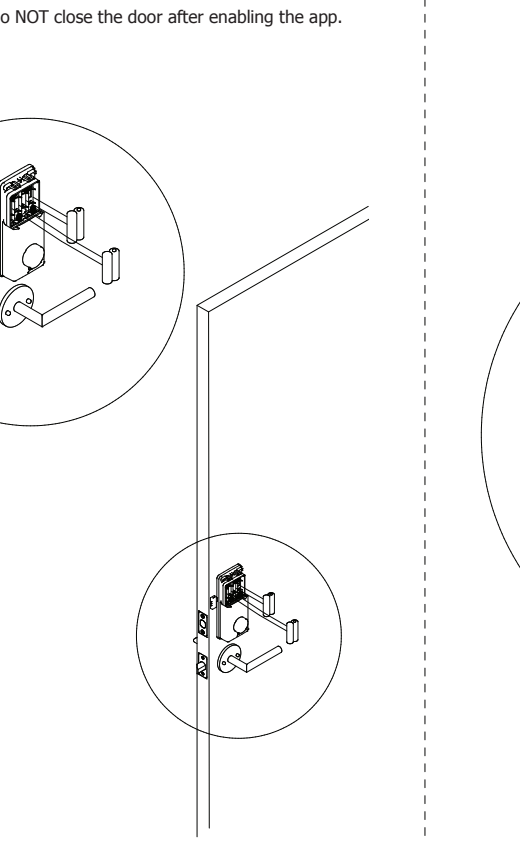

## 17. Battery Cover

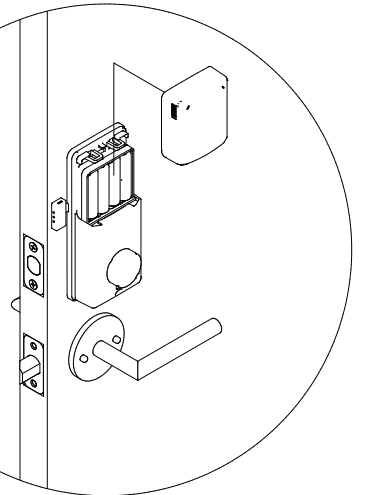

## Pairing (Part 1)

1. Download the Populife APP from the "App store or Google Play store".
2. Register as a new user or use your existing account to login.

### New User

Login--->Add lock--->Deadbolt V4

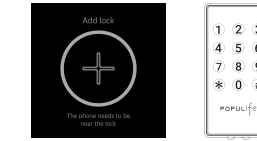

### Pairing

1. Turn on Bluetooth & Wi-Fi/Mobile data, use the screen's keypad to turn on the app
2. A list of lock will appear on your phone, select the one with indicated.

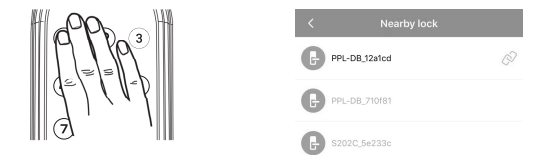

### Rename the lock

i.e.: "Front door 901", "John's home" or "42#CA"  
You can add several locks in your mobile phone, name it to distinguish which door was controlled

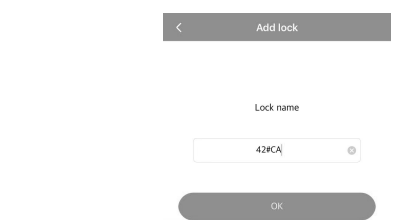

## Pairing (Part 2)

Add an additional lock to your mobile phone

Open the Populife APP--->Add lock ("+" in the upper right corner)

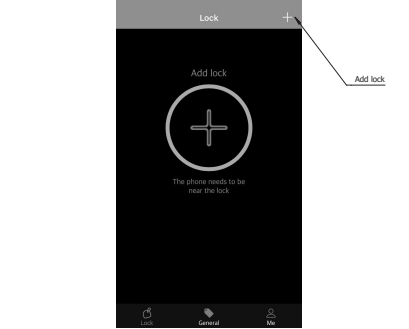

Use the screen's keypad to turn on the device.  
Follow the steps found on the previous page.

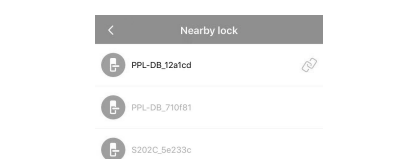

### Rename the lock

i.e.: "Front door 901", "John's home" or "42#CA"  
You can add several locks in your mobile phone, name them accordingly to avoid confusion

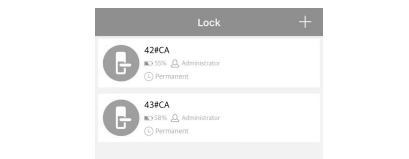

## Lock

### 1. Auto-Lock

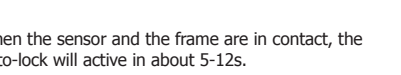

### 2. Lock via touchscreen

Press and hold the "#" icon displayed for 3s and the bolt will automatically lock the door

### 3. Lock via APP

Open the app and press the lock icon for 3s and lock mode will be enabled

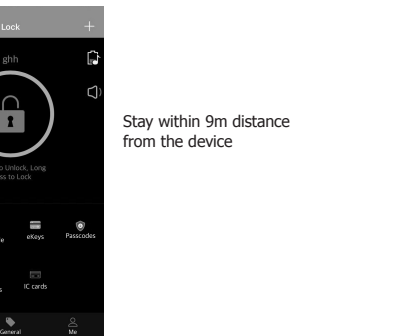

Stay within 9m distance from the device

## Unlock

### 1. Unlock via APP

Activate the Bluetooth and choose the lock icon displayed.  
Please keep within 9m distance of the door.



### 2. Unlocking with Master PIN code

- Go to Master PIN code ---> "Settings" ---> "Admin PIN code"

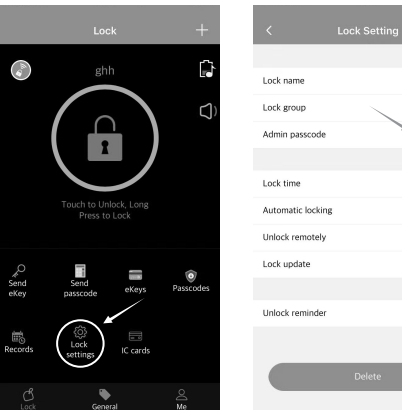

Type in the PIN code and end with a "#" to unlock

i.e.: 7989589#

You may add a few digits before inserting the correct number combination to prevent exposure to outside parties.  
i.e.: 47237989589# the first 4 no, 4723 is to confuse the intruders

## Unlock (Sharing Part 1)

### 3. Setting the PIN code for visitors and family members

The app can generate PIN codes for different users. Validity date is determined by the Administrator for either: one-time, permanent or a selected duration date.

Visitors or family members may use the PIN codes generated and unlock the door. All of this can be done with ease from your mobile phone.

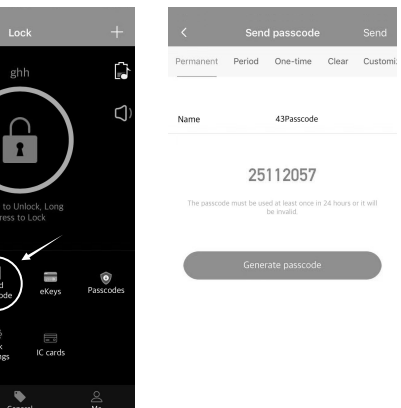

## Unlock (Sharing Part 2)

You may generate a Bluetooth key for your visitors or family members. The link that they received will be used to generate an e-key in their app.

(\*Make sure they have downloaded and registered in our Populife app)

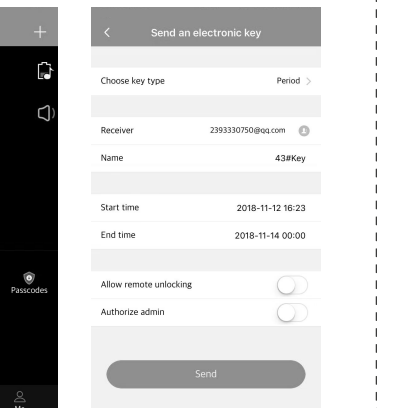

## Features and setting

### 1. Default factory PIN code

In "Factory Mode" (before pairing), the PIN to unlock is \*1234567890#

### 2. Privacy mode

To activate, press the key under the spinning wheel for 3s or more.

To deactivate, follow the same procedure or turn the wheel on your door.

During Privacy Mode, exterior parties will be unable to unlock the door with their app or PIN code

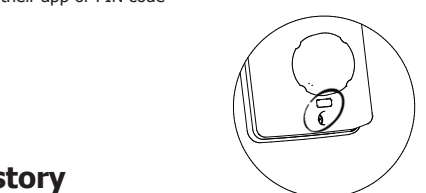

### 3. History

You can check the record in your APP to see when and who accessed the door.

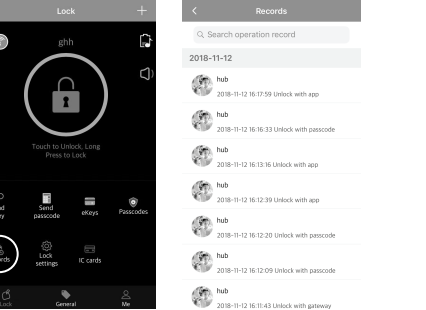

## Features and setting

### 4. Battery running out

In case it happens, you may use a 9V battery as an emergency power supply. Connect it with at the bottom of the device, switch on and use the PIN code or Bluetooth to access the door.

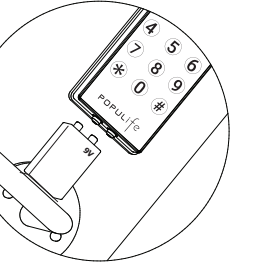

### 5. Delete the lock from your phone

If you want to permit others to control this lock, You have to delete the lock from your phone first. So that other mobile phone can pair with it and use it.

Under "Lock setting" ---> "Delete"

You have to make sure your phone is near to your lock within 9 meters distance.

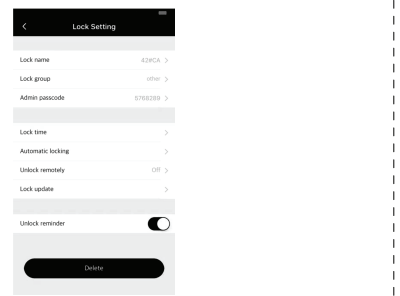

## FAQ

### 1. Why can't I pair?

Please double-check that your mobile's device Bluetooth and Wi-Fi/4G is turned on. Then touch the screen to activate the door.

### 2. Why isn't the touch screen active?

Verify that the batteries have been inserted properly. Remove and re-insert them.

### 3. Why is the touchscreen unresponsive?

i) If you insert the wrong PIN code more than 5 times, touchscreen will be disabled for 5 minutes. Please wait patiently and verify you have the right code with the Administrator.

ii) Check if "Privacy Mode" is activated, turn the bolt in & out a few times to disable the mode.

### 4. My deadbolt seems to turn in the wrong direction

Kindly check the door's opening direction. Remove the lock and adjust appropriately based on the information provided on Page 2, B).

### 5. Why I can't delete my existing lock from the app?

You have to be in proximity of the device (9m) with your mobile and then simply delete it from your app.

### 6. How far away can I be to control effectively control the door?

We suggest around 9m, if there are objects within that distance, please step closer.

# User Guide

## Smart Deadbolt V4

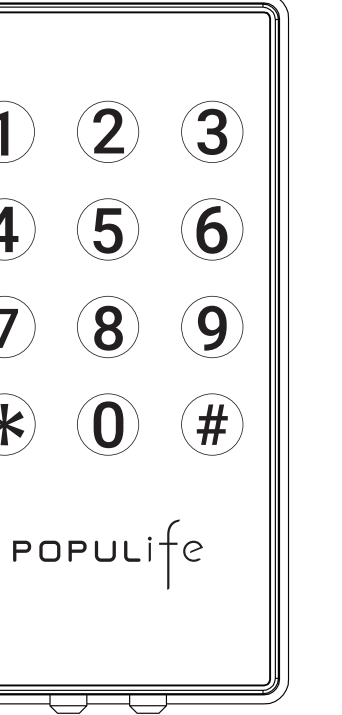

#### FCC Warning Statement

Changes or modifications not expressly approved by the party responsible for compliance could void the user's authority to operate the equipment. This equipment has been tested and found to comply with the limits for a Class B digital device, pursuant to Part 15 of the FCC Rules. These limits are designed to provide reasonable protection against harmful interference in a residential installation. This equipment generates uses and can radiate radio frequency energy and, if not installed and used in accordance with the instructions, may cause harmful interference to radio communications. However, there is no guarantee that interference will not occur in a particular installation. If this equipment does cause harmful interference to radio or television reception, which can be determined by turning the equipment off and on, the user is encouraged to try to correct the interference by one or more of the following measures:

- - Reorient or relocate the receiving antenna.
- - Increase the separation between the equipment and receiver.
- - Connect the equipment into an outlet on a circuit different from that to which the receiver is connected.
- - Consult the dealer or an experienced radio/TV technician for help.

This device complies with part 15 of the FCC Rules. Operation is subject to the following two conditions:

(1) This device may not cause harmful interference, and

(2) this device must accept any interference received, including interference that may cause undesired operation.