

Wireless Charger EC150 Operating Instruction

Product specification parameter

Model : EC150
Capacity : 15W
Material:recycled ABS
Euroregistration number : 008546444-0001

Product illustrate

1. Wireless induction charger
2. Type C connector

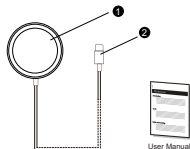

How to operate

1. Connect the magnetic wireless charger to an AC wall plug or any other adapter source of power



2. If your phone is not equipped with a magnet ring, you may stick the magnet ring provided with the charger. Please paste carefully in the exact location where the induction charging pad of your phone is.



Warning

Read all instructions and warnings prior to using this product. Improper use of this product may result in product damage, excess heat, toxic fumes, fire or explosion, for which damages you are responsible.

1. Do not store the device in high-temperature environment, including heat caused by intense sun light or other forms of heat. Do not place device in fire or other excessively hot environments.
2. Do not disassemble this device or attempt to re-purpose or modify it in any manner.
3. For questions or instructions for the various ways to charge using this device, refer to the Charging Your Wireless Device section of this manual.
4. Do not attempt to replace any part of this device.
5. If this device is accessible to or may be used by a minor, the purchasing adult agrees to be solely responsible for providing supervision, instruction, and warnings. The purchaser agrees to defend, indemnify, and hold manufacturer harmless for any claims or damages arising from unintended use or misuse by a minor.
6. All products have gone through a thorough quality assurance inspection.

If you find that your device is excessively hot, is emitting odor, is deformed, abraded, cut or is experiencing or demonstrating an abnormal phenomenon, immediately stop all product use and contact Manufacturer.

FCC statement:

This device complies with Part 15 of the FCC rules. Operation is subject to the following two conditions: 1) this device may not cause harmful interference, and 2) this device must accept any interference received, including interference that may cause undesired operation.

Note: This equipment has been tested and found to comply with the limits for a Class B digital device, pursuant to part 15 of the FCC Rules. These limits are designed to provide reasonable protection against harmful interference in a residential installation.

This equipment generates uses and can radiate radio frequency energy and, if not installed and used in accordance with the instructions, may cause harmful interference to radio communications. However, there is no guarantee that interference will not occur in particular installation. If this equipment does cause harmful interference to radio or television reception, which can be determined by turning the equipment off and on, the user is encouraged to try to correct the interference by one or more of the following measures:

- Reorient or relocate the receiving antenna.
- Increase the separation between the equipment and receiver.
- Connect the equipment into an outlet on a circuit different from that to which the receiver is connected.
- Consult the dealer or an experienced radio/TV technician for help.

Changes or modifications not expressly approved by the party responsible for compliance could void the user's authority to operate the equipment.

Radiation Exposure Statement

This device complies with FCC RF radiation exposure limits set forth for an uncontrolled environment. This transmitter must not be co-located or operating in conjunction with any other antenna or transmitter. During the operation of device a distance of 15 cm surrounding the device and 20 cm above the top surface of the device must be respected.