



ALTER
AGE **14+**



WORLD OF TANKS

Funkferngesteuerter / Radio Controlled

Tiger I / T-34/85



Maßstab / Scale

1/30

2.4GHz

Fernsteuerung
Remote Control

NICHT GEEIGNET FÜR KINDER UNTER 14 JAHREN!
NOT SUITABLE FOR CHILDREN UNDER 14 YEARS!

TABLE OF CONTENTS

| | Page |
|--|------|
| Caution notes, safety notes and disclaimer of warranty | 3-4 |
| Scope of Delivery..... | 5 |
| Battery caution and safety notes..... | 6 |
| Battery pack caution and safety notes..... | 6 |
| Battery pack charging | 7 |
| Remote control functions..... | 8-12 |
| Remote control binding..... | 12 |
| Infrared function..... | 13 |
| Accessories..... | 14 |
| Warranty exclusion..... | 15 |
| Notes..... | 16 |

© COPYRIGHT

Torro GmbH, D-63762 Großostheim. Any publication, reproduction, distribution, or commercial use is subject to written consent. All article names and pictures or illustrations are property of the respective manufacturer or of Torro GmbH. Copyright is extended to translations and layout. All contents of the manual are subject to change. No liability is assumed for changes and errors.

CAUTION NOTES

PLEASE READ THESE OPERATING INSTRUCTIONS CAREFULLY

The manufacturer is not liable for injuries and accidents caused by improper use, alteration, or disassembly of the product. Such altered or disassembled products will not be repaired by the manufacturer.

- Never attempt to disassemble or modify the device. This can lead to malfunctions or hazards.
- The manufacturer does not offer any repair service for such products that have been modified or disassembled in any way by the user!
- Should the model interior or the remote control get wet due to rain or immersion into water, stop operating the tank because this may cause malfunctions.
Remove all batteries and contact your local dealer.
- Do not expose the model or the remote control to strong sunlight. This may cause deformation or malfunction.

Keep this manual for further reference. If the manual is lost, contact your dealer.

SAFETY NOTES AND DISCLAIMER OF WARRANTY

RC models are not toys for children. Only responsible and careful acting persons may use the model. Exact work, technical understanding, and a safety-oriented attitude are absolutely necessary when assembling and operating the tank. Each mistake during assembly or operation can result in severe damages or injuries. If you are unexperienced in using model vehicles, do let a person with experience show you how to operate such models.

Never operate the model near to people, animals, or on public roads in order to avoid accidents. Always make sure that there are no persons or animals or any obstacles close to the operating area. Check the model for damages before each use and make sure that only a model free from any damages or problems will be operated.

Switch on the transmitter first and then the RC model. Check the operating distance to get a feeling for the maximum operating distance. When switching off the devices, switch off the model first and then the transmitter.

You as a holder are liable for damages which occur as a result of operating a model vehicle. Torro GmbH does not have any control over the handling, the compliance with assembly and operation notes as well as the actual operation of the model and its maintenance. Therefore, Torro GmbH is not liable for any damages, losses, or costs of any kind. Torro GmbH repudiates liability for each and every compensation claim, which results from operating or using the model or its components or which relates to such operating or using. We are not liable for any injury to persons, material damages, and the consequences therefrom, which result from our delivery. Unless legislation states otherwise, any award of damages is restricted to the invoice value of the product.

No liability is accepted for misprints, translation errors or mistakes that may have occurred during the preparation of the operating instructions.

We reserve the right to make technical and optical changes! Pictures may differ from the original.

CAUTION NOTES

PLEASE READ THESE OPERATING INSTRUCTIONS CAREFULLY

This RC battle tank is not a toy but a tank model controlled by radio signals.

Please use carefully to avoid injuries and damages. Please read through the following caution notes!

⚠ Do not put hands in between the wheels or onto the tracks.

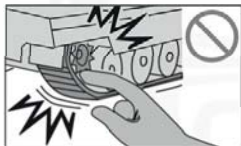

Keep hands or fingers away from wheels and tracks to avoid injuries. To hold or lift the tank do not use wheels or tracks in order to avoid damage and/or malfunctions.

⚠ Do not use tank near or on public roads!



Do not use tank at or on public roads to avoid traffic accidents. Also, do not play in water pits, on sand, or on carpets in order to avoid malfunctions.

⚠ Avoid swallowing of small parts by infants and small children!



Keep small parts and packing material out of reach of infants and small children in order to avoid accidental swallowing of such parts or material.

⚠ Shut down all systems after use.



After use set main switch to "OFF". Remove batteries to avoid discharge or leakage.

⚠ Do not use infrared battle system in strong sun light!

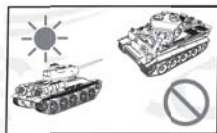

Strong sun light may affect the infrared controlled battle functions of the tank and cause malfunctions. It is recommended not to use the IR battle functions under such conditions.

SCOPE OF DELIVERY



Warning

Not following the warning notes may cause injuries and malfunctions.
Please follow all warning notes!

Use tanks indoors only, outdoor use at your own risk!

This tank is a high-precision product and should be used with care.
Avoid shocks and dust, sand or stones entering the body or the wheels and tracks.
This also applies for the remote controller.
The manufacturer is not liable for damages or malfunctions because of warning notes not being followed.

Please, do follow all warning and safety notes in this manual!

Check the correct functioning of the tank before attaching the accessories!



Be careful when using tools!



Warning Batteries

Crack



Do not use damaged
batteries to avoid
short circuit!

MANUAL



REMOTE CONTROL



3x 1,5V AAA Batteries
(not included)

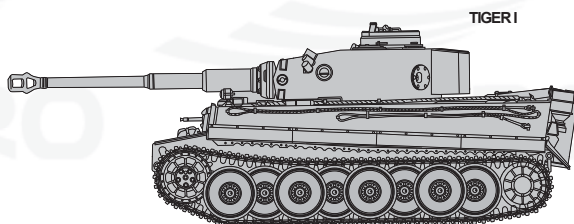

TIGER I

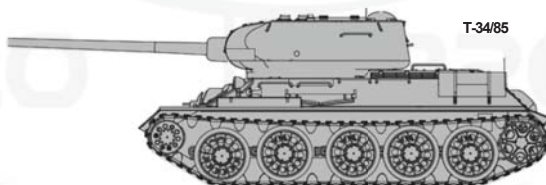

T-34/85

ACCESSORIES:



3,6V 600 mAh Ni-Mh
Battery pack



Charging cable

BATTERIES**Warning**

Not inserting batteries with the correct polarity may cause battery leakage or device malfunction.

**Warning**

Do not use different types of batteries together. This may result in battery leakage and burn injuries.

**Warning**

Remove batteries from the remote control if it will not be used for a long period of time. Batteries can leak (acid).

**Warning**

Environmental protection: Return used batteries to known collection points.

CAUTION AND SAFETY NOTES**■ Remote control****ON/OFF Sequence for Devices:**

When turning on power, turn on remote control first then the tank. Sequence for turning off power is vice versa.

1. Loosen the screws of the battery compartment cover using a screwdriver. Remove the cover.
2. Insert the batteries and make sure that the +/- polarity is correct.
3. Slide the cover back on and fix it with the screw.



English

BATTERY PACK**CAUTION AND SAFETY NOTES****Warning**

- Make sure voltage and plug of charger correspond to local standards.
- Battery pack and charger are matched for safety reasons. Do not use other devices. This might cause explosions!
- Do not leave charging unattended.
- Depending on how long the tank is operated, battery pack may become very hot. Allow battery to cool down for at least 30 minutes before charging it in order to prevent damage.
- Do not cover battery pack during charging process and always keep battery away from flammable materials.
- Do not throw battery pack into open fire: explosion hazard!
- A heat development generated in the battery and the charger during charging is normal when charging is done properly!
- Failure to comply with these notes may result in defects to the battery!
- Lithium batteries must not be used!

BATTERY PACK CHARGING

Charging process with the supplied charging cable.

1. Plug the USB cable into a USB port on the computer or a dedicated adapter.
The power indicator lights up.
2. Connect the cable from the battery pack to the USB plug. The power indicator goes out.

The battery is fully charged when the power indicator lights up red.

The input voltage at the USB interface is DC 5V \pm 0.5V

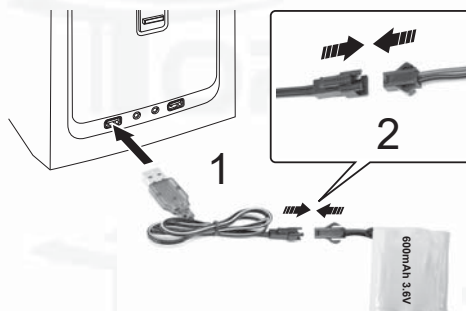

3. Set the tank to "OFF".
Loosen the screws of the battery cover by using a screwdriver.

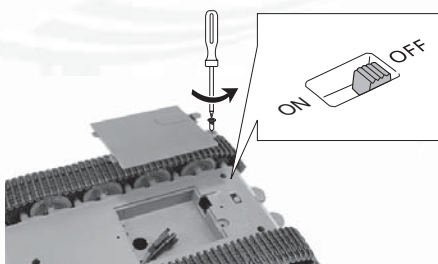

4. Connect the two plugs as shown.
Close the cover again.





Note

If the tank slows down, it is a sign that the battery needs to be charged.
Remote control range: about 20 meters
Combat range: up to 8 meters

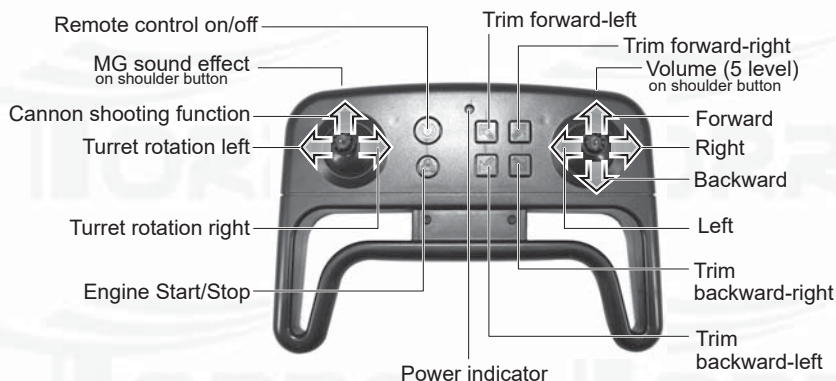

REMOTE CONTROL FUNCTIONS



Switch on:

1. Insert batteries into the remote control with the correct polarity.
2. Connect the battery pack to the tank.
3. Press and hold "ON/OFF" on remote control  for approx. 2 seconds.
4. Acoustic signal will start and the power indicator on the remote control will light up.
The remote control is now ready for operation.
5. Set the on/off switch on the bottom of the model to "ON".
6. Press and hold "Engine Start/Stop" on remote control .
As soon as you hear the acoustic sound and the model's headlights are illuminated, the model is ready for operation.

Switch off:

1. Press and hold "Engine Start/Stop" on the remote control .
2. Set the on/off switch on the bottom of the model to "OFF".
3. Press and hold "On/Off" on the remote control .
An acoustic signal sounds and the operating LED goes out.

REMOTE CONTROL FUNCTIONS

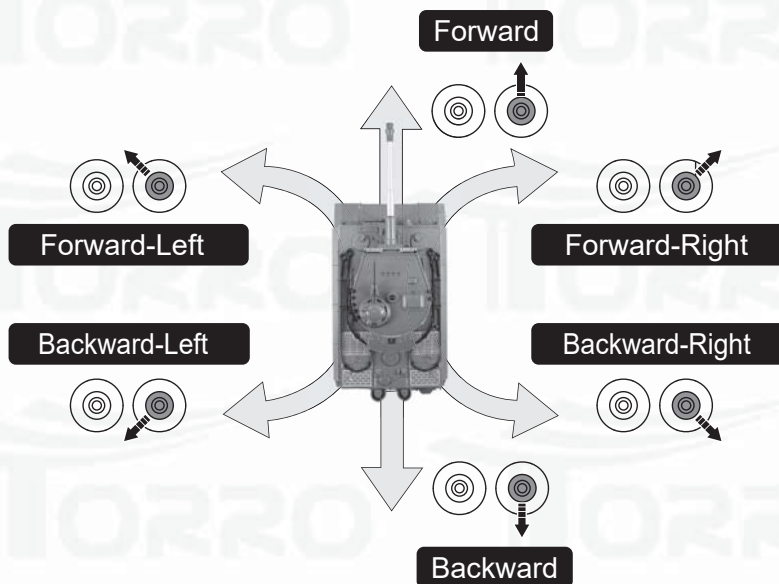

Trim left/right:

Note:

The trim function is used when the tank deviates to the left or to the right, when it should drive straight ahead.

This can be remedied with the trim to be set in the opposite direction:

If a leftward movement is visible, press the "Trim forward-right" button and vice versa.

If the trim is adjusted using the remote control, each change is signaled by a "beep" sound.

A "beep" sounds after each button press, regardless of the direction.

When the maximum trim in the respective direction is reached, no more sound is emitted.

If the remote control reaches the neutral position between Trim right & Trim left,

two successive "beeps" will sound.

REMOTE CONTROL FUNCTIONS

Trim Forward

If the tank deviates to the left when driving straight ahead, press the "Trim forward-right" button on the remote control until the tank drives straight ahead.

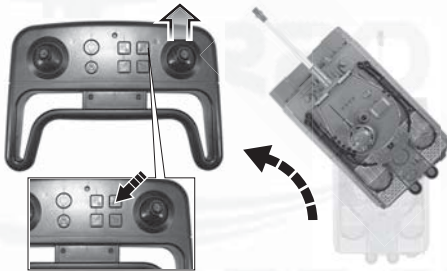

If the tank deviates to the right when driving straight ahead, press the "Trim forward-left" button on the remote control until the tank drives straight ahead.

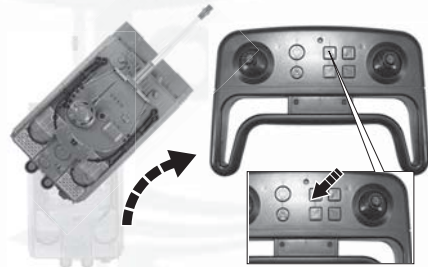

English

Trim Backward

If the tank deviates to the left when reversing, press the "Trim backward-right" button on the remote control until the tank moves straight.

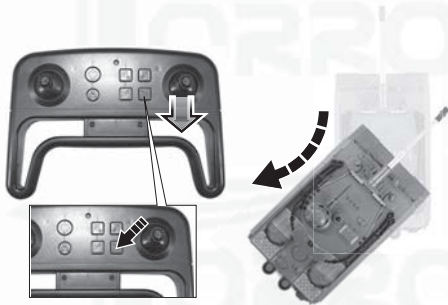

If the tank deviates to the right when reversing, press the "Trim backward-left" button on the remote control until the tank moves straight.

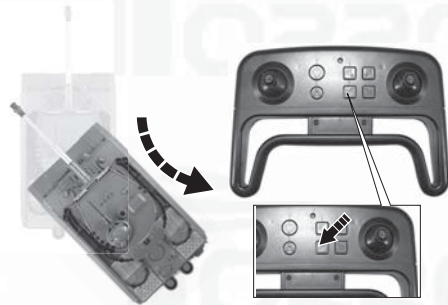

MG Fire

Press the left shoulder button for the MG effect. The MG LED flashes and the MG sound is heard as long as the button is pressed.

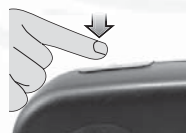

REMOTE CONTROL FUNCTIONS

Left



Press right control stick to the left.

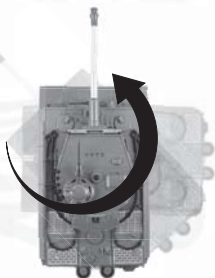

Right



Press right control stick to the right.

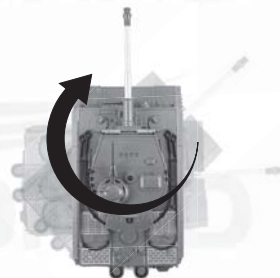

Turret rotation left



Press left control stick to the left.

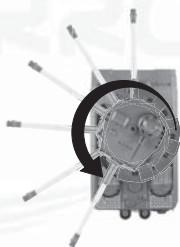

Turret rotation right

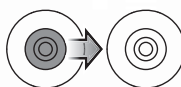

Press left control stick to the right.

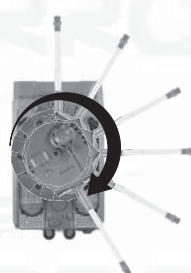

Warning

If the turret rotation reaches the maximum, the slipping clutch engages.

As soon as you hear a "clacking" sound, please stop rotating the turret to avoid damage to the model.

Do not hold down the control sticks if the tank comes to a surface that creates a lot of resistance or if the tracks come loose or something gets caught in them.

Otherwise, the undercarriage or the engine may be damaged.

If the tracks come loose, please reattach them before continuing to operate the model to avoid damage to the model.

Do not abruptly stop parts such as tracks, wheels or the turret while they are in motion to avoid damage to the model.

REMOTE CONTROL FUNCTIONS

The various functions can be combined to simulate realistic movement of the tank in the terrain. Below are some examples, whereby your own and new combinations can be devised:

Drive + cannon right/left

Drive + cannon firing function

Turn tank + MG firing function



Note

Combining several functions consumes more battery power than using individual functions separately.

REMOTE CONTROL BINDING

The code-binding was already done ex works, so that the remote control and the receiver are directly connected to each other.

If the remote control and receiver were purchased separately, or the remote control was used for a different model, the binding must be performed again.

This is done as described below:

1. Inserting the batteries into the remote control with the correct polarity.
2. Press and hold "On/Off" on the remote control  for approx. 2 seconds
3. The sound will start and the power indicator on the remote control will light up.

The remote control is now ready for operation.

4. Press and hold "Engine Start/Stop" on the remote control  and at the same time press the on/off switch on the underside of the model to "ON".
5. As soon as you hear sound and the model's headlights light up, the binding is complete and the model is connected to the remote control.

INFRARED FUNCTION

English

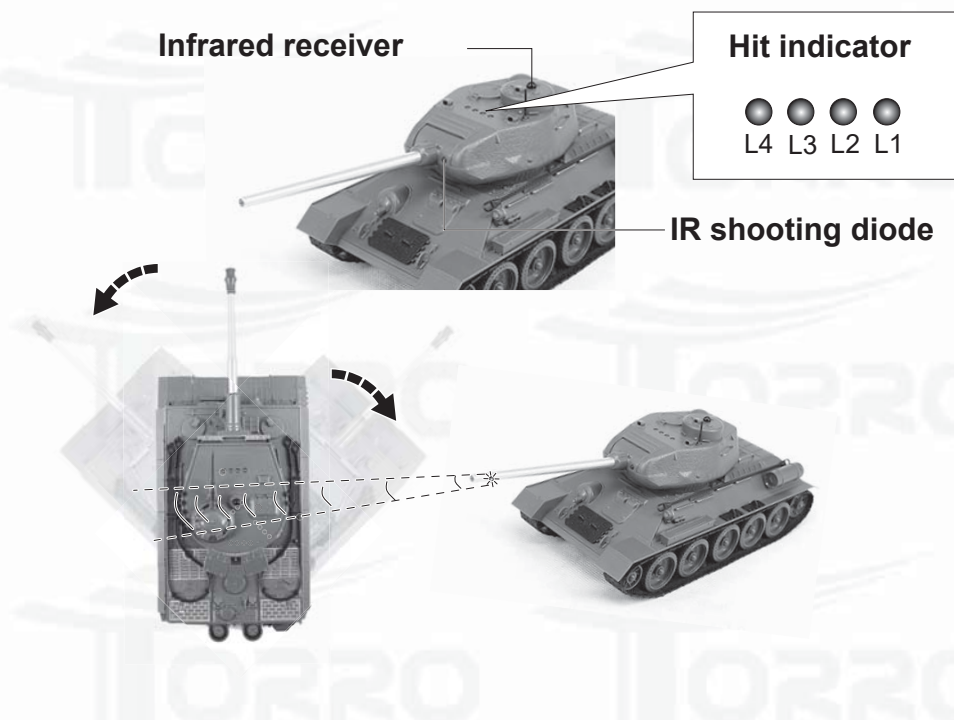

At the beginning of the battle, each tank has 4 life points.

(Visible on the hit display)

As soon as a tank is hit, one "life" is lost and one less LED lights up on the hit display.

As soon as the tank has been hit 4 times, it has lost the battle.

All functions go out and the tank switches off.

Press "Engine Start/Stop" on the remote control  to restart the tank and start a new battle.

ACCESSORIES

Accessories may already be partially attached.

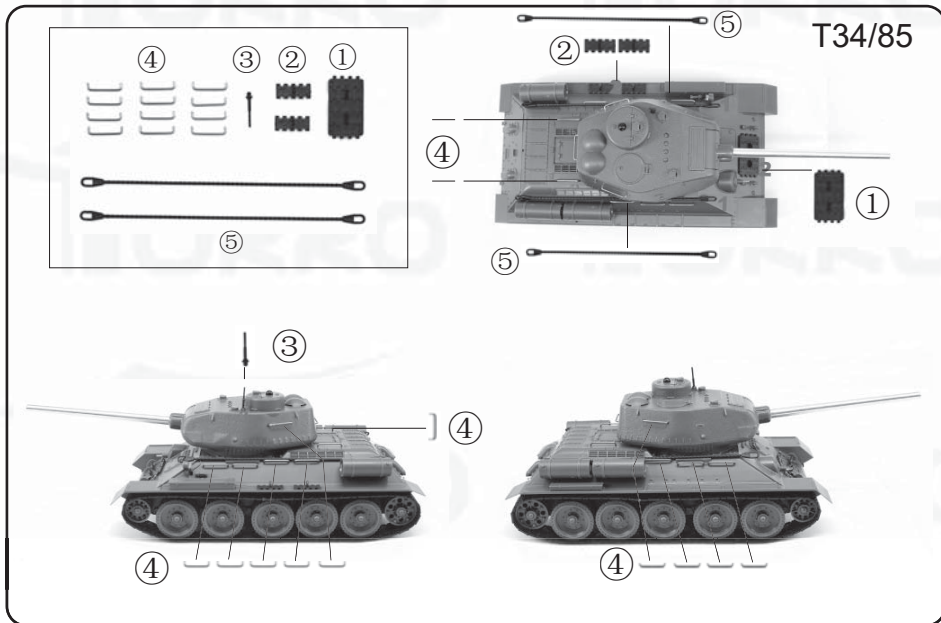

English

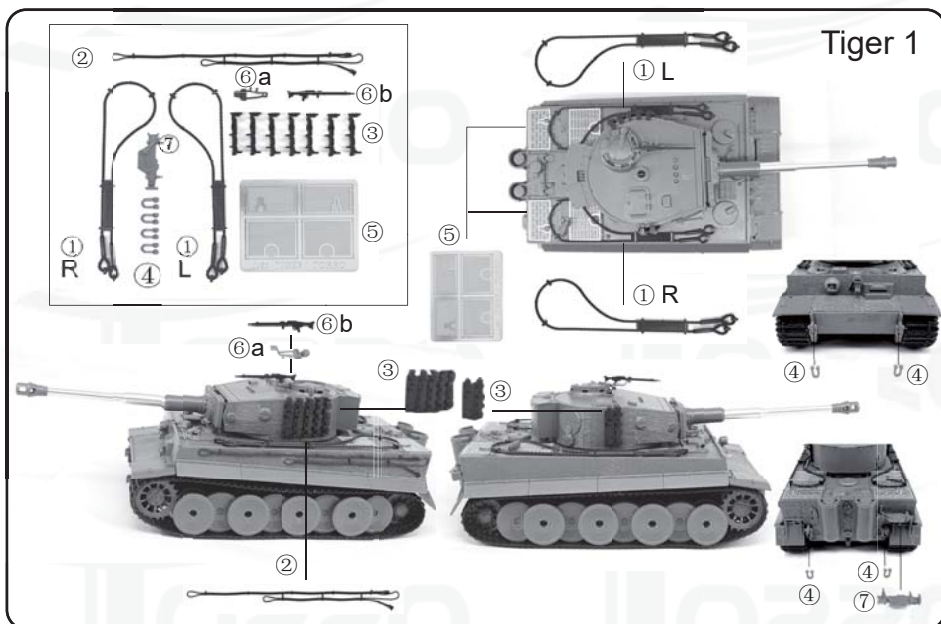

WARRANTY EXCLUSION

There is an exclusion of warranty for damages caused for any of the following reasons.



1 Letting the model drop or exposing it to strong shocks which leads to the tank or remote control being damaged.



2 Model and/or remote control being exposed to a wet environment leading to malfunctions.



3 Model is driven in a place with sand, mud, dirt, or on an uneven surface which leads to malfunctions and damage.



4 Model is driven on carpets, lawns or on other surfaces which cause excessive resistance leading to damages.

- 5 Other malfunctions caused by noncompliance with warning or caution notes listed in this manual.
- 6 Malfunctions due to misuse (wrong battery polarity, improper batteries...).
- 7 Malfunctions due to improper assembly or alteration or use of improper parts.
- 8 Malfunctions caused during transport or because of poor storage conditions.
- 9 Other malfunctions not covered by our quality guarantee.

No repair services will be offered for products, which have been altered or disassembled by the user in any way!

Torro spare parts and accessories service

Torro offers an excellent spare part service. Please contact your local dealer for spare part inquiries.



Warning

DANGER DUE TO SMALL PARTS BEING SWALLOWED! KEEP AWAY FROM INFANTS, TODDLERS AND CHILDREN!



Frequency 2,4 GHz

Max. radiated transmission power
10 mW**ATTENTION**

Before operating the model and the remote control, please read these instructions and the complete manual carefully and completely.

English

IMPORTANT INFORMATION**Telecommunication Regulations:**

This device may be operated in EU countries and CH.

Declaration of Conformity:

The declaration of conformity is available for download at <https://www.torro.de/en/certificates>

Environmental protection

Please hand out used batteries, rechargeable batteries and broken electrical appliances at the known collection points of trade and municipalities!

Thank you!

**Product Questions / Customer Complaints**

Please, do contact our service department if you have any questions or a complaint. Do not send in items before having contacted our service department via telephone, e-mail or fax.

Torro GmbH

Am Röhrig 2
63762 Grossostheim
Germany
Fax: +49 (0) 6026 9990482
Email: service@torro.de
www.torro.de

FCC Statement

This equipment has been tested and found to comply with the limits for a Class B digital device, pursuant to Part 15 of the FCC Rules. These limits are designed to provide reasonable protection against harmful interference in a residential installation. This equipment generates uses and can radiate radio frequency energy and, if not installed and used in accordance with the instructions, may cause harmful interference to radio communications. However, there is no guarantee that interference will not occur in a particular installation. If this equipment does cause harmful interference to radio or television reception, which can be determined by turning the equipment off and on, the user is encouraged to try to correct the interference by one or more of the following measures:

- Reorient or relocate the receiving antenna.
- Increase the separation between the equipment and receiver.
- Connect the equipment into an outlet on a circuit different from that to which the receiver is connected.
- Consult the dealer or an experienced radio/TV technician for help.

Changes or modifications not expressly approved by the party responsible for compliance could void the user's authority to operate the equipment.

portable device warning statements

The device has been evaluated to meet general RF exposure requirement. The device can be used in portable exposure condition without restriction.