

Contact Us

We are committed to leave all our customers best products and services. Quality of our products and services is our top priority, and our mission is to enrich the lives, to develop the interest and to provide the joy of entertainment to all of our customers by providing the best products and pre-sale / post-sale support.

We value each of our customers and appreciate your suggestions and opinions. Please feel free to contact us:



mingoservice@outlook.com (US region)

minidroneservice@outlook.com (EU region)



Subscribe us on YouTube

changes or modifications not expressly approved by the party responsible for compliance could void the user's authority to operate the equipment.

This equipment has been tested and found to comply with the limits for a Class B digital device, pursuant to Part 15 of the FCC Rules. These limits are designed to provide reasonable protection against harmful interference in a residential installation. This equipment generates, uses and can radiate radio frequency energy and, if not installed and used in accordance with the instructions, may cause harmful interference to radio communications. However, there is no guarantee that interference will not occur in a particular installation. If this equipment does cause harmful interference to radio or television reception, which can be determined by turning the equipment off and on, the user is encouraged to try to correct the interference by one or more of the following measures:

- Reorient or relocate the receiving antenna.
- Increase the separation between the equipment and receiver.
- Connect the equipment into an outlet on a circuit different from that to which the receiver is connected.
- Consult the dealer or an experienced radio/TV technician for help.

H12

UserManual V1.0



CONTENT

	Page
1. Warnings	3
2. Safety Notes	3
3. Using this manual	4
3.1 Read Before the First Flight	4
3.2 Video Tutorials	4
3.3 Package Contents	4
3.4 Aircraft Diagram	5
3.5 Remote Control	5
3.6 Battery Installation – Remote Control	6
3.7 Charging the Battery	6
4. Ready to Fly	6
4.1 Propeller Protector and Control lever Installation	6
4.2 Linking Remote Control with the Drone	7
4.3 Calibrating the Drone	7
4.4 Unlock/Lock the Drone	7
4.5 One Key Auto Take-off / Land	7
4.6 Emergency Stop	8
4.7 Mode of High / Medium / Low Speed	8
4.8 Flip and Roll	8
4.9 High-speed Spinning	8
4.10 Flight Instruction	9
4.11 Headless Mode	10
4.12 One Key Return	10
5. Trouble shooting	11
6. Contact Us	12

TROUBLESHOOTING

Problems	Reasons	Solutions
The light on the drone are flashing, but the drone is NOT responding	1.Insufficient battery power; 2.Remote control is NOT connected to the drone; 3.Unbalanced position; 4.Cannot pair due to the drone being powered on for a long time.	1. Fully charge the battery; 2. Turn OFF the drone and controller. Reconnect them by turning ON again; 3. Place your drone on a horizontal flat surface; 4. Turn OFF the drone and controller. Reconnect them by turning ON again.
The propellers spin but does NOT take-off	1.Insufficient battery power; 2.Propellers NOT installed correctly; 3.Damaged propellers; 4.Something being caught in the propellers or gears.	1. Fully charge the battery; 2. Check the propellers installation (A to A, B to B); 3. Replace new propellers; 4. Clear gears and propellers.
The drone does NOT fly properly after a crash	1.Propellers NOT installed correctly; 2.Damaged propellers; 3.The balance of gyro is confused; 4.Propellers have hit the Blade Guard; 5.Wire or circuits board was broken; 6. Motor burnt out	1. Check the propellers installation (A to A, B to B); 2. Replace new propellers; 3. Calibrate the drone OR press Trim button to fine tune the direction. 4. Ensure propellers are working well; 5. Replace motors or circuit boards; 6. Replace motor.
One Key Return button does NOT work properly	1.Pilot changed position after connecting the remote controller to the drone; 2.Transmitter button does NOT function; 3.Battery is low.	1.Reconnect the remote control with the drone and ensure NOT to move around after doing so; 2.Use another remote control; 3. Fully charge battery or use new battery.

Important Notes:

When one propeller does NOT spin while the other ones do, or one propeller spins at different speed rate, the motor of this propeller might be burnt up. As the motor and circuit board will heat up with use, take 10 minus break to cool down to ensure the durability of the parts.

In case the drone might descend on a further or fly to insecure zone due to the insufficient battery power when flying outdoors. Please be informed that H12 drone is specially designed with the function of secure warning. When battery power is insufficient, the LED light would flash constantly, then the pilot will have time to control it to fly back and recharge the battery.

Headless Mode

Prerequisite: Before entering the headless mode, the drone is required to be paired and calibrated.

- Place the drone on a flat level surface, the head of the drone will be faced forwards, and the tail of the drone will be faced towards the pilot.

- Press the Headless Mode button once, and the controller will continually emit DI DI DI and the drone's LED light will remain flashing. Indicating that Headless Mode function is in use.

- Now you should be able to operate your drone under headless mode. To exit, press the Headless Mode button once again and it will emit a beep sound.

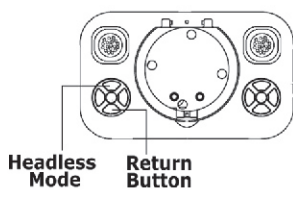

One Key Return

While in the air, press One Key Return button once, and the drone will fly towards the pilot position.

Important Notes for Headless Mode/One Key Return :

- When pairing the remote control to the drone, ensure the head of the drone is facing forward, the tail is facing towards the pilot (and the remote).

- When operating in Headless Mode /One Key Return, the pilot should not move around. This is because the drone will fly relative to the pilot where it is bound (to the remote), not relative to where the remote is.

- That said, we suggest the pilot to stay stationery and face the same direction in which he/she sets the head of the drone to face when binding the remote.

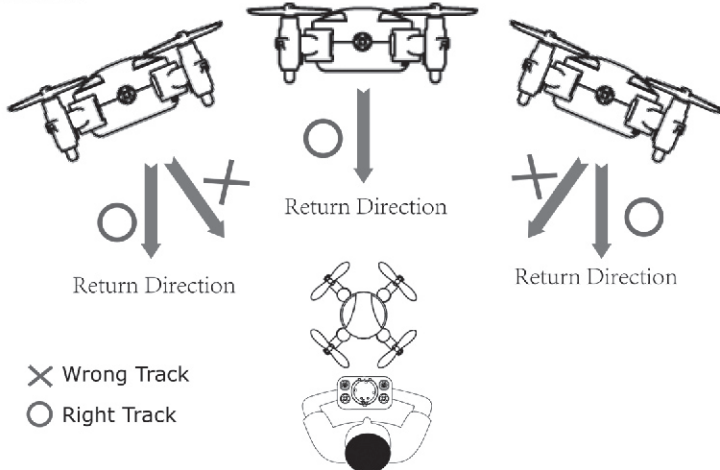

Warnings

- Read the entire User Manual to become familiar with the features of this product before operating. Failure to operate the product correctly can result in damage to the product, personal property or cause serious injury.
- This is NOT a toy. This product requires basic drones operating experience, and is not suitable for children under 14 years of age.
- It must be operated with cautions. Failure to operate this product in a safe and responsible manner could result in injury or damage to the product or property.
- This manual contains instructions for safety, operation and maintenance. It is essential to read and follow all the instructions and warnings in this manual (chargers, batteries etc.) prior to assembly, set up or use, in order to operate correctly and avoid damage or serious injury.
- This product composes of many precise electrical components. Always keep small parts and electrical parts out of the reach of children, to avoid the risk of eating or suffocation.
- The charger is not a toy.
- Do not use any other charger other than provided for charging.
- Battery charging should be done under adult supervision at all times, in a location out of reach of children. It must be kept away from flammable materials when charging.
- To avoid a potential fire hazard from batteries do not reverse polarity or puncture batteries. Do not store the batteries near any heat source.
- Make sure that batteries are installed correctly to ensure correct polarity. If you do not plan to use your quadcopter for an extended period of time, remove the batteries from the controller to avoid battery leakage, which may damage the controller. Please dispose depleted batteries according to local laws and ordinances.
- This product is non-waterproof. Do not operate in the rain or near the water area.
- Do not use this product under severe environments such as snow, strong wind, low temperature, etc.
- High temperatures could damage the internal structure of the aircraft. Keep the aircraft away from heat source and avoid long time exposure to direct sunlight.
- Do not operate this product in areas where laws and regulations prohibit flights.

Safety Notes

- This product is suitable for indoor and outdoor use. Please make sure you choose a flight area with no obstacles and maintain a safe distance from people and pets. Do not operate near power lines.
- Before the first fly, learn how to apply the 'emergency stop' function, which is in page 8 of this manual.
- Always keep the aircraft flying within the visual range of the operator.
- Do not hover or fly this product over the crowds.

USINGTHISMANUAL

Read Before the First Flight

Please read this document before operating your H12 Drone. Please keep this manual for future reference. We recommend that you watch all tutorial videos in this manual and read the Disclaimer before you fly.

Video Tutorials

Go to the address below or scan the code to watch the H12 Drone tutorial videos, which demonstrate how to use the drone safely:
http://bit.do/avialogic_youtube



Package Contents

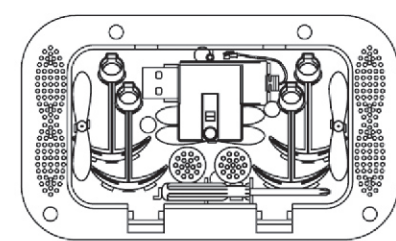

Accessories are at the back of the controller

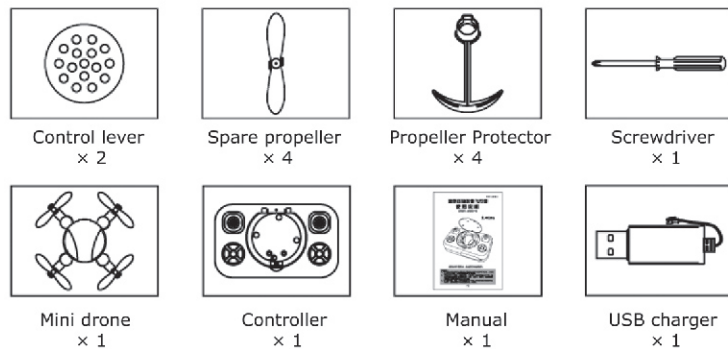

Flight Instruction

Before flying your quadcopter, it is highly recommended that you familiarize yourself completely with its controls. Read through the instruction manual completely before attempting your first flight.

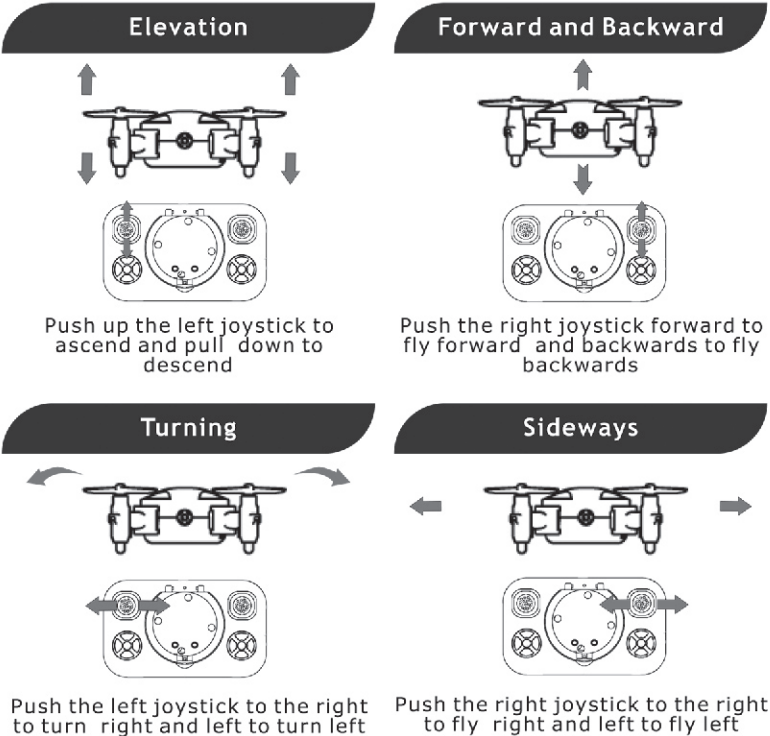

Practice Tips

Use these recommended practice exercises to become a better quadcopter pilot:
Elevation: Raise the quadcopter using the throttle joystick. Gradually lower the quadcopter so it lands softly to the ground.
Direction: Move the quadcopter in a cross pattern using the directional joystick. Move forward, backward, left, right and back to its original position.
Flying: Once you have mastered the previous exercises, draw a circle on the ground. Practice flying within the confines of the circle. Narrow the circle as your skills progress.

Emergency Stop

In an event of an emergency where the drone needs to be stopped immediately, long press the Emergency Stop button for 1 Second. The drone will stop immediately.

Warning: When using Emergency Stop function, it will cause the drone in the air to fall from the sky.

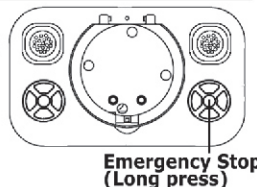

Mode of High/Medium/Low Speed

There are 3 speeds (High/Medium/Low Speed) available for this drone. By default, it is set at Low speed level. To speed up, press the "Speed Switch" on the remote control, it will emit a "beep beep", indicating it is at Medium speed level. Press again and it will emit "beep beep beep" ~ High speed level. Low speed mode is suitable for beginners.

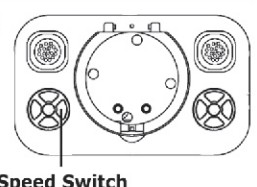

Flip and Roll

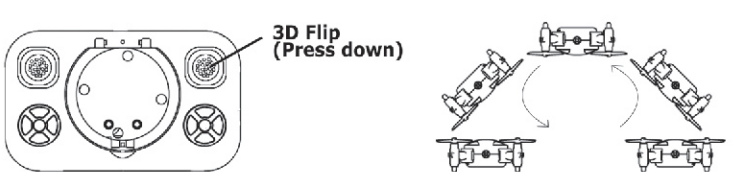

When the drone is flying in the air, press the right joystick on the remote control and a "beep" will be heard, quickly turn the right joystick to either directions and the drone will perform a 360° degrees flip towards that direction.

- Warning:**
- This action requires sufficient flight space around the drone to prevent collision or crash.
 - Under low battery mode, the LED light will keep flashing. And flipping will NOT be performed by the drone.

High-speed Spinning

Once the drone has hovered in the air, press the "High-speed Spinning" on the remote control, a DI sound will emit, then you can perform left/right rotation by simply shifting the left joystick to the left/right for one second. So, the drone will spin around in high-speed level as according to the instruction. To exit, press the High-speed Spinning button for one more time.

Warning: This action requires sufficient flight space around the drone to prevent collision or crash.

Aircraft Diagram

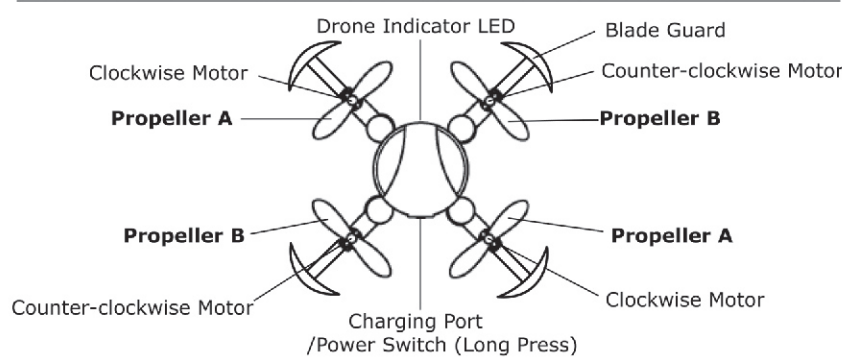

Important Notes: Every propellers has indicated alphabet A and B. Please install the propellers in correspondence with blade A and blade B as shown above. Otherwise the drone will fail to take off.

Remote Control

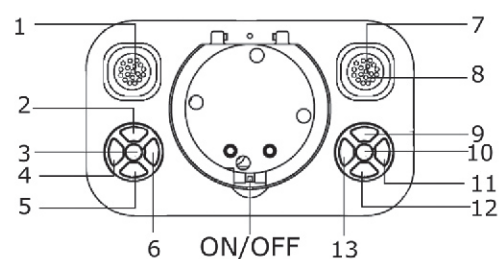

- Throttle Control Lever / Left & Right Steering
- Headless Mode
- One Key Auto Takeoff /Landing (press once/press once again)
- High Speed Spinning
- Return Button
- Speeds Switch (High/Medium/Low)
- Forward/Backward/Left/Right Direction Control Lever
- 3D Flip (Press down)
- *Forward Trimmer
- Emergency Stop(Long Press)
- *Right Trimmer
- *Backward Trimmer
- *Left Trimmer

***Left/Right Trimmer:** If the entire body of the drone drifts left or right during take-off, use this to correct. (i.e.: trim right if it drifts left)

***Forward/Backward Trimmer:** If the entire body of the drone drifts forward or backward during take-off, use this to correct. (i.e.: trim forward if it drifts back)

Battery Installation – Remote Control

To install batteries, use the included screwdriver to open the battery cover. Rotate counter- clockwise to loosen the screw. Insert 2 AAA batteries into the remote control. Re-attach battery cover. Rotate screw clockwise to refasten.

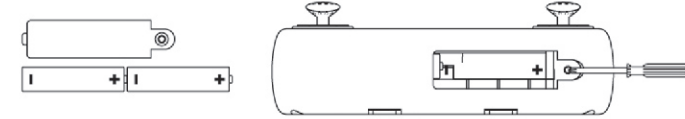

Install batteries with correct polarity. Do not mix and new batteries Do not mix different types of batteries

Important Notes:

In the event that the remote control battery is running low, the remote control will emit DI DI DI sound. Please replace new batteries for the remote control.

Charging the Battery

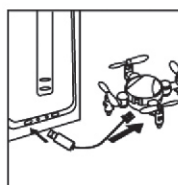

Connect the battery using the USB charging cable provided to the USB port for charging. Power output of **5V 0.5-1A** must be used for safe charging. When the battery is charging, the indicator light on the USB cable will light up. When the battery is fully charged, the indicator light will be off. The charging time for a full charge is about 35 minutes. Flight time is about 8 minutes.

Always charge the aircraft under adult supervision and out of reach of children

READYTOFLY

Propeller Protector and Control lever Installation

- Install the two Control Levers which can be found at the back of the remote control. (as shown the picture below)
- Install the four Propeller Protectors which can be found at the back of the remote control. (as shown the picture below)

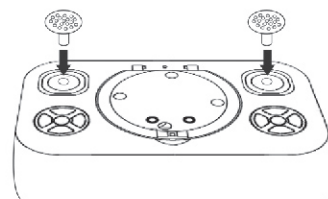
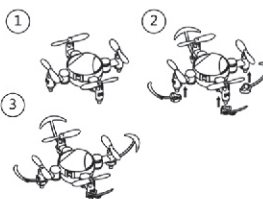

Linking Remote Control with the Drone

- To activate the drone, press the ON/OFF button for about one second, the LED indicator on the drone will be flashing. Then place the drone on a flat surface.

- Switch on the remote control by pushing the ON/OFF switch to ON. The power indicator on the remote control will light up and a DI sound will emit. One more DI sound will emit showing that the drone and the remote control have interacted. The indicator light of the drone will go from flashing to solid, indicating that the remote control and the drone is now paired.

Important Note:

- Please ensure the power indicator of the drone has turned on before turning on the remote control. Otherwise it cannot be paired successfully.
- Please make sure that the drone is placed on the levelled surface otherwise it will fail to pair with the remote control.
- If fails to pair, please turn off the power indicator of the drone and the remote control, and repeat steps 1 and 2.

Calibrating the Drone

Pull both the Joysticks to the bottom right corner for about 2 seconds. Calibration starts when the indicator on the drone start flashing. Wait until the indicator LED stops flashing. Calibration is now completed.

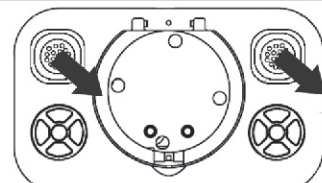

Note:

Please calibrate each time before taking off.

Unlock/Lock the Drone

Before the drone can takeoff, it has to be unlocked.

Pull the left joystick to the bottom left corner and the right joystick to the bottom right corner at the same time.

When the drone is unlocked, the propeller blades will start to rotate. Repeat the operation, the drone will be locked.

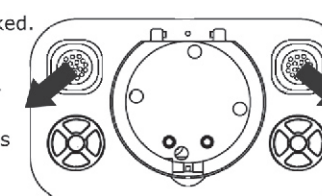

One Key Auto Take-off / Land

TAKE-OFF: After unlocking the drone, while on the ground, press the Auto Take-off/Land button, the drone will take off and hover in the air.

LAND: While in the air, press the Auto Take-off/Land button, the drone will land automatically.

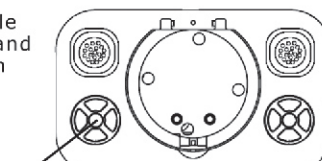

Auto Take-off / Land

Note: It is recommended to start operate the drone after the drone is hovering in the air for about 2 seconds.