

cosori

Smart Nutrition Scale

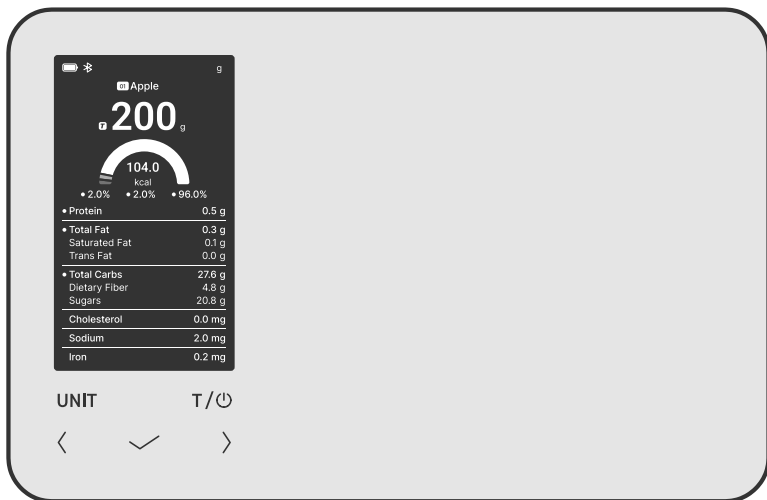

User Manual



Thank you for your purchase!



Bring Balance to the Kitchen

Download and connect your smart nutrition scale to the VeSync app to enjoy smart features, recipe inspiration, and more.



Find inspiration with our recipe gallery at **cosori.com**.



Explore weekly, featured recipes hand-crafted by our chefs in the Cosori kitchen.



Questions? Contact Us

For a little extra help in the kitchen reach out to us:

Email: recipes@cosori.com

Toll-free: 1-888-402-1684

Mon–Fri, 9:00 am–5:00 pm PST/PDT

From your imagination to your plate,
uncover kitchen wellness with Cosori.

Table of Contents

| | |
|--|----|
| Package Contents | 3 |
| Specifications | 3 |
| Important Safety Information | 3 |
| Getting To Know Your Smart Nutrition Scale | 6 |
| VeSync App Setup | 7 |
| Scale Operation | 7 |
| Maintenance | 9 |
| Troubleshooting | 10 |
| Limited Warranty Information | 12 |
| Customer Support | 15 |

Package Contents

- 1 × Smart Nutrition Scale
- 1 × USB-C Charging Cable
- 1 × User Manual
- 1 × Quick Start Guide

Product Overview: Smart Nutrition Scale

This Smart Nutrition Scale is designed for measuring food weight and calculation of nutritional information, facilitating effective dietary tracking and nutritional assessment.

Specifications

| | |
|--|--|
| Models | CNS-R001S-X CNS-R002S-S |
| Weight Capacity | 176.4 oz / 11 lb / 5,000 g / 5,000 mL |
| Units | oz / lb:oz / g / mL / fl'oz |
| Increments | 0.1 oz / 1 g / 1 mL |
| Dimensions | 9.2 x 6.0 x 0.8 in / 23.4 x 15.2 x 2.0 cm |
| Battery | 800mAh Li-ion Battery |
| Working Altitude | 0–9843 ft / 3000 m |
| Operating Temperature | 41°–104°F / 5°–40°C |
| Operating Humidity | 35%–80% |
| Overvoltage Category | II |
| Pollution Degree of Intended Environment | 2 degrees |
| IP (Ingress Protection) Rating | IP21 |

Note: To access additional smart nutrition scale functions, download the **VeSync app** (see page 7).

READ AND SAVE THESE INSTRUCTIONS

Important Safety Information

To avoid damage to this scale, please read and follow all instructions and safety guidelines in this manual.

SCALE

- **Do not** exceed the 11 lb / 5,000 g weight capacity, as doing so may damage the scale.

An overload indicator will appear on the LCD display if the limit is exceeded.

- This smart scale is not waterproof.

Do not immerse the scale in water or any liquid. If liquid is spilled on the digital display or buttons, immediately wipe the scale clean with a soft cloth to avoid internal damage.

- Handle with care. This scale is not intended for commercial or heavy-duty use.
- Keep the scale in a

cool, dry place. Avoid exposing to damp environments or extreme temperatures.

- Household use **only**.

BATTERY

 will turn red if the scale has less than 20% battery. When the battery is less than 5%, the scale needs to be charged immediately. Follow the steps to recharge the battery.

1. Insert the USB charging cable into the USB charging port.
2. Plug the USB charging cable into a DC 5V adapter and plug into an outlet. You can also plug the cable into a powered USB outlet.

Note: *The scale can't be used while charging, so it is recommended to charge the battery when  turns red, indicating low battery.*

BATTERY WARNING

- Disposal of a battery into a fire or hot oven, or mechanically crushing or cutting of a battery, may result in an explosion;
- Leaving a battery in an extremely high temperature environment, such as sunshine, fire, or hot surface, may result in an explosion or the leakage of flammable liquid or gas;
- A battery subjected to extremely low air pressure may result in an explosion or the leakage of flammable liquid or gas.

SAVE THESE INSTRUCTIONS

Getting to Know Your Smart Nutrition Scale

**SMART NUTRITION SCALE
DIAGRAM**

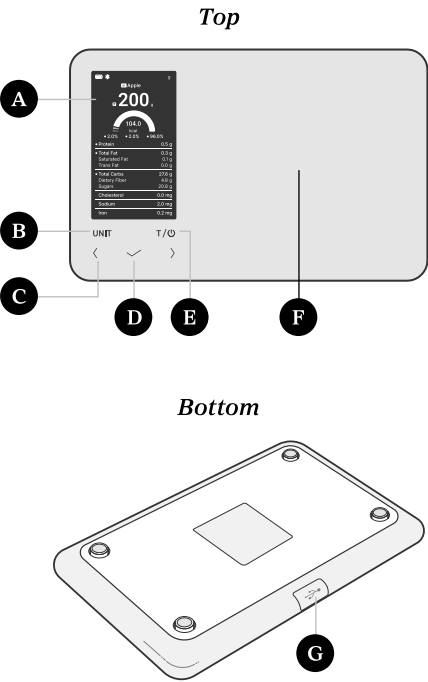

- A. Digital Display
- B. Unit Switching Button
- C. Left/Right Selection Buttons
- D. Confirm Button
- E. Power/Tare Button
- F. Weighing Platform
- G. USB-C Charging Port

**DISPLAY
DIAGRAM**

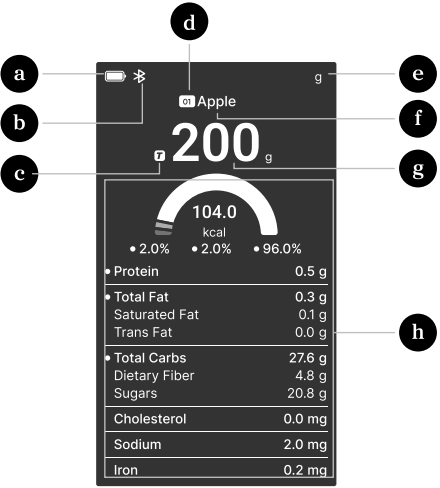

- a. Battery Indicator
- b. Bluetooth® Icon
- c. Tare Indicator
- d. Food Identification Number
- e. Measurement Unit
- f. Food Name
- g. Weight Value
- h. Nutritional Information

Controls

POWER/TARE BUTTON

- Tap to turn on the scale.
- Press and hold for 3 seconds to turn off the scale.
- When the scale is on, tap to tare or zero out the scale (see **Tare function**, page 8).

UNIT SWITCHING BUTTON

- Tap to cycle through measurement units: ounces (oz), pounds and ounces (lb:oz), grams (g), milliliters (ml), or fluid ounces (fl'oz).

VeSync App Setup

Note:

- *The VeSync app is continually being improved and may change over time. If there are any differences, follow the in-app instructions.*
- *Requires device to run app, Wi-Fi or mobile data, and iOS version 13 or Android version 7 (or above). Standard data and messaging rates may apply. Registration is required.*

1. To download the VeSync app, scan the QR code or search "VeSync" in the Apple App Store® or Google Play Store.



Note: For Android™ users, choose **"Allow"** to use VeSync.

2. Open the VeSync app. If you already have an account, tap **Log In**. To create a new account, tap **Sign Up**.

Note: You must create your own VeSync account to use third-party services and products. These will not work with a guest account. With a VeSync account, you can also allow your family and friends to use your smart nutrition scale. Even if you switch to a new device, your nutrition records will still be available on your VeSync account.

3. Make sure your phone has Bluetooth® turned on.
4. Tap **+** and select your smart nutrition scale.
5. Follow the in-app instructions to connect to your smart nutrition scale.

Note: You can change the name and icon at any time in the smart scale settings.

Scale Operation

Tips

- For accurate results, always place the scale on a hard, flat surface, and keep the scale away from dirt, dust, vibration, wind, air currents, and electromagnetic interference.
- When you turn on the scale, choose units, or use the Tare function, always wait for the scale to read **"0"** before attempting measurement.
- To take full advantage of your smart nutrition scale, you must connect the scale to the **VeSync app** (see page 7).

Setting Up

1. Tap **T/⏻** to turn on the scale.

Note: If the battery is low, charge the scale before continuing (see **Battery**, page 5).

2. Tap **< >** to cycle through language options. Select a language and tap **✓**.
3. Connect the scale to the VeSync app (see **VeSync App Setup**, page 7).

General Operation

1. Tap **T/⏻** to turn on the scale. Tap **UNIT** to select your desired measuring unit. You can also change the measurement unit in the VeSync app. [Figure 1.1]

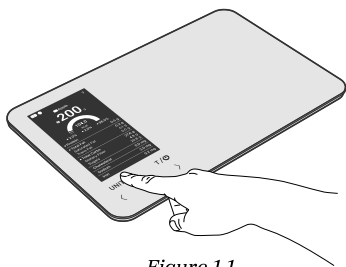

Figure 1.1

2. Optionally, if you're using a container to hold the items or liquid you're measuring, place the empty container on the scale and tap **T/⏻** to zero out (tare) the container's weight (see **Tare Function**, page 8).
3. To view your food's nutrition data, you must select the food you are weighing in the VeSync app.
 - a. You can also import food data to your scale through the app. This allows you to quickly select the food you are weighing on the scale (see **Quick Weighing**, page 9).

4. Gently place your food item on the scale. The display will show the weight/volume and nutrition data (if applicable). [Figure 2.1] If your smart scale is connected to the VeSync app, the data will be synchronized with the app.

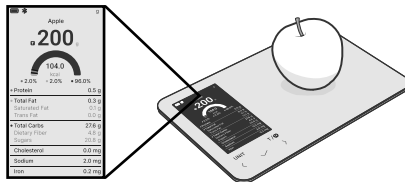

Figure 2.1

5. Press and hold **T/⏻** for 3 seconds to turn off the scale.

Note:

- To reset the scale, remove all weight from the platform and tap **T/⏻**.
- To conserve battery power, the scale will automatically turn off after 2 minutes of inactivity. The display backlight will automatically turn off after 30 seconds of inactivity. You can change this in the VeSync app.

Tare Function

Whenever you measure liquid or items inside a container, you can use the Tare function to remove the container's weight from the final measurement.

1. Place an empty container on the scale. The display will show the container's weight. [Figure 3.1]

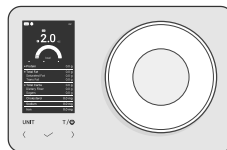

Figure 3.1

Tare Function (Cont.)

2. Tap **T/⊖**. The display will show "0" again. [Figure 3.2]

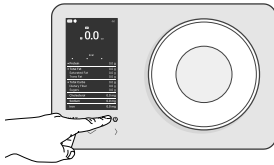

Figure 3.2

3. Place liquid or food items in the container. The scale will now measure the liquid or items, without including the weight of the container. [Figure 3.3]

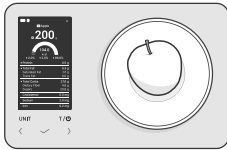

Figure 3.2

4. When you're done, reset the scale by removing all weight and tapping **T/⊖**.

Quick Weighing

You can import nutrition data of your most frequently eaten foods to the scale through the VeSync app. You can import up to 50 different foods.

1. Before placing your food on the scale, tap **< >** to cycle through imported food items.
 - a. Press and hold **< >** to quickly jump 5 food items.
2. Tap **✓** to select a food item.
3. Gently place your food item on the scale.

Memory Function

WITHOUT APP CONNECTION:

- Without imported food items, the scale only displays an item's weight/volume and does not save data.
- If a food item is selected, measurement results and nutrition data are locally stored on the scale. The scale can store up to 200 sets of data.
- When storage is full, new data will automatically overwrite old data. Connect to the VeSync app to upload your results and nutrition data.

WITH APP CONNECTION:

- All measurement results and nutrition data automatically sync with the VeSync app.
- View the app for complete measurement history and detailed analyses.

Maintenance

- Use a slightly damp cloth to clean the surface of the scale, followed by a dry, soft cloth to wipe away the remaining moisture.
- You can use a dry, soft cloth to wipe dust off the scale.
- **Do not** wash the scale or immerse it in water or any other liquid.

Troubleshooting

| Inaccurate weighing | Make sure the scale is on a hard, flat surface. |
|--|--|
| Scale does not turn on | The scale has low battery. Charge the scale. |
| Scale cannot connect to the VeSync app | Make sure your mobile device is within 30 ft / 10 m of the scale. |
| | Some Bluetooth devices can only exchange data with one other Bluetooth device at a time. Make sure the scale is not currently connected to any other phone or app. |
| VeSync app is not scanning food | Make sure you grant the VeSync app permission to use your camera. |
| | Confirm that the camera is pointed at the food and the area is well-lit. |

If you still need help, please contact **Customer Support** (see page 15).

Important Usage Disclaimer

It is imperative that users follow the instructions outlined in this user manual to ensure the proper functioning of the Smart Nutrition Scale. The manufacturer shall not be liable for any adverse outcomes resulting from improper use, including but not limited to incorrect measurements, malfunctions, or any other issues that arise from failure to adhere to the provided guidelines. By using this product, you acknowledge and accept these terms.

Federal Communication Commission Interference Statement – Part 15

This device complies with Part 15 of the FCC Rules. Operation is subject to the following two conditions:

1. This device may not cause harmful interference, and
2. This device must accept any interference received, including interference that may cause undesired operation.

NOTE: This equipment has been tested and found to comply with the limits for a Class B digital device, pursuant to Part 15 of the FCC Rules. These limits are designed to provide reasonable protection against harmful interference in a residential installation. This equipment generates, uses and can radiate radio frequency energy and, if not installed and used in accordance with the instructions, may cause harmful interference to radio communications. However, there is no guarantee that interference will not occur in a particular installation. If this equipment does cause harmful interference to radio or television reception, which can be determined by turning the equipment off and on, the user is encouraged to try to correct the interference by one or more of the following measures:

- Reorient or relocate the receiving antenna.
- Increase the separation between the equipment and receiver.
- Connect the equipment into an outlet on a circuit different from that to which the receiver is connected.
- Consult the dealer or an experienced radio/TV technician for help.

FCC Caution: Any changes or modifications not expressly approved by the party responsible for compliance could void the user's authority to operate this equipment.

FCC Supplier's Declaration of Conformity (SDOC)

Arovast Corporation hereby declares that this equipment is in compliance with FCC requirements.

The declaration of conformity may be consulted in the support section of our website, accessible from www.cosori.com

Limited Warranty Information

| | |
|--|----------------------------|
| Product Name | Smart Nutrition Scale |
| Models | CNS-R001S-X CNS-R002S-S |
| <i>For your own reference, we strongly recommend that you record your order ID and date of purchase.</i> | |
| Order ID | |
| Date of Purchase | |

Cosori Limited Product Warranty

Register your products at <https://warranty.cosori.com/warranty> to stay up to date with important product information such as product updates, limited warranties, usage and maintenance recommendations, and notifications concerning safety warnings or product recalls. Registration is not required to claim your limited warranty.

Two (2) Year Limited Consumer Product Warranty

Arovast Corporation ("Arovast") warrants that the product shall be free from defects in material and workmanship for a period of **2 years from the date of original purchase** ("Limited Warranty Period"), provided the product was used in accordance with its use and care instructions (e.g. in the intended environment and under normal circumstances).

Your Limited Warranty Benefits

During the Limited Warranty Period and subject to this Limited Warranty Policy, Arovast will, in its sole and exclusive discretion, either (i) refund the purchase price if the purchase was made directly from the online Cosori store, (ii) repair any defects in material or workmanship, (iii) replace the product with another product of equal or greater value, or (iv) provide store credit in the amount of the purchase price.

Who Is Covered?

This limited warranty extends only to the original consumer purchaser of the product and is not transferable to any subsequent owner of the product, regardless of whether the product transferred ownership during the specified term of the limited warranty. The original consumer purchaser must provide verification of the defect or malfunction and proof of the date of purchase to claim the Limited Warranty Benefits.

Be Aware of Unauthorized Dealers or Sellers

This limited warranty does not extend to products purchased from unauthorized dealers or sellers. Arovast's limited warranty only extends to products purchased from authorized dealers or sellers that are subject to Arovast's quality controls and have agreed to follow its quality controls. Please be aware, products purchased from an unauthorized website or dealer may be counterfeit, used, defective, or may not be designed for use in your country. You can protect yourself and your products by making sure you only purchase from Arovast or its authorized dealers.

If you have any questions about a specific seller, or if you think you may have purchased your product from an unauthorized seller, please contact our Customer Support via support@cosori.com.

What's Not Covered?

- Normal wear and tear, including parts that might wear out over time (e.g. batteries, filters, cleaning brush, essential oil pads, etc.).
- If the proof-of-purchase has been altered in any way or is made illegible.
- If the model number, serial number or production date code on the product has been altered, removed or made illegible.
- If the product has been modified from its original condition.
- If the product has not been used in accordance with directions and instructions in the user manual.
- Damages caused by connecting peripherals, additional equipment or accessories other than those recommended in the user manual.
- Damages or defects caused by accident, abuse, misuse, or improper or inadequate maintenance.
- Damages or defects caused by service or repair of the product performed by an unauthorized service provider or by anyone other than Arovast.
- Damages or defects occurring during commercial use, rental use, or any use for which the product is not intended.
- If the unit has been damaged, including but not limited to damage by animals, lightning, abnormal voltage, fire, natural disaster, transportation, dishwasher, or water (unless the user manual expressly states that the product is dishwasher-safe).
- Incidental and consequential damages.
- Damages or defects exceeding the cost of the product.

Claiming Your Limited Warranty Service in 5 Simple Steps:

1. Make sure your product is within the specified limited warranty period.
2. Make sure you have a copy of the invoice and order ID or proof-of-purchase.
3. Make sure you have your product. **DO NOT** dispose of your product before contacting us.
4. Contact our Customer Support team via support@cosori.com.
5. Once our Customer Support team has approved your request, please return the product with a copy of the invoice and order ID.

Sole and Exclusive Remedy

THE FOREGOING LIMITED WARRANTY CONSTITUTES AROVAST CORPORATION'S EXCLUSIVE LIABILITY, AND YOUR SOLE AND EXCLUSIVE REMEDY, FOR ANY BREACH OF ANY WARRANTY OR OTHER NONCONFORMITY OF THE PRODUCT COVERED BY THIS LIMITED PRODUCT WARRANTY STATEMENT. THIS LIMITED WARRANTY IS EXCLUSIVE, AND IN LIEU OF ALL OTHER WARRANTIES. NO EMPLOYEE OF AROVAST CORPORATION OR ANY OTHER PARTY IS AUTHORIZED TO MAKE ANY WARRANTY IN ADDITION TO THE LIMITED WARRANTY IN THIS LIMITED PRODUCT WARRANTY STATEMENT.

Disclaimer of Limited Warranties

TO THE FULLEST EXTENT PROVIDED BY APPLICABLE LAW, EXCEPT AS WARRANTED IN THIS LIMITED PRODUCT WARRANTY POLICY, AROVAST CORPORATION PROVIDES THE PRODUCTS YOU PURCHASE FROM AROVAST CORPORATION "AS IS" AND AROVAST CORPORATION HEREBY DISCLAIMS ALL WARRANTIES OF ANY KIND, WHETHER EXPRESS OR IMPLIED, STATUTORY, OR OTHERWISE, INCLUDING BUT NOT LIMITED TO ANY WARRANTIES OF MERCHANTABILITY, NON-INFRINGEMENT, AND FITNESS FOR PARTICULAR PURPOSE.

Limitations of Liability

TO THE FULLEST EXTENT PROVIDED BY APPLICABLE LAW, IN NO EVENT WILL AROVAST CORPORATION, ITS AFFILIATES, OR THEIR LICENSORS, SERVICE PROVIDERS, EMPLOYEES, AGENTS, OFFICERS, OR DIRECTORS BE LIABLE FOR:

(A) DAMAGES OF ANY KIND ARISING OUT OF OR IN CONNECTION WITH PRODUCTS PURCHASED FROM AROVAST CORPORATION IN EXCESS OF THE PURCHASE PRICE PAID BY THE PURCHASER FOR SUCH PRODUCTS, OR

(B) INDIRECT, SPECIAL, INCIDENTAL, CONSEQUENTIAL, OR PUNITIVE DAMAGES EVEN IF AROVAST CORPORATION OR ONE OF ITS SUPPLIERS HAS BEEN ADVISED OF THE POSSIBILITY OR LIKELIHOOD OF SUCH DAMAGES.

AND REGARDLESS OF WHETHER CAUSED BY TORT (INCLUDING NEGLIGENCE), BREACH OF CONTRACT, OR OTHERWISE. OUR LIABILITY SHALL UNDER NO CIRCUMSTANCES EXCEED THE ACTUAL AMOUNT PAID BY YOU FOR THE DEFECTIVE PRODUCT, NOR SHALL WE UNDER ANY CIRCUMSTANCES BE LIABLE FOR ANY CONSEQUENTIAL, INCIDENTAL, SPECIAL OR PUNITIVE DAMAGES OR LOSSES, WHETHER DIRECT OR INDIRECT.

EXCEPT AS COVERED BY THIS LIMITED PRODUCT WARRANTY STATEMENT, AROVAST CORPORATION SHALL NOT BE LIABLE FOR COSTS ASSOCIATED WITH THE REPLACEMENT OR REPAIR OF PRODUCTS PURCHASED FROM IT, INCLUDING, BUT NOT LIMITED TO, LABOR, INSTALLATION, OR OTHER COSTS INCURRED BY THE USER AND, IN PARTICULAR, ANY COSTS RELATING TO THE REMOVAL OR REPLACEMENT OF ANY PRODUCT.

Other Rights You May Have

SOME JURISDICTIONS DO NOT ALLOW FOR: (1) EXCLUSION OF IMPLIED WARRANTIES; (2) LIMITATION ON THE DURATION OF IMPLIED WARRANTIES; AND/OR (3) EXCLUSION OR LIMITATION OF INCIDENTAL OR CONSEQUENTIAL DAMAGES; SO THE DISCLAIMERS

IN THIS POLICY MAY NOT APPLY TO YOU. IN THESE JURISDICTIONS YOU HAVE ONLY THE IMPLIED WARRANTIES THAT ARE EXPRESSLY REQUIRED TO BE PROVIDED IN ACCORDANCE WITH APPLICABLE LAW. THE LIMITATIONS OF WARRANTIES, LIABILITY, AND REMEDIES APPLY TO THE MAXIMUM EXTENT PERMITTED BY LAW.

ALTHOUGH THIS LIMITED WARRANTY GIVES YOU SPECIFIC LEGAL RIGHTS, YOU MAY HAVE OTHER RIGHTS IN YOUR JURISDICTION. THIS STATEMENT OF LIMITED WARRANTY IS SUBJECT TO APPLICABLE LAWS THAT APPLY TO YOU AND THE PRODUCT. PLEASE REVIEW THE LAWS IN YOUR JURISDICTION TO UNDERSTAND YOUR RIGHTS FULLY.

Changes To This Policy

We may change the availability of this limited warranty at our discretion, but any changes will not be retroactive.

This warranty is made by:

US

AROAVST CORPORATION
1775 Flight Way, Suite 150
Tustin, CA 92782
USA

UK

VESYNC (SINGAPORE) PTE. LTD.
6 Raffles Quay, #14-06, 048580 Singapore

Terms & Policy

Arovast Corporation warrants all products to be of the highest quality in material, craftsmanship, and service, effective from the date of purchase to the end of the 2-year warranty period.

This warranty does not limit your rights under the applicable local consumer protection laws. If the applicable local consumer protection laws require the manufacturer to provide a longer warranty period, the warranty period shall be extended to the shortest period required by the laws.

If you have any questions or concerns about your new product, please contact our helpful Customer Support Team.

Attributions

Amazon, Alexa, and all related logos are trademarks of Amazon.com, Inc. or its affiliates.

Google, Android, and Google Play are trademarks of Google LLC.

App Store® is a trademark of Apple Inc.

Wi-Fi® is a registered trademark of Wi-Fi Alliance®.

iOS is a registered trademark of Cisco Systems, Inc. and/or its affiliates in the United States and certain other countries.

The Bluetooth® word mark and logos are registered trademarks owned by Bluetooth SIG, Inc. and any use of such marks by Etekcity Corporation is under license. Other trademarks and trade names are those of their respective owners.

Customer Support (US)

If you have any questions or concerns about your new product, please contact our helpful Customer Support Team.

Arovast Corporation

1775 Flight Way, Suite 150
Tustin, CA 92782
USA

Support Hours

Mon–Fri, 9:00 am–5:00 pm PST/PDT

Email: support@cosori.com

Toll-Free: 1-888-402-1684

**Please have your order invoice PDF or screenshot(s) ready before contacting Customer Support.*

Customer Support (UK)

If you have any questions or concerns about your new product, please contact our helpful Customer Support Team.

VESYNC (SINGAPORE) PTE. LTD.

6 Raffles Quay, #14-06, 048580
Singapore

Email:

support.uk@cosori.com



Tous les papiers peuvent être triés et recyclés, y compris le manuel d'utilisation, le livre de recettes et la carte de garantie.

