

User Manual



WhatsApp Support

WhatsApp ID: 8618820461144

E-mail Support: support@vormor.cn

Please read this instruction manual carefully
and keep it properly before you use the product.

Catalogue

- 1. Product Features
- 2. Parts
- 3. Before Using
- 4. Main Function
- 5. Product Specifications
- 6. Safety
- 7. Warranty
- 8. Warranty Certificate

1.Product Features

The voice translator is an AI product integrating multiple AI technologies such as speech recognition, OCR, text translation, speech synthesis, etc. As long as the voice is spoken, it can be instantly translated into the language you want and broadcast, and the photo text can be translated into a foreign language. It also has more exciting features. In the scenes of “go abroad, second language learning, business conference, ect.” the communication problems between different languages are effectively solved.

2.Parts

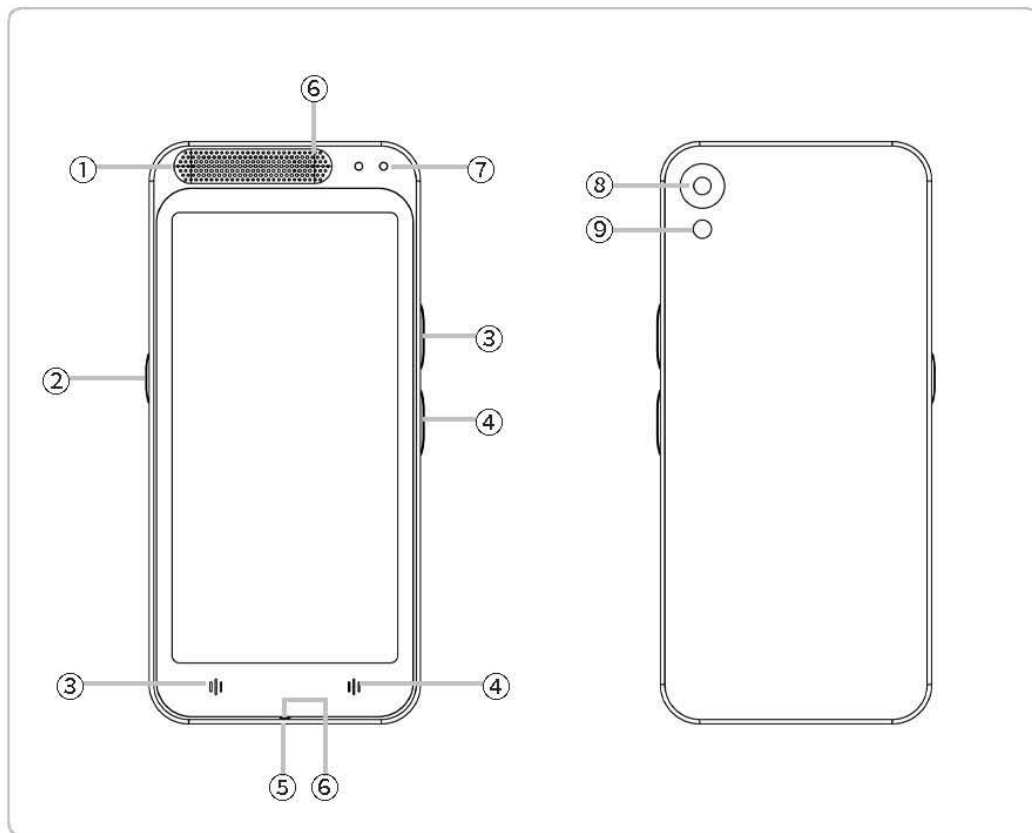

- | | |
|------------------------------|-------------------------------|
| ①BOX speaker | ②Power on/off |
| (3) Translation Button (red) | (4) Translation Button (blue) |
| ⑤Type-c | ⑥Mic |
| ⑦charging indicator | ⑧Camera |
| ⑨Flash light | |

- (1) Power On/Off: Long press the power button for more than 3 seconds for power on/off;
- (2) Standby: Short press the power button to wake up or standby.
- (3) Touch screen: Slide to select a function / return to the home page.

3.Before Using

.Device charging:

We suggest charging the device before using, normally 1 hour for fully charged. **Only supports 5V 1A, does not support fast charging**

.WIFI Connecting:

Please prioritize using online translation, it can connect to the WIFI or mobile HotSpot. (During offline translation , the responding speed and accuracy are limited.)

WIFI connecting Steps:

1)Settings --WLAN---Open, then connect your wifi .

Please note: 5G wifi are not supported.

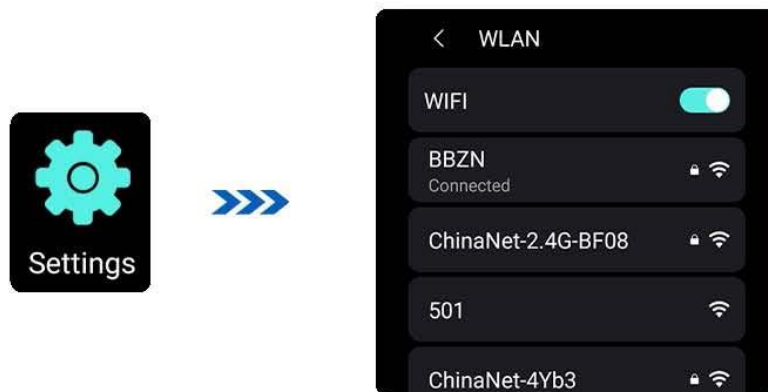

.System Language Settings

Settings --- Language--select your language

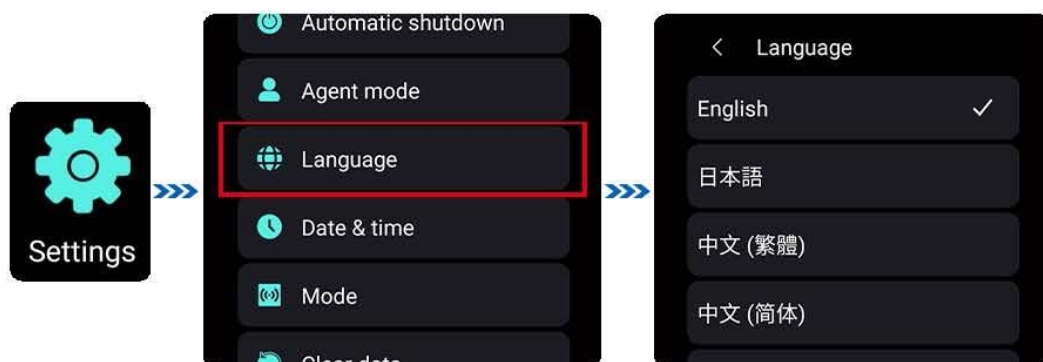

.Main Interface

Used to access various settings and functions.

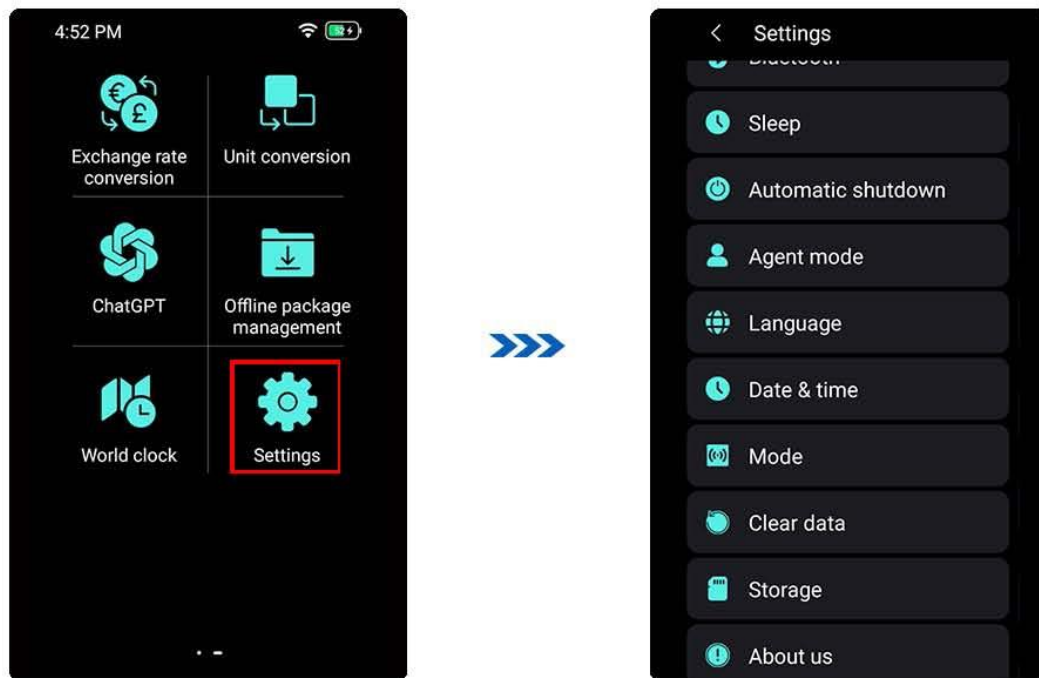

4.Main function

.Online Translation

Before using, make sure your network is connected successfully.

(1). **Language selection:** At the top of the online translation interface, select the original language and target language respectively.

(2). **Voice input:** Long press the red/blue button (voice input button), start “talking” when you hear “Di”, red for the original language and blue for the target language otherwise it will not be recognized. **Please make sure to say the corresponding language selected. Otherwise it will not be recognized.**

(3). After releasing your hands, the voice is automatically recognized and parsed, and translated into the set target language and broadcast by voice. Tap screen to replay the conversation.

(4). Long press the text records to Delete or Empty.

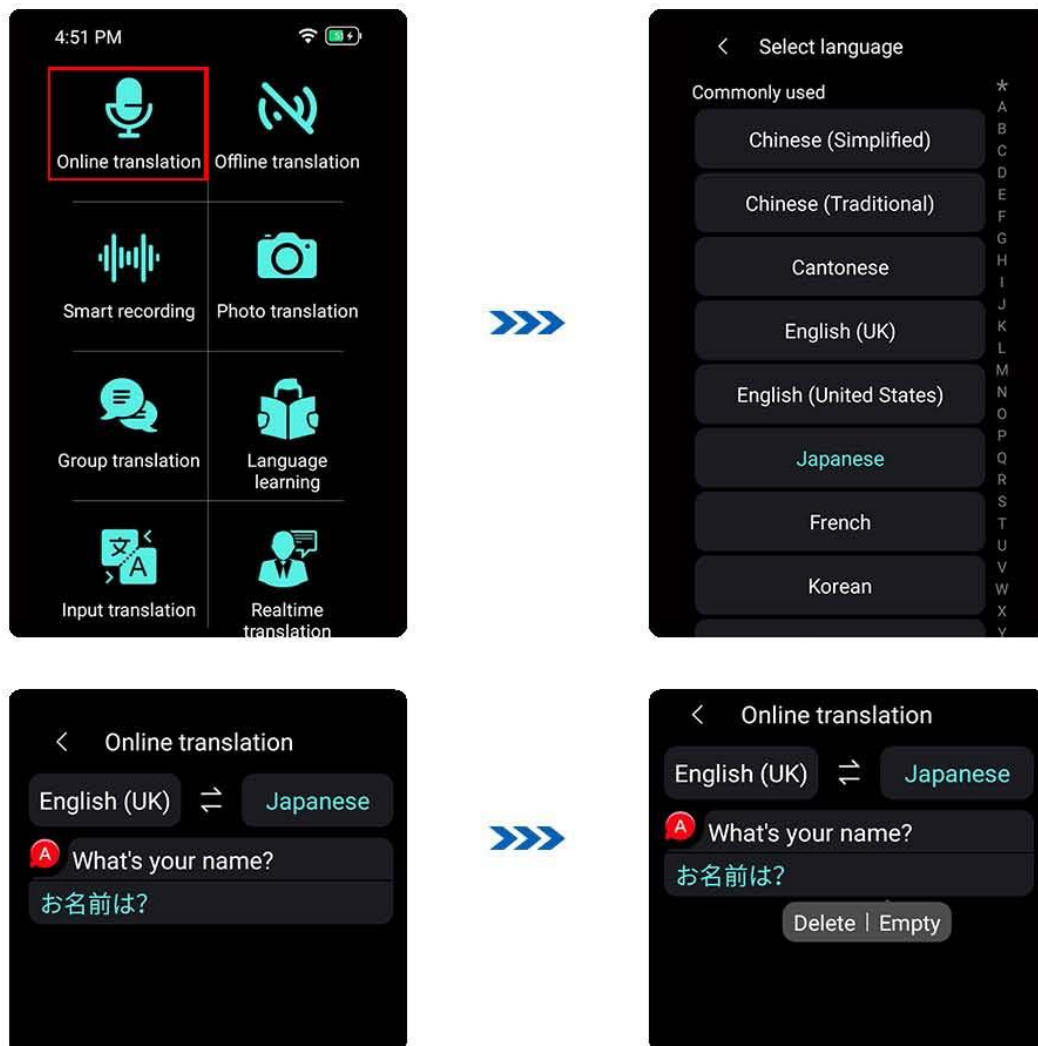

.Offline Translation

Offline translation , the responding speed and accuracy are limited,Please prioritize using online translation.You must connect to the network and download the language data before using the offline translation

(1)Language Selection: Click the language bar at the top of the Voice Translation screen. Select the original language and target language from the displayed list .

(2)Data download: When using offline translation for the first time, please download the “Offline package management ” .

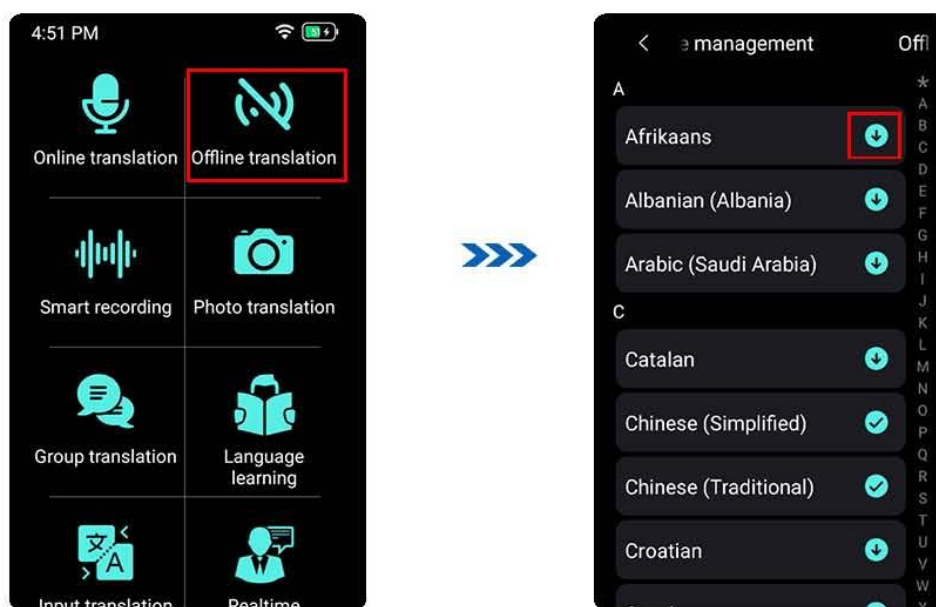

(3)Voice input: Long press the red/blue button (voice input button) , start “talking” when you hear “Di” .
Please make sure say the corresponding language selected.
Otherwise it will not be recognized.

(4)After releasing your hands, the voice is automatically recognized and translated to the target language.



.Recording Translation

(1)**Language selection:** Tap the original language (red) on the recording translation screen. Next, tap the target language (blue) and select the language.

(2)**Recording:** Press button  to start recording.  button to stop recording. Next, choose whether or not you want to save the recording.

(3)**Translate recordings:** Tap  to display the list of recordings.  button to play back the audio recording. Click the button  in the upper right corner to display the original text and the translated text.

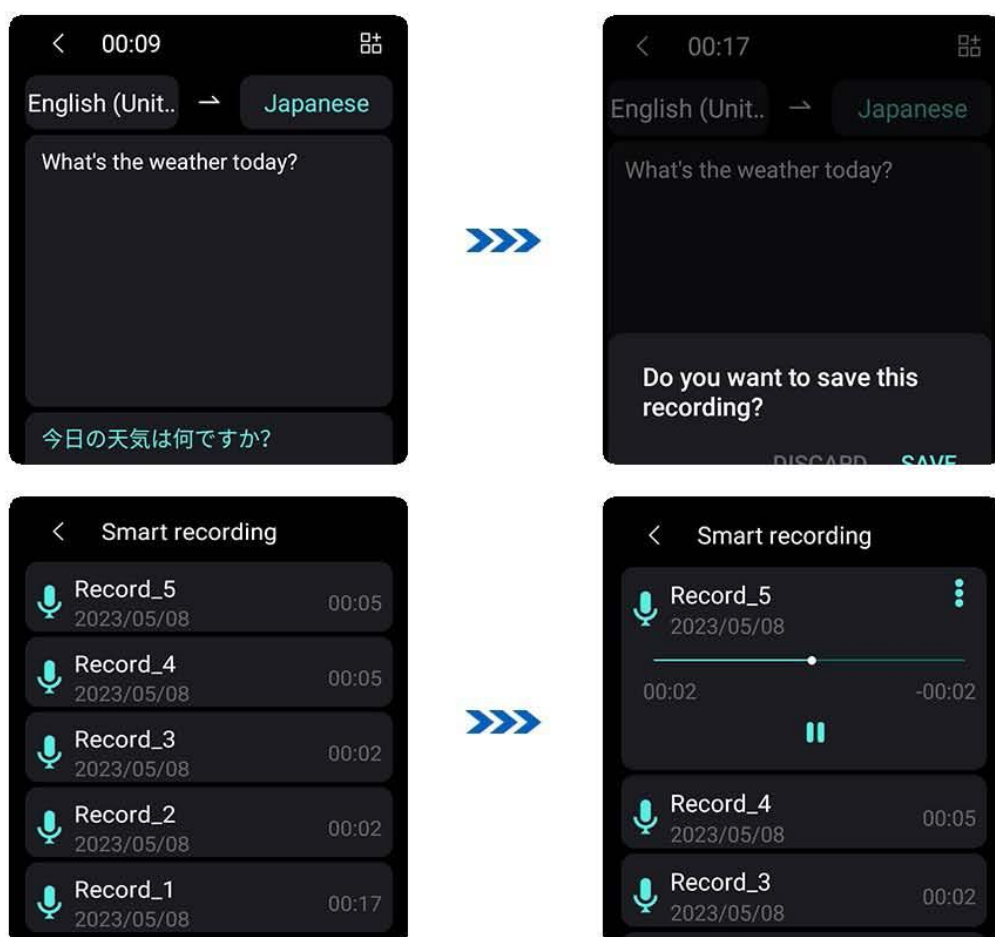

.Photo Translation

(1)**Language Selection:** Tap the language bar at the top of the photo translation screen to select the original language and the target language.

(2) Aim the camera at the photo or text you want to translate, and then tap the screen to bring it into focus. Press the Take Photo button to take a photo. When the analysis is complete, the translation results will be displayed on the screen.

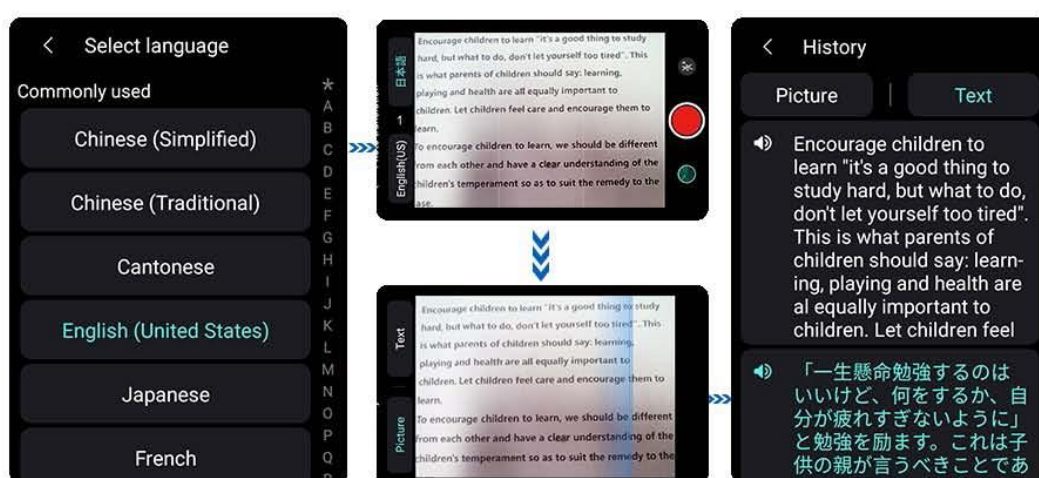

.Group Translation

You can invite multiple people to join the group and communicate in different languages within the group. Up to 500 people per group. Click "Create" and input the ID to add members, then perform mutual translation.

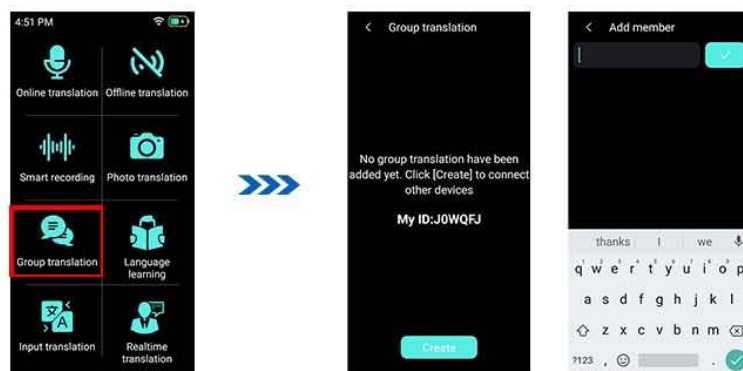

.Language Learning

(1)**Language Selection:** Tap the language bar at the top of the language learning screen to select your original language and the target learning language.

(2)**Talking:** Long press the Translation Button (red) , say what you want to practice when you hear “Di” .When you release your hand, the target learning content will be displayed on the screen.

(3)**Learning:** Click the arrow to enter the following interface.Long press the Translation Button to follow the target learning content. Release your hand and your learning results and scores will be displayed on the screen.You can listen to standard pronunciation and your pronunciation repeatedly

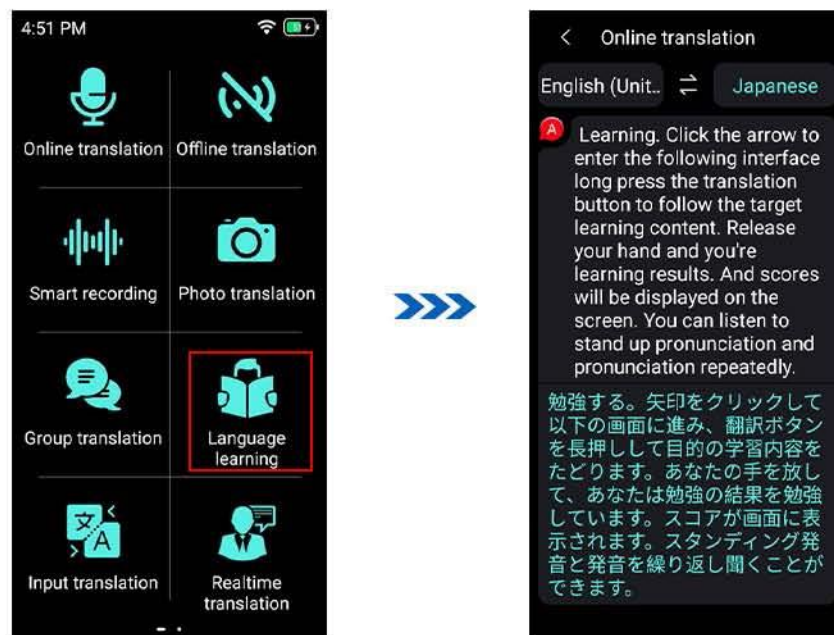

.Input Translation

You can input text on the keyboard and translate it into the target language you want.

Exchange Rate Conversion

You can perform real-time exchange rate conversion between multiple currencies (for reference only).

Unit Conversion

You can convert between multiple units (for reference only).

ChatGPT

Log in your CHATGPT account and start a pleasant journey.

World Clock

You can check the time in different time zones

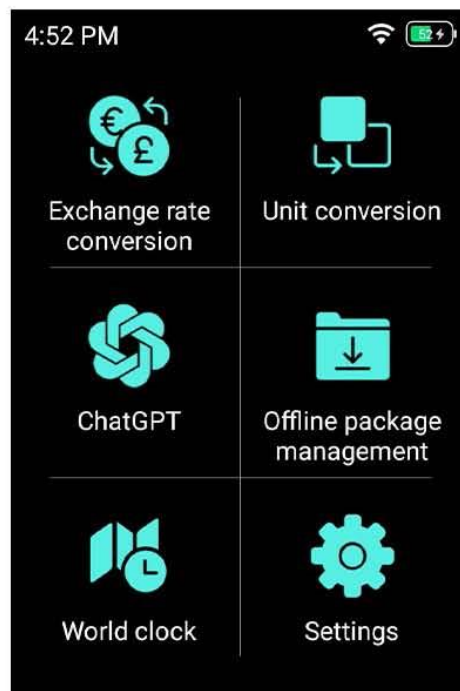

.Realtime Translation

Before using, please ensure that your network is successfully connected.

(1)**Language selection:** Click the dropdown button on the realtime translation interface. Select the original and target languages in the display list separately.

(2)**Voice input:** Gently press the red/blue button (voice input button), and when "Please start speak" appears, please start speaking.

(3)Gently press the red/blue button again to end the conversation. and the sound will be automatically recognized, emitted, and converted. Click on the screen for voice playback conversation.

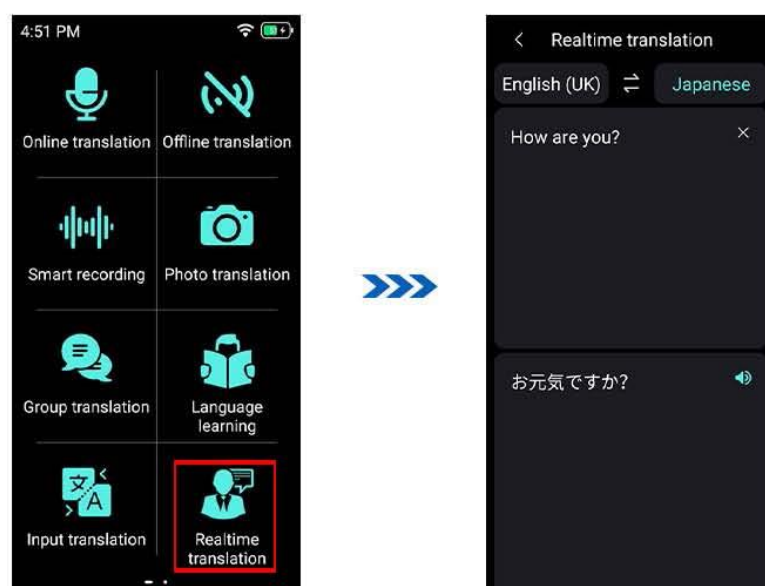

Warm tip: Please choose the appropriate language.
Otherwise, it will not be recognized.

.Settings

(1)WLAN: Connect the device's WIFI network.

(2)Bluetooth: It can connect Bluetooth headsets, Bluetooth speakers and other audio devices (only supports audio playback, does not support audio input).

(3)Sleep: Setting standby time

(4)Auto Shutdown: Choose from 10-minute, 30-minute, 60-minute, and permanent options to set automatic shutdown after the device goes to sleep

(5)Proxy mode: If the device encounters no network response during operation, you can select Enable this function. Under normal circumstances, it is recommended that you do not turn it on.

(6)language:Set different system languages, including Simplified Chinese, Traditional Chinese, English, German, French, Japanese, Thai and Korean etc.

(7)Date and Time: The default system automatically recognizes the local time zone, date, and time based on the network. Manual selection and setting is also possible

(8)Broadcast mode: When performing speech translation work, automatic is selected by default, and the translated target language will automatically announce the voice. If you select Manual, you need to manually click the translation result to have an announcement sound.

(9)Clear data: All usage records of the translator can be cleared.

(10)Storage Space: You can view the memory space status of the device

(11)About us: View the current device model, serial number, system version, etc.

5.Product Specifications

Name	Language Translator Device	N.W	101g
Size	118*56*11mm	Capacity	1500mAh
DC	5V/1A	Stand-by time	7days
Charge interface	Type-c USB	Screen size	4.1"IPS touch panel
Resolution ratio	640*1280	Speaker	BOX speaker
Network	WIFI	Material	ABS

6.Safety

.Caveat

(1)Do not use this equipment in places where electronic equipment is prohibited, such as gas stations, fuel depots, chemical plants, etc., as this may cause an explosion or fire.

(2)Please do not use unrecognized or incompatible power supplies, chargers, which may cause fire, explosion or other hazards.

(3)When charging is complete or not charging, disconnect the charger from the device and unplug the charger from the power outlet.

(4)It is strictly forbidden to place the equipment in an environment with too high or too low temperature to avoid fire, explosion or product failure; it is strictly forbidden to bring the equipment close to heat sources such as ovens, electric heaters, etc., and should not be put into fire; lithium batteries should not be exposed to such as sunshine. , fire roast or similar in an overheated environment.

(5) Do not allow children or pets to swallow this device or its accessories to avoid injury.

.Disclaimer

(1) Please read the product manual carefully before use and strictly follow the instructions.

(2) This product is not responsible for the translation results.

(3) This product is not waterproof, because the machine damage caused by water ingress is borne by the user.

(4) Do not place this product in an environment with high temperature, high humidity and damage to the product.

(5) Do not allow children or pets to swallow this device or its accessories to avoid injury.

.FAQ

(1) Please do not turn off the power until the system update is completed.

(2) Please connect wireless network when using this machine, currently we only support 4G network. The network environment may affect the response speed of translation or cause translation failure, please switch to another network at this time.

(3) When translating, press and hold the "Translate" button until you see the microphone icon and speak. To ensure correct speech recognition, please use normal speech speed and release the button when you finish speaking.

(4) Please place the microphone at a distance controlled to within 30 cm from your mouth for clear recognition and translation.

(4) Please place the microphone at a distance controlled to within 30 cm from your mouth for clear recognition and translation.

(5) Please use to speak at normal speed, repeated interruptions or joining two words together will cause the translation to fail.

(6) Please try to speak in a standard voice and reduce the use of dialects and slang.

(7) If the translation is not accurate, try to use a different expression.

7. Warranty

1. This product is free of charge for 1 year.

2. During the warranty period, in accordance with the failures caused by the normal use of the instructions (determined by the company's after-sales personnel or authorized service personnel of our company), it will be repaired free of charge.

3. During the warranty period, the following conditions are not covered by the free warranty:

(1) Failure to provide warranty certificate and valid purchase certificate.

(2) Unauthorized repair, misuse, collision, negligence, abuse, accident, improper use of this product, etc.

(3) Because it is exposed to glare, fire or similar overheating for a long time.

(4) Machine damage or performance failure due to human factors such as water ingress.

4. Loss caused by the adapter due to the use of unqualified power supplies exceeding 5V/2A. Regardless of the contract, civil disputes, etc.

The company is not special about anything. Occasionally or indirectly responsible for loss and damage.

8.Warranty Certificate

Product Name:

Product Number:

Customer Name:

Contact Number:

Contact Address:

Product Serial Number:

Date	Fault phenomenon	Records	Hand man

FCC Compliance Statement:

This device complies with Part 15 of the FCC Rules. Operation is subject to the following two conditions:

- (1) this device may not cause harmful interference, and
- (2) this device must accept any interference received, including interference that may cause undesired operation.

Changes or modifications not expressly approved by the party responsible for compliance could void the user's authority to operate the equipment.

NOTE: This equipment has been tested and found to comply with the limits for a Class B digital device, pursuant to Part 15 of the FCC Rules. These limits are designed to provide reasonable protection against harmful interference in a residential installation. This equipment generates, uses instructions, may cause harmful interference to radio communications. However, there is no guarantee that interference will not occur in a particular installation. If this equipment does cause harmful interference to radio or television reception, which can be determined by turning the equipment off and on, the user is encouraged to try to correct the interference by one or more of the following measures:

- Reorient or relocate the receiving antenna.
- Increase the separation between the equipment and receiver.
- Connect the equipment into an outlet on a circuit different from that to which the receiver is connected.
- Consult the dealer or an experienced radio/TV technician for help.

FCC Radiation Exposure Statement

The device has been evaluated to meet general RF exposure requirement. The device can be used in portable exposure condition without restriction