

User Manual



No Key



Unlock with
Smartphone



Unlock with
codes



Share Guests
Access



IP66

The "MOKOO" Lock,

Isn't it AMAZING to open your lock WITHOUT A KEY.

All you need is to download an app, connect a Bluetooth to open, and manage your SMART lock with just a little energy. A compatible Android smart phone (or an ios smart phone) can work like a key to open your lock. The lock itself takes up a VERY low energy - all it needs is 2 units of CR2032 battery which can run the lock up to 12 months under normal usage. And, the battery is easily accessible in the market.

It has a fast battery-changing function.

The MOKOO lock stands well against all odds of climates (rain-proof, hail-proof, snow-proof or sunlight-proof) and is good for outdoor use. Its waterproof exceeds IP66 level (*Prerequisite: The lock should be fully locked and in good shape*) and runs well under a normal temperature range from -20 to 60 degree Centigrade.

MOKOO lock brings you all fresh intellectual experiences as follows:

- Use app to unlock
- Use codes to unlock
- Master user has a supreme overriding power, which includes:
 - Control the number of use and the time slot for users to unlock via the app
 - Allow unlimited use for users to unlock via the app
 - Cancel or change the setting at random for user to use the abovementioned functions (as long as the line is connected)
- Master users are able to open the lock just via the app (with NO Internet connected)
- Master users can adopt a self-setting of their desired codes to unlock their locks
- Master users can check the past usage records including time, location and user (as long as the connection with the lock is engaged).
- Master users are allowed to use the "proximity function" to open the lock when using app to unlock.
- Users can check the level of energy just through the app.

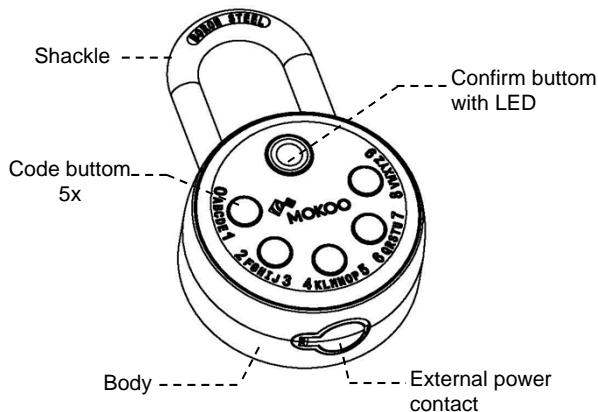

Quick start---Unlock with Smartphone

1. Remove lock & instructions package.
2. Use smartphone, visit app store & download free Mokoo app.
3. Follow prompts to log into, or create a Mokoo account.
4. In Mokoo app, touch Add a Lock (+).
5. press the Confirm button to connect the lock and smartphone
6. After connection done, configure your Lock name · Master Code · Proximity mode, and then press "DONE" .
7. Press any button on the lock to wake up the lock and prompt it to communicate with your smartphone. The distance of your smartphone and the lock should be kept within 1 metre.
8. When the lock is ready to open, you will hear a "click" motor sound signifying that it is time for you to pull out the shackle.

Quick start---Unlock with lock keypad

1. Remove lock & instructions package.
2. Press the preset codes: 1, 3, 5, 7, 9 or your own new codes (*Note: once the lock has paired up successfully with a smartphone, the preset codes will become invalid*)
3. Complete entering all your codes and then push a Confirm Button
4. If the input of the codes you entered is correct, you will hear a sound of the motor turning to unlock, and just pull the shackle to unlock.
5. If the input of the codes is wrong or unsuccessful, please repeat step 2 and 3 to configure the lock until it is ok to unlock



LED Indicators

BLUE	GREEN	RED
Startup	Entering the codes	Flash once: <ul style="list-style-type: none"> • Locked • Codes in error • If 3 times on end in error with the codes
Waiting for pairing with app	Input of codes is successful	Quick Red Flashes: <ul style="list-style-type: none"> • Low-energy alarm
In pairing with app .		

How to unlock with an external battery?

1. If battery runs out in locked position, just lift the lid on the External power contact to expose jumper contact point.
2. Hold a new CR2032 battery into the slot with positive(+) side of battery facing the top of the lock.
3. While holding the battery in place, use an authorized smartphone with MOKOO app opened (the distance between the lock and the smartphone is kept within the range of 1 metre)
4. Open the mokoo app, and set it to the " Proximity Unlock Mode", you will hear the sound of the motor turning , and then you can pull the shackle to unlock.
5. Even without the smartphone on hand, you can use Master Code to unlock the lock as long as the battery connection is engaged

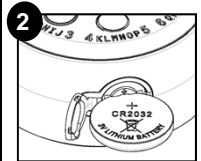
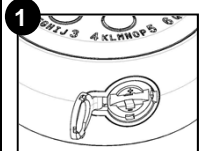

How to change a battery?

Battery- changing process should be operated under the condition that ' the lock should be opened where the shackle must be completely extracted from the lock '

1. press the recess places of the lid cover with two thumbs of both hands (or insert a suitable coin onto the recess place), and turn the lid in a clockwise direction
2. when the triangle mark is turned to align itself with the circle mark on the rim of the lock
3. take off the lid
4. take out the old battery with care
5. put on a new battery
6. put the lid back and turn it in an anti- clockwise direction until both triangle marks align well on the back

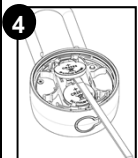
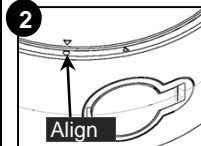
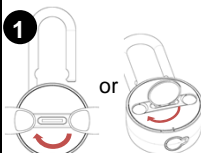

How to restart the lock?

If the lock is dead for an unknown reason, Please press Confirm button until you see the flash bluelight turning on again.



NOTE: This equipment has been tested and found to comply with the limits for a Class B digital device, pursuant to part 15 of the FCC Rules. These limits are designed to provide reasonable protection against harmful interference in a residential installation. This equipment generates uses and can radiate radio frequency energy and, if not installed and used in accordance with the instructions, may cause harmful interference to radio communications. However, there is no guarantee that interference will not occur in a particular installation. If this equipment does cause harmful interference to radio or television reception, which can be determined by turning the equipment off and on, the user is encouraged to try to correct the interference by one or more of the following measures:

- Reorient or relocate the receiving antenna.
- Increase the separation between the equipment and receiver.
- Connect the equipment into an outlet on a circuit different from that to which the receiver is connected.
- Consult the dealer or an experienced radio/TV technician for help

Changes or modifications not expressly approved by the party responsible for compliance could void the user's authority to operate the equipment.

This device complies with Part 15 of the FCC Rules. Operation is subject to the following two conditions:

(1) this device may not cause harmful interference, and (2) this device must accept any interference received, including interference that may cause undesired operation.

This device contains licence-exempt transmitter(s)/receiver(s) that comply with Innovation, Science and Economic Development Canada's licence-exempt RSS(s). Operation is subject to the following two conditions:

- (1) This device may not cause interference.
- (2) This device must accept any interference, including interference that may cause undesired operation of the device.

L'émetteur/récepteur exempt de licence contenu dans le présent appareil est conforme aux CNR d'Innovation, Sciences et Développement économique Canada applicables aux appareils radio exempts de licence. L'exploitation est autorisée aux deux conditions suivantes :

- (1) L'appareil ne doit pas produire de brouillage;
- (2) L'appareil doit accepter tout brouillage radioélectrique subi, même si le brouillage est susceptible d'en compromettre le fonctionnement.