

Mono Bluetooth Headset PHILIPS
TAL5000
User Manual

Catalog

1.Product Overview-----	1
2.Basic Operation-----	2
3.Bluetooth Pairing and Connection-----	3
4.Connection with Two devices-----	4
5.LED Indicator-----	5
6.Charging-----	5
7.Product Specification-----	6
8.Attentions and Q & A-----	7

1. Product Overview

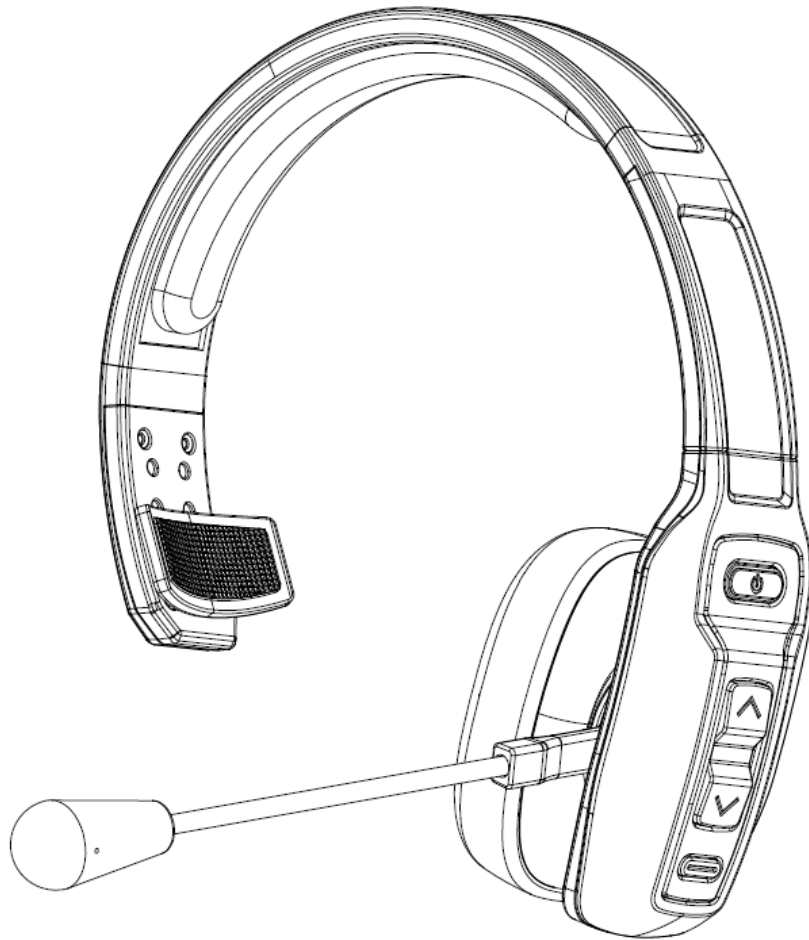

Packing list:

- A. Bluetooth Headset PHILIPS TAL5000 x 1
- B. Micro USB charge cable x 1
- C. User manual x 1

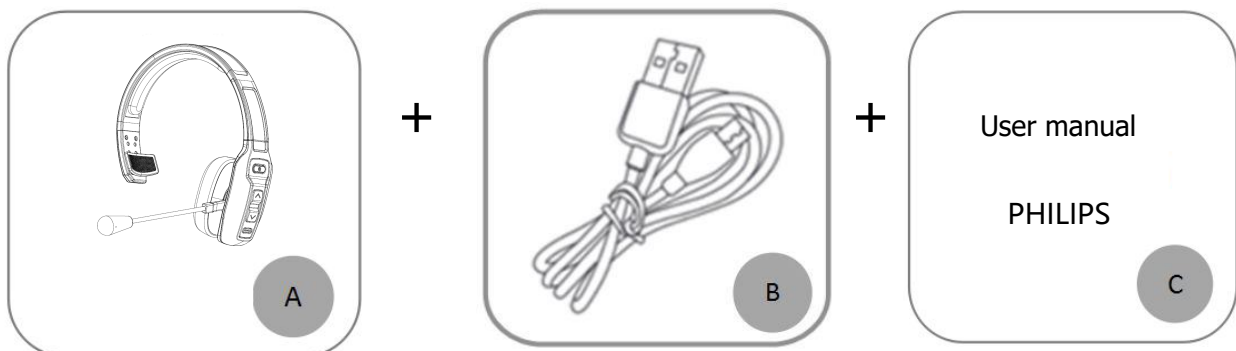

2. Basic Operation

2. Basic Function

	Function	Operation Instruction
MFB	Power On	In off status, long press MFB for 3-4 seconds to power on, PHILIPS TAL5000 will enter pairing mode automatically. (will enter reconnect mode automatically if have pairing record)
	Power Off	In on status, long press MFB for 5 seconds to power off.
	Enter Pairing Mode	In off status, long press MFB for 5-7 seconds to enter pairing mode, or under unconnected standby mode & reconnect mode to double click MFB. (After the Bluetooth is disconnected, PHILIPS TAL5000 automatically enters the pairing state.)
	Play / Pause	Short press when play music.
	Redial A Call	In connected standby/playing music mode, double press MFB to dial the last call.
	Voice Dialing	Long press MFB for 1 second then release.
	Audio Switch	When during a call, long press for 1 second MFB then release.
	Answer a call	When a call incoming, short press to answer.
	Hang up a call	When during a call, short press to hang up.
	Reject a call	When a call incoming, long press for 1 second to reject a call.
Volume +	Volume Up	Short press.
	Next Song	Long press for 1 second.
Volume -	Volume Down	Short press.
	Previous Song	Long press for 1 second.
Microphone Mute Button	Microphone Mute	When during a call, short press button to mute, press again to cancel.

3. Bluetooth Pairing and Connection

A. In off status, long press MFB for 5-7 seconds to enter pairing mode with Blue & Red LED flash alternately.

B. Search and click to connect " PHILIPS TAL5000" on your phone Bluetooth lists, LED change to Blue slow flash once after connected, now you can play music from phone to headphone.

C. You can press MFB / Volume+ / Volume- / Microphone Mute Button on the Bluetooth headset to control the answer/hang up a call and play/pause of the music, next and previous song, volume up and down, microphone mute.



1. In off status, long press MFB for 5-7 seconds to enter pairing mode with Blue & Red LED flash alternately.

2. Search and click to connect "PHILIPS TAL5000" on your phone Bluetooth lists, LED change to Blue slow flash once after connected, now you can play music from phone to headphone.

4. Connection with Two devices

- The mobile phones connected to PHILIPS TAL5000 are divided into two sets: Machine A and Machine B.
- Connect machine A first, and press the MFB for 3-4 seconds to start the machine, with Red & Blue LED flash alternately. Turn on the Bluetooth of machine A and search for the device, search for "PHILIPS TAL5000" and then click to connect. After the connection is successful, turn off the Bluetooth of machine A and PHILIPS TAL5000 enters the pairing state again.
- Then use Machine B to pair and connect with PHILIPS TAL5000, according to the method of machine A. After the matching is successful, turn on the Bluetooth of machine A and click "PHILIPS TAL5000" to connect. (Some mobile phones may have the automatic connection function).



*Music only can be played from one phone under two connections, when you want to play music from another phone, you need to pause or close the music of the previous phone. The same operation during talking status.

5. LED Indicator

Mode	LED Indicator
Power on	Blue LED flash 3 times
Power off	Red LED is on for 1 second
Pairing mode	Red & Blue LED flash alternately
Connected standby mode	Blue LED flash once every 10 seconds
Playing Music	Blue LED flash twice every 10 seconds
Talking	Blue LED flash twice every 10 seconds
Delete pairing record	Red & Blue LED flash once at the same time
Charging	Solid Red LED
Full charged	Solid Blue LED
Low battery	Red LED flash

6.Charging

Please charge the PHILIPS TAL5000 at once when the Red LED flash. Charging time is about 2 hours. Solid Red LED turn off and Blue LED turn on when full charged.

Charge Connections

Please connect to the PHILIPS TAL5000 charging port through the Type-C end of Type-C charging cable.

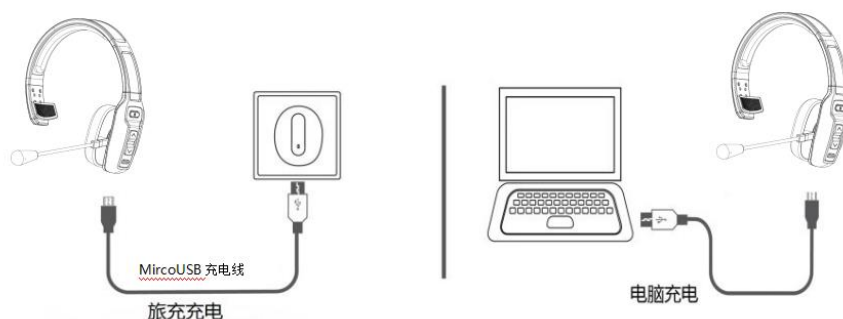

***Note:**

Please charge the PHILIPS TAL5000 at least once every 2 months when don' t use it.

7.Product Specification

Bluetooth Version	Bluetooth V5.2
Bluetooth Chipset	BT8926B
Operation Range	10 meters
Bluetooth Protocols	HSP HFP A2DP AVRCP
CODEC	SBC,AAC
Charging Time	About 2 hours
Talking Time	About 35 hours(70% volume)
Working Time	About 60 hours(70% volume)
Headset Net Weight	About 141g
Headset Dimension	192.90*157.08*54.05mm
Recharge Stand Net Weight	About 174.g

9. Attentions and Q & A

A. How to reconnect and operation when failed to reconnect?

When PHILIPS TAL5000 connected with your mobile phone successfully at the first time, it will search and reconnect the paired device automatically when power on, If failed, please pair and connect again. PHILIPS TAL5000 can be reconnect in 10 minutes, will be power off if over 10 minutes. It will have a tone "Your headset is connected" after over operation range disconnect.

B. How to delete paired records?

Long press the MFB and Volume - Button for 5 seconds to clear the pairing record. After deleting, PHILIPS TAL5000 will not connect devices automatically.

C. What' s the password for pairing?

Some connection devices require password for pairing, please try 0000 or 8888 or 1111 or 1234.

D.What devices could charge for the headphone?

Any car charger, power bank, PC etc. which meet DC 5V, charging current more than 500mA could be charge for PHILIPS TAL5000.

E. How to do if have connect issue or dead?

Please try charging reset, operation: plug in charging cable to charging, this will reset the headset to power off, it can be used normally after power on.If you still cannot use it normally, you can ask customer service or manufacturer for technical support.

F. Power off automatically?

PHILIPS TAL5000 will power off if does not connect any devices for over 10 minutes, or battery voltage is less than 3.1V.

FCC and IC Statement

FCC Information

The device complies with the FCC rules, Part 15. Operation is subject to the following two conditions:

- This device may not cause harmful interference, and.
- This device must accept any interference received, including interference that may cause undesired operation.

Warning: Changes or modifications not expressly approved by the party responsible for compliance could void the user's authority to operate the equipment.

Note: This equipment has been tested and found to comply with the limits for a Class B digital device, pursuant to Part 15 of the FCC Rules.

These limits are designed to provide reasonable protection against harmful interference in a residential installation.

This equipment generates, uses and can radiate radio frequency energy. If not installed and used in accordance with the instructions, may cause harmful interference to radio communications. However there is no guarantee that interference will not occur in a particular installation.

If this equipment does cause harmful interference to radio or television reception, which can be determined by turning the equipment off and on, the user is encouraged to try to correct the interference by one or more of the following measures:

- Reorient or relocate the receiving antenna.
- Increase the separation between the equipment and receiver.
- Connect the equipment into an outlet on a circuit different from that to which the receiver is connected.

- Consult the dealer or an experienced radio/TV technician for help

RF Warning Statement

The device has been evaluated to meet general RF exposure requirements. The device can be used in portable conditions without restriction.

IC-Canada: CAN ICES-3(B)/NMB-3(B)

This device contains licence-exempt transmitter(s)/receiver(s) that comply with Innovation, Science and Economic Development Canada's licence-exempt

RSS(s) Operation is subject to the following two conditions:

1. This device may not cause interference.
2. This device must accept any interference, including interference that may cause undesired operation. of the device.

Avis d'Industrie Canada: CAN ICES-(B)/NMB-(B)

L'émetteur/récepteur exempt de licence contenu dans le présent appareil est conforme aux CNR d'Innovation, Sciences et Développement économique Canada. applicables aux appareils radio exempts de licence. L'exploitation est autorisée aux deux conditions suivantes :

1. L'appareil ne doit pas produire de brouillage;
2. L'appareil doit accepter tout brouillage radioélectrique subi, même si le brouillage est susceptible d'en compromettre le fonctionnement.

Radiation Exposure Statement: The product comply with the Canada portable RF exposure limit set forth for an uncontrolled environment and are safe for intended operation as described in this manual. Déclaration d'exposition

aux radiations: Le produit est conforme aux limites d'exposition pour les appareils portables RF pour les Etats-Unis et le Canada établies pour un environnement non contrôlé.