

# Model # TRD065F1M

## DC POWER CEILING FAN REMOTE CONTROL MANUAL

### INSTALLATION INSTRUCTIONS

**NOTE:** This unit is to be used for the control of DC power ceiling fan and in an AC120V 60Hz power supply only. Output Power: 1.67A(Max.) for motor or 200W (Max.) for incandescent lamp load.

**Important:** Using a full range dimmer switch (not included) to control fan speed will damage the fan. To reduce the risk of fire or electrical shock, do not use a full range dimmer switch to control fan speed.

### LEARNING PROCESS

**NOTE:** The Hand Held Remote Control is equipped with a learning ID function which has code combinations to prevent potential interference from other remote units. This unit finished learning process inside manufactory, if replace transmitter or receiver, user need to redo learning process before using this unit. Receiver could remember up to 3pcs transmitter.

Step: 1. Switch power off at fuse box or circuit breaker before you begin installing the fan. Make wiring connections ok. Within 60 seconds of turning the Receiver AC power ON, press the transmitter LEARN button.

Step: 2. Hold LEARN button about 1 second, once the receiver has detected the ID, the DOWN light will blink twice then turn off, fan running at medium speed and make the beep sound twice to indicate the pairing process have been completed. Then the transmitter can control the receiver.

Note: After the AC power is on, do not press any other buttons on the transmitter before learning ok. Because doing so will cause the procedure to fail.

After completing the steps above, you should be able to operate the ceiling fan and light. If the ceiling fan is not responding to the transmitter, please turn the power off to the receiver and repeat step 1 and 2.

Please note that the transmitter can learn in multiple receiver, when doing learning process please make sure not learn in other receiver.

If you want to clear these pairing transmitters, turn off ceiling fan and turn on within 60 seconds, press and hold the LEARN button over 8 seconds. The DOWN lights blink twice then turn off and fan running at medium speed. This will indicate the ceiling fan is only controlled by one remote.

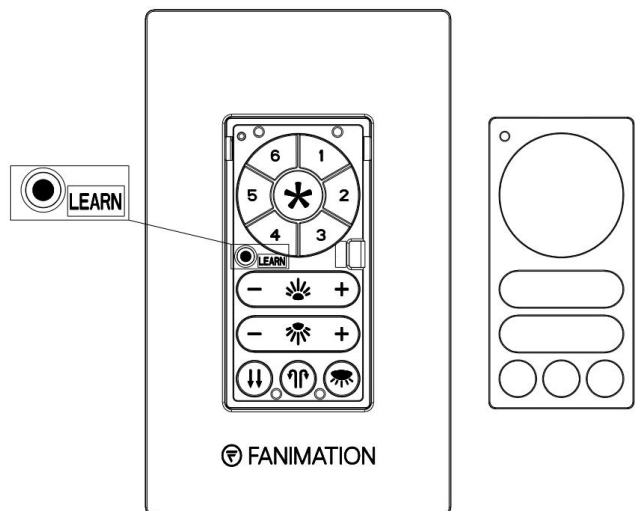

\*The buzzer setting: you could press and hold  about 5 seconds to turn on or off.

## FUCNCTIONS OF REMOTE CONTROL:



: Turn off ceiling fan.

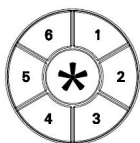

: Press button to set fan speed. (1~6 speed, 6 for high speed.)



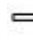

: Turn on or off UP lights.

Press  button to turn on and brighten lights to the desired level and release. Press  button to turn on and dim lights to the desired level and release.



: Turn on or off DOWN lights.

Press  button to turn on and brighten lights to the desired level and release. Press  button to turn on and dim lights to the desired level and release.



: The fan runs counterclockwise. Airflow will provide a downward cooling breeze.



: The fan runs clockwise. Airflow will force warm air downward without a noticeable breeze.



: When lights are on, use this button to select the desired color-temperature.

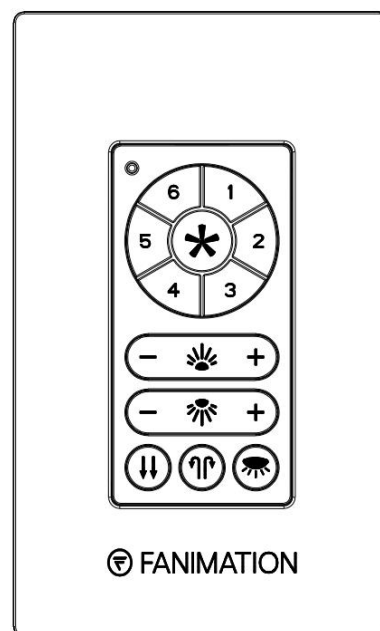

## INSTALLING WALL PLATE

Attach wall plate using the two provided screws.

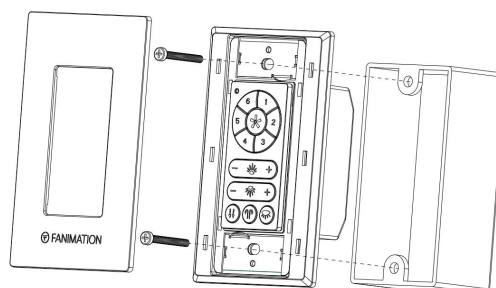

## To assure continued FCC compliance:

### FEDERAL COMMUNICATIONS COMMISSION INTERFERENCE STATEMENT

This equipment has been tested and found to comply with the limits for a Class B digital device, pursuant to Part 15 of the FCC Rules. These limits are designed to provide reasonable protection against harmful interference in a residential installation. This equipment generates uses and can radiate radio frequency energy and, if not installed and used in accordance with the instructions, may cause harmful interference to radio communications. However, there is no guarantee that interference will not occur in a particular installation. If this equipment does cause harmful interference to radio or television reception, which can be determined by turning the equipment off and on, the user is encouraged to try to correct the interference by one or more of the following measures:

- Reorient or relocate the receiving antenna.
- Increase the separation between the equipment and receiver.
- Connect the equipment into an outlet on a circuit different from that to which the receiver is connected.
- Consult the dealer or an experienced radio/TV technician for help.

### CAUTION:

Any changes or modifications not expressly approved by the grantee of this device could void the user's authority to operate the equipment.

**FCC ID: 2AQZU-18060**

This device complies with Part 15 of the FCC Rules. Operation is subject to the following two conditions: (1) This device may not cause harmful interference, and (2) this device must accept any interference received, including interference that may cause undesired operation.

This equipment complies with FCC radiation exposure limits set forth for an uncontrolled environment.