

User Manual for iFisher

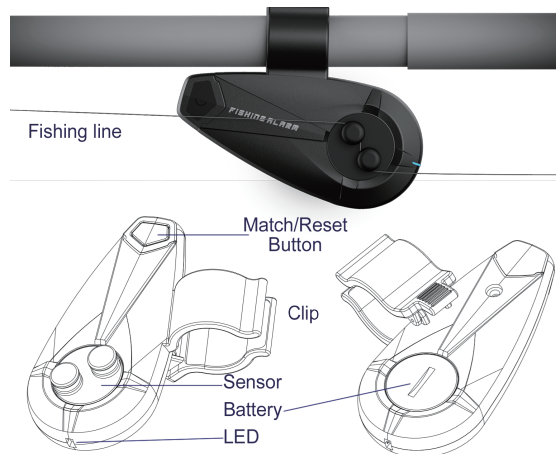

1. Please search “iFisher” to download the APP “iFisher Alarm” from Google Play Store or Apple Store, please find the icon - 

2. Matching: Start the “iFisher” APP and click the “+” (see Pic 1), push the matching button on your smart fishing alarm (called iFisher here) for 2 seconds, you’ll find a BT named “iFish_XXXX” on your APP (see Pic 2), and click it to match. If you have more iFishers just do it repeatedly. The first time for matching needs a few more seconds, please try it again if there’s no reaction, normally it will be matched if you try again.

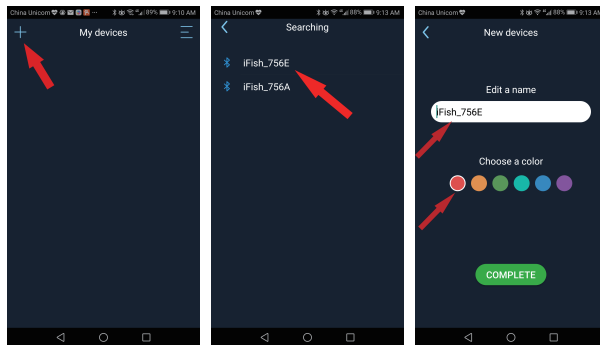

Pic 1

Pic 2

Pic 3

3. Setting on the APP: You can Edit a name and choose a color for your iFishers, and by clicking the matched device’s name for once, you can edit or delete it. (see Pic 3, for IOS, it needs to slide left to do this.) Clicking the ON/OFF button can disconnect your iFishers.

4. Setting on the fishing rod: You can clip the iFisher on the fishing rod, and put the fishing line around the bite sensor, and make sure the fishing line is straight away. Once the fish bites, it will pull the sensor, and iFisher will send a BT signal to your mobile phone, and then you’ll know the fish is on hook right away, no matter what you are doing at that time.

5. Change Battery: Once the LED light is deeming, and the connection between the APP and device is always lost, you can use a coin to turn left to open the battery cover and change the old battery by a new one (CR-2032). The “-” should be faced to the PCB.

Remarks:

1. Make sure your smart phone is BT4.0 above (IOS10.0 above for the Apple products), some old version smart phones don’t support this product, and make sure the BT is opened all the time in your phone.

2. It is better to click “trust this APP”, and allow all the permissions when you are setting the APP permission.

3. Please test it after setting, and please click the “+” to rematch if you leave the working distance for a long time (Android).

4. It can match 4-7 iFishers for one phone (pad) at most, more iFishers will cause the APP collapse. IOS version is more stable, while not all the Android phones’ BT use the same BT chip, so some of the Android phones may have small bugs, which won’t influence the normal use. Please update your APP if there’s new version on the APP store.

5. You can just turn off the APP after using, the device will be power off after 45 minutes. At the other hands, if you leave the connect distance more than 45 minutes, please push the device’s reset button to rematch.

6. The item is very stable now, but in case that you met problem when using, please do according the following steps:

- 1) Click the “+” on APP, it may connect again automatically;
- 2) Turn off the APP and restart it and click the “+” to rematch;
- 3) Push the reset button on the device, and rematch it;
- 4) Take out the battery to reload it or change a new battery.

Normally do one of the above action will cover all the possible problems.

FCC Warning Statement Changes or modifications not expressly approved by the party responsible for compliance could void the user's authority to operate the equipment. This equipment has been tested and found to comply with the limits for a Class B digital device, pursuant to Part 15 of the FCC Rules. These limits are designed to provide reasonable protection against harmful interference in a residential installation. This equipment generates uses and can radiate radio frequency energy and, if not installed and used in accordance with the instructions, may cause harmful interference to radio communications. However, there is no guarantee that interference will not occur in a particular installation. If this equipment does cause harmful interference to radio or television reception, which can be determined by turning the equipment off and on, the user is encouraged to try to correct the interference by one or more of the following measures:

- Reorient or relocate the receiving antenna.
- Increase the separation between the equipment and receiver.
- Connect the equipment into an outlet on a circuit different from that to which the receiver is connected.
- Consult the dealer or an experienced radio/TV technician for help.

This device complies with part 15 of the FCC Rules. Operation is subject to the following two conditions: (1) This device may not cause harmful interference, and (2) this device must accept any interference received, including interference that may cause undesired operation.