

## Quick Manual

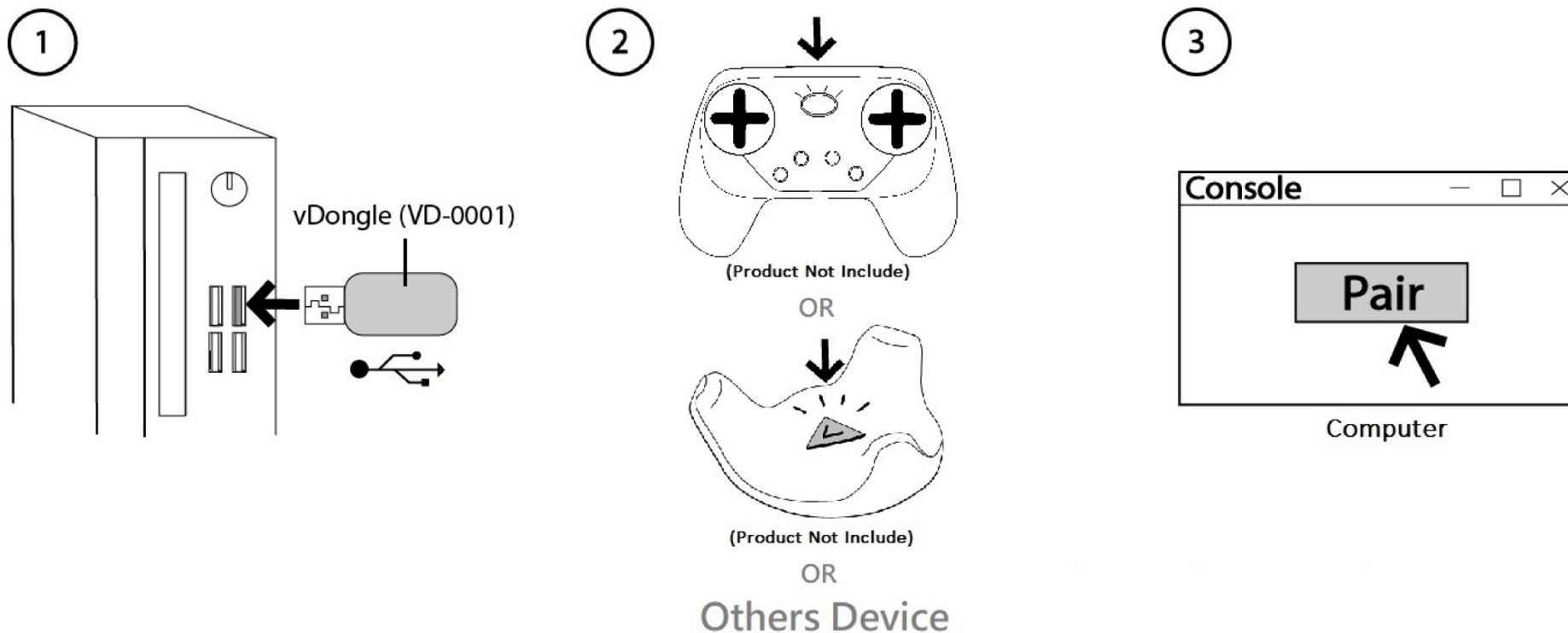

To run the program:

- Plug in the vDongle to the computer.
- Open Windows Command Prompt, drag "lighthouse\_console.exe" into it, then press enter.

To pair the device with vDongle:

- Press and hold the button on the device until the LED displays blinking.
- On the console, type "pair", then press enter.
- When paired the device until the LED displays ON.

To obtain the data of the device:

- On the console, type the commands, and then press enter.  
(type "help" and then press enter, can be found more commands information.)

To quit the program:

- On the console, type "quit", then press enter.

# Safety and Regulatory Guide

English

Safety and Regulatory Guide.....2

The health and safety warnings in this guide are  
periodically updated for accuracy and completeness.  
Check [www.votanic.com](http://www.votanic.com) for the latest version

VOTANIC Ltd.

## **Important Safety Information – Read Before Use**

The [vDongle] product (the “product”) is intended to be used with other peripheral devices (“peripherals”) with a virtual reality system. Read the following warnings and information before use of the product and follow all safety and operating instructions applicable to the product, the peripherals, and your virtual reality system. Failure to do so may cause bodily injury, electric shock, fire, and property and other damage.

### **Ensure You Are Able to Safely Use the Product**

Consult your doctor before using the product if you have pre-existing serious medical conditions (such as a heart ailment), conditions that affect your ability to safely perform physical activities, psychiatric conditions (such as anxiety disorders or post-traumatic stress disorder), or if you are pregnant or elderly.

Do not use the product if you are sick, fatigued, under the influence of intoxicants/drugs, or are not feeling generally well, as it may exacerbate your condition.

### **Radio Frequency Interference**

The product can emit radio waves that can interfere with the operation of nearby electronic devices. If you have a cardiac pacemaker or other implanted medical device, do not use the product until you have consulted with your doctor or the manufacturer of your medical device.

### **Avoid Overuse**

Prolonged, uninterrupted use of the product or peripherals should be avoided. It may negatively impact hand-eye coordination, balance, and/or cause other negative effects. While using the product or peripherals frequently and for prolonged periods of time, you may experience tiredness or soreness in your muscles, joints, or other body parts. Take regular breaks from using the product. The length and frequency of necessary breaks may vary from person to person.

### **Use by Children**

The product was not designed to be used by children. Do not leave the product within the reach of young children or allow them to use or play with it. They could hurt themselves or others, or could accidentally damage the product.

The product may contain small parts with sharp edges that may cause an injury or which could become detached and create a choking hazard for young children. Consult your doctor immediately if any parts of the product or peripherals are swallowed.

If older children are permitted to use the product, then adults should monitor them closely for any negative effects during and after their use of the product. Do not allow older children to use the product if negative effects are observed. Adults should also ensure that older children avoid prolonged use of the product.

## **General Use and Maintenance Instructions**

### **Electrical safety**

This product is intended for use when supplied with power from the designated peripheral. Other usage may be dangerous and will invalidate any approval given to this product.

### **Safety Precautions for Direct Sunlight**

Keep the product away from excessive moisture and extreme temperatures. Do not leave the product in places such as on a car dashboard, window sill, or behind a glass that is exposed to direct

sunlight or strong ultraviolet light for extended periods of time. The headset contains lenses which may focus and intensify bright light sources, causing damage to the hardware.

### **General Precautions**

- Do not connect with incompatible peripherals.
- Do not attempt to disassemble this product.
- Use only qualified personnel to service or repair this product.
- Always treat the product with care and keep it in a clean and dust-free place.
- Avoid dropping the product. If dropped, especially on a hard surface, and the user suspects damage, take it to an authorized service technician or provider for inspection.
- Do not expose the product to open flames or lit smoking products.
- Do not drop, throw or try to bend the product.
- Do not expose to liquid.
- Do not use harsh chemicals, cleaning solvents, liquid cleansers or aerosols to clean the product.
- Do not paint the product.
- Store the product at temperatures between 0°C to 40°C
- Please check local regulations for proper disposal of electronic products.
- Avoid hot areas. The product should be placed away from heat sources such as radiators, heat registers, stoves, or other products (including amplifiers) that produce heat.
- Avoid using the product after a dramatic change in temperature. When you move the product between environments with very different temperature and/or humidity ranges, condensation may form on or within the product. To avoid damaging the product, allow sufficient time for the moisture to evaporate before using the product.

NOTICE: When taking the product from low-temperature conditions into a warmer environment or from high-temperature conditions into a cooler environment, allow the product to acclimate to room temperature before turning on power.

### **Damage Requiring Service**

Contact an authorized service technician or provider under the following conditions:

- The product has been damaged by exposure to liquid, dropped, subject to impact or damaged.
- There are noticeable signs of overheating.
- The product does not operate normally when you follow the operating instructions.

### **Cleaning the product**

Unplug the product from other peripherals before cleaning. Use a damp cloth for cleaning, but NEVER use water to clean the product. If there is any itching, eczema, swelling, irritation of the skin, or you experience any discomfort, please discontinue use and consult your physician.

### **About vDongle regulatory agency identifications**

For regulatory identification purposes, vDongle product is assigned a model number of VD-0001.

vDongle FCC ID is **2AQWO-VD0001**. This FCC ID can also be found printed on the vDongle.

To ensure continued reliable and safe operation of vDongle, use only the accessories listed below with your VD-0001:



### **Federal Communication Commission Interference Statement**

This equipment has been tested and found to comply with the limits for a Class B digital device, pursuant to Part 15 of the FCC Rules. These limits are designed to provide reasonable protection against harmful interference in a residential installation. This equipment generates uses and can radiate radio frequency energy and, if not installed and used in accordance with the instructions, may cause harmful interference to radio communications. However, there is no guarantee that interference will not occur in a particular installation. If this equipment does cause harmful interference to radio or television reception, which can be determined by turning the equipment off and on, the user is encouraged to try to correct the interference by one of the following measures:

- Reorient or relocate the receiving antenna,
- Increase the separation between the equipment and receiver.
- Connect the equipment into an outlet on a circuit different from that to which the receiver is connected.
- Consult the dealer or an experienced radio or television technician for help.

#### **FCC Caution:**

- Any changes or modifications not expressly approved by the party responsible for compliance could void the user's authority to operate this equipment.
- This transmitter must not be co-located or operating in conjunction with any other antenna or transmitter.

This device complies with Part 15 of the FCC Rules. Operation is subject to the following two conditions: (1) This device may not cause harmful interference, and (2) this device must accept any interference received, including interference that may cause undesired operation.

### **Radiation Exposure Statement**

This equipment complies with FCC radiation exposure limits set forth for an uncontrolled environment.

### **Industry Canada Statement**

vDongle IC: **24308-VD0001**

This device contains licence-exempt transmitter(s)/receiver(s) that comply with Innovation, Science and Economic Development Canada's licence-exempt RSS(s). Operation is subject to the following two conditions:

1. This device may not cause interference.
2. This device must accept any interference, including interference that may cause undesired operation of the device.

L'émetteur/récepteur exempt de licence contenu dans le présent appareil est conforme aux CNR d'Innovation, Sciences et Développement économique Canada applicables aux appareils radio exempts de licence. L'exploitation est autorisée aux deux conditions suivantes :

1. L'appareil ne doit pas produire de brouillage;
2. L'appareil doit accepter tout brouillage radioélectrique subi, même si le brouillage est susceptible d'en compromettre le fonctionnement.

Radiation Exposure Statement

This equipment complies with IC radiation exposure limits set forth for an uncontrolled environment.

Déclaration d'exposition aux radiations

Cet équipement est conforme aux limites d'exposition aux rayonnements IC établies pour un environnement non contrôlé.

**Proprietary Notice**

© 2018 VOTANIC Ltd. All rights reserved. VOTANIC, and all other VOTANIC product and service names are the trademarks or registered trademarks in the U.S. and/or other countries of VOTANIC Ltd. and its affiliates.