

- Repeat the connection procedure. You can also try moving the mouse closer to the nano receiver.
- This mouse will work best if used on a smooth surface. It will not work on reflective, polished or clear surfaces such as glass or mirrors.
- Avoid looking directly into the light beam.
- Do not mix batteries of different types; do not use new batteries with old ones.
- Remove the batteries from the battery compartment if you will not be using the mouse for an extended period.
- Dead batteries should be immediately removed from the battery compartment in order to avoid leakage.
- Keep mouse and batteries away from fire, heat or water.
- Do not disassemble or replace parts of the mouse.

FCC Statement:

This device complies with Part 15 of the FCC Rules. Operation is subject to the following two conditions:

- (1) This device may not cause harmful interference.
- (2) This device must accept any interference received, including interference that may cause undesired operation.

Warning: Changes or modifications not expressly approved by the party responsible for compliance could void the user's authority to operate the equipment.

NOTE: This equipment has been tested and found to comply with the limits for a Class B digital device, pursuant to Part 15 of the FCC Rules. These limits are designed to provide reasonable protection against harmful interference in a residential installation. This equipment generates, uses and can radiate radio frequency energy and, if not installed and used in accordance with the instructions, may cause harmful interference to radio communications. However, there is no guarantee that interference will not occur in a particular installation. If this equipment does cause harmful interference to radio or television reception, which can be determined by turning the equipment off and on, the user is encouraged to try to correct the interference by one or more of the following measures:

Reorient or relocate the receiving antenna.
Increase the separation between the equipment and receiver.
Connect the equipment into an outlet on a circuit different from that to which the receiver is connected.
Consult the dealer or an experienced radio/TV technician for help.

Supplier's Declaration of Conformity 47 CFR 2.1077 Compliance Information

CRC: 2797302
RESPONSIBLE PARTY:
Army & Air Force Exchange Service
3911 S. Walton Walker Blvd
Dallas, TX 75236-1598
shopmyexchange.com/customer-service/#contact
or Toll Free: (800) 527-2345



This device complies with Part 15 of the FCC Rules.
Operation is subject to the following two conditions:
(1) This device may not cause harmful interference, and
(2) This device must accept any interference received,
including interference that may cause undesired operation.



Manufactured for your Military Exchanges
© **2022 Exchange**
P.O. Box 660202
Dallas, TX 75266-0202
shopmyexchange.com
Printed in China

power zone

CRC#2797302(BLUE)

MINI WIRELESS TRAVEL MOUSE

Instruction Manual

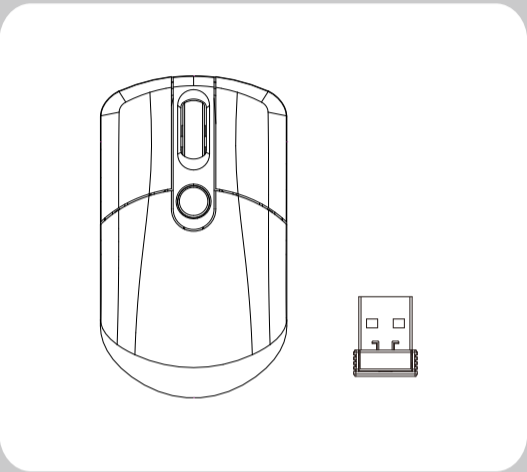

Please read this user manual carefully before using this item.

正面

Product Features



- Compact design for easy for pack and travel
- 3-button with scroll wheel
- Optical sensor for smooth tracking performance
- Switchable 800/1200/1600dpi resolution
- 2.4GHz wireless technology with operating range up to 26ft(8m)
- Plug & Play

◆ **Specifications**

MINI WIRELESS TRAVEL MOUSE

Power rating: 3V --- 15mA

System requirements: Windows® XP/Vista/7/8/10 & Mac OS.

Specifications are subject to change without further notice.

◆ **Package Content**

- Mini wireless travel mouse
- Instruction manual
- Nano receiver

◆ **Installation**

Note: When battery level is low, light indicator will flash red on the scroll wheel.

- Remove the battery cover.
- Insert 2 x AAA new batteries according to the battery polarity symbol.
- Replace the battery cover.
- Switch on your computer and connect the nano receiver to an available USB port.

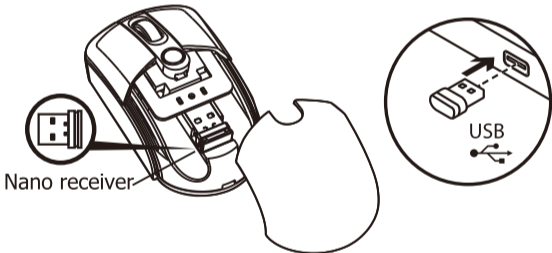

The following figure shows the positions of the mouse's scroll wheel and buttons.

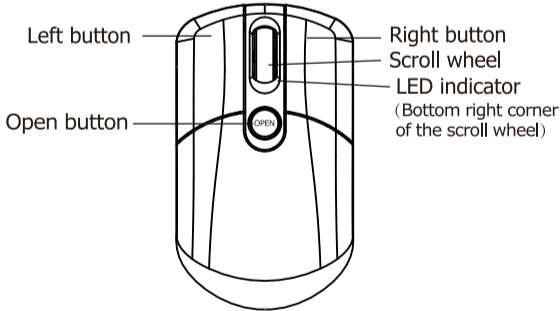

ON/OFF switch

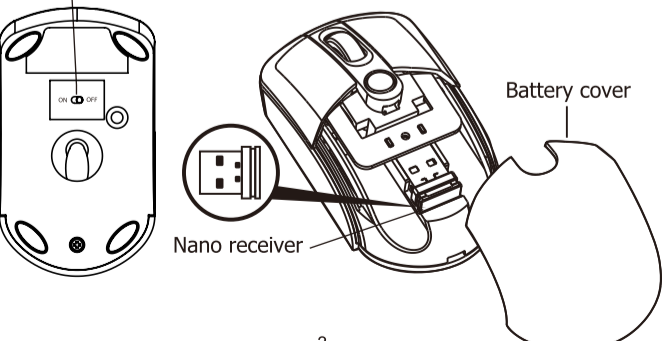

◆ **Activating The Wireless Mouse**

Switch the ON/OFF button to power on the mouse. The mouse will automatically connect to the nano receiver plugged into your computer.

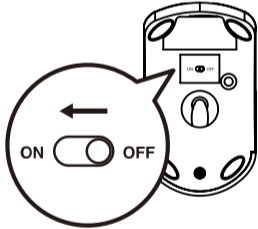

◆ **DPI Adjustment**

Press the left button and scroll wheel once at the same time to adjust the resolution:

- 800dpi - LED indicator flashes once.
- 1200dpi (default) - LED indicator flashes twice.
- 1600dpi - LED indicator flashes 3 times.

Caution



If the mouse does not work correctly, please try below actions.

- Check that the power switch is in the ON position.
- Make sure the nano receiver is plugged into a USB port and the computer is on or try the nano receiver in a different USB port.
- Check battery installation, replace battery if needed.
- If mouse performance is slow or intermittent around a wireless network, unplug the nano receiver from the USB port and then reinsert it. Reactivate the mouse with the ON/OFF switch on the bottom of the mouse.

反面