

Solar String Light
User Manual

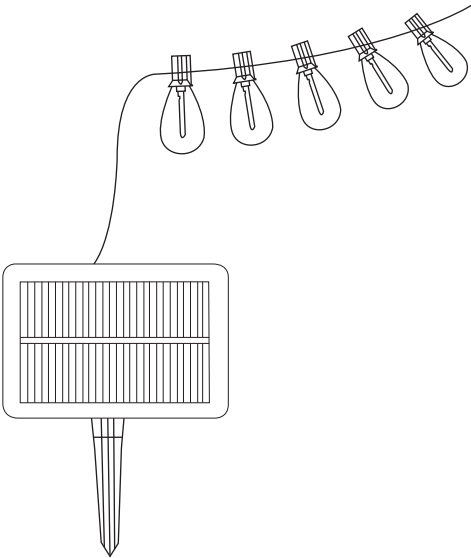

If you encounter any issues while using our products, please contact our Customer Support team through your Amazon Orders page.Or you can send your inquiry to our Official CustomerSupport at:

Call us: (725) 255-2966
Monday-Sunday from: 9:00AM-6:PM(PT)
Contact via email: support@jerritte.com

1

SAFETY INSTRUCTION

This manual applies to the following types of solar string lights

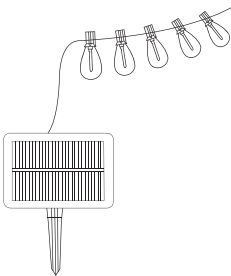

ATTENTION

- 1 Ensure the switch is turned on and check that all bulbs are functioning properly. If any bulbs are not working, please reach out to us for assistance.
- 2 Keep the solar panel away from the bulbs or other light sources to ensure the bulbs light up automatically at night.
- 3 Before first use, charge the battery for 8 hours using a USB cable or place the solar panel in direct sunlight for a full day.
- 4 Clear snow and debris from the solar panel to maintain efficient battery charging.

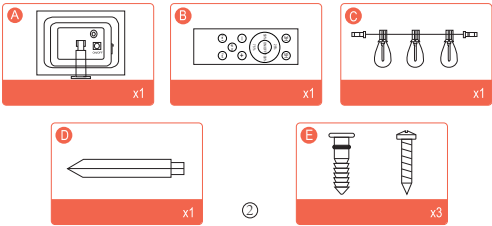

2

REMOTE CONTROL

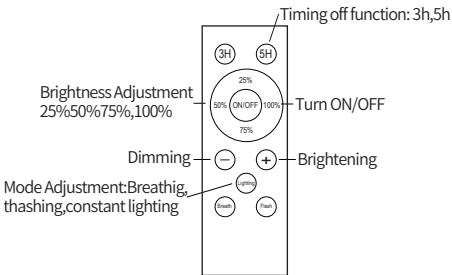

INSTALLATION STEPS

Before Installation

Before starting the installation, ensure all parts are included and undamaged. If any part is missing or defective, do not proceed with the installation.

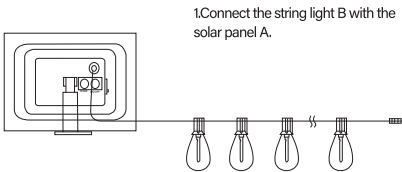

2.Testing the String Lights Press the button as shown in the diagram to verify that the string lights are functioning properly.

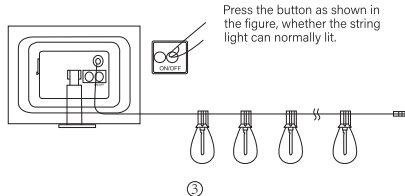

3

3.Install the panel by staking it into the ground or attaching it to drywall using screws and anchors.

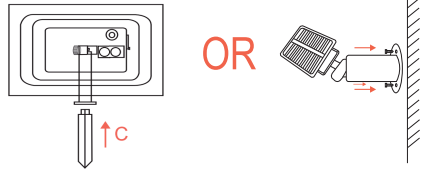

4.Charge

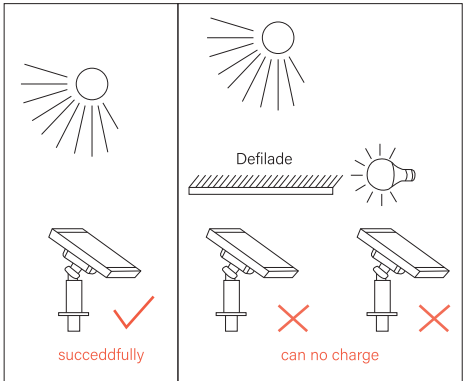

4

SOLAR PANEL GUIDELINES

- 1 Turn on the switch and check that all bulbs are working correctly. If not, contact customer support.
- 2Keep the solar panel away from the bulbs or other light sources to ensure the lights activate automatically at night.
- 3 Before first use, charge the battery for 8 hours using a USB cable or place the solar panel in direct sunlight for a full day.

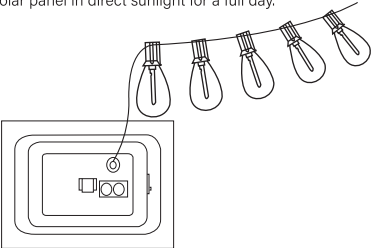

PRODUCT PARAMETER

Product Information

Material :Metal+Plastic
Package Contents String Light / Bulb / instruction Manual / Solar Panels

Table with 2 columns: Specifications and Details. Rows include Solar panel (2.5w/5v), Length of string (50FT), Charging time (8hours(solar), 2 hours (usb charger 5V 1A)), Light on / off (auto), Bulb Base (E12), Bulb quantity (18Bulb+1Spare), Color temperature (2200K), Light source (LED), and Mode (Lighting/Flash/Breath).

5

Common Troubleshooting

Q1: If the entire light string doesn't turn ON:

- a. Check if all connections are secure, namely, the two cords and the bulbs.
- b. Make sure the solar panel is fully charged.We suggest you place it in direct sunlight to recharge for 6 hours.
- c. If the solar panel is still not working properly after charging by sunlight, you can use usb to charge the charging panel for charging test, the charging port sends out red light, which means that the battery panel is undercharged and needs to continue charging.

Q2:The remote control does not work

- a. Check if the remote control battery has power.
- b. Reset the remote control, then re-pair it.

Reset the remote:

Within 30 seconds after power-on, long press the turn on/off button on the pole for 3-5 seconds. Reset the remote successfully when the lamp fast flashes.

Re-pairing:

Within 30 seconds after power-on, long press the turn on/off button on the top right of the remote for 3-5 seconds. Re-pair the remote successfully when the lamp fast flashes.

2. Other issues.

Please call or email us, we will provide you with a satisfactory solution.

6

Q3: Short Battery Life



- 1.On sunny days, ensure the solar panel receives 8 hours of sunlight to provide 8-15 hours of illumination.
- 2.On cloudy or rainy days, use USB charging as an alternative.

Q4: Entire String Not Illuminated

1. Verify that the solar panel has sufficient power.



Charging the solar panel using a USB cable. If the red indicator light is on, the solar panel is charging.(Please note that the power of the charging cable should preferably be 5V/1A, otherwise it may cause damage to the solar panel)

If the green indicator light is on, the battery is fully charged.Check for loose connections at the solar panel connection point and secure them if necessary.

7

CUSTOMER SERVICE

If you encounter any issues while using our products, please contact our Customer Support team through your Amazon Orders page.Or you can send your inquiry to our Official.

Call us: (725) 255-2966
Monday-Sunday from: 9:00AM-6:PM(PT)

Contact via email: support@jerritte.com

8

FCC Warning

This device complies with part 15 of the FCC rules. Operation is subject to the following two conditions: (1) this device may not cause harmful interference, and (2) this device must accept any interference received, including interference that may cause undesired operation.

Changes or modifications not expressly approved by the party responsible for compliance could void the user's authority to operate the equipment.

NOTE: This equipment has been tested and found to comply with the limits for a Class B digital device, pursuant to part 15 of the FCC Rules. These limits are designed to provide reasonable protection against harmful interference in a residential installation. This equipment generates uses and can radiate radio frequency energy and, if not installed and used in accordance with the instructions, may cause harmful interference to radio communications. However, there is no guarantee that interference will not occur in a particular installation. If this equipment does cause harmful interference to radio or television reception, which can be determined by turning the equipment off and on, the user is encouraged to try to correct the interference by one or more of the following measures:

- Reorient or relocate the receiving antenna.
- Increase the separation between the equipment and receiver.
- Connect the equipment into an outlet on a circuit different from that to which the receiver is connected.
- Consult the dealer or an experienced radio/TV technician for help.

Radiation Exposure Statement

The device has been evaluated to meet general RF exposure requirement. The device can be used in portable exposure condition without restriction.