

G3

LED Desk Lamp User Manual

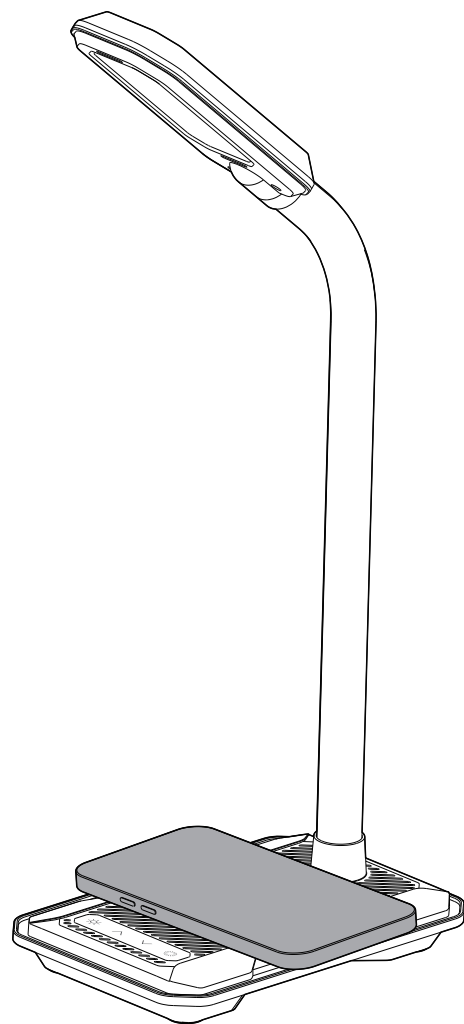

Please read all information carefully before you use the product and keep the manual for future reference.

Product Structure

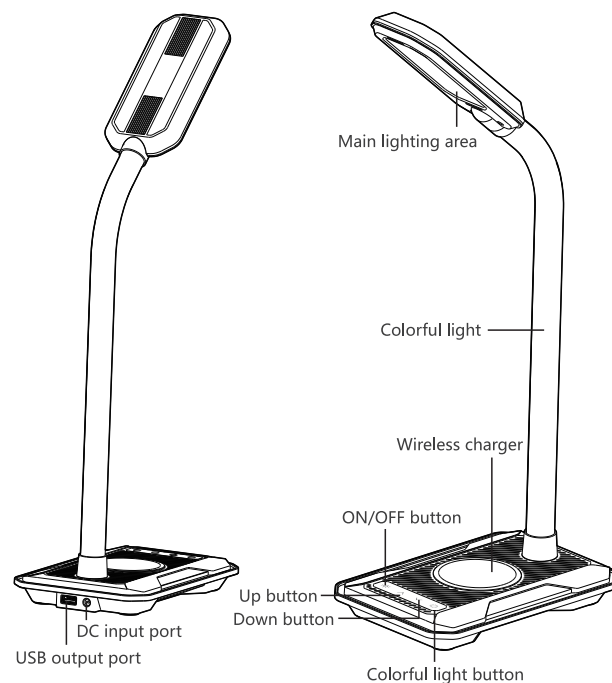

Specification

Adaptor	12V/2.5A
Color Temperature	3000±283K/4000±400K/5000±283K
Luminous flux	400-500Lm
Power of Main Light	6.5W
Max Output Power of Wireless Charger	10W
USB Output	5V/2.1A

Cautions:

- If use wireless charger only, the output power of wireless charging is 10W, it will change to 5W when you turn on the main light at the same time.
- Please wipe it by soft cotton fabric for surface cleaning and do not use any corrosive solvents.
- The light source is irreplaceable, please stop use once the light is end of life.
- If a failure occurs, please do not disassemble by yourself to avoid any damage on the product. You can contact the manufacture for maintenance.

Product List

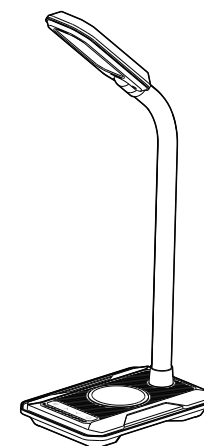

Lamp



Adaptor



User Manual

Note: The product accessories, user interface and other illustrations in the manual are schematic diagrams for reference only. Due to product upgrading, physical product may be slightly different from the schematic diagram. Please refer to the object.

Connect to the Power

Plug the adaptor into the DC port.
When connect to the power, RGB/LED is showing in curtain type, and indicator of wireless charger light up with red and green color in the same time .

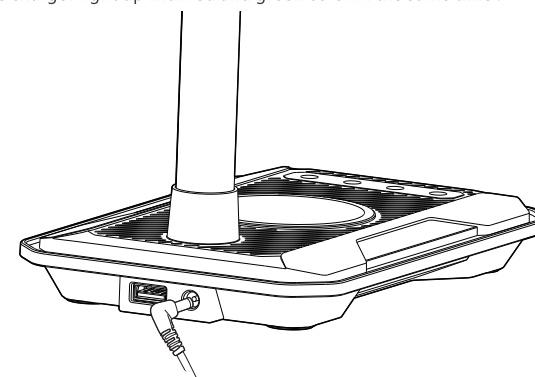

Note:

- The flexible cables on the outside of lamp cannot be replaced, please stop using the lamp immediately once the flexible cables are broken.
- Don't use on a plane which has bevel angle over 6°

Product Operation

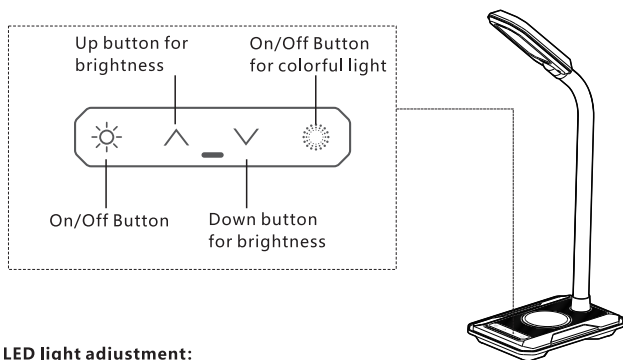

LED light adjustment:

Short press "☀" button to open or close the LED light, long press "☀" button to switch the color temperature, with Cold light - Warm light - Cold/Warm light in turn accordingly. Short press "▲" button to increase the brightness, short press "▼" decrease the brightness.

Colorful light adjustment:

Short press "🌈" to open the colorful light and turn to mode of Colorful - Follow spot - Gradual change - Acoustical 1 - Acoustical 2 in turn.

When LED light and colorful light work in the same time, short press "☀" to close both lights together.

Wireless Charging Function

Put the devices which supports wireless charging function to the wireless charger area, red indicator means it is charging, green indicator means it is full charged (For the phone charging, when the phone is full charged, the indicator will turn green if the phone support to send the fully charged signal, if not, the indicator will not turn green).

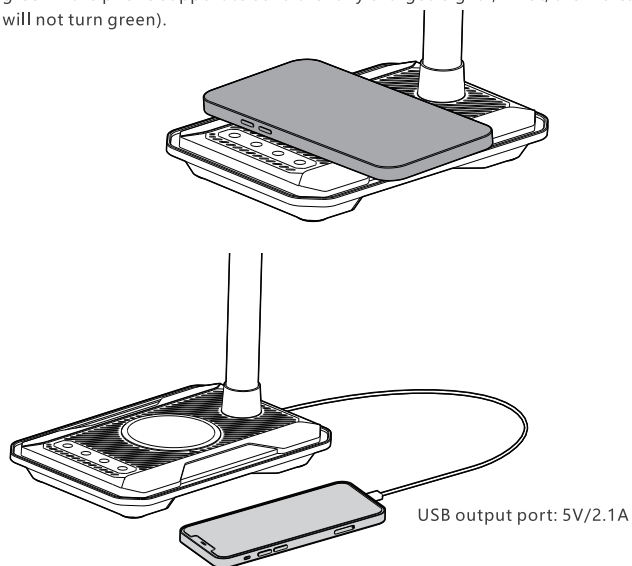

Viewing Angle Adjustment

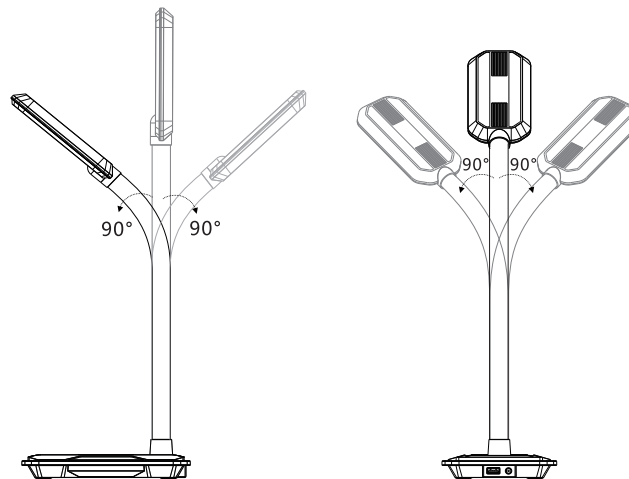

Note: Adjusting beyond the specified angle range may result in damage the connections.

Warranty card

Customer name(Mr/Ms)	
Tel	
Number	
Date	
Address serial	
Model Purchasing	
Purchasing store	
Store address	
Invoice number	
<div>Company Seal</div>	

FCC Statement

Changes or modifications not expressly approved by the party responsible for compliance could void the user's authority to operate the equipment.

This equipment has been tested and found to comply with the limits for a Class B digital device, pursuant to Part 15 of the FCC Rules. These limits are designed to provide reasonable protection against harmful interference in a residential installation. This equipment generates uses and can radiate radio frequency energy and, if not installed and used in accordance with the instructions, may cause harmful interference to radio communications. However, there is no guarantee that interference will not occur in a particular installation. If this equipment does cause harmful interference to radio or television reception, which can be determined by turning the equipment off and on, the user is encouraged to try to correct the interference by one or more of the following measures:

- Reorient or relocate the receiving antenna.
 - Increase the separation between the equipment and receiver.
 - Connect the equipment into an outlet on a circuit different from that to which the receiver is connected.
 - Consult the dealer or an experienced radio/TV technician for help
- This device complies with part 15 of the FCC rules. Operation is subject to the following two conditions (1) this device may not cause harmful interference, and (2) this device must accept any interference received, including interference that may cause undesired operation.

This equipment complies with FCC radiation exposure limits set forth for an uncontrolled environment. This equipment should be installed and operated with minimum distance 20cm between the radiator & your body.