

Bluetooth®

USER MANUAL



Model:V6 PLUS_T20S

Bluetooth Headset

Manufacturer:Shenzhen Winnerelec Industrial Co.,LTD

Address:411-416 Room Social security building, Honghua Bei Road Gongming Street Guangming New District,Shenzhen, China

Table of Contents

Introduction	Page 1
Packet Contents	Page 2
Install Instructions	Page 3
Charging	Page 5
General Operation Instructions	Page 5
FM Operation	Page 7
Universal Pairing and Using	Page 8
Bluetooth Intercom Talk	Page 9
Technical Specifications	Page 16
Certification	Page 16

1: Introduction

Thank you for choosing the T20s Motorcycle 6 Riders full-duplex stereo Bluetooth wireless helmet headsets, designed for installing into most open-face, flip-front and full-face style helmets.

With the T20s, you can call hands-free on your Bluetooth mobile phone, listen to music or voice instructions of GPS navigation, and activate wireless intercom for rider to rider or rider to passenger intercom talk within range of 1200 meters(depending on terrain conditions).

The T20s is compliant with Bluetooth Specification V3.0 supporting the following profiles: Headset Profile(HSP), Hands-Free Profile(HFP), and Advanced Audio Distribution Profile (A2DP), and Audio Video Remote Control Profile(AVRCP) and Audio Gateway (AG). It supports universal pairing with most Bluetooth headsets on the market. The user can activate Siri or S-Voice from the main unit for voice dialing and other voice commands. The FM radio tuner is built into the main unit and allows for station scanning.

Superior audio fidelity has been achieved with our high fidelity, non-ported, and ultra-slim helmet HD speakers. This headset also provides the industry's best combination of wind and ambient noise reduction with the miniature boom microphone.

Please read this User Manual carefully before using this product.

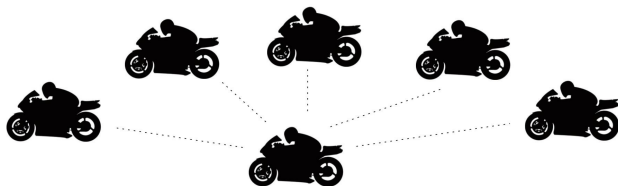

Rider to Rider Full duplex Intercom



How It Works

2: Packet Content



HIFI Speaker and Microphone

Clip Mounting Bracket

User Manual

3: Fixed installation method

1:Locate the helmet at the left and clean it up

2:Peel off the 3M rubber protective film

3:Apply pressure to the metal carrier to secure the holder firmly

Note: it takes 24 hours after drying.

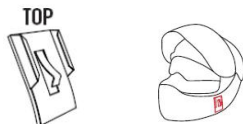

Temporary installation method

1:Clip on the left edge of the helmet

2:Remove metal handle after installation

3:If required, use additional anti slip rubber patches

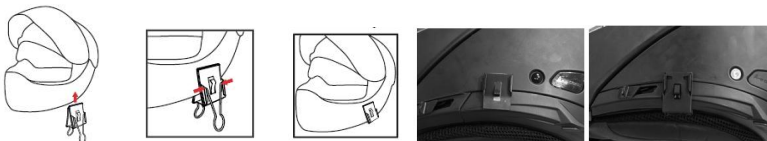

Install host

- 1: Slide V6S PLUS_T20S host off the top of the clip and you'll hear a click when it is completely plugged in
- 2: Plug in the 3.5mm headset plug

Headset mounting method

- 1: Stick the left and right horns of the headphones in the position of the left and right ears of the helmet
- 2: Keep the microphone in front of the mouth, Note: microphone holes point to the mouth

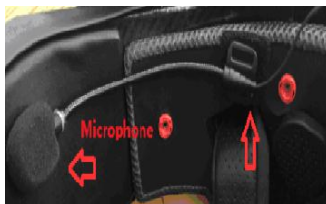
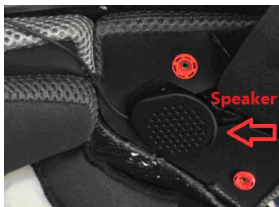

4: Charging

1. You can charge with the Micro USB cable in the package. During charging, OLED show “Charging”. After full charging, OLED show “Charged full”, and it is recommended to recharge the battery before each use. Suggest full charge before each use.
2. Low battery warning: Headset will automatically voice prompt low battery at every 5 minutes to prompt the user to recharge it.
3. Battery state notify: When standby, double press Power button to report battery level.

5: General Operation Instructions

Power on /Power off

Press Power button for approx. 3S, the screen display “Power on”, and it powers on.

When power on status, press Power button for approx. 1s, the screen display “Power off”, and it power off.



Pairing with Cell Phone or GPS and Using

Mobile Phone/GPS pairing steps

1. When power off, press Power button for approx 8S, the screen display “Pairing”, Open the phone Bluetooth, search for “ V6S PLUS_T20S ”, then click on the phone connection pair. After the pairing, the screen display “Paired” and goes back to standby mode.

Answer phone calling:

The unit will automatically answer the incoming call after 12 seconds. Or press Phone button to answer the incoming phone call immediately.

Reject incoming call:

When have incoming calls, double press Power button 2 times to reject within 12s.

End phone calling:

During talking, short press Phone button to end the call.

Voice dial:

When phone standby, double press Volume - button to make voice dialing (The phone itself must have voice dialing function)

Last number redials:

When cell phone standby, double press Volume + button to make last number redialing.

Memory connects with cell phone:

Once pairing with cell phone, when power on again, headset will re-connect with mobile automatically. Or in case disconnect during standby mode, short press Phone button will

connecting again.

Connect third party calls:

When connecting two cell phones, during phone call with first cell phone and second cell phone dial in, can double press Phone two times to answer the second cell phone and hold the first cell phone conversation. When finish the second cell phone conversation, will back to the conversation with fist cell phone.

Music Control:

Press the Phone button to play and pause the music. When playing music, double press Volume + button to go to next track, double press Volume - button to go to previous track.

Voice Volume Control:

Short press Volume + button or Volume- button adjust the voice volume. Or while music or talking state, long press Volume+ button or Volume - button adjust the voice volume.

6: FM RADIO

Turn on/off radio

When in standby mode, press and held Volume+ button or Volume - button 1 seconds to turn on FM radio. Press and hold it again for 1 seconds to turn off FM radio.

FM Radio Station Search

While in FM mode, double press Volume + button or Volume - button two times to search a next/previous FM channel.

Preset and store up to 6 FM radio stations

In FM radio mode, when a favorite station is found, long press Phone button 1 seconds to save, a beep tone will sound. Preset and store up 6 FM radio stations. Once 6 stations have been saved, saving a new station will overwrite the oldest saved station. Press Phone button to rotate between each saved station.

7: Universal Pairing and Using



Power on other brand Bluetooth device into pairing suitable, *meanwhile* T20s at standby mode, long press Intercom B button 1 seconds, and screen display “pairing”, then short press Intercom B, and screen display “Searching”. After pair successfully, the screen display “Paired”.

After paired, while the at standby mode, short press Volume+ and Volume- button at the same times, V6 PLUS_T20S reconnect with Bluetooth headset which connected before and start talking. While in talking mode, short press Phone button to end it.

8: Bluetooth Intercom Talk

The V6 PLUS_T20S can be paired with other T20s for up to a total of 6 units for full duplex Bluetooth intercom.

Pairing Two headsets and talk



Step 1: Power on unit 1 and unit 2, then long press unit 1 and unit 2 Button B, the screen display “Pairing” of all, then short press Button B on either unit, then the unit’s screen display “Searching”, after pairing finish, the screen display “Paired” and go back to standby mode.

Step 2: After pair finished, Short press Button B on either unit, it will start intercom, and screen display “Intercom B”. During Intercom talking, short press Phone button to exit intercom mode.

Pairing Three T20s headsets and talk



Step 1: Power on unit 1 and unit 2, then long press unit 1 and unit 2 Button B, the screen display “Pairing” of all, then short press Button B on either unit, then the unit’s screen display “Searching”, after pairing finish, the screen display “Paired” and go back to standby mode.

Step 2: Power on unit 1 and unit 3, then long press unit 1 and unit 3 Button C, the screen display “Pairing” of all, then short press Button C on either unit, then the unit’s screen display “Searching”, after pairing finish, the screen display “Paired” and go back to standby mode.

Step 3: After pair finished, Short press Unit 1’s Button B on either unit1 and unit2, it will start intercom, and screen display “Intercom B”. During Intercom talking, short press Phone button to exit intercom mode.

Step 4: After pair finished, Short press Unit 1’s Button C on either unit1 and unit3, it will start intercom, and screen display “Intercom C”. During Intercom talking, short press Phone button to exit intercom mode.

Pairing Four headsets and talk



Step 1: Power on unit 1 and unit 2, then long press unit 1 and unit 2 Button B, the screen display “Pairing” of all, then short press Button B on either unit, then the unit’s screen display “Searching”, after pairing finish, the screen display “Paired” and go back to standby mode.

Step 2: Power on unit 1 and unit 3, then long press unit 1 and unit 3 Button C, the screen display “Pairing” of all, then short press Button C on either unit, then the unit’s screen display “Searching”, after pairing finish, the screen display “Paired” and go back to standby mode.

Step 3: Power on unit 1 and unit 4, then long press unit 1 and unit 4 Button D, the screen display “Pairing” of all, then short press Button 4 on either unit, then the unit’s screen display “Searching”, after pairing finish, the screen display “Paired” and go back to standby mode.

Step 4: After pair finished, Short press Unit 1’s Button B on either unit1 and unit2, it will start intercom, and screen display “Intercom B”. During Intercom talking, short press Phone button to exit intercom mode.

Step 5:After pair finished, Short press Unit 1’s Button C on either unit1 and unit3, it will start intercom, and screen display “Intercom C”. During Intercom talking, short press Phone button to exit intercom mode.

Step 6:After pair finished, Short press Unit 1’s Button D on either unit1 and unit4, it will start intercom, and screen display “Intercom D”. During Intercom talking, short press Phone button to exit intercom mode.

Pairing Five headsets and talk

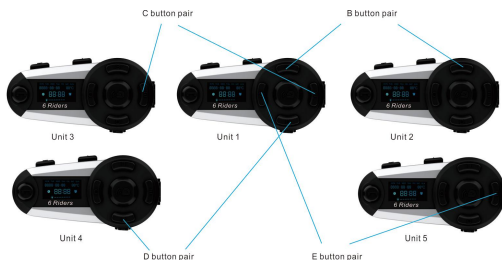

Step 1: Power on unit 1 and unit 2, then long press unit 1 and unit 2 Button B, the screen display

“Pairing” of all, then short press Button B on either unit, then the unit’s screen display

“Searching”, after pairing finish, the screen display “Paired” and go back to standby mode.

Step 2: Power on unit 1 and unit 3, then long press unit 1 and unit 3 Button C, the screen display

“Pairing” of all, then short press Button C on either unit, then the unit’s screen display

“Searching”, after pairing finish, the screen display “Paired” and go back to standby mode.

Step 3: Power on unit 1 and unit 4, then long press unit 1 and unit 4 Button D, the screen display

“Pairing” of all, then short press Button 4 on either unit, then the unit’s screen display “Searching”, after pairing finish, the screen display “Paired” and go back to standby mode.

Step 4: Power on unit 1 and unit 5, then long press unit 1 and unit 5 Button E, the screen display

“Pairing” of all, then short press Button 5 on either unit, then the unit’s screen display “Searching”,

after pairing finish, the screen display “Paired” and go back to standby mode.

Step 5: After pair finished, Short press Unit 1’s Button B on either unit1 and unit2, it will start intercom, and screen display “Intercom B”. During Intercom talking, short press Phone button to exit intercom mode.

Step 6: After pair finished, Short press Unit 1’s Button C on either unit1 and unit3, it will start intercom, and screen display “Intercom C”. During Intercom talking, short press Phone button to exit intercom mode.

Step 7: After pair finished, Short press Unit 1’s Button D on either unit1 and unit4, it will start intercom, and screen display “Intercom D”. During Intercom talking, short press Phone button to exit intercom mode.

Step 8: After pair finished, Short press Unit 1’s Button E on either unit1 and unit5, it will start intercom, and screen display “Intercom E”. During Intercom talking, short press Phone button to exit intercom mode.

Pairing Six headsets and talk

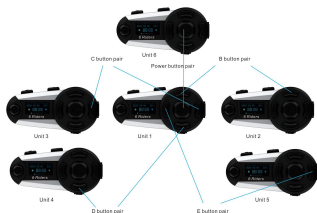

Step 1: Power on unit 1 and unit 2, then long press unit 1 and unit 2 Button B, the screen display “Pairing” of all, then short press Button B on either unit, then the unit’s screen display “Searching”, after pairing finish, the screen display “Paired” and go back to standby mode.

Step 2: Power on unit 1 and unit 3, then long press unit 1 and unit 3 Button C, the screen display “Pairing” of all, then short press Button C on either unit, then the unit’s screen display “Searching”, after pairing finish, the screen display “Paired” and go back to standby mode.

Step 3: Power on unit 1 and unit 4, then long press unit 1 and unit 4 Button D, the screen display “Pairing” of all, then short press Button 4 on either unit, then the unit’s screen display “Searching”, after pairing finish, the screen display “Paired” and go back to standby mode.

Step 4: Power on unit 1 and unit 5, then long press unit 1 and unit 5 Button E, the screen display “Pairing” of all, then short press Button 5 on either unit, then the unit’s screen display “Searching”, after pairing finish, the screen display “Paired” and go back to standby mode.

Step 5: Let unit 1 and Unit 6 in power off state, then long press unit 1 and unit 6 Power button about 6 seconds, the screen display “Pairing” of all, and short press Power button on either unit, the unit’s screen display “Searching”, after pairing finish, the screen display “Paired” and go back to standby mode.

Step 6: After pair finished, Short press Unit 1’s Button B on either unit1 and unit2, it will start intercom, and screen display “Intercom B”. During Intercom talking, short press Phone button to exit intercom mode.

Step 7:After pair finished, Short press Unit 1's Button C on either unit1 and unit3, it will start intercom, and screen display "Intercom C". During Intercom talking, short press Phone button to exit intercom mode.

Step 8:After pair finished, Short press Unit 1's Button D on either unit1 and unit4, it will start intercom, and screen display "Intercom D". During Intercom talking, short press Phone button to exit intercom mode.

Step 9:After pair finished, Short press Unit 1's Button E on either unit1 and unit5, it will start intercom, and screen display "Intercom E". During Intercom talking, short press Phone button to exit intercom mode.

Step 10:After pair finished, Short press Unit 1's Button power on either unit1 and unit6, it will start intercom, and screen display "Intercom A". During Intercom talking, short press Phone button to exit intercom mode.

Answer third intercom call:

When two device have started the intercom talking, the other intercom call in, the unit who be called have tone to notify, and double press Phone button two times on the unit to answer the incoming intercom call.

9: Technical specifications:

1. Bluetooth 3.0 Support : HSP,HFP,A2DP,AVRCP, AGHSP
2. Working hours: 12 hours
3. Standby time: 300 hours
4. Charging time: 3 hours
5. Battery: lithium containing rechargeable lithium battery 650mAH, 3.7v
6. Dimensions: 87cm * 45cm * 26cm
7. Weight: 50g
8. Certification : CE, FCC, TELEC

NOTE: This equipment has been tested and found to comply with the limits for a Class B digital device, pursuant to part 15 of the FCC Rules. These limits are designed to provide reasonable protection against harmful interference in a residential installation. This equipment generates uses and can radiate radio frequency energy and, if not installed and used in accordance with the instructions, may cause harmful interference to radio communications. However, there is no guarantee that interference will not occur in a particular installation. If this equipment does cause harmful interference to radio or television reception, which can be determined by turning the equipment off and on, the user is encouraged to try to correct the interference by one or more of the following measures:

- Reorient or relocate the receiving antenna.
- Increase the separation between the equipment and receiver.
- Connect the equipment into an outlet on a circuit different from that to which the receiver is connected.
- Consult the dealer or an experienced radio/TV technician for help Changes or modifications not expressly approved by the party responsible for compliance could void the user's authority to operate the equipment. This device complies with Part 15 of the FCC Rules. Operation is subject to the following two conditions: this device may not cause harmful interference, and this device must accept any interference received, including interference that may cause undesired operation.

RF Exposure Information:

FCC RF Exposure requirements: The highest SAR value reported under this standard during product certification for use next to the head with the minimum separation distance of 0 mm is 1.342 W/Kg. This transmitter must not be collocated or operating in conjunction with any other antenna or transmitter. This product is compliance to FCC RF Exposure requirements and refers to FCC website <https://apps.fcc.gov/oetcf/eas/reports/GenericSearch.cfm> search for FCC ID: 2AQN2-V6PLUST20S



MADE IN CHINA

Web: www.winnerelec.com

E-mail: sales@winnerelec.com