

Manfrotto
Imagine More

INSTRUCTIONS
MVG220 & MVG220FF

INDEX

| | | |
|---|-------|------------|
| GB | | P. 4 - 8 |
| I | | P. 9 - 13 |
| D | | P. 14 - 18 |
| F | | P. 19 - 23 |
| E | | P. 24 - 28 |
| CN | | P. 29 - 33 |
| KO | | P. 34 - 38 |
| J | | P. 39 - 43 |
| RU | | P. 44 - 48 |
| DISCLAIMER & INFORMATION FOR USERS | | P. 49 - 55 |
| DECLARATION OF CONFORMITY & CERTIFICATIONS | | P. 56 - 58 |

Overview

Professional 3-axis gimbal designed for DSLR and mirrorless cameras, designed with function buttons and LCD touch screen.

Touch Screen

- Camera Connection
- Bluetooth
- Multifunction Knob Control
- Battery Level

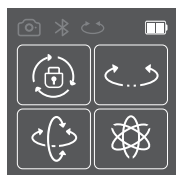

- All Lock Mode
- Pan Mode
- Follow Mode
- All Follow Mode

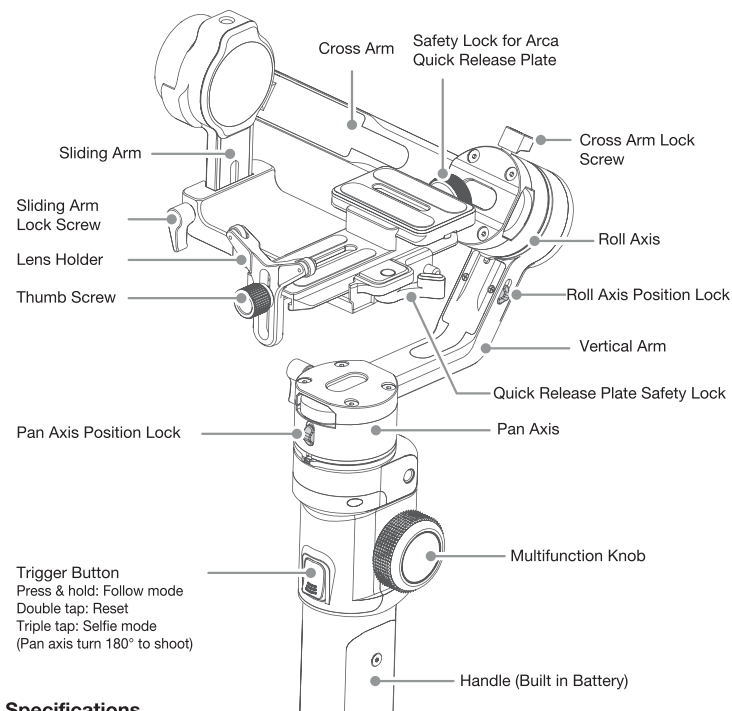
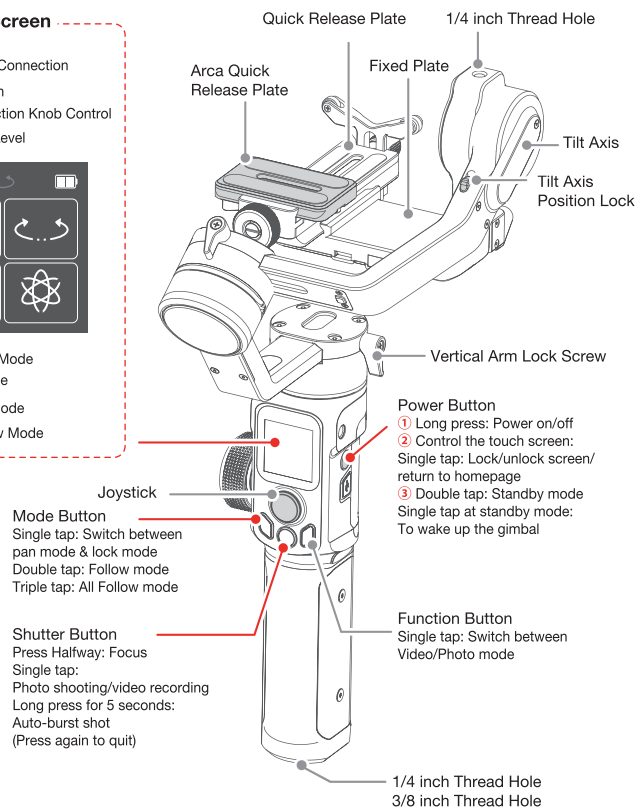

Specifications

| | | | |
|--------------------|---------------|--------------------------|------------------------------------|
| Max. Tilting Range | 230° | Theoretical Battery Life | 14h (well-balanced) |
| Max. Rolling Range | 360° | Weight | About 1100g |
| Max. Panning Range | 360° | Payload Capability | 2200g (well-balanced) |
| Tilt Follow Speed | 2°/s ~ 75°/s | Compatible Cameras* | Canon, SONY, Panasonic and others. |
| Pan Follow Speed | 3°/s ~ 150°/s | | |

* Please download the detailed manual for the specific compatible camera and lens.
This product does not include the camera.

Standard kit accessories



USB 2.0 to Micro
x1



USB 3.0 to Micro 3.0
x1



USB 2.0 to Mini
x1



USB 2.0 to Type C
x1



Type C to Multi
x1



DC 2.5mm (Panasonic
Shutter Cable) x1



Anti-slip Metal Tripod
x1



Versatile Arm
x1

Pro kit accessories

Professional kit (code MVG220FF) includes all the accessories provided within the standard kit detailed above, plus the additional items listed here:



Brushless Follow Focus (FF)
x1

Quick Start Guide

 Please read the detailed manual before you begin.

TIPS

- 1) Please mount the camera and balance it before Power ON.
- 2) When the battery is low, please charge the gimbal.
- 3) When not in use for a long time, power off the gimbal.
- 4) For quick start, utilising MVG220 basic features follow the steps below.

1 Charging

 Please fully charge the battery before power on the gimbal for the first time.

Open the USB rubber cover. Connect the USB 2.0 to Type-C cable to charge. Quick charge is available.

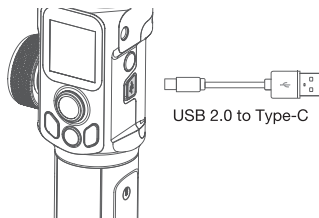

2 Position Lock

Each rotating axis has a position lock for convenient balancing and storage. Be sure to unlock the position locks before using the gimbal.

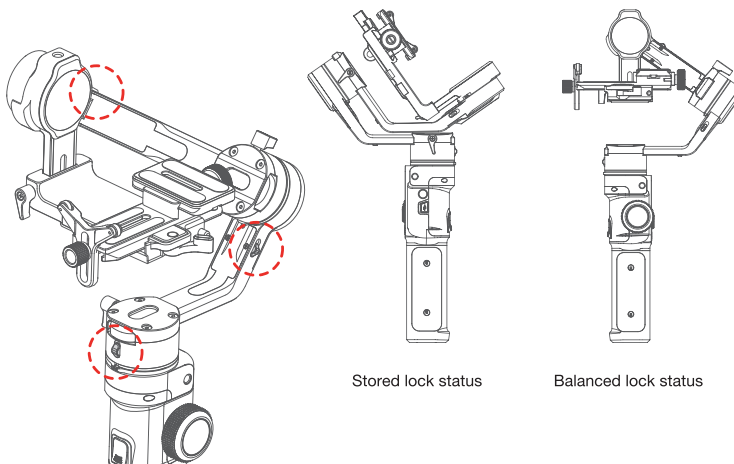

Stored lock status

Balanced lock status



Download Manfrotto gimbal app.



3 Camera Installation

⚠ Make sure the battery and memory card are installed before camera installation.

Step 1: Mount quick release plate ① on fixed plate ②, lock it. Loosen the ARCA quick release plate safety lock ③, take out ARCA quick release plate ④.

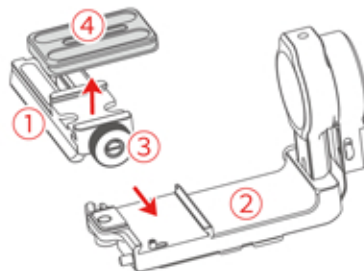

Step 3: Insert ARCA quick release plate directly into quick release plate ①, tighten the safety lock ③ for ARCA quick release plate.

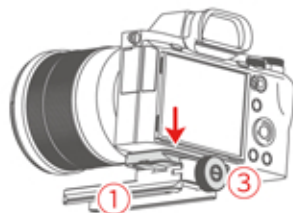

Step 2: Mount camera on ARCA quick release plate ④.



Step 4: Install lens holder ⑤ to support lens, and tighten the thumb screw.

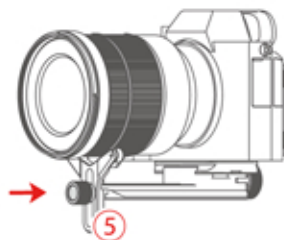

4 Gimbal Balancing

TIPS

- 1) Before balancing the gimbal, please lock the gimbal at the balanced lock status.
- 2) Lens cover should be removed from the camera and the memory card needs to be inserted to the camera to complete all the connections to ensure that the camera is ready for shooting.
- 3) When balancing the gimbal, make sure the camera and gimbal are all powered off.
- 4) If it is needed to add accessories after the balance is completed, gimbal needs to be re-balanced again.

4.1 Balance Tilt Axis

- (1) a. Unlock the tilt axis position lock ①, turn the camera lens upwards, and check the gravity center of camera.
- b. Loosen the sliding arm lock screw ②, slide the sliding arm ③ to balance the camera.
- c. Tighten the sliding arm lock screw ②, when the camera lens keeps upwards that means balanced.

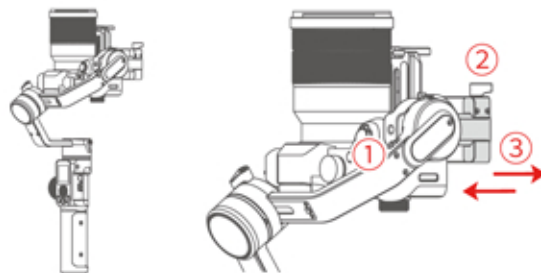

- (2) a. Place the camera lens forwards, check the gravity center of camera.
 b. Unlock the quick release plate safety lock ①, adjust camera position until it can stay stable at any angles.
 c. Lock the safety lock ①. Tilt the camera up or down, if it stays stable, it means balanced.

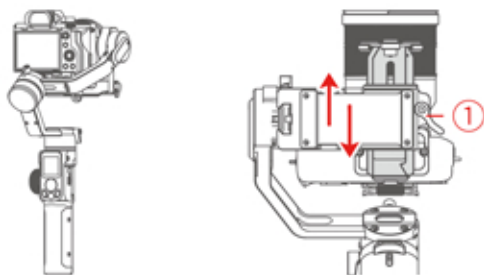

4.2 Balance Roll Axis

- a. Tighten the tilt axis position lock ①, unlock the roll axis position lock ②, check gravity center of camera.
 b. Loosen the cross arm lock screw ③, slide cross arm ④ to balance the camera position.
 c. Tighten the cross arm lock screw ③, and tilt the camera to the left or right, if it stays stable, it means balanced.

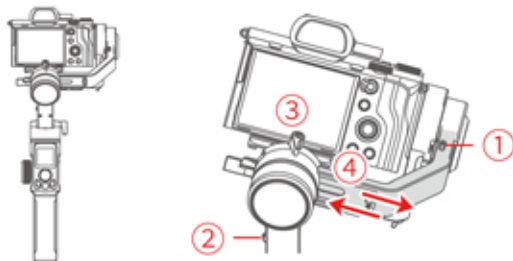

4.3 Balance Pan Axis

- a. Tighten the roll axis position lock ① after balanced tilt axis and roll axis. Unlock pan axis position lock ②, loosen vertical arm lock screw ③.
 b. Hold the handle angled to 15°~20°, check the camera's movement (roll axis will point down if not balanced).
 c. Slide vertical arm ④ to balance it until the camera stays there at any angles, balance succeeded.
 d. Tighten the vertical arm lock screw ③.

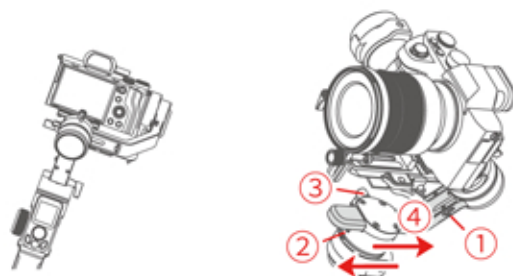

5 Power ON/OFF

 Be sure to unlock the position lock before using the gimbal.

Long press power button, release the button until it shows  on display.



Detailed Manual

Download the detailed user manual from official website manfrotto.com



DISCLAIMER

The information contained in this document is subject to change without notice.

Vitec Imaging Solutions makes no warranty and shall not be liable for any errors on information contained in this document.

Any changes or modifications not expressly approved by Vitec Imaging Solutions could void the user's authority to operate this equipment.

INFORMATION FOR USERS



In accordance with Article 10 of Directive 2012/19/UE of the 04/07/2012 concerning Waste Electrical and Electronic Equipment (WEEE).

The above symbol, also present on equipment, indicates that, at such time as the user should decide to dispose of the equipment, it must NOT be disposed of as unsorted municipal waste, but must be collected separately. The same applies to all components of the equipment and any recharge or refill elements that the product may comprise.

For information on the waste collection systems suitable for this equipment, contact Vitec Imaging Solutions or any authorised member of the National Registers in EU countries. Household (or similar) waste may be disposed of via standard municipal differentiated waste collection schemes.

If you purchase a new version of this model or similar equipment - or if your existing equipment measures less than 25 cm - you may return the items you no longer require to your retailer who will take care of contacting the company or organization handling the proper collection and management of used equipment.

Correct separate collection and specific treatment of WEEE are necessary to avoid potential damage to human health and the environment, and favour the recycling and recovery of component materials.

Improper or illegal disposal of this product by the user will result in punishments or fines being applied in accordance with national Decrees based on Directive 91/156/EC and 2008/98/EC.

ESCLUSIONE DI RESPONSABILITÀ

Le informazioni riportate in questo documento sono soggette a variazioni senza preavviso.

Vitec Imaging Solutions non rilascia garanzie e non assume responsabilità per eventuali errori nelle informazioni riportate in questo documento.

Qualunque variazione o modifica apportata senza espressa approvazione di Vitec Imaging Solutions può annullare il diritto dell'utente di impiegare questo apparecchio.

INFORMAZIONE AGLI UTENTI



Ai sensi dell'art. 10 della Direttiva 2012/19/UE del 04/07/2012 sui rifiuti da apparecchiature elettriche ed elettroniche (RAEE).

Il simbolo sopra riportato, presente anche sull'apparecchiatura, indica che essa deve essere oggetto di raccolta separata nel momento in cui l'utilizzatore decide di disfarsene (inclusi tutti componenti, i sotto-insiemi e i materiali di consumo che sono parte integrante del prodotto).

Per l'indicazione sui sistemi di raccolta di detti apparecchi vi preghiamo di contattare Vitec Imaging Solutions o altro soggetto iscritto nei vari Registri Nazionali per gli altri Paesi dell'Unione Europea. Il rifiuto originato da nucleo domestico (o di origine analoga) può essere conferito a sistemi di raccolta differenziata dei rifiuti urbani.

All'atto dell'acquisto di una nuova apparecchiatura o, senza obbligo di un acquisto nuovo, per le apparecchiature con dimensioni inferiori ai 25 cm, è possibile riconsegnare al rivenditore il vecchio apparecchio. Il rivenditore si farà poi carico di contattare il soggetto responsabile del ritiro dell'apparecchiatura.

L'adeguata raccolta separata dell'apparecchio dismesso e l'avvio alle successive operazioni di trattamento, recupero e smaltimento ambientalmente compatibile, consente di evitare potenziali effetti negativi sull'ambiente e sulla salute umana, e favorisce il riciclaggio ed il recupero dei materiali componenti.

Lo smaltimento abusivo del prodotto da parte dell'utente comporta l'applicazione delle sanzioni previste dai recepimenti nazionali delle Direttive 91/156/CE e 2008/98/CE.

CERTIFICATIONS

EU



Manufacturer's name :

Vitec Imaging Solutions

Manufacture's address :

Via Valsugana 100, 36022 Cassola (VI), Italy

Product name : GIMBAL

Product code : MVG220 & MVG220FF

Simplified Declaration of Conformity

GB - Hereby, "Vitec Imaging Solutions" declares that the radio equipment type "MVG220 & MVG220FF" is in compliance with Directive 2014/53/EU and with Directive 2011/65/CE and its amendments.

The full text of the EU declaration of conformity is available at the following internet address:

I - Il fabbricante, "Vitec Imaging Solutions", dichiara che il tipo di apparecchiatura radio "MVG220 & MVG220FF" è conforme alle direttiva 2014/53/UE e alla direttiva 2011/65/CE e alle sue rettifiche.

Il testo completo della dichiarazione di conformità UE è disponibile al seguente indirizzo Internet:

D - Hiermit erklärt "Vitec Imaging Solutions", dass der Funkanlagentyp "MVG220 & MVG220FF" der Richtlinie 2014/53/EU entspricht und der EU Richtlinie 2011/65/CE und deren Änderungen übereinstimmt.

Der vollständige Text der EU-Konformitätserklärung ist unter der folgenden Internetadresse verfügbar:

F - Le soussigné, "Vitec Imaging Solutions", déclare que l'équipement radioélectrique du type "MVG220 & MVG220FF" est conforme à la directive 2014/53/UE et à la directive 2011/65/UE et ses amendements.

Le texte complet de la déclaration UE de conformité est disponible à l'adresse internet suivante:

E - Por la presente, "Vitec Imaging Solutions" declara que el tipo de equipo radioeléctrico "MVG220 & MVG220FF" es conforme con la Directiva 2014/53/UE y con la Directiva 2011/65/CE y sus modificaciones.

El texto completo de la declaración UE de conformidad está disponible en la dirección Internet siguiente:

P - O abaixo assinado "Vitec Imaging Solutions" declara que o presente tipo de equipamento de rádio "MVG220 & MVG220FF" está em conformidade com a Diretiva 2014/53/UE e com a Diretiva 2011/65/CE e suas respectivas emendas.

O texto integral da declaração de conformidade está disponível no seguinte endereço de Internet:

S - Härmed försäkrar "Vitec Imaging Solutions" att denna typ av radioutrustning "MVG220 & MVG220FF" överensstämmer med direktiv 2014/53/EU och direktiv 2011/65/CE och dess tillägg.

Den fullständiga texten till EU-försäkran om överensstämmelse finns på följande webbadress:

NL - Hierbij verklaar ik, "Vitec Imaging Solutions", dat het type radioapparatuur "MVG220 & MVG220FF" conform is met Richtlijn 2014/53/EU en Richtlijn 2011/65/UE en de daaraan toe behorende amendementen is.

De volledige tekst van de EU-conformiteitsverklaring kan worden geraadpleegd op het volgende internetadres:

TR - Burada, "Vitec Imaging Solutions", "MVG220 & MVG220FF" tipi radyo ekipmanının 2014/53 / AB sayılı Direktife uygun olduğunu beyan eder.

AB uyumu beyanının tam metni aşağıdaki internet adresinden edinilebilir:

gimbal.manfrotto.com

USA**FCC ID: 22AQ5K-GIMBAL220****Declaration of conformity**

NOTE: This equipment has been tested and found to comply with the limits for a Class B digital device, pursuant to part 15 of the FCC Rules. These limits are designed to provide reasonable protection against harmful interference in a residential installation. This equipment generates, uses and can radiate radio frequency energy and, if not installed and used in accordance with the instructions, may cause harmful interference to radio communications. However, there is no guarantee that interference will not occur in a particular installation. If this equipment does cause harmful interference to radio or television reception, which can be determined by turning the equipment off and on, the user is encouraged to try to correct the interference by one or more of the following measures:

- Reorient or relocate the receiving antenna.
- Increase the separation between the equipment and receiver.
- Connect the equipment into an outlet on a circuit different from that to which the receiver is connected.
- Consult the dealer or an experienced radio/TV technician for help.

CANADA

IC ID: 24113-GIMBAL220

IC Statements:

This device complies with Industry Canada licence-exempt RSS standard(s). Operation is subject to the following two conditions: (1) this device may not cause interference, and (2) this device must accept any interference, including interference that may cause undesired operation of the device.

Under Industry Canada regulations, this radio transmitter may only operate using an antenna of a type and maximum (or lesser) gain approved for the transmitter by Industry Canada. To reduce potential radio interference to other users, the antenna type and its gain should be so chosen that the equivalent isotropically radiated power (e.i.r.p.) is not more than that necessary for successful communication.

Déclaration d'IC :

Ce dispositif est conforme aux normes RSS exemptes de licence d'Industrie Canada.

Son fonctionnement est assujéti aux deux conditions suivantes : (1) ce dispositif ne doit pas provoquer de perturbation et (2) ce dispositif doit accepter toute perturbation, y compris les perturbations qui peuvent entraîner un fonctionnement non désiré du dispositif.

Selon les réglementations d'Industrie Canada, cet émetteur radio ne doit fonctionner qu'avec une antenne d'une typologie spécifique et d'un gain maximum (ou inférieur) approuvé pour l'émetteur par Industrie Canada. Pour réduire les éventuelles perturbations radioélectriques nuisibles à d'autres utilisateurs, le type d'antenne et son gain doivent être choisis de manière à ce que la puissance isotrope rayonnée équivalente (P.I.R.E.) n'excède pas les valeurs nécessaires pour obtenir une communication convenable.

RUSSIA – BELARUS - KAZAKHSTAN – KYRGYZSTAN - ARMENIA



FCC regulatory conformance:

This device complies with Part 15 of the FCC Rules. Operation is subject to the following two conditions:

- (1) This device may not cause harmful interference.
- (2) This device must accept any interference received, including interference that may cause undesired operation.

NOTE: This equipment has been tested and found to comply with the limits for a Class B digital device, pursuant to part 15 of the FCC Rules. These limits are designed to provide reasonable protection against harmful interference in a residential installation. This equipment generates uses and can radiate radio frequency energy and, if not installed and used in accordance with the instructions, may cause harmful interference to radio communications. However, there is no guarantee that interference will not occur in a particular installation. If this equipment does cause harmful interference to radio or television reception, which can be determined by turning the equipment off and on, the user is encouraged to try to correct the interference by one or more of the following measures:

- Reorient or relocate the receiving antenna.
- Increase the separation between the equipment and receiver.
- Connect the equipment into an outlet on a circuit different from that to which the receiver is connected.
- Consult the dealer or an experienced radio/TV technician for help

NOTE: The manufacturer is not responsible for any radio or TV interference caused by unauthorized modifications to this equipment. Such modifications could void the user's authority to operate the equipment.

IC regulatory conformance

This device complies with CAN ICES-3 (B)/NMB-3(B).

This device complies with Industry Canada licence-exempt RSS standard(s). Operation is subject to the following two conditions:

- (1) this device may not cause harmful interference, and
- (2) this device must accept any interference received, including interference that may cause undesired operation.

Cet appareil est conforme à la norme CAN ICES-3 (B)/NMB-3 (B).

Le présent appareil est conforme aux CNR d'Industrie Canada applicables aux appareils radio exempts de licence. L'exploitation est autorisée aux deux conditions suivantes :

- (1) l'appareil ne doit pas produire de brouillage, et
- (2) l'utilisateur de l'appareil doit accepter tout brouillage radioélectrique subi, même si le brouillage est susceptible d'en compromettre le fonctionnement.

This equipment complies with IC radiation exposure limits set forth for an uncontrolled environment. This equipment should be installed and operated with minimum distance of 10 mm between the radiator and your body. This transmitter must not be co-located or operating in conjunction with any other antenna or transmitter.

Cet équipement est conforme aux limites d'exposition aux rayonnements de la IC établies pour un environnement non contrôlé. Cet équipement doit être installé et fonctionner à au moins 10mm de distance d'un radiateur ou de votre corps.

RF Exposure

This equipment complies with FCC radiation exposure limits set forth for an uncontrolled environment. This equipment should be installed and operated with minimum distance of 20cm between the radiator and your body, and with minimum distance of 10mm between the antenna and your handle.

This transmitter must not be co-located or operating in conjunction with any other antenna or transmitter.

