

# **Arrow**

## **Smartwatch**

USER MANUAL

# Welcome to The World of Arrow

Thanks for purchasing Arrow Smartwatch. To enjoy your Smartwatch, please consult this user's manual in detail. There are many functions available, such as calendar, pedometer, clock, camera, video recorder, audio recorder and more.

## What's in the box

Included in each box is one Arrow Smartwatch, one wireless charger base, one USB cable, one user manual, one warranty card and a screen cover.

### Short Key:

❶ Camera Short key  
or Photo Button

❷ On/Off Button or  
Screen Lock Button

(Click press Button❶ to enter photo mode in any status. Click press Button

❶ to take a photo and hold Button❶ (more than 2s) to take a burst photos.

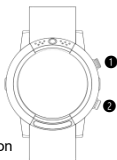

### Wake up screen:

Click press Button❷ to lock screen and enter sleep mode;

You can wake up screen by raising your arm.



### To turn off Screen:

1.Press button ❷

2.Cover the screen with your hand.



## Adjusting Camera Direction

The screen and the camera can be rotated by 360° allowing the user to point the camera in any direction they please.

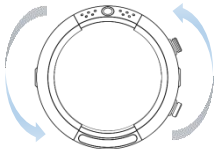

## Video recording while screen off

While recording video, to save battery, you may turn off the screen and continue to capture video. Cover the screen once with your hand to activate this feature.



## Wireless Charger Base

With our wireless charging technology, you can charge your Arrow Smartwatch simply by placing it on the charger base. We suggest charging your watch for a full 3 hours before first use.

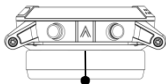

Wireless Charger Base

## Features

Memory: 1GB RAM + 8GB Flash ROM

Buttons: On/off Button, Photo Button

Remind: Vibrating by motor

Charge mode: Wireless charger

Screen: AMOLED, 1.4"

Resolution: 400\*400 pixels

Touch screen: Multi points

Camera: 5 Mega pixels

Battery: 480mAH, 3.7V Li-ion

Endurance Time: 48 ~ 72 hours

Water proof: Daily

## Operation instructions



### ① Changing Clock face:

Press and hold the screen to activate faces and swipe left and right to choose a new selection.

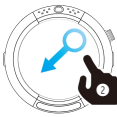

### ② Enter main interface:

To enter main interface from Clock face by slide

a) L to R; b) R to L; c) Diagonally to Lower Left at a 45° angle

- You can change to different page by sliding



### ③ Return to previous screen:

Lower Left 45° sliding

- Slide finger diagonally to lower left at a 45° angle.

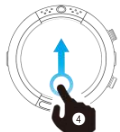

### ④ Exit current program:

Slide finger from down to up.



### ⑤ Status Screen:

Upper to Lower sliding

- Display: Time, Date, Battery Status
- Settings: Wifi; Bluetooth; Brightness

## Functions Description

### Camera

This program is used to take photos and record videos. You can rotate the bezel in any direction to capture the perfect moment.

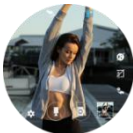
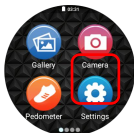

(Note: you can share your photos or videos to your mobile phone easily.)

## Gallery

This program is used to view your pictures or videos. In Gallery mode, you can enter the Camera mode quickly by click camera icon at upper right corner.

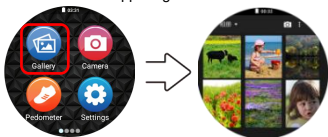

## Pedometer

This program is used to count up your steps. Whether you're running, walking or playing sports you can easily set your step goals.

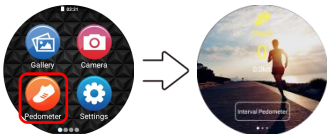

## Setting

Wireless and Network: WLAN, Bluetooth, you can turn on/off them.

Device: you can view or set Display, Reminder, Notice, Memory or Applications.

Personal: you can view or set Safety, Language, Input Method, Backup and Reset

**System:** you can view or set Date, Time, and About Watch.

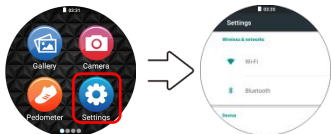

## Calendar

This program is used to view date by Day, Weekly, Monthly.



## Clock

This program is used to set Alarm Clock, Time Zone, Timer or Count Down Timer.

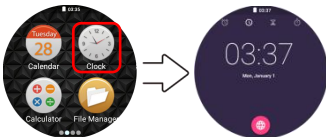

## Calculator

This program is used to run calculations. Add, Subtract, Multiply, Divide.

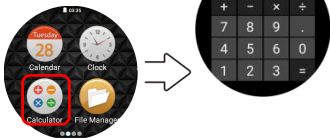

## File Manager

This program is used to view memory status and file attributes.

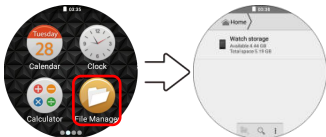

## Recorder

This program is used to record audio.



## Angle Calibration

This program is used to calibrate the screen reorientation sensor, please calibrate your watch as instructed and



follow the prompts. This will ensure your watch screen will adjust to correct position automatically no matter which direction you rotate the bezel.



## Arrow APP

This program is used to wirelessly share pictures , videos or audio files to your smart phone.



## APP Download & Setup

Please scan QR code below to download Arrow APP.



## **Scan here to setup**

(It is compatible with both iOS and Android phones)

### **Connecting between Arrow Smartwatch and Phone APP:**

Open Arrow APP in your Arrow Smartwatch and open Arrow APP in your smart phone. Then Arrow Smartwatch will set up an access point automatically. Find Arrow in WiFi list, and select it, then your smart phone is connected with your Arrow Smartwatch.

### **Share Files**

When your Arrow Smartwatch is connected with your smart phone, you can share files very easily by clicking “Share” soft key in phone APP.

### **Real Time Notifications:**

Open Application Notifications to view a list of applications that you may select. After making selections, your Arrow Smartwatch will receive notifications from your smart phone which you may read in real time.

## **| Warranty**

**If your Arrow Smartwatch has manufacturer defects or malfunctions which are not caused by damage from the user. We will take the following actions:**

- Within 15 days, you may send the unit to be repaired or return it to dealer for an exchange if it is not repairable. You are responsible for all shipping and delivery costs.
- Within 1 year, you can send the unit to be repaired at no cost. You are responsible for all shipping and delivery costs.
- We guarantee quality of the charger and charging cable for 6 months.

- We guarantee the strap stays in working condition for 15 days.

**Please use Arrow Smartwatch properly as described below:**

- Use it as described in user's manual
- Don't disassemble or repair it.
- Use it in a normal environment, don't use it in high magnetic fields or high electric fields
- Avoid dropping, shocking, soaking or placing your watch in a moist environment.

**We can't guarantee problems which are not related to product quality, such as:**

- If you are dissatisfied with appearance or operation of the Arrow APP;
- If you are dissatisfied with battery life, color, appearance, shape or compatibility.
- Normal wear and tear or aging of the unit.

Scratches or color fading of all outer components including (watch case, glass screen cover, watch buckle, buttons, bottom case or top bezel.

## **| Water exposure & daily use**

**Dear user,**

We make no guarantees about your Arrow Smartwatch meeting any waterproof requirements. But, it has been manufactured to protect against light splashing, rain or reasonable water exposure from hand washing.

To prevent damage to your unit we recommend avoiding:

- Dropping or shocking your watch;
- Dipping your watch into water
- Exposing your watch to extreme moisture extreme

temperature environments

- Wearing your watch while swimming or bathing
- Wearing your watch in a sauna or steam room;
- Exposing your watch to high pressure water or

high speed running water, such as taking a shower, water skiing, surfing, or jet skiing, etc...

- Exposing your watch to salt water, solvent, detergent, perfume or cosmetics.

We can not guarantee any damage or defects to your Arrow Smartwatch caused by misuse or by user accidents. Please be cautious with accessories, such as wireless charger and Micro USB cable and keep them free of water and dust.

If your Arrow Smartwatch is dipped into water or soaked by accident, please turn it off immediately, and place it in a dry environment.

We appreciate you purchasing the Arrow Smartwatch, we will do our best to keep innovating and improving our products.

## Warning:

This device complies with Part 15 of the FCC Rules. Operation is subject to the following two conditions: (1) this device may not cause harmful interference, and (2) this device must accept any interference received, including interference that may cause undesired operation.

changes or modifications not expressly approved by the party responsible for compliance could void the user's authority to operate the equipment.

NOTE: This equipment has been tested and found to comply with the limits for a Class B digital device, pursuant to Part 15 of the FCC Rules. These limits are designed to provide reasonable protection against harmful interference in a residential installation. This equipment generates, uses and can radiate radio frequency energy and, if not installed and used in accordance with the instructions, may cause harmful interference to radio communications. However, there is no guarantee that interference will not occur in a particular installation.

If this equipment does cause harmful interference to radio or television reception, which can be determined by turning the equipment off and on, the user is encouraged to try to correct the interference by one or more of the following measures:

- Reorient or relocate the receiving antenna.
- Increase the separation between the equipment and receiver.
- Connect the equipment into an outlet on a circuit different from that to which the receiver is connected.
- Consult the dealer or an experienced radio/TV technician for help.

NOTE: This device and its antenna(s) must not be co-located or operation in conjunction with any other antenna or transmitter

### RF Exposure Statement

To maintain compliance with FCC's RF Exposure guidelines, This equipment should be installed and operated with minimum distance of 5mm the radiator your body. This device and its antenna(s) must not be co-located or operation in conjunction with any other antenna or transmitter