

全向麦克风

Omnidirectional Microphone

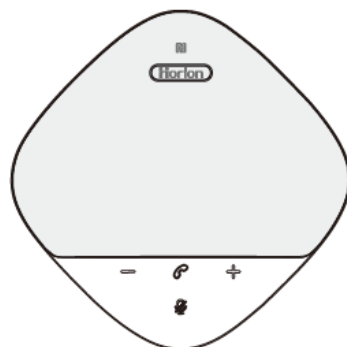

本使用说明书所有图片仅供参考，具体请以实物为准

HM-5P无线全向麦克音箱

使用说明书

Contents

- 1. Important Information.....1
- 2. Safety Warnings and Precautions.....1
- 3. Product Appearance.....5
- 4. Connection modes.....6
- 5. Direction for use.....12
- 6. Common faults and troubleshooting.....18
- 7. FCC.....20
- 8. Key Specifications.....22

1. Important Information

This manual contains the precautions and the product usage. Please read and understand all the instructions before using the device. The damage caused by failure to follow the instructions is not covered by the warranty. Please keep this manual properly.

2. Safety Warnings and Precautions

➤ Be careful of electric shock or fire!

1. This device is not waterproof, please keep it dry; if water is immersed in this product, please shut down immediately and contact the customer service center according to the prompt provided by the customer service center before using it again.
2. Never place this device and accessories near the burning flames or other heat sources, including direct sunlight.
3. This device should be turned off and unplugged before lightning storms.

➤ **Be careful of short circuit or catching fire!**

1. Before connecting this device to an electrical outlet, please make sure that the power supply voltage matches the voltage value printed on the back or bottom of the product. Never connect the product to an electrical outlet when the voltage is different.

➤ **Be careful of injury or damage this speaker!**

1. Never place this device or any objects on a power cord or other electronic devices.
2. If this product is transported at a temperature below 5°C, please unpack the product and wait until the temperature reaches room temperature before connecting it to a power outlet.
3. This product comes with sharp objects, please handle it carefully so as to avoid injury to the user or scratching the appearance of the product or damaging the internal parts of the product!

➤ **Be careful overheat!**

1. Never install this device in an enclosed space. Always leave at least 4 inches space around the product for ventilation.

➤ **Children's health**

1. This device and accessories may contain some small parts, please keep them out of the reach of children to avoid danger.

➤ **Care for the product!**

1. Clean this device only with a piece of microfiber cleaning cloth.

➤ **Care for the environment!**

1. This device applies recyclable high-performance materials and components. Never dispose of this product with other household wastes. Please understand the local regulations on the sorting collection of electronic, electrical products and batteries.

2. Proper disposal of these products helps to avoid potential negative effects on the environment and human body health.

➤ **Maintenance & servicing**

1. Please contact professional service personnel for all repair services;
2. Please do not insert any sharp object into the inside of the device;
3. Please do not drop or hit the device to avoid damaging it.

3. Product Appearance

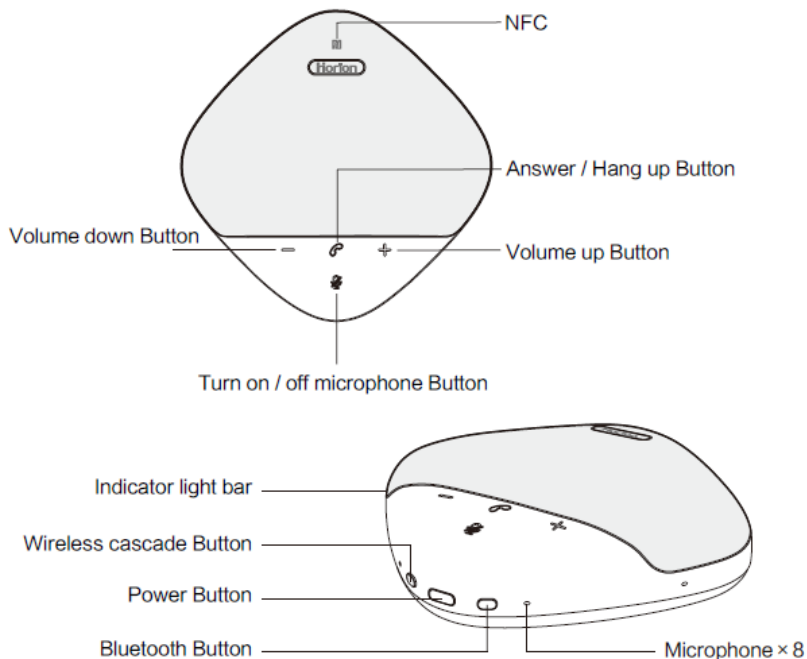

4. Connection modes

- **Support for multi-device connections**

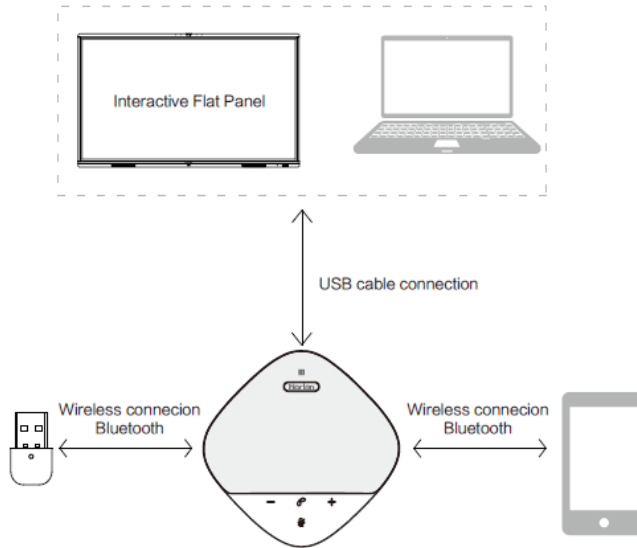

- (1) Support for USB Dongle, Bluetooth multi-channel simultaneous use:

It supports multi-channel data fusion of USB, Double Bluetooth. It can work in three connection modes at the same time to support simultaneous access of multiple parties for the conference.

- ◆ Mode 1: Connect the computer/Intelligent Flat Panel (Windows or Mac) to this device via USB cable.
- ◆ Mode 2: Connect this device with Bluetooth. The Bluetooth indicator will flash to indicate that the device is in Bluetooth pairing state. Enable Bluetooth functions on mobile phones/other devices, and select to connect this device from the Bluetooth device list. Please refer to the label at the bottom of the device for the name of Bluetooth (when the Intelligent Flat Panel is connected to the wireless speakerphone, USB Dongle is required to ensure the stability of Bluetooth connection).

- ◆ Mode 3: Optional USB Dongle (supporting win7/8/10 and Mac OS), operating as follows:
 1. Insert the USB Dongle into the computer(If you use a USB Dongle to connect to the Intelligent Flat Panel, please connect it to the front-mounted USB port of the Intelligent Flat Panel to ensure best use effect), USB Dongle will be automatically connected to the device(which is the only device bound by USB Dongle);
 2. If it is necessary to re-pair the wireless speakerphone to the new USB Dongle, the distance between the USB Dongle and the wireless speakerphone should be controlled within 3 meters. When the wireless microphone is in the Bluetooth disconnected state, press and hold the Bluetooth button for 5-7s to enter the binding mode. After the binding is completed, the blue light of the USB Dongle is always on; if the same USB Dongle is connected subsequently, the wireless microphone device will auto connect.

- **Support wireless cascading of dual devices in Dongle and Bluetooth state**

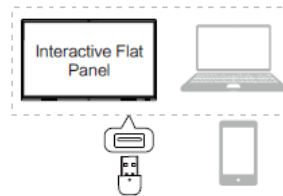
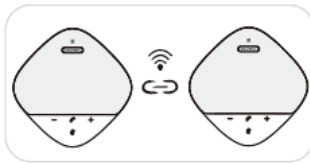

Note: See Bluetooth status / Setting for device cascading operations.

Note: to connect computer/Intelligent Flat Panel with USB Dongle, it is necessary to set this device as the default playback and recording device in the computer/Intelligent Flat Panel sound setting interface.

Note: The device can be quickly connected by "NFC" with the mobile phone.

- 1 Search for the NFC function in the mobile terminal system settings and turn it on;
- 2 The NFC sensing area touches the device;
- 3 Touch for no less than 2 seconds; if there is no reaction, please try again.

The following picture is: mobile phone NFC lable location

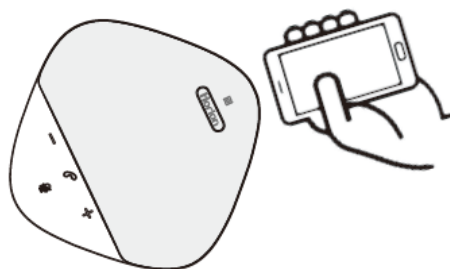
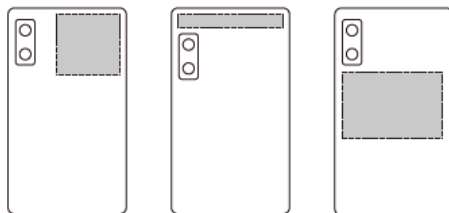

5. Direction for use

➤ Turn on/off the device

Long press and hold the power key for 2 seconds to turn on or off the device.

➤ Answer/hang up call

*This device can only use the function of answering and hanging up the phone when connecting to the phone.

- (1) When there is an incoming call, press the " ⌂ " key to answer the call.
- (2) When it is in calling state, press the " ⌂ " key to hang up the call.
- (3) When there is an incoming call, long press and hold the " ⌂ " key for 3 seconds to reject the call.

➤ **Turn on/off microphone**

Short press the microphone mute key to turn the microphone on , the red light means microphone turn off, and the white light means microphone turn on.

➤ **Volume adjustment**

Press volume "+" and volume "-" keys to increase or decrease the volume accordingly, Long presses can be quickly adjusted.

➤ **Equipment charging**

- (1) Connect the power adapter with the USB cable for charging;
- (2) When charging, the power light flashes; when full charge, the light is always on.

➤ **Checking the battery capacity**

- In the power-on state, short press the power key to view the current remaining battery capacity. When the Light ring is full of light, the battery is full. When the battery capacity is relatively low, the power button's red indicator light will flash and the low battery capacity tone is broadcast.

➤ **Bluetooth**

1. Support dual Bluetooth, Bluetooth 1 hidden hotspot, only for Dongle connection; Bluetooth 2 open hotspot, used to connect to Bluetooth host devices such as Phones, PC, Pad, etc;
2. When Bluetooth is not connected, long press to turn Bluetooth on/off;
3. When Bluetooth is connected, long press to disconnect the current Bluetooth connection.

➤ **Palm mute function**

Cover all touch buttons with your palm to achieve instant mute function.

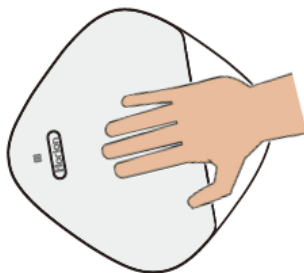

➤ **Bluetooth status/Setting**

Status	Operation	Description
How to connect the USB Dongle?	1. Insert the USB Dongle into the front USB port of the display device 2. Press and hold the Bluetooth button of the wireless omnidirectional microphone device for 5-7s to enter the Dongle pairing mode	Pairing: flashing blue light Pairing successful: blue light is always on
How to turn off bluetooth?	Long press the bluetooth button for 2s	Turn off bluetooth: white light is always on

Status	Actionable	Description
How to pair wireless cascade?	Two devices press and hold the cascade button for 2s to enter the wireless cascade pairing	Pairing: the green light is flashing Pairing is successful: the green light is always on
How to turn off the wireless cascade pairing?	Double click the Bluetooth button.	Disconnect the wireless cascade connection.
How to disconnect after bluetooth connected device?	Long press the bluetooth button for 2s	Disconnect bluetooth: blue light flashes.
Other functions of bluetooth button	Click the bluetooth key	play/pause music

6. Common faults and troubleshooting

The following table contains common faults and their solutions. Please read it carefully.

Fault	Possible Cause	Solution
Unable to turn on the device.	Low or no electricity.	Connect the adapter to charge.
Shut down automatically after running for a while.	Insufficient battery capacity.	Connect the adapter to charge.

Fault	Possible Cause	Solution
No sound.	Is the connection correct? Is the volume turned on?	Select the correct sound source input; adjust the device.
Unable to work with USB.	Is there any mistake in using the USB cable?	Please use the original USB cable to make a call.
Invalid key.	The key may be accidentally Touched.	Long press and hold the power button for 8seconds to reset the system.
Unable to charge the device.	The charging device is in fault or the battery is already full.	Replace it with a charging device with normal functions.

7.FCC

Federal Communication Commission Interference Statement

This equipment has been tested and found to comply with the limits for a Class B digital device, pursuant to Part 15 of the FCC Rules. These limits are designed to provide reasonable protection against harmful interference in a residential installation. This equipment generates, uses, and can radiate radio frequency energy and, if not installed and used in accordance with the instructions, may cause harmful interference to radio communications. However, there is no guarantee that interference will not occur in a particular installation. If this equipment does cause harmful interference to radio or television reception, which can be determined by turning the equipment off and on, the user is encouraged to try to correct the interference by one or more of the following measures:

- Reorient or relocate the receiving antenna.
- Increase the separation between the equipment and receiver.

- Connect the equipment into an outlet on a circuit different from that to which the receiver is connected.

- Consult the dealer or an experienced radio/TV technician for help.

Caution: Any changes or modifications not expressly approved by the party responsible for compliance could void the user's authority to operate this equipment.

FCC Caution:

This device complies with Part 15 of the FCC Rules. Operation is subject to the following two conditions: (1) This device may not cause harmful interference, and (2) this device must accept any interference received, including interference that may cause undesired operation.

Radiation Exposure Statement:

The device has been evaluated to meet general RF exposure requirement. The device can be used in portable exposure condition without restriction.

8.Key Specifications

Frequency band(s): 2402–2480MHz(BT)

Maximum power transmitted: 13dBm

FCC ID(Speakerphone): 2AQ5R-HM-5P

FCC ID(USB Dongle): 2AQ5R-UD10

Speakerphone