

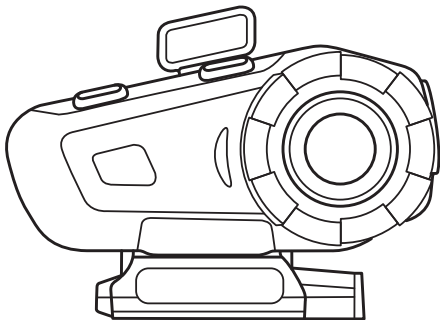

HELMET

BLUETOOTH INTERCOM



Operation Manual

Attention :

Thank you for purchasing G2 helmet Bluetooth intercom . For best use experiences , please read manual before use .



Installation

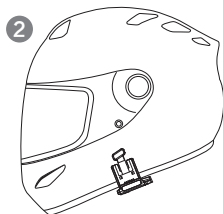
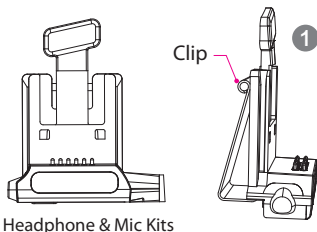

Fix the headphone & Mick Kits on the right position, adjust the speaker and mic, then hide the speaker cable.

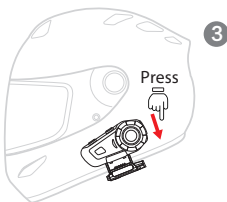

Insert the main unit, press to the bottom of kits, main unit locked and installation completed.

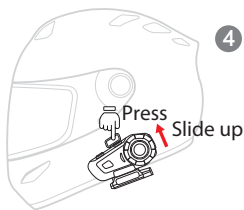

Take away the main unit by press the button and slide it up, disassmble completed.

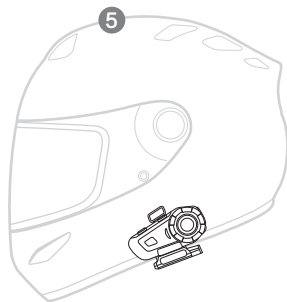

Remark: Mic should be close enough to moutg, and speaker near to ear. plase use sponge if the speaker postion is too deep.

Operation

1.Outlook / Function

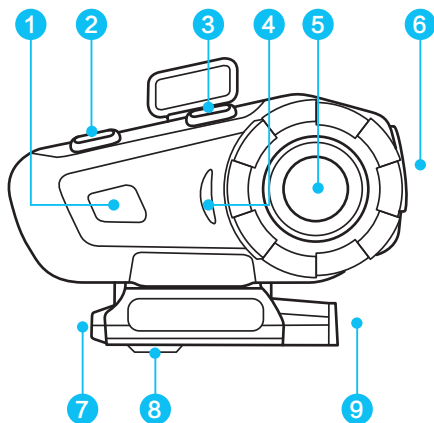

1 Intercom

2 Volume - / Previous

3 Volume + / Next

4 LED Indicator

5 Function

6 Charge / Data

7 Headphone & Mic Kits

8 Passersby Communication

9 Aux In

2. Charge

2.1 How to Charge

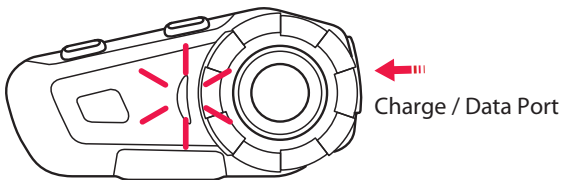

For first time use , please recharge the device until the red light is off .

1. Connect the cable with device and PC USB port ;
2. After cable connected , the red light on and start to charge , when battery is full , the red light will be off automatically . (Need 2 hours to fulfill the battery) .

** Do not use power from car or motorcycle directly , unstable power may damage the device .*

2.2 Power Detect & Notification Function

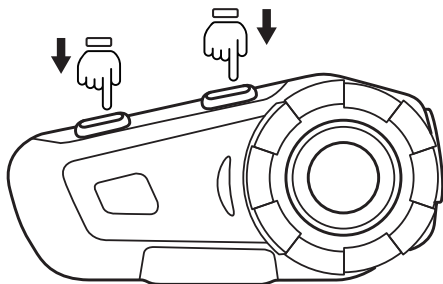

Low Power Notification:When power lower than 10% , red light flash in the function button and voice message will remind power lower than 10% , please recharge immediately .

Power Detect Function:G2 has power detect function , when device is on , short press volume - and volume + button at the same time , recorded voice message will tell you :

Power over 90%
Power over 50%
Power lower 50%
Power lower 10% please recharge immediately

3. Switch On / OFF

3.1 Switch On

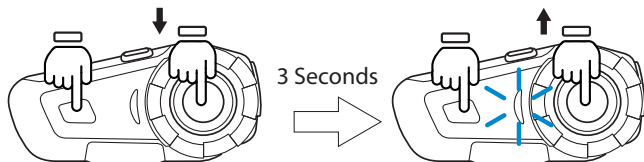

Press Intercom + Function button for 3 seconds until the LED indicator flash blue light , a voice prompt "Welcome" will be heard .

3.2 Switch Off

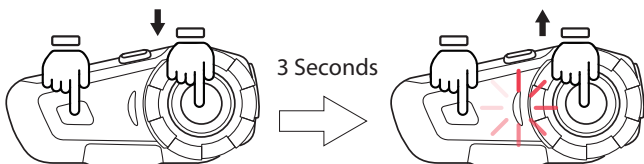

When device is on , press Press Intercom + Function button for 3 seconds until the LED indicator flash red light , a voice prompt "Power Off" will be heard .

4. Cellphone Function

4.1 Pair with Cellphone

STEP 1.

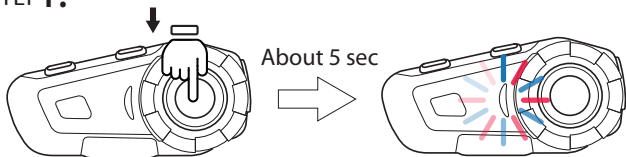

When device is on , long press function button, red and blue light flash in the function button , entering pairing mode .

STEP 2.

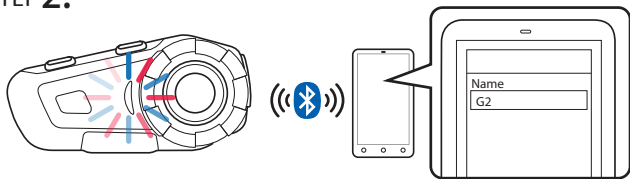

Switch cellphone Bluetooth , choose G2, the pairing is complete . Voice message will also say pairing complete .

Remark: when pairing complete , please check both cellphone audio and media audio are all chosen , otherwise call or music can not be processed .

4.2 Cellphone Function

Answering Call: Short press function once .

Hangup Call: After call , short press function once .

Refuse Call: Long press function button for 2 seconds .

Redial: Short press function button twice .

Volume Up: Press Volume + while talking .

Volume Down: Press Volume - while talking .

Manual/Auto Switch: Long press Function , Volume+ and Volume- at the same time for 3S when Stand by .

5. Voice Command



When your G2 is paired up with cellphone , long press Passersby Communication button , will automatically switch on the voice command function .

**Cellphone must equipped with this function .*

6. Music Play

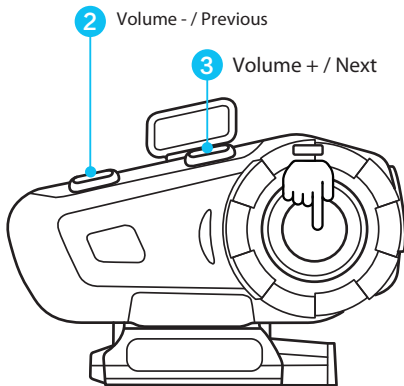

Play: When device is on , short press Function .

Pause: When music is playing , short press Function .

Volume Up : When music playing ,short press volume + once .

Volume Down : When music playing ,short press volume - once .

Play Previous: When music playing ,long press volume - for 2 seconds .

Play Next: When music playing ,long press volume + for 2 seconds .

7. Wire Connection

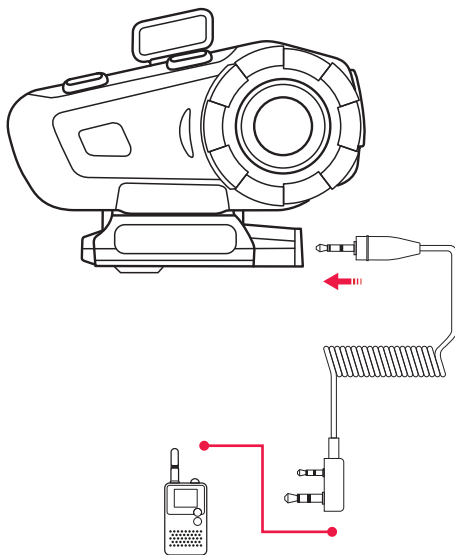

Two-Way Radio
(Needs professional radio connect cable)

Any device with 3.5mm connector can transmit voice signal to G2.
through the transfer line.

8. Passersby Communication

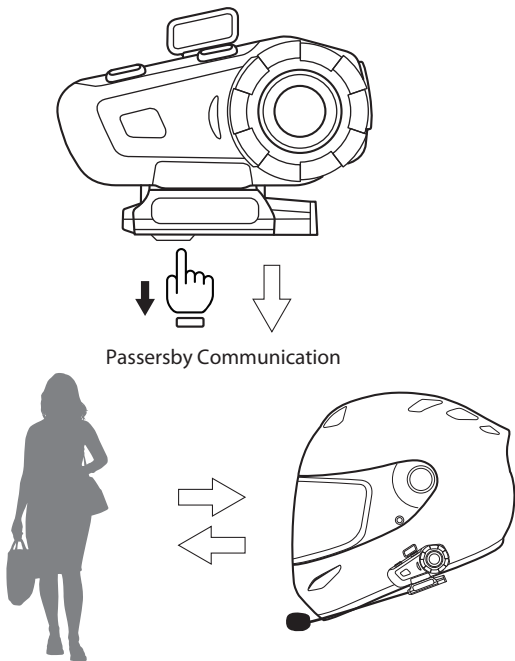

Short Press Passersby communication button to switch on this function , and re-press will switch off this function .

**This function allows rider talk to passersby without take off helmet .*

9. Intercom Function (Rider to Rider)

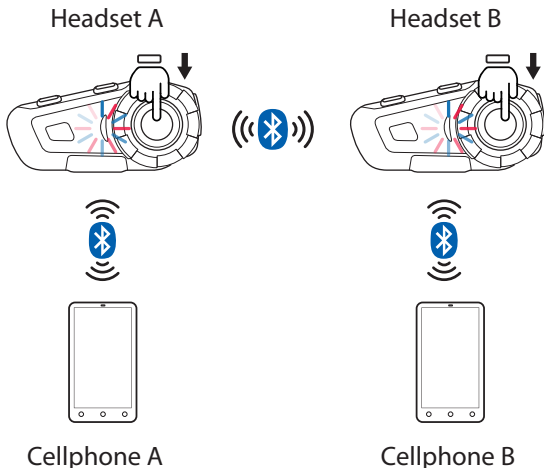

1. When device on , press both Headset A and B's function button until red and blue light to enter pairing mode .
2. Short press Headset A or B's intercom button , the red and blue light will be flashed slowly . once LED indicator turns into blue , the device connection completed .
3. After connection completed , you can switch on the intercom function by press any of the headset's intercom button .

10.FM

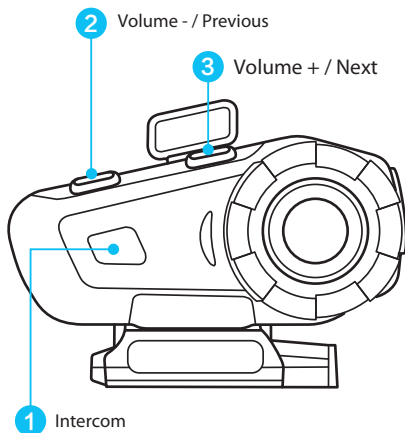

FM Switch On: Press Intercom button for 3 seconds when device is stand by ;

FM Switch Off: Press Intercom button for 3 seconds when FM is on ;

Volume Up : When FM On , short press volume + once .

Volume Down : When FM On , short press volume - once .

Search Previous: When FM On , long press volume - for 2 seconds .

Search Next : When FM On , long press volume + for 2 seconds .

11. Memory Clean

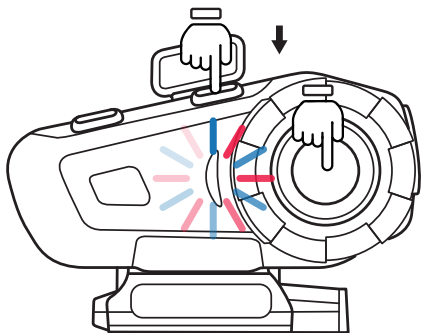

Memory Clean: When device is on, press Volume + and function button at the same time for 3 seconds. Then G2 will clear the pairing memory with other devices.

12. Q&A

12.1 Q&A

Q1: No sounds from one or two side speaker

A1: Check device plug , needs to firmly connected

Q2: Can it be recharged from bike USB charger while riding ?

A2.1: Not recommended , unstable power source will cause damage on internal circuit , may cause unable to recharge/can't fully charged/can't switch on.

A2.2: Power bank will be good .

Q3: When using radio , not transmission or continuous transmission

A3: Check 2.5mm pin , has to insert firmly . The pin equipped with waterproof aprons , user might think its already plugged .

Q4: New device can't switch on

A4: Recharged at least 30 minutes before switch use .

12.2 Warning

12.21 Sound Volume Warning

Long period or too loud may hurt hearing ability .

12.22 Disassemble or Modification

The G2 is precisely made in factory . Any disassemble or modification may damage the device , please do not tear any of the safety regulation and serial sticker from the device , that will void the warranty . Please contact us directly if needed .

FCC Statement

This equipment has been tested and found to comply with the limits for a Class B digital device, pursuant to part 15 of the FCC rules. These limits are designed to provide reasonable protection against harmful interference in a residential installation. This equipment generates, uses and can radiate radio frequency energy and, if not installed and used in accordance with the instructions, may cause harmful interference to radio communications. However, there is no guarantee that interference will not occur in a particular installation. If this equipment does cause harmful interference to radio or television reception, which can be determined by turning the equipment off and on, the user is encouraged to try to correct the interference by one or more of the following measures:

- Reorient or relocate the receiving antenna.
- Increase the separation between the equipment and receiver.
- Connect the equipment into an outlet on a circuit different from that to which the receiver is connected.
- Consult the dealer or an experienced radio/TV technician for help.

To assure continued compliance, any changes or modifications not expressly approved by the party.

Responsible for compliance could void the user's authority to operate this equipment. (Example- use only shielded interface cables when connecting to computer or peripheral devices).

This equipment complies with Part 15 of the FCC Rules. Operation is subject to the following two conditions:

- (1) This device may not cause harmful interference, and
- (2) This device must accept any interference received, including interference that may cause undesired operation.

RF warning statement:

The device has been evaluated to meet general RF exposure requirement.
The device can be used in portable exposure condition without restriction.