

# Power Bank

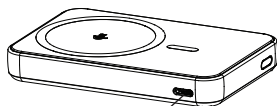

USB-C

Left side

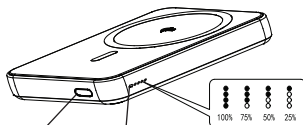

Power Switch

Charging Indicator

Wireless Charging Indicator

Right side

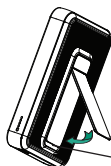

Support frame  
Open here

Charge your phone

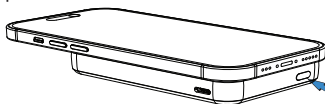

Press power switch  
to start charging

Remove any objects from back of phone before charging. Example: Magnet, holder, key or card

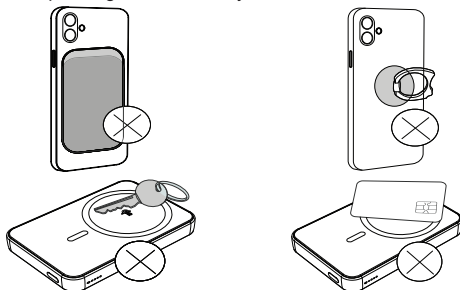

## Included

- 5000mAh Magsafe Portable Battery

## Basic Specification

- Battery cell: lithium-ion polymer
- Rated capacity: 5000mAh/3.7VDC, 18.5Wh
- Power bank capacity: 2600mAh/5VDC,
- Input: 5V  $\equiv$  3A, 9V  $\equiv$  2A 18W Max.
- Output USB-C: 5V  $\equiv$  3A, 9V  $\equiv$  2.22A 20W Max.
- Output Wireless: 15W Max.
- Output Total: 5W+7.5W(USB-C).
- Dimensions: 100(L)\*66(W)\*16(H)mm.
- Recommend using a USB charging adapter with 20W power output for maximum recharging speed.

FCC ID:2APXNLACP021 Model:080-08-2558

This device complies with part 15 of the FCC Rules. Operation is subject to the following two conditions.

- (1) This device may not cause harmful interference, and
- (2) This device must accept any interference received, including interference that may cause undesired operation.

Warning: Changes or modifications to this unit not expressly approved by the party responsible for compliance could void the user's authority to operate the equipment.

Note: This equipment has been tested and found to comply with the limits for a Class B digital device, pursuant to Part 15 of the FCC Rules. These limits are designed to provide reasonable protection against harmful interference in a residential installation. This equipment generates, uses and can radiate radio frequency energy and, if not installed and used in accordance with the instructions, may cause harmful interference to radio communications. However, there is no guarantee that interference will not occur in a particular installation. If this equipment does cause harmful interference to radio or television reception, which can be determined by turning the equipment off and on, the user is encouraged to try to correct the interference by one or more of the following measures:

- Reorient or relocate the receiving antenna.
- Increase the separation between the equipment and receiver.
- Connect the equipment into an outlet on a circuit different from that to which receiver is needed.
- Consult the dealer or an experienced radio/TV technician for help.

This equipment complies with FCC radiation exposure limits set forth for an uncontrolled environment. This transmitter must not be co-located or operating in conjunction with any other antenna or transmitter.

## CAUTIONS IMPORTANT SAFETY INSTRUCTIONS-SAVE THESE INSTRUCTIONS TO REDUCE THE RISK OF FIRE OR ELECTRIC SHOCK, CAREFULLY FOLLOW THESE INSTRUCTIONS

1. Do not modify, disassemble, open, drop, crush, puncture, or shred the battery.
2. The battery pack and charger contains a lithium-polymer battery, which is flammable.
3. Keep your battery pack and charger dry, and do not use with wet hands. Moisture in or on the battery pack and charger may lead to electrical shock.
4. Your battery pack and charger may become warm during operation. This is normal. However, to prevent overheating keep area around mini battery pack and charger ventilated and do not place anything on or around battery pack and charger during operation. Do not operate your battery pack and charger near a heat source, heat vent, or in direct sunlight. Your battery pack and charger should be used in temperatures between 50-80°F (10-27°C).
5. If the battery inside the battery pack and charger leaks for any reason, discontinue use, and do not allow the battery pack and charger's contents to contact your skin or eyes. In the event of accidental contact wash the affected area with large amounts of water and seek medical attention immediately.
6. Your battery pack and charger is not a toy. Keep them from children.
7. Do not store your battery pack and charger either fully charged or discharged.
8. Do not store your battery pack and charger at elevated temperatures (such as in your car) or in high humidity.
9. Do not dispose of your battery pack and charger as ordinary refuse, as it contains a lithium-polymer battery. Consult your local municipal or civil authority for instructions on correctly disposing of a lithium-polymer battery.

Operating ambient temperature: 0~25°C

Storage and transportation ambient temperature: -10~60°C

Altitude not higher than 2000m (The air pressure is not less than 80kPa)

### WARNING:

- Placing the battery in a fire or hot oven, or mechanically crushing or cutting the battery, can cause an explosion;
- Leaving the battery in an extremely high temperature surrounding environment, such as sunshine, fire, or hot surface may result in an explosion or the leakage of flammable liquid or gas;
- Batteries under extremely low air pressure may explode or leak flammable liquids or gases.

### CAUTION

There is a risk of fire or explosion if the battery is replaced with an incorrect model!