

# Preface

Thank you for choosing D02 Wireless stereo Bluetooth headset, this manual will help you know how to use your Bluetooth headset, before using Bluetooth headset, you must know and familiar with the Bluetooth function of your mobile phone.

## Accessories List

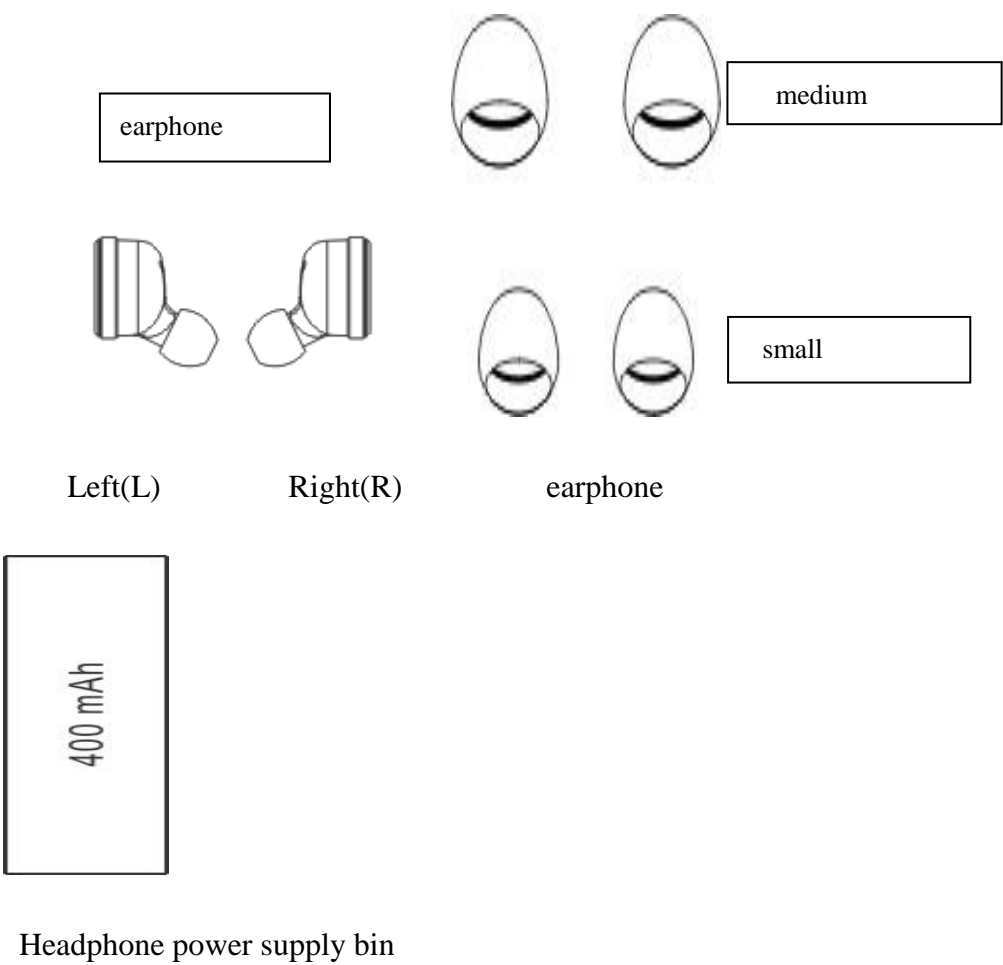

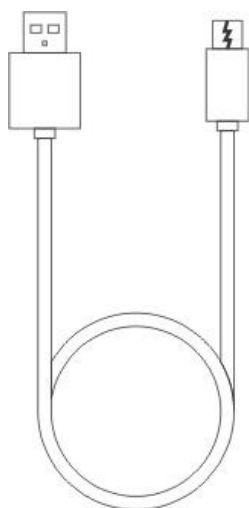

USB cable

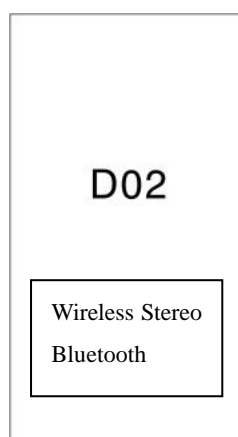

User manual

## Product diagram

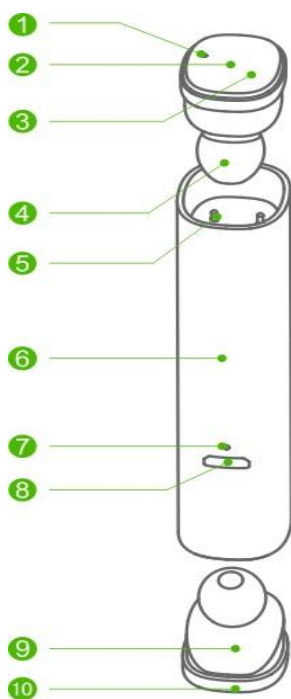

- 1: earphone LED
- 2: Hidden keys
- 3: Microphone
- 4: Ear Cap
- 5: Charge Port
- 6: Power supply bin
- 7: Power supply bin indicator light

- 
- 8: Micro USB port
  - 9: Headset
  - 10: Headset metal decoration

## Product parameter

Bluetooth version 4.2  
Headphone Battery 45 mAh  
Power bank Battery: 400 mAh  
Power supply bin Voltage: 5V  
Transmission frequency: 20hz-20khz  
Bluetooth protocol: A2DP/HFP/HSP/AVRCP/SPP

## Wearing graphic

1: In order to get the best audio effect, please try different size of earplugs, wearing the suitable earplug, you should feel close, comfortable and stable. When using outdoors, please put your cell phone on the same side of your left ear. A medium ear cap will have a better bass effect.



Remark: Please press the ear cap tightly when you install the ear cap, so as to make sure that it can fit to the charging bin and charging well.

## Binaural mode

1. Put the headset into the charging bin

Put the headset into the charging bin, the headset red indicator is on, which means it is charging. When charging is finished, the headset indicator light will be off after 5 times flashing, the headset charging takes about 45 minutes. (If the charging bin is low battery. Please charge the charging bin at first)



## 2. Take out the headset.

Take out the “L” and “R” headset from charging bin, the headset will power on automatically, after 10 seconds, the “L” and “R” will finish pairing automatically, then “L” headset will flash red and blue, “R” headset will light off.



“L” headset flash red and blue

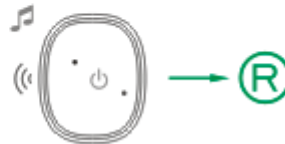

“R” headset light off

## 3. Turn on the mobile phone Bluetooth, pairing the Bluetooth name “D02-L”, finish pairing, start working.

If only one headset has sound, please delete the pairing and turn off mobile phone Bluetooth, when the headset is power off, please long press the power on key of “L” and “R” for 5 seconds until the headset flash red and blue, wait for 5-10 seconds, “L” headset flash red and blue, “R” headset will light off, turn on the mobile phone Bluetooth, search and pairing “D02-L” again.

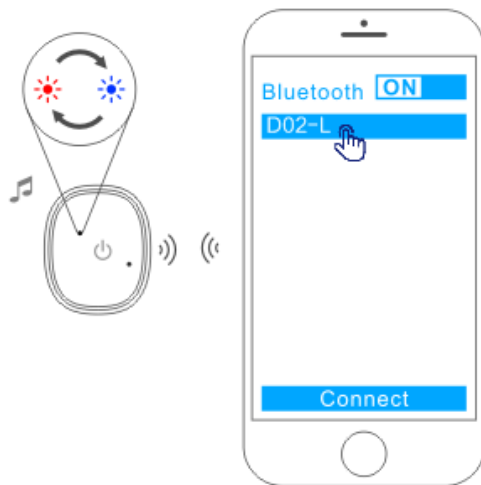

#### 4. Subsequent working.

Next time when you take out the headset from charging bin, the headset will pairing your mobile phone automatically (Make sure mobile phone Bluetooth is turned on already)

## Single ear mode

1. If “L” headset paired mobile phone before, next time when you use “L” headset single ear mode, just need to take out “L” headset and wait for about 10 seconds, the headset will pair automatically.
2. If “L” headset didn’t pair mobile phone before, you will need to take out headset or power on headset and wait about 10 seconds until the LED indicator light flash red and blue, then turn on mobile phone Bluetooth, search and pair “D05-L”.
3. The first time when you use “R” headset, take out headset or power on headset and wait for about 10 seconds until the LED indicator light flash red and blue, then turn on mobile phone Bluetooth, search and pair “D05-R” .
4. If “R” headset paired mobile phone before, next time when you use “R” headset single ear mode, just need to take out “R” headset and wait about 10 seconds, the headset will pair automatically.

## Charging Instruction

### How to charge the charging bin

Connect the adapter or USB port via USB cable, it will finish charging after about 120 minutes.

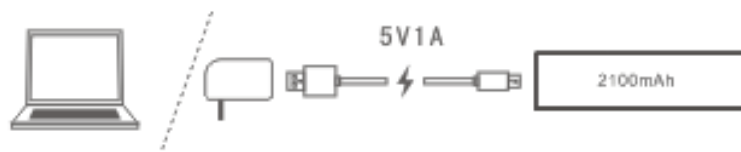

## Charging bin battery display

When charging bin is low battery, LED indicator flash blue.

When charging the charging bin, LED indicator light red.

When charging is finished, LED indicator lights are full of red light.

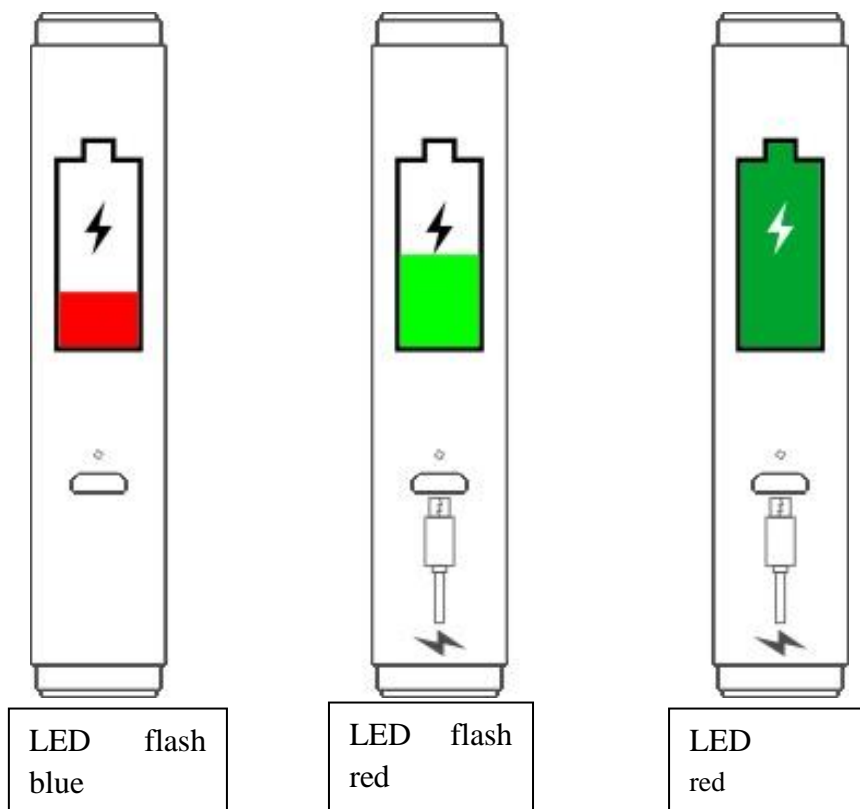

## Earphone Battery Display

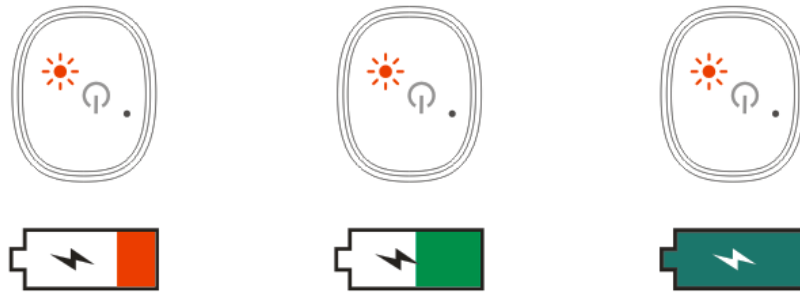

Working status

Flashing red light shows low power

Charging status

The red light keep lighting on shows it's charging.

Charging status

The red light flash 5 times and then light off shows charging is finished

## Function list:

### 1 Headset Call

Binaural mode: Call status, only the main headset(left headset) has sound.

Single ear mode: Call status, single headset has sound(left and right headphones can work separately)

Coming call status: Single click to answer the call, long press for two seconds to reject the call.

Standby status: Double-click the main-headset(left headset)key, will dial back the last number automatically.

Call Status: Single click the key to hang up the call, double-click the key to transfer the call to the phone.

### 2. Play music

Play: single click the key

Pause: single click the key

Next: Double click the key when playing the music

### 3. Power off

Put the headset back into the charging bin or long press the headset key for 4 seconds.

## Troubleshooting

Fault	Cause	Solutions
cant power on	Headset low battery	Charge the headset
Headset Flashing	Headset low battery	Charge the headset

---

red light		
Charging without indication	The headset are not connected well	Adjust headset position
Automatically shutdown	Low headset battery	Charge the headset
The headset has an echo.	The volume is too loud or the environment is too noisy	Adjust the volume or change the environment
The headset are noisy.	Outside environment is bad or too far away from the phone	Change position, or move close to the mobile phone
Sound is small	The headset is not wearing correctly or the volume is too small	Adjust the headset position or adjust the phone volume
Signal Intermittent	Outside environment interference or too far away from the phone	Change to better environment or move close to your mobile phone
Headset has no sound	No paired successfully between headsets	Pair the headset correctly

### **Warning**

- 1: Do not keep the equipment in too low or too high temperature for a long time, extreme temperatures can cause equipment to deform and reduce the battery capacity, also shorten the service life of the equipment.
- 2: Don't use the equipment in heavy rain, thunderstorms can cause equipment to malfunction, and increase the risk of electric shock.
- 3: Please do not disassemble or refit headsets for any reason, which may cause headsets to malfunction or burn down, please send the headset to the dealer for maintenance.
- 4: Please put the equipment and accessories in places where children and pets are not accessible, so as to avoid accidents.
- 5: Do not put the product in water.

### **FCC Warning:**

Changes or modifications not expressly approved by the party responsible for compliance could void the user's authority to operate the equipment.

This device complies with Part 15 of the FCC Rules. Operation is subject to the following two conditions: (1) this device may not cause harmful interference, and (2) this device must accept any interference received, including interference that may cause undesired operation.

This equipment has been tested and found to comply with the limits for a Class B digital device, pursuant to Part 15 of the FCC Rules. These limits are designed to provide reasonable protection against harmful interference in a residential installation. This equipment generates, uses and can radiate radio frequency energy and, if not installed and used in accordance with the instructions, may cause harmful interference to radio communications. However, there is no guarantee that interference will not occur in a particular installation.

If this equipment does cause harmful interference to radio or television reception, which can be



---

determined by turning the equipment off and on, the user is encouraged to try to correct the interference by one or more of the following measures:

- Reorient or relocate the receiving antenna.
- Increase the separation between the equipment and receiver.
- Connect the equipment into an outlet on a circuit different from that to which the receiver is connected.
- Consult the dealer or an experienced radio/TV technician for help.

This device complies with FCC RF radiation exposure limits set forth for an uncontrolled environment. This transmitter must not be co-located or operating in conjunction with any other antenna or transmitter