

User Manual

Item: Item Finder

Model: F1



Work with Apple Find My

To use the Apple Find My app to find this item, the latest version of iOS, iPadOS, or macOS is recommended. The Find Items app on Apple Watch requires the latest version of watchOS.



Content



Item Finderx1



USB-C Cablex1



Use Manualx1

Major Functions

Attach the item finder to the item that needs protection (such as keychain, bag, etc.).

1.By using the Apple Find My app, you can find your weTag from your iPhone, iPad, iPod touch, or Mac. Simply open the Apple Find My app, click on the corresponding item, and you will see the location of the item finder. Use the map guide to find it.

2.Even if it is left in a place far away from you, you can also enable the lost mode to lock the location of the item and use the map guide to find it since Apple device are widely used.

3.In addition, if your item finder leaves the range of your Apple device, you will receive an alarm notification. This can help you timely discover the lost items and avoid further losses.

4.Usage and Battery Replacement: The item finder has a built-in CR2032 cell battery, which can usually last for 1 year. Battery replacement is very easy, using a rocker, from the back of the positioner, open the back cover along the back cover gap, a new CR2032 cell battery can be replaced.

Before Connection

Use the item finder, need an Apple device (such as iPhone), turn on the Bluetooth function, in "Settings" - "Apple ID" - enable "Share My Location" in the Find My app.

Explanation of Buttons and Status

1. Turn On

Press the button of the item finder once, and when the finder makes a sound of "Di Didi Didi". Currently, the item finder is turned on successfully and enters the pairing state.

2. SN# check

In the power-on state, double-click the button, and the item finder will make a "beep" sound, which can be used to confirm whether the locator is working properly. At this moment, the unique serial number embedded in the locator can also be queried, which can help locate the owner of the item through the Apple Find My app and provide contact information to return the lost item to its rightful owner.

3. Turn Off:

a) Press and hold the button of item finder for 3 seconds, and it will play the confirmation sound "Didi" , and then release the button.

b)At this moment, the locator is turned off.

c)After turning off, the item finder cannot be used as a bound device, playing sound, and etc. It cannot protect your things.

4. Restoring the factory settings

a)Click the button 5 times in a row, when the 5th time is pressed, don't release the button, and keep pressing the button for 3 seconds at least, a beeping "Di Dididididi" will be played by buzzer. Release the button after confirming the sound effect (the above operation needs to be completed within 5 seconds).

b)Restoring the item finder to factory settings, please remember

Connect & Bind Device



1. Turn on the item finder



Find My

2. Open the Find My app

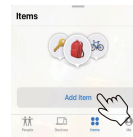

3. click "Add Items"

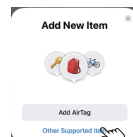

4.Select Other Supported Item



5. Click "Connect"

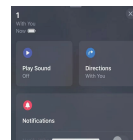

6. Finish

Battery Warning

The battery used in this product may leak or explode, result in personal injury, property damage or environmental pollution. For your safety, be sure to follow the instructions below:

1.Do not use sharp objects to remove the battery.

2.Do not put the battery into fire, heating or subject to high temperature treatment.

3.Do not place the locator in a place with high temperature, humidity, or direct sunlight.

4.Do not immerse the locator in water or other liquids.

5.Do not put the battery in contact with metal such as pins, coins, etc. so as not to cause a short circuit.

6.Do not use unauthorized or prescribed battery types.

7.Do not attempt to disassemble the battery or heat it.

8.Do not store batteries with other metal objects.

9.If you encounter battery leakage, heat or other abnormal conditions, please stop using it immediately, and dispose of in accordance with relevant safety regulations.

Legal Notice

Use of the Works with Apple badge means that a product has been designed to work specifically with the technology identified in the badge and has been certified by the product manufacturer to meet Apple Find My network product specifications and requirements. Apple is not responsible for the operation of this device or use of this product or its compliance with safety and regulatory standards.

Warranty terms and Contact us

The warranty terms for the locator series products are as follows: Within one year from the date of purchase, Shenzhen Winnershine Electronics Co., Ltd will be responsible for any problems caused by product materials and workmanship. The company will handle the specific requirements of the purchaser accordingly.

If you have any questions or issues with the product, please feel free to contact us at:

Customer Service: info@winnershine.com

Website: www.winnershine.com

FCC Warning

This device complies with part 15 of the FCC Rules. Operation is subject to the following two conditions: (1) this device may not cause harmful interference, and (2) this device must accept any interference received, including interference that may cause undesired operation. Any changes or modifications not expressly approved by the party responsible for compliance could void the user's authority to operate the equipment.

NOTE: This equipment has been tested and found to comply with the limits for a Class B digital device, pursuant to Part 15 of the FCC Rules. These limits are designed to provide reasonable protection against harmful interference in a residential installation. This equipment generates, uses and can radiate radio frequency energy and, if not installed and used in accordance with the instructions, may cause harmful interference to radio communications. However, there is no guarantee that interference will not occur in a particular installation. If this equipment does cause harmful interference to radio or television reception, which can be determined by turning the equipment off and on, the user is encouraged to try to correct the interference by one or more of the following measures:

- Reorient or relocate the receiving antenna.
- Increase the separation between the equipment and receiver.
- Connect the equipment into an outlet on a circuit different from that to which the receiver is connected.
- Consult the dealer or an experienced radio/TV technician for help.

The device has been evaluated to meet general RF exposure requirement. The device can be used in portable exposure condition without restriction