

Headphones

User Manual

MODEL : JH-ANC930PLUS



Function Instruction:

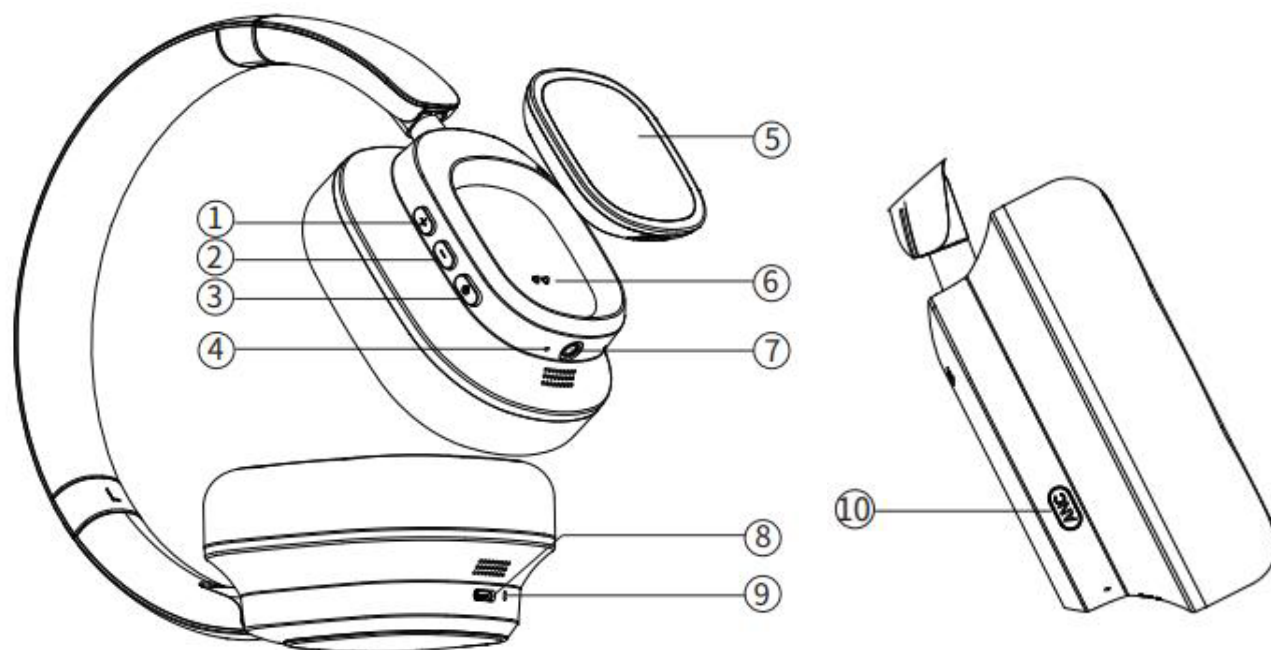

①"+":Volume up,next song

②"":Power on/off,Music play/pause

③"-":Volume down,previous song

④ Calling microphone

⑤LCD touch screen

⑥Communication pin

⑦3.5mm AUX jack port

⑧ Type-C charging port

⑨ Charging indicator

⑩ ANC button

Power on/off Instruction:

Power on:

In power-off mode, press and hold the power button around 2 seconds with blue and red light flashing alternately until you hear voice "Power on", then the headset enter pairing mode with the voice "pairing"

Power off:

In power-on mode, press and hold the power button around 4 seconds, then the indicator will be off.

How to pair:

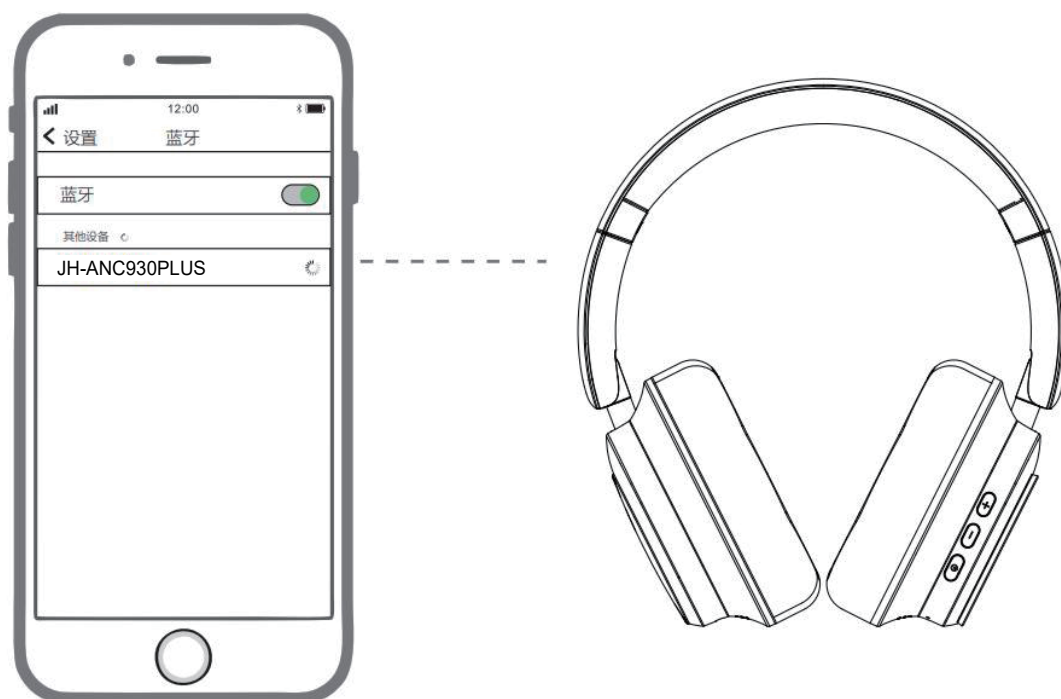

1. After power on, the blue and red light will flash alternately, then it enters pairing mode;
2. Turn on the Bluetooth function of mobile or other device, search the Bluetooth pairing name "JH-ANC930PLUS" and connect, the voice "connected" will be heard after the successful connection, and the blue indicator will flash every 5 seconds.

Music play operation:

Volume up: Short press the "+" button

Volume down: Short press the "-" button

Next song: Press and hold the "+" button

Previous song: Press and hold the "-" button

Music play/pause: Click the power button

Calling operation:

Answer call:Click the power button when call is coming;

End call:Click the power button when call is over;

Reject call:Press and hold the power button around 2 seconds;

Redial:Double click the power button to redial the last called number

Siri function:

Press and hold the power button around 1 second to activate Siri

Clear pairing

In power-on mode,click the power button 4 times until blue and red indicator flashes alternately

ANC mode:

The default mode is normal mode,click the ANC button,it enter ANC mode,click the ANC button again,it enters transparency mode

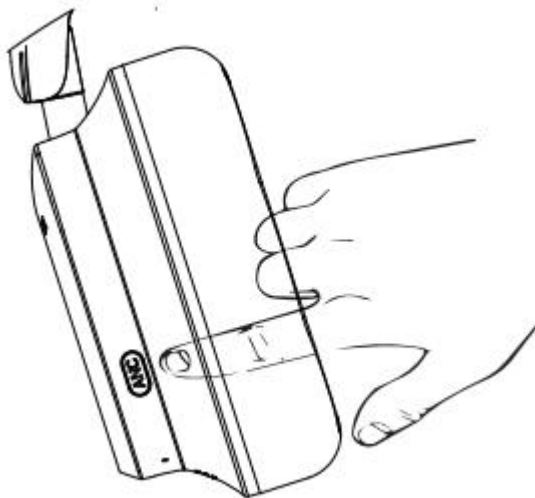

Indicator instruction

Connect successfully	The blue indicator blinks every 5 seconds
Pairing status	The red and blue indicator blink alternately
Reset	The red and blue indicator blink alternately
Listen to music	The blue indicator blinks every 5 seconds
Charge fully	The indicator will be solid blue
ANC on	The indicator will be solid green
Power off	The red indicator will goes off
Charging	The indicator will be solid red

AUX mode:

Connect the AUX cable to headset and mobile (or other device such as Computer, iPad etc), then can play music.

Note: If turn on the headset, once insert the AUX cable to headset, the headset will be turned off automatically, must take out the AUX cable if need to turn on the headset.

The ANC mode is not working if power-off mode

Charging:

In Charging, the red light will be solid on;

Once charging finished, the blue light will be solid on.

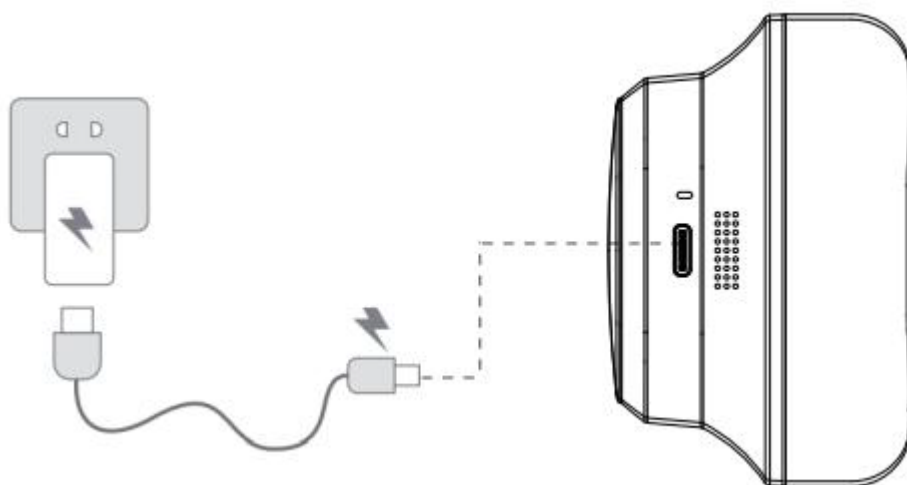

Technical parameter

Bluetooth chipset	JL7018,V5.3
Bluetooth distance	>10m
Frequency range	2402--2480MHz
Input	DC5V,1A
Charging time	Around 2H
Charging port	Type-C
Battery capacity	600 mAh
Speaker driver	Φ40mm,32Ω

FCC Statement

1.This device complies with Part 15 of the FCC Rules. Operation is subject to the following two conditions:

(1)This device may not cause harmful interference.

(2)This device must accept any interference received, including interference that may cause undesired operation.

2. Changes or modifications not expressly approved by the party responsible for compliance could void the user's authority to operate the equipment.

Note:This equipment has been tested and found to comply with the limits for a class B digital device,pursuant to Part 15 of the FCC Rules. These limits are designed to provide reasonable protection against harmful interference in a residential installation.

This equipment generates uses and can radiate radio frequency energy and,if not installed and used in accordance with the instructions,may cause harmful interference to radio communications.However,there is no guarantee that interference will not occur in a particular installation.if this equipmemt does cause harmful interference to radio or television reception,which can be determined by turning the equipment off and on,the user is encouraged to try to correct the interference by one or more of the following measures:

- Reorient or relocate the receiving antenna.
- Increase the separation between the equipment and receiver.
- Connect the equipment into an outlet on a circuit different from that to which the receiver is connected.
- Consult the dealer or an experienced radio/TV technician for help.

The device has been evaluated to meet general RF exposure requirement.

The device can be used in portable exposure condition without restriction.