

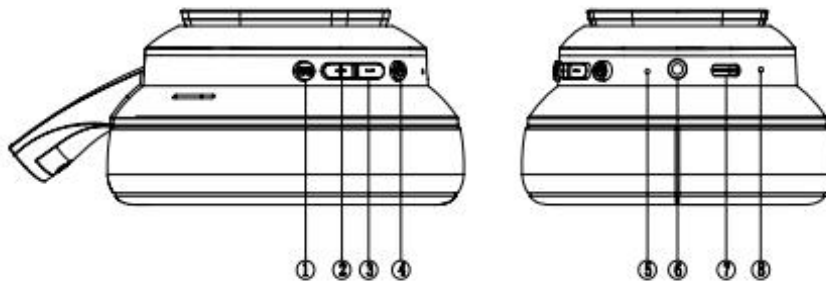

# Headphone



## Function Description



- ① EQ mode switch/Voice Assistant
- ② "+" : Volume up/Next song
- ③ "-" : Volume down/Previous song
- ④ "  " :Power on/off, MFB
- ⑤Bluetooth indicator,
- ⑥3.5mm jack
- ⑦Type-C charging port
- ⑧Microphone

## Operation Instructions

### Power on/off

Press and hold the power button for 2 seconds. The blue indicator light will remain illuminated for 1 second, followed by alternating flashes of the red and blue lights to power on the device. At this point, the headphones will enter pairing mode or automatically reconnect to the last paired Bluetooth device.

To turn off the device, press and hold the power button for 3 seconds. The red light will remain on for 1 second, after which the device will power down.

### Pairing

Press and hold the power button for 2 seconds. The device will enter pairing mode when the blue indicator light remains on for 1 second, followed by alternating flashes of the red and blue lights. Enable the Bluetooth function on your mobile phone (computer, iPad, etc.), and search for the Bluetooth device named "JH-822PLUS+AI". Select the device name to establish a connection. Once the connection is successfully established, the blue indicator light will flash once every 6 seconds.



### **Volume Control / Music Play**

Press the + button to increase volume; press the - button to decrease volume.

Press and hold the + button for 2 seconds to skip to the next song; Press and hold the - button for 2 seconds to return to the previous song.

### **Play/Pause**

Press the power button to toggle between play and pause modes.

### **Calling (Mobile)**

To answer an incoming call, press the power button.

To end an ongoing call, press the power button.

To cancel the dialing process, press the power button.

To reject an incoming call, perform a long press on the power button for 2 seconds.

To redial the last number in the call history, double press the power button.

### **Clear pairing records**

Rapidly click the power button five consecutive times. Once the red and blue indicator lights begin to flash alternately, the headphone's pairing records will be successfully erased.

### **Voice Assistant**

Double-click the EQ button to activate Siri or Google Assistant.

## Lights Description

Connect successfully	The blue indicator light flashes once every six seconds.
Pairing status	The red and blue indicator lights alternate in flashing.
Clear pairing records	The red and blue indicator lights alternate in flashing.
Play music	The blue indicator light flashes once every six seconds.
Charge fully	The blue indicator light remains continuously illuminated.
Power off	The red indicator light flashes for one second and then turns off.
Charging	The red indicator light remains continuously illuminated.

## Line-in Mode

To use the Line-in function, connect the audio cable to the 3.5mm audio input jack on the headphones. This allows you to directly link the headphones to a playback device to listen to music.

Note: If the headphones are powered on when the audio cable is inserted, the device will automatically power off. To resume operation, the audio cable must be disconnected from the audio input jack.

## Charging Instructions

When the battery level is low, use a Type-C charging cable to recharge the headphones. The device will automatically power off during the charging process. A full charge typically takes approximately two hours.

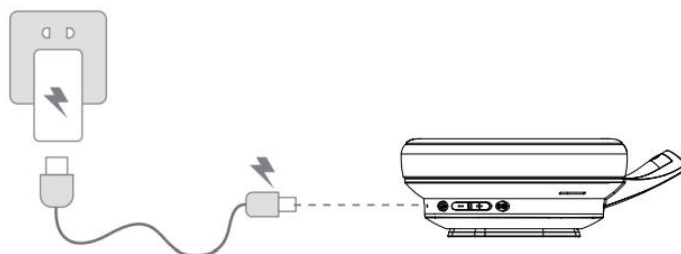

## Technical Parameters

Product model	JH-822 Plus
Bluetooth version	V6.0
Working distance	≥10m
Frequency response	2402-2480MHz
Input voltage	5V/1 A
Charging time	Approximately 2 hours
Charging port	Type-C charging port
Speaker	40mm/32Ω

## Frequently Asked Questions (FAQ)

1. Headphones fail to power on.

Verify that the headphones are sufficiently charged.

2. Bluetooth pairing failure.

Ensure the headphones are powered on and in pairing mode. Maintain a pairing distance within 1 meter. Restart the device and attempt pairing again.

3. Automatic reconnection.

Upon powering on, the headphones will automatically reconnect to the most recently paired mobile device.

4. Audio interruption or stuttering.

Check whether the connection distance is within the effective range and ensure there are no physical obstructions between the headphones and the connected device.

5. Charging options.

The headphones can be charged using a 5V/1A DC power adapter, a car charger, or a portable power bank.

### Warning

\* Unauthorized disassembly or modification of the headphones is strictly prohibited, as it may result in malfunction or permanent damage.

\* Avoid exposing the headphones to extreme temperatures, including excessively hot or cold environments.

\* Do not expose the headphones to moisture or submerge them in any liquid.

\* Refrain from dropping, striking, piercing, or subjecting the headphones to any physical impact that may compromise their performance.

\* This device contains an integrated rechargeable lithium-ion battery. Under no circumstances should the battery be disassembled, compressed, or exposed to fire.

## **FCC Statement**

1.This device complies with Part 15 of the FCC Rules. Operation is subject to the following two conditions:

(1)This device may not cause harmful interference.

(2)This device must accept any interference received, including interference that may cause undesired operation.

2. Changes or modifications not expressly approved by the party responsible for compliance could void the user's authority to operate the equipment.

Note:This equipment has been tested and found to comply with the limits for a class B digital device,pursuant to Part 15 of the FCC Rules. These limits are designed to provide reasonable protection against harmful interference in a residential installation.

This equipment generates uses and can radiate radio frequency energy and,if not installed and used in accordance with the instructions,may cause harmful interference to radio communications.However,there is no guarantee that interference will not occur in a particular installation.if this equipment does cause harmful interference to radio or television reception,which can be determined by turning the equipment off and on,the user is encouraged to try to correct the interference by one or more of the following measures:

- Reorient or relocate the receiving antenna.
- Increase the separation between the equipment and receiver.
- Connect the equipment into an outlet on a circuit different from that to which the receiver is connected.
- Consult the dealer or an experienced radio/TV technician for help.

The device has been evaluated to meet general RF exposure requirement.

The device can be used in portable exposure condition without restriction.