

**⚠ WARNING: CHOKING HAZARD
SMALL PARTS. NOT FOR CHILDREN
UNDER 3 YEARS.**

This device complies with part 15 of the FCC Rules. Operation is subject to the following two conditions:
(1) This device may not cause harmful interference, and
(2) this device must accept any interference received, including interference that may cause undesired operation.

Ningbo Troika Science & Technology Company Limited
No.11 Gaoya Road, Jiangshan Town, Yinzhou District, Ningbo City, China

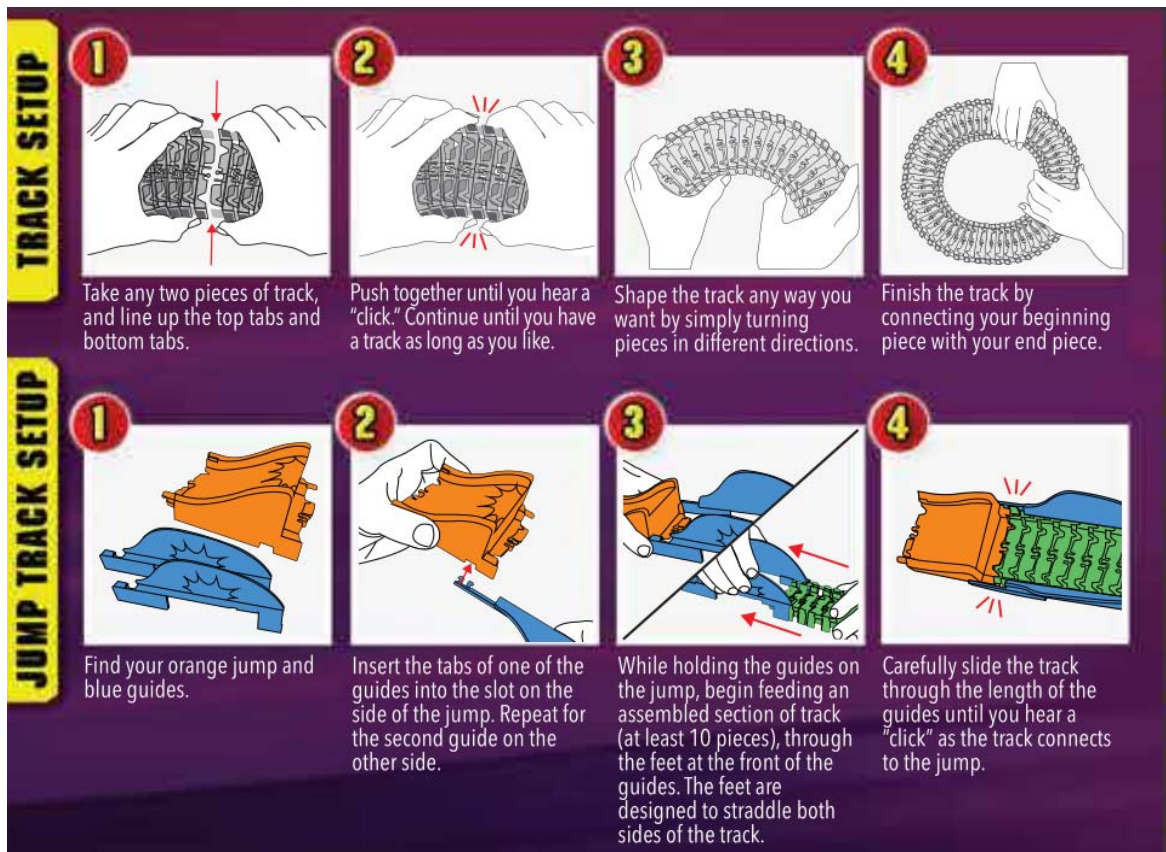

FCC Warning Statement

Changes or modifications not expressly approved by the party responsible for compliance could void the user's authority to operate the equipment.

This equipment has been tested and found to comply with the limits for a Class B digital device, pursuant to Part 15 of the FCC Rules. These limits are designed to provide reasonable protection against harmful interference in a residential installation. This equipment generates uses and can radiate radio frequency energy and, if not installed and used in accordance with the instructions, may cause harmful interference to radio communications. However, there is no guarantee that interference will not occur in a particular installation. If this equipment does cause harmful interference to radio or television reception, which can be determined by turning the equipment off and on, the user is encouraged to try to correct the interference by one or more of the following measures:

- - Reorient or relocate the receiving antenna.
- - Increase the separation between the equipment and receiver.
- - Connect the equipment into an outlet on a circuit different from that to which the receiver is connected.
- - Consult the dealer or an experienced radio/TV technician for help.

This device complies with Part 15 of the FCC Rules. Operation is subject to the following two conditions: (1) this device may not cause harmful interference, and (2) this device must accept any interference received, including interference that may cause undesired operation



Adult Note: Product is not intended for use in crib. Do not leave infant unattended with product. Please retain packaging for future reference and contact information. Cut plastic attachments with scissors and discard pieces. Discard all broken toys. Remove old batteries and replace with new batteries. Be sure to insert batteries correctly with adult supervision and always follow the toy and battery manufacturer's instructions. Do not mix old and new batteries. Do not mix alkaline, standard (carbon-zinc), or rechargeable (nickel-cadmium) batteries. Rechargeable batteries must be removed from toy before being recharged. Non-rechargeable batteries are not to be recharged. Rechargeable batteries are to be charged only under adult supervision. Use 1.5V AA Batteries or equivalent only. Do not short-circuit battery terminals. Always remove weak or dead batteries from product. Remove batteries if product will be stored for an extended period of time. Batteries should be changed by an Adult. Unscrew battery cover with phillips head screwdriver (not included) and lift away from back of product. Remove the dead batteries. Be sure to insert the new batteries correctly according to (+) and (-) symbols located on the battery compartment. Replace battery cover and tighten screw securely before further use.

WARNING: Battery acid and leakage can cause personal injury and cause damage to your MT Micro Car and Remote product and surrounding property. If battery leakage occurs, thoroughly wash any affected skin, making sure to keep battery acid away from eyes, ears, nose and mouth. Immediately wash any clothing or other surface that comes into contact with leaked battery acid. Leaking batteries may make "popping" sounds.



Toggle Switches on the Micro Car ON/OFF to "ON"
 Side toggle switch of remote control to "RACE"
 Remote trigger——Control forward and backward and speed
 Button on the back of the remote——Instantaneous acceleration

