

PRIME RS01 Quick Manual

Android™ 13



Google, Android, Google Play and other marks are trademarks of Google LLC.

FCC Part 15 Information and Notices

This device complies with part 15 of the FCC Rules.

Operation is subject to conditions: (1) This device may not cause harmful interference, and (2) this device must accept any interference received, including interference that may cause undesired operation.

Please take attention that changes or modification not expressly approved by the party responsible for compliance could void the user's authority to operate the equipment.

GEN2WAVE

#7 floor, Point town B/D, 187-4, Gumi-dong, Bundang-gu,

Seongnam-si, Gyeonggi-do, 463-870, Rep. of Korea

Tel. +82-31-607-7537 Fax. +82-31-608-7537

Homepage : www.gen2wave.com Email : tcs@gen2wave.com

Specification

| Part | Item | Details | Part | Item | Details | |
|-----------------------------|------------------|---|--------------------|---|---|-----------------------------|
| Physical Characteristics | Dimensions | 6.61(L) x 3.03(W) x 0.69(H) in. 168(L) x 77(W) x 17.4(H) mm | User Environment | Thermal Shock | MIL STD 810H (-40°F to 158°F/-40°C to 70°C rapid transition) | |
| | Weight | 10.57oz / 300g | | Electrostatic Discharge (ESD) | +/- 15kv air discharge, +/- 8kv direct discharge, +/- 8kv indirect discharge | |
| | Display | 5.5in. FHD+, 1080x2160, 650nits | IST | Sensor | Light, Magnetometer, Motion, Pressure, Proximity | |
| | Touch Panel | Dual mode capacitive touch with stylus Corning Gorilla Glass 5 | Data Capture | Barcode Scanning | Zebra SE4770 | |
| | Battery | All in one type battery, 4,900mAh Li-polymer | | Camera | Front Camera : 8MP Rear Camera : 50MP Auto Focus with LED Flash | |
| | Expansion Slot | MicroSD up to 512GB SDXC | Wireless WAN | Radio Frequency Bands | US : 5G-NR: N2 / N5 / N12 / N25 / N30 / N38 / N41 / N48 / N66 / N71 / N77 / N78 LTE-FDD: B2 / B4 / B5 / B7 / B12 / B13 / B14 / B17 / B25 / B29 / B30 / B46 / B66 / B71 LTE-TDD: B38 / B41 / B42 / B43 / B48 WCDMA: B2 / B4 / B5 GSM: B2 / B3 / B5 / B8 | |
| | Notification | Full color LED, Vibrate and audible tone | | | | GPS |
| | SIM Slot | 2ea of Nano sim slots | | Wireless LAN | | Radio |
| | Voice and Audio | Dual speakers for loud and clear sound USB-C audio headset support 3.5 mm audio jack, 3 MIC | Operating Channels | | Channel 1-13 (2401-2483 MHz):1,2,3,4,5,6,7,8,9,10,11,12,13; Channel 36-165 (5150-5850 MHz): 36,40, 44,48,52,56,60,64,100,104,108,112,116,120,124, 128, 132,136,140,144,149,153,157,161,165; Channel 1-233 (5925-7125 MHz); Channel Bandwidth: 20/40/80/160 MHz | |
| | Buttons | Left : Volume up, Volume down, PTT Right : Power, F1, F2 / TOP : SOS | Interface Ports | Security and Encryption | WEP (40 or 104 bit); WPA/WPA2 Personal (TKIP, and AES); WPA3 Personal (SAE); WPA/WPA2 Enterprise (TKIP and AES); WPA3 Enterprise (AES) — EAP-TTLS (PAP, MSCHAP, MSCHAPv2); EAP-TLS, PEAPv0-MSCHAPv2, PEAPv1-EAP-GTC, LEAP, EAP-PWD) | |
| Performance Characteristics | CPU | Qualcomm® QCM6490 Octa-Core 2.7GHz | | Wireless PAN | Bluetooth | 5.2 |
| User Environment | Memory | 8GB RAM / 128GB UFS Flash | Operating System | | Operating Temperature | -4°F to 122°F/-20°C to 50°C |
| | Operating System | Android 13 with GMS Certified | | Storage Temperature | | |
| | Humidity | 5 to 95% non-condensing | Drop | MIL STD 810H (Multiple 5ft, 1.5m drops) | Tumble | 500 1.6ft, 0.5m tumbles |
| User Environment | Sealing | IP68 | Vibration | MIL STD 810H (Vibration) | | |

Package

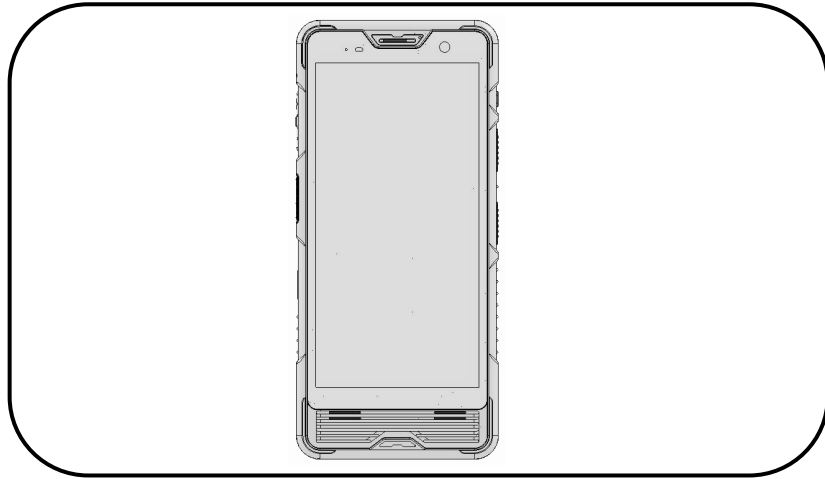

PRIME RS01

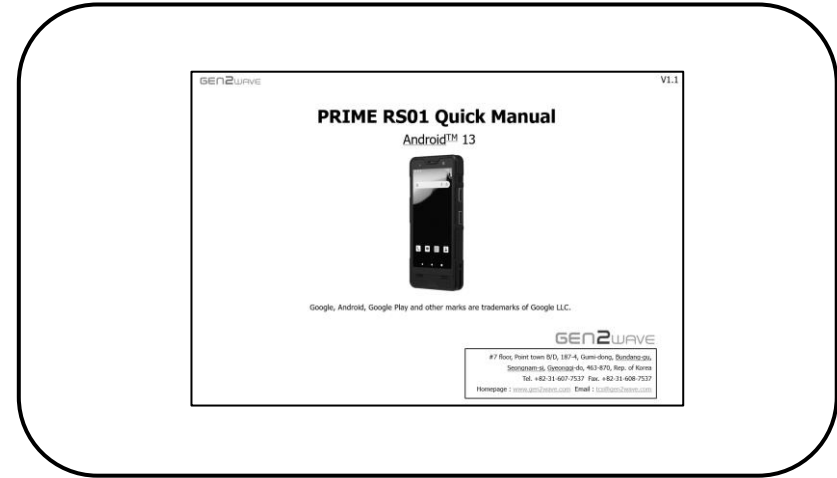

Quick Manual

NOTE. Items in the box may be changed according to the purchase order.

Device Features

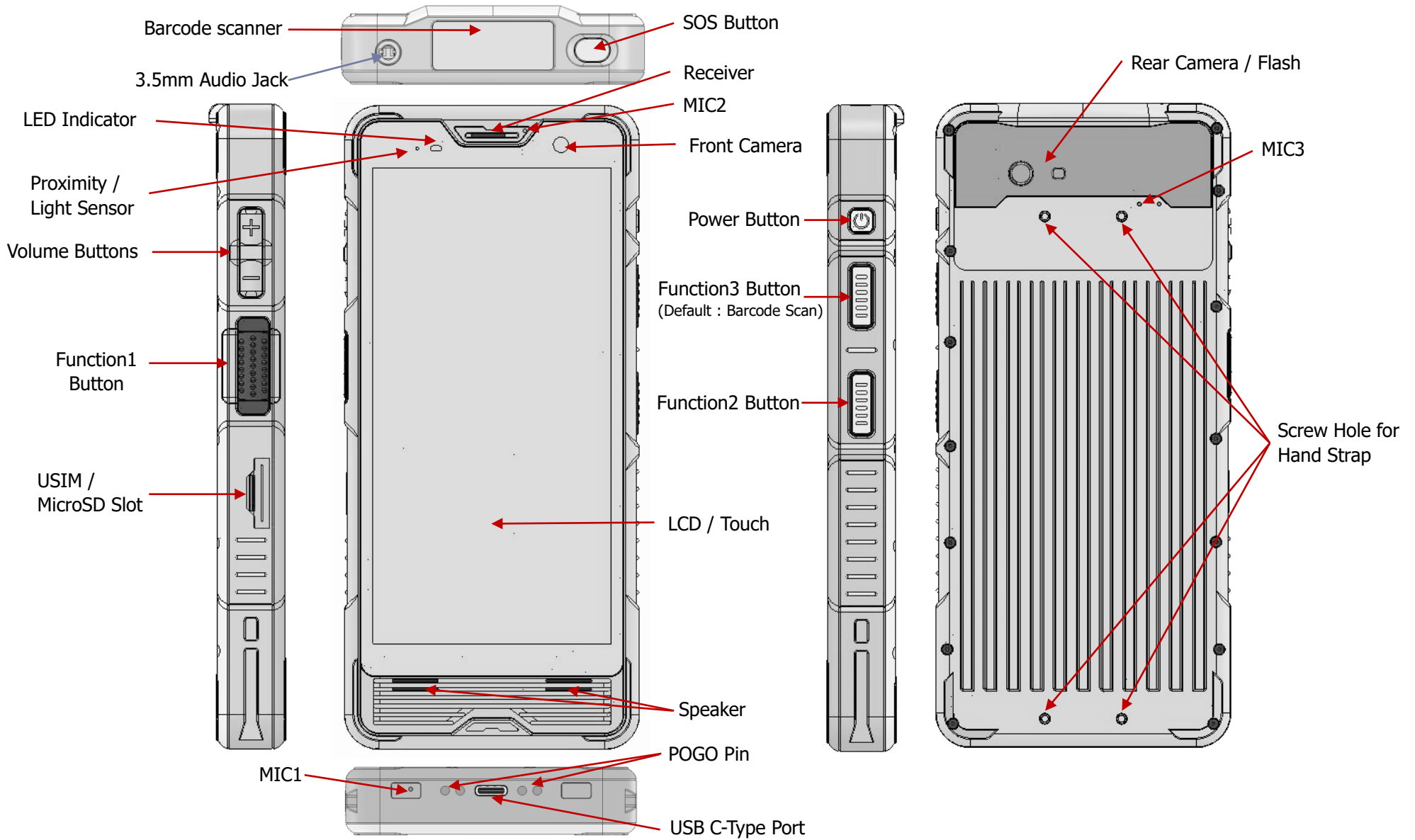

Card Installation

- ▶ How to Insert SIM cards and a MicroSD card
 - ① Pull out the cover of the USIM(nano) and MicroSD slots.
 - ② Insert USIM card and Micro SD card into the slot.
 - ③ Slide the slot into the device.
- ▶ USIM and MicroSD card can be removed in the reverse order.

④

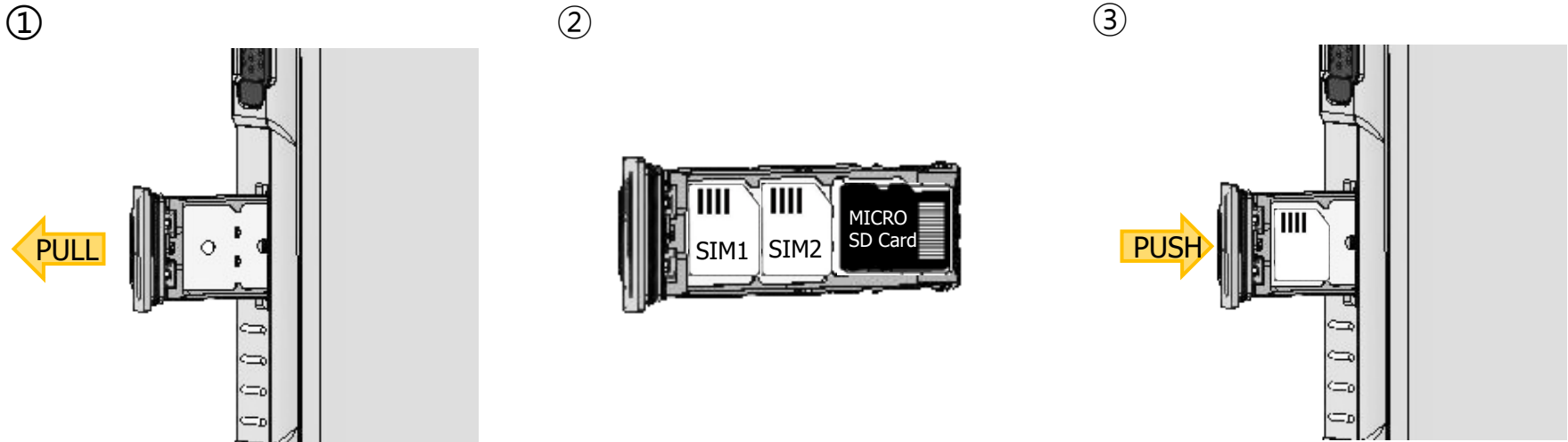

Caution. If the device is powered on and the SIM card is inserted, the device must be rebooted.

Charging the Device

▶ Charging

- ① The device battery can be charged by plugging in power cable to USB-C port.
- ② When charging, the charging status LED of the device lights up, red when charging, and green when charging is complete.
- ③ Battery LED indicates as follows :
 - ▶ OFF : Not Charging Red LED : Charging Green LED : Fully Charged

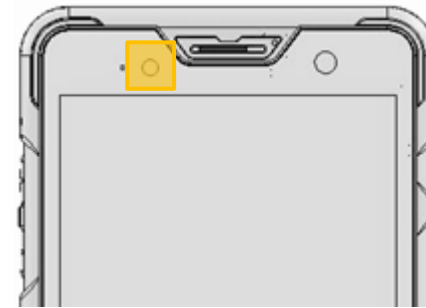
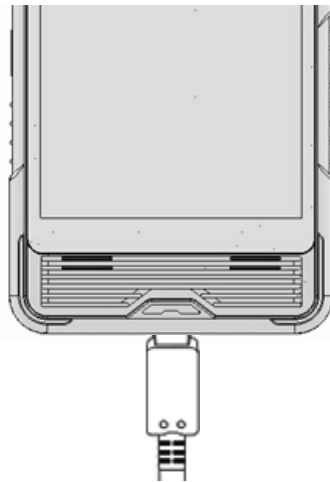

Note. Devices supports high-speed charging.
Adapter voltage must be 5~9V and current is 2A or higher recommended.

Caution. Charging speed is slow when using a PC's USB port or adapter with less than 2A current.

How to use functions

Barcode Scanner

The laser aimer should be on the center of the barcode to get a successful read.



Success



Fail

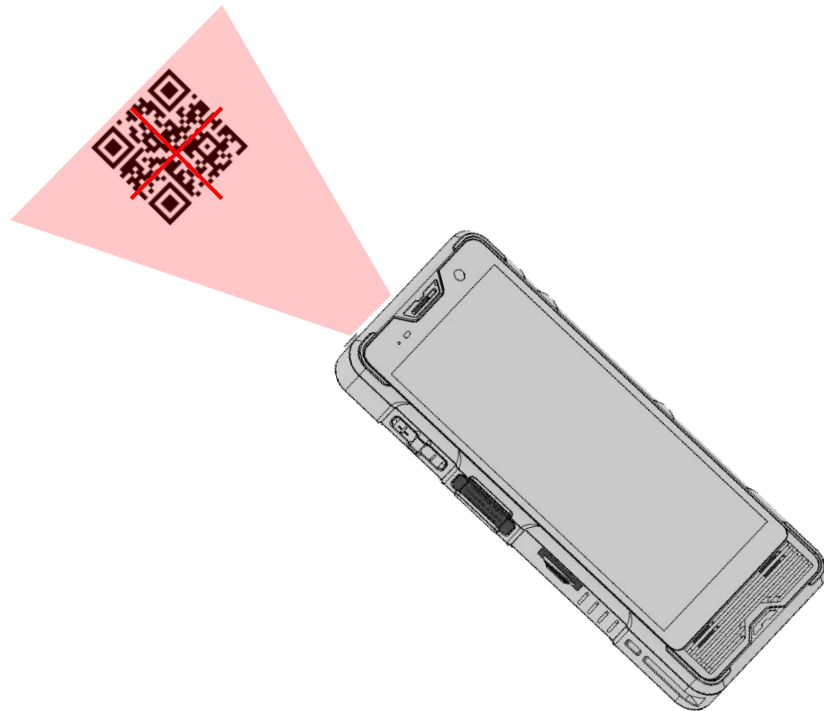

NFC Reader

Since NFC antenna is integrated in the rear side of the device, read the contactless card as shown.

NFC reading distance depends on the NFC card type.

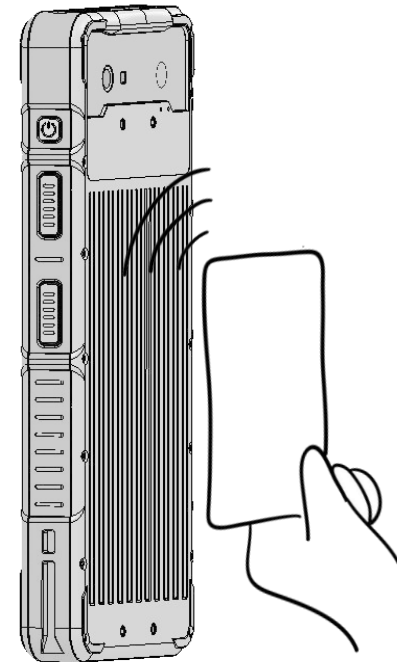

How to use power

▶ Power On

- Press the power button for 1 second to turn on the device.
- The power LED briefly turns green on the screen, then turns off, and the GEN2WAVE logo appears.

▶ Power Off

- Press the power button until the system menu appears and touch Power off icon.

▶ Soft Reset

- Press the power button until the system menu appears and touch Restart icon.

▶ Hard Reset

- Press and hold the power button for approximately 10 seconds to reboot the device..

▶ Factory Reset

- Follow the below steps to Factory Reset.
- Path : Settings → System → Reset options → Erase all data (factory reset) → Erase all data

Caution. Factory Reset : Erase all data and restore default settings.

SAR. This device has been tested and meets the FCC RF exposure limit. FCC SAR has been tested with 0mm distance for head SAR, 15mm for Body SAR, 10mm for Hotspot SAR and 0mm for Extremity SAR.