

Requirements

- Internet service
- Internet router with available Ethernet port
- Active Precept account

Overview

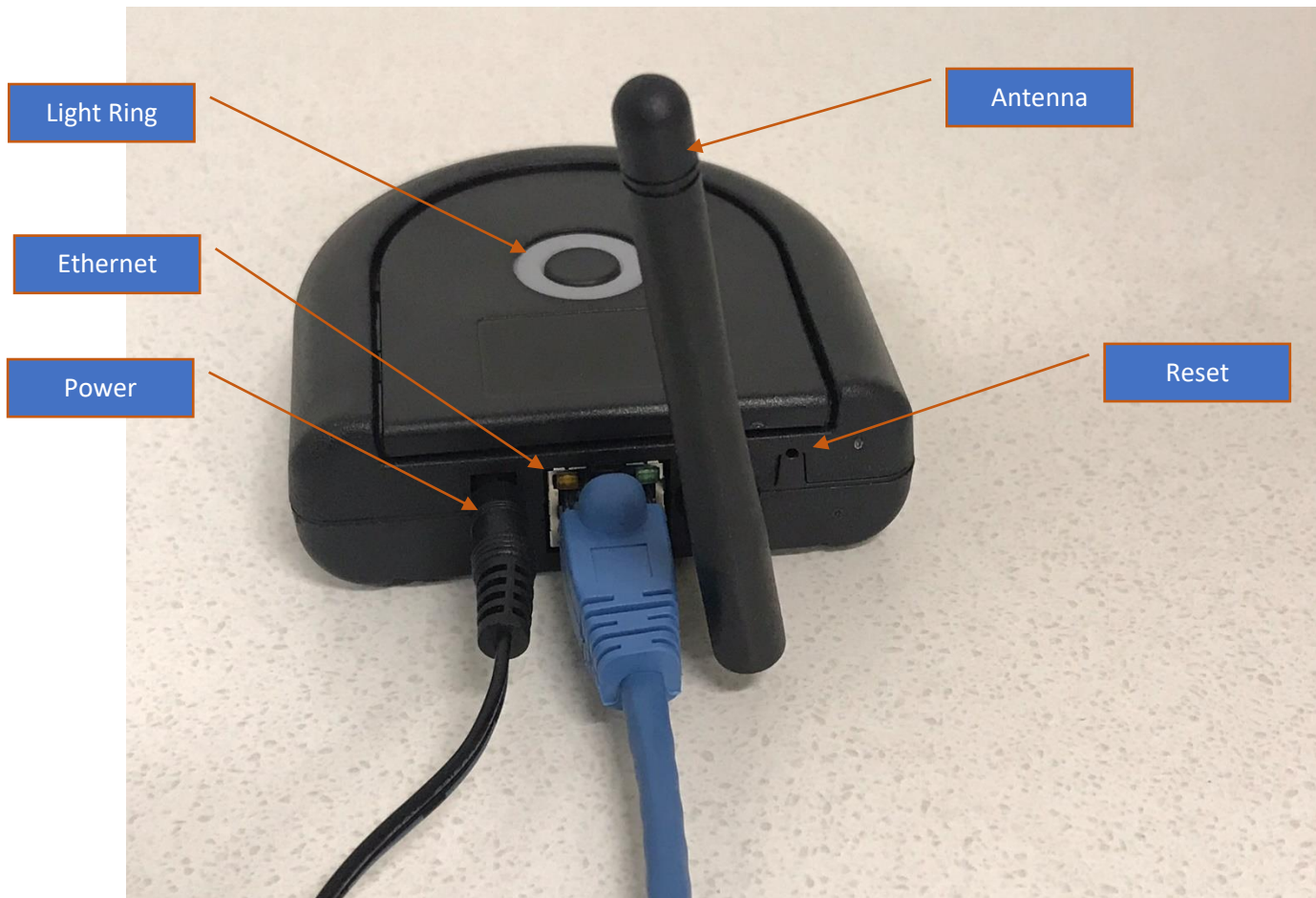

Step 1 – Connect the Antenna

Connect the antenna to the back of the antenna, pivot the antenna so it points straight up.



Step 2 – Connect the Ethernet

Plug one end of the Ethernet cable into your internet router and plug the other end into your gateway.

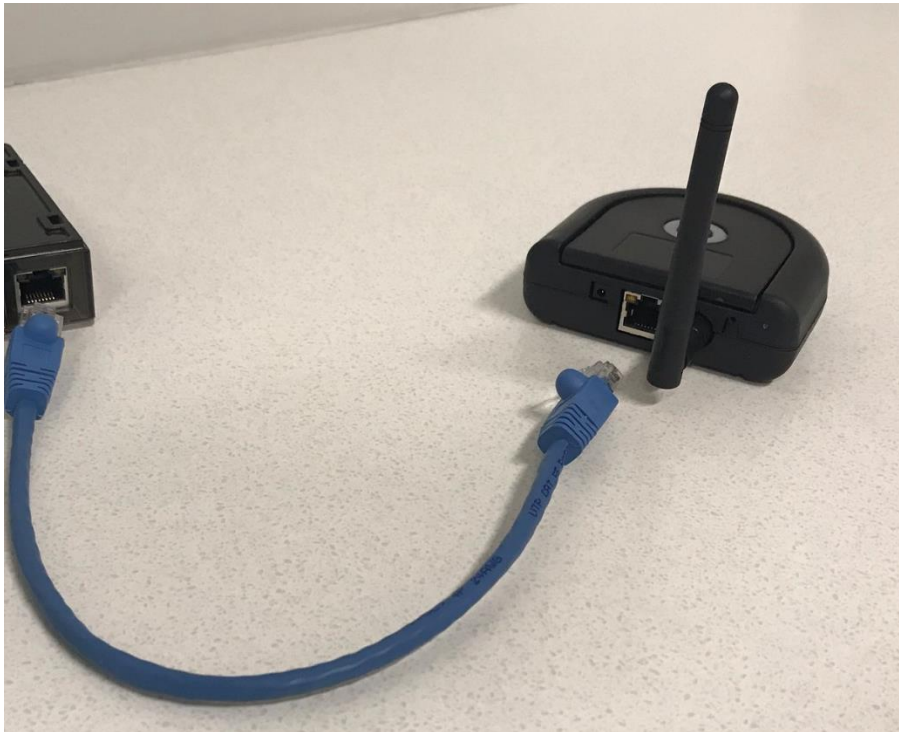

Step 3 – Connect the Power Adapter

Insert the round plug of the power adapter into your gateway. Plug the power adapter into a power outlet.

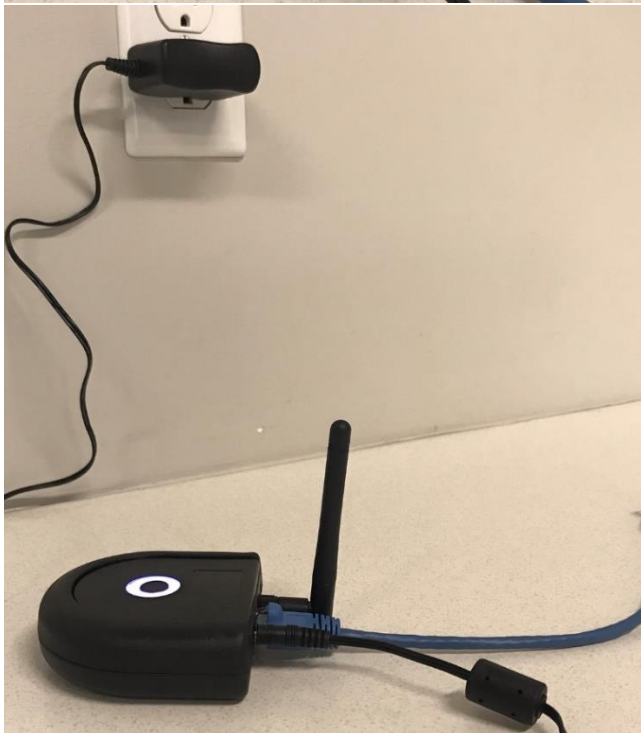

Step 4 – Verify the Light Ring

Ensure the lights are functioning properly, see the color chart below.

Color	Description
White (Pulsing)	Turning on
White	Ready to pair
Blue	Standard Operation
Amber (Blinking)	Factory reset
Red	No connection to Precept Account services
Magenta	Searching for Precept hardware
Amber (Pulsing)	Downloading firmware
Amber (Rapid Blinking)	Updating firmware

Step 5 – Pair the Gateway with your Precept App

Follow the instructions in your Precept App to pair a new device.

Factory Reset

Insert a small pin or paper clip into the small hole next the antenna to restore all settings to factory default.



Regulatory Compliance

This equipment has been tested and found to comply with the limits for a Class B digital device, pursuant to Part 15 of the FCC Rules. These limits are designed to provide reasonable protection against harmful interference in a residential installation. This equipment generates uses and can radiate radio frequency energy and, if not installed and used in accordance with the instructions, may cause harmful interference to radio communications. However, there is no guarantee that interference will not occur in a particular installation. If this equipment does cause harmful interference to radio or television reception, which can be determined by turning the equipment off and on, the user is encouraged to try to correct the interference by one of the following measures:

Reorient or relocate the receiving antenna.

Increase the separation between the equipment and receiver.

Connect the equipment into an outlet on a circuit different from that to which the receiver is connected.

Consult the dealer or an experienced radio/TV technician for help

Changes or modifications not expressly approved by the party responsible for compliance could void the user's authority to operate the equipment.

To comply with FCC part 15 and Industry Canada's RSS-102 radio frequency exposure limits for general population/uncontrolled exposure, the antenna used for this transmitter must be installed to provide a separation distance of at least 20 cm from all persons and must not be located or operating in conjunction with any other antenna or transmitter.

Pour se conformer à la partie 15 de la FCC et aux limites d'exposition aux radiofréquences RSS-102 d'Industrie Canada pour la population générale/exposition non contrôlée, l'antenne utilisée pour cet émetteur doit être installée à au moins 20 cm de distance ou fonctionnant conjointement avec toute autre antenne ou émetteur.

This device complies with part 15 of the FCC Rules. Operation is subject to the following two conditions: (1) This device may not cause harmful interference, and (2) this device must accept any interference received, including interference that may cause undesired operation.

This device complies with Industry Canada's licence-exempt RSSs. Operation is subject to the following two conditions:

(1) This device may not cause interference; and

(2) This device must accept any interference, including interference that may cause undesired operation of the device."

"Le présent appareil est conforme aux CNR d'Industrie Canada applicables aux appareils radio exempts de licence. L'exploitation est autorisée aux deux conditions suivantes :

1) l'appareil ne doit pas produire de brouillage;

2) l'appareil doit accepter tout brouillage radioélectrique subi, même si le brouillage est susceptible d'en compromettre le fonctionnement.

CAN ICES-3 (B)/NMB-3(B)