

Baby Monitor

INSTRUCTIONS





Contents

03	Safety Instructions
03	Camera Introduction
16	Display Introduction



Baby Monitor Manual

Thank you for purchasing our products. This manual provides information on the baby monitor and instructions for its use.

About the Manual

Every effort has been made to ensure that the contents of this manual are accurate and up-to-date. However, the accuracy of all contents cannot be guaranteed. If any described functions differ from the current version of the baby monitor, please refer to the actual product. Our company reserves the right to change content or technical specifications without prior notice. If the included items in the attachments do not match those in the product package, please refer to the product package.

01 Safety Instructions

1. This product is not a substitute for adult supervision.
2. This product must be placed out of reach of the infant and at least 1.5-2 meters away from the infant to ensure that the infant has a safe distance from this product.
3. Do not place the USB power cord where the baby can reach it to avoid potential strangulation or safety risks.
4. This product is not a toy and should not be used by babies.
5. Please use the provided adapter with a power output of 5V/1A.

02 Camera Introduction

Appearance Brief

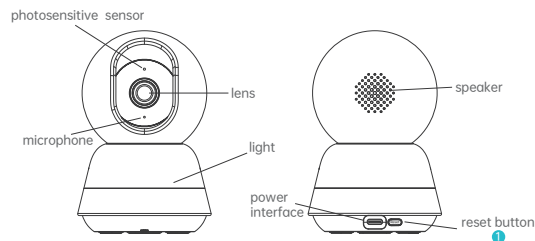

03

① Reset button

reset button for device reset, display pairing and WiFi configuration

Short press once: Display pairing

Long press (1-9s): WiFi network configuration

Long press for 10s: Device reset

Product Appearance



Specifications

Product name: Smart Life Camera
Pixel: 2 million pixels
Video compression: H.264/H.265 high profile
Image enhancement: Digital wide dynamic, 3D noise reduction
Direct current: 5V/1A
Wireless encryption: WEP/WPA/WPA2
Power consumption: <4W
Local storage: Micro SD card
Wireless connections: 2.4G 802.11 b/g/n
Supported platform: Android/iOS
HaLow WiFi frequency (supported for cameras with displays): 900MHz 802.11ah(North America)/868MHz 802.11ah(Europe)

*Note: European WiFi frequency is 868MHz, while North American WiFi frequency is 900MHz.

Parts description

- ◆ Press and hold the reset button for 10 seconds. When you hear a prompt, indicating that the reset is successful.
- ◆ Recommended storage: A high-speed MicroSD card (8-256GB). Without the card, functions such as storing, viewing historical videos, and firmware upgrades will not be supported.
- ◆ Packing list: Smart Life camera × 1, manual × 1, adapter × 2, charging cable × 2 and silicone head cover × 1

APP Installation

- ◆ Download the APP: Scan the QR code for the Smart Life APP below and complete the installation.
- ◆ Register and log in: Open the Smart Life APP and follow the guide to register and log in.



Add device:Scan QR code

- ◆ Please ensure that there is available Wi-Fi and an Internet connection.
- ◆ Plug in the power cord and turn on the device.
- ◆ Open the Smart Life APP, click "Add Device" on the home page (image 01). Select "Camera&Lock", click "Indoor PTZ camera (Wi-Fi)" (image 02) to add camera, then click "Next " (image 03);

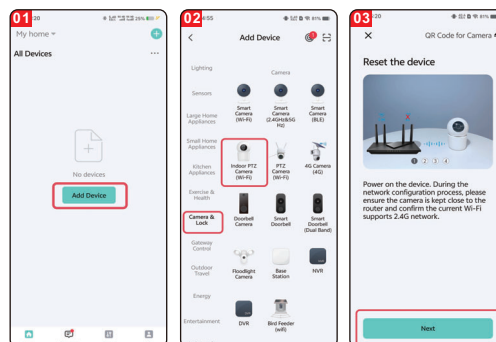

Attention: Only 2.4G Wi-Fi network supported;

- ◆ If the phone is not connected to Wi-Fi, click "Set Now" (image 04) to access the Wi-Fi permission settings and enable "Wireless Data". (image 05)
- ◆ If the phone is connected to Wi-Fi (image 06), click "Next".

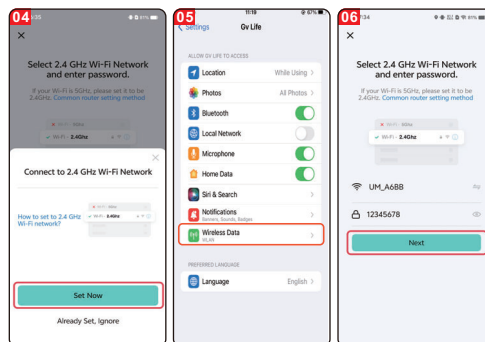

- ◆ A QR code will appear on the screen, please point the QR code at the camera lens (the camera is about 20-30cm away from phone). Once the prompt sounds, click "I Heard a Prompt" (image 07).
- ◆ The device is connecting to the phone (image 08). Press and hold the reset button of camera for 1-9 seconds, and when users hear a prompt, the connection to the phone will start.

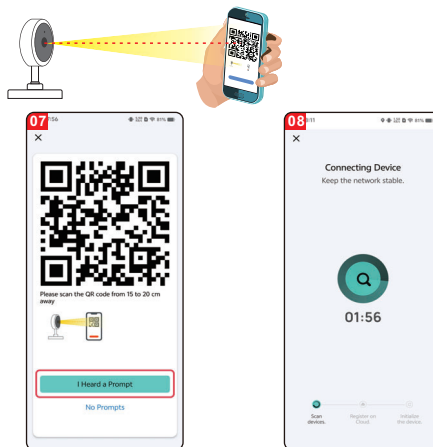

- ◆ Complete the connection (image 09), and "Done";
- ◆ The interface will then switch to the device preview interface (image 10).
- ◆ After closing the device preview interface, the interface returns to the APP's homepage. At this time, the connected device will appear on the APP's homepage (image 11). You can click the connected device icon to view the monitoring footage.

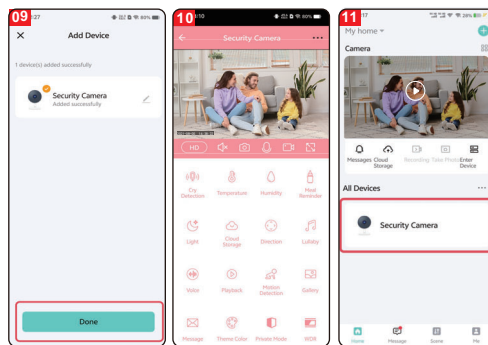

Add device: Bluetooth pairing (alternative method)

- ◆ Turn on "Bluetooth" (image 12).
- ◆ Click the icon in the upper right corner (image 13).
- ◆ Select "Add" (image 14).

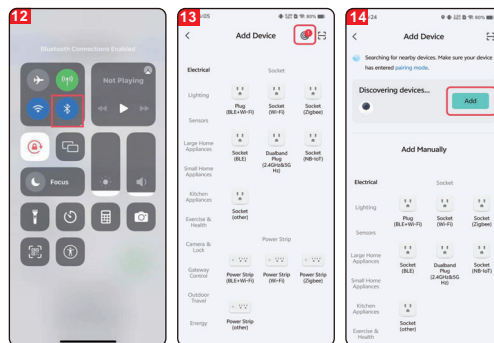



◆ Connect to WiFi and click "Next"(image15).

◆ The page redirects to the "Add Device" page (image 16)

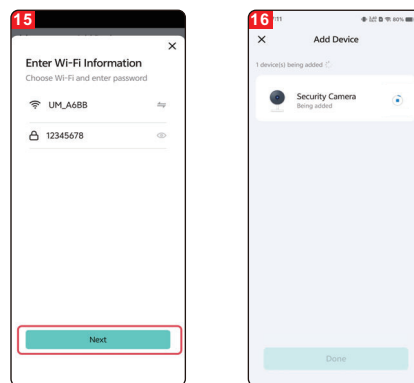



- ◆ Once the addition is successful, click "Done" (image 17)
- ◆ The page will then redirect to the monitoring video interface (image 18)

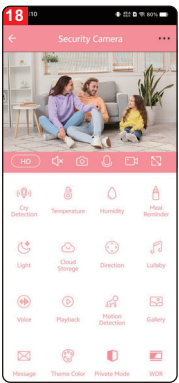
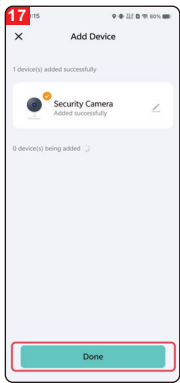

Function Introduction



Cry Detection: Camera will send a notification to the mobile phone when it detects a baby crying.



Temperature: In the temperature settings, users can toggle the temperature unit between Celsius and Fahrenheit. Users can also set low and high temperature alarms. After the temperature alarm is activated, if the ambient temperature is lower or higher than the set threshold, the camera will send a notification to the app.



Humidity: In the humidity settings, users can set alarms for high and low humidity. When the humidity alarm is activated, and the ambient humidity is lower or higher than the set humidity threshold, the camera will send a notification to the app.



Feeding Reminder: Users can set feeding times, and when it's time to feed the baby, the app will send a notification to remind users of feeding their babies.



Light: Users can manually turn the camera's light on and off, or users can also set a schedule for the light to automatically turn on and off.



Cloud Storage: Once cloud storage is activated, users can access video playback even without a TF card in the device.



Direction Control: Users can control the direction of the PTZ(Pan-Tilt-Zoom), and zoom in or out during video preview.



Lullaby: The device includes seven lullabies. The lullaby settings allow user to adjust the volume, select the playback order, and switch or pause the lullabies.



Soothing Sound: Click the soothing sound button to record(up to 10 seconds). After 10s, the device will automatically stop recording. During the recording, users can also manually click the button to stop recording. When crying is detected, the device will automatically play the soothing sound.



Playback: Users can view historical videos.(TF card required)



Motion Detection: When the device detects movement, it will send a notification to the app.



Photo Album: Users can view screenshots and videos captured by the camera.



Messages: In the message interface, users can see the notifications sent by the camera.



Theme Color Settings: Users can switch the app's theme color.



Privacy Mode: When this function is enabled, the camera stops all operations. After turning off this function, the camera resumes normal operation.



WDR(Wide Dynamic Range): Adjust the picture to make it brighter or darker.



Night Vision Mode: Choose between three night vision modes: smart mode, infrared night vision mode, and color night vision mode.



Motion Tracking: When this function is enabled, the camera will follow detected moving objects.



Sound Detection: After turning on this function, when the device detects sound, it will send a notification to users through the APP.



Motion Detection: After turning on this function, when the device detects movement, it will send a notification to users through the APP.



Siren: Users can manually turn on the alarm function on the device.

03 Display Introduction

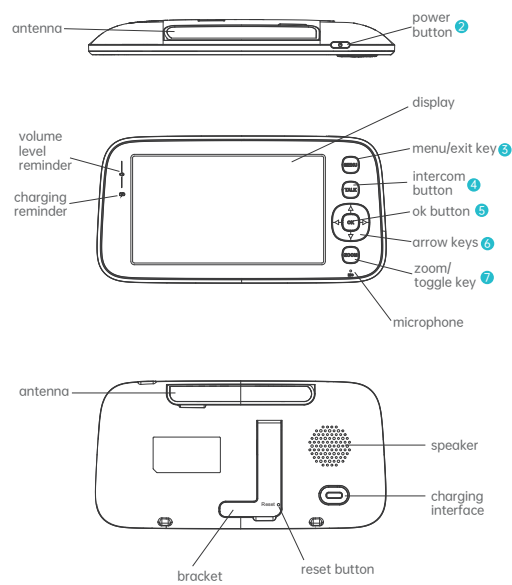



② Power button

Off state: Long press the power button to turn on the display.
Standby state: Long press the power button to turn off the display,
short press to turn the display off/on.

③ Menu key

Preview interface-short press: The system setting menu pops up.
Other interfaces - short press: Return to the previous menu.

④ Intercom button

One-way intercom mode: Long press this button to activate the
call function, release it to turn it off.
Two-way intercom mode: Short press this button to activate the
call function, short press again to turn it off.

⑤ Ok key

Menu interface: Enter a submenu or confirm settings.
Preview interface: Adjust volume and brightness.

⑥ Arrow keys(up, down, left and right)

Preview interface: Short press the OK button to adjust the
volume, and use the left and right arrow keys to adjust the
volume. Use the up and down keys to adjust the brightness.
PTZ settings: Adjust the camera direction when previewing
the monitoring videos.
Menu enabling: Adjust menu options.

⑦ Zoom/toggle key

When connected to the camera-short press: Switch magnifica-
tion.When connected to multiple cameras-long press: switch
between different cameras. And switch all cameras each time
so it will enter split-screen preview mode. At this time, press
and hold the key again to return to the first camera view.





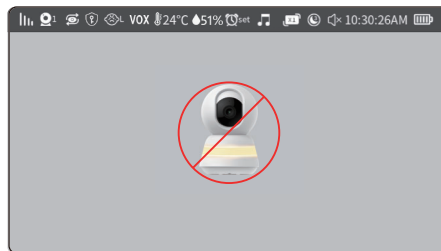

Function Introduction

- 1.This product is powered by a built-in battery or a 5V/1A DC adapter. The built-in battery charges automatically when connected to the DC adapter.
- 2.When the battery is functioning normally, press and hold the on/off button for 2 seconds to turn the display on or off.
- 3.This device supports camera patrol monitoring and split-screen monitoring.
- 4.In single-split screen mode, the status bar displays as shown below.



- Signal strength icon: Shows the current signal strength.
- Camera ID: Displays the ID of the connected camera.
- Camera patrol preview is turned on.
- Privacy mode is turned on.
- Cry detection is turned on.
- VOX** VOX function is turned on.
- 24°C** Temperature icon: Displays the ambient temperature of the camera
- Feeding reminder icon: Users can set a feeding reminder time via the menu.



-  Humidity icon: Displays the ambient humidity of the camera.
-  Music icon: Shows whether the music is on or off.
-  Screen magnification display.
-  Screen saver icon: Displays the set screen-off time.
-  Sound status icon.
-  10:30:26AM Date and time icon.
-  Battery status icon: Shows battery level or charging status.

5.Two-screen mode: It only is enabled when two cameras are paired. Long press the camera zoom/toggle button (P16) in sequence and the screen will display as shown below:



6.Quad-split screen mode: It only is enabled when three or four cameras are paired. At this time, long press the camera toggle button in sequence to enter the quad-split screen mode.

The status bar and screen display are as follows:

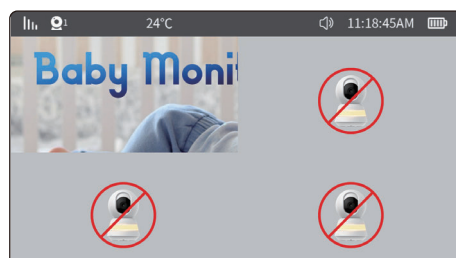

7. The volume and brightness menu is as shown below:

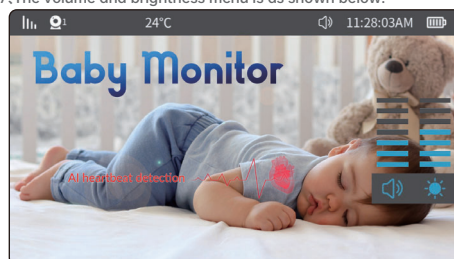

In the preview interface, press the "OK" key to activate the volume and brightness menu:

- ① Increase Volume: Use the right arrow key to increase the volume. Decrease Volume: Use the left arrow key to decrease the volume.
- ② Increase Brightness: Use the up arrow key to increase brightness. Decrease Brightness: Use the down arrow key to decrease brightness.

8. PTZ control menu is as shown below:

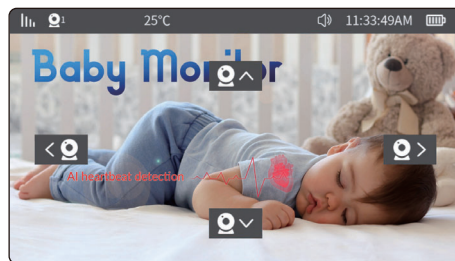









In the preview interface, press any arrow key to activate the PTZ (Pan-Tilt-Zoom) control menu. Long press or short press the arrow key to adjust the camera angle as needed.

Introduction to main menu options

Press the menu key to access the system menu as shown below:





The menu contains the following 8 items:

- | | |
|--|--|
|  Camera settings |  Feeding reminder settings |
|  Sound settings |  Screen brightness settings |
|  VOX alarm settings |  Lullaby playback |
|  Light switch |  Other menu settings |

1.Camera settings:

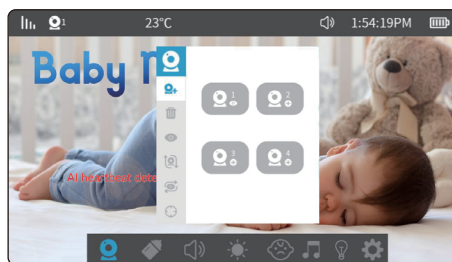
Select camera settings to access the following menu:



 Camera matching. 4 cameras can be paired. Once paired successfully, the pairing can be automatically saved and there is no need to match when you turn on the display again. To re-pair a camera, first delete the existing pairing, then proceed with matching.

Matching method:

① (Navigate to: Menu→Camera settings→Camera matching)then select camera→confirm. At this time, the display automatically searches for the camera. Short press the menu key during pairing to immediately exit pairing mode

② Make sure the camera is powered on. Verify that the camera's indicator light is steadily lit. At this time, press the reset key on the matching camera briefly, and the camera will emit a beep. Finally, users wait for the device to automatically match.

③ Once the pairing is complete, an image from the camera will appear on the display.

Note: A "👁️" or "✅" icon will be displayed in the lower-right corner to indicate a successfully paired camera. If the camera is deleted, it will revert to "⊕".

2..Delete camera settings:

🗑️ Select the "👁️" or "✅" icon in the lower-right corner and press the ok button to delete the camera. After deletion, the icon in the lower right corner changes to "⊕" and you need to reconnect it again if you want to connect.

3.View the specified camera footage:

👁️ To view the specified camera feed, select the camera with the corresponding serial number and press OK button.

4.Camera flip setting:



🔄 Supported camera flip settings

5.Camera screen patrol function



Loop playback settings: It can only be enabled when two or more cameras have been paired. When activated, the screen will display each camera's feed for 15 seconds before switching to the next.

6.Motion tracking settings:



- ☒ Motion tracking switch.
- ☒ Smart frame switch.

7. Feeding reminder function:

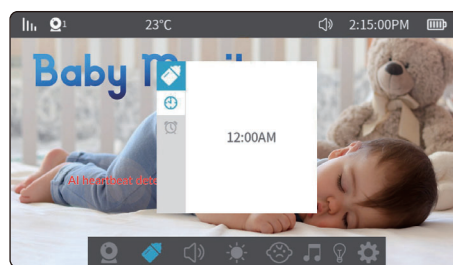

There are 5 options: customize time, 2 hours, 3 hours, 4 hours and off. After setting, if the display remains powered on, an alarm sound and a pop-up window will appear at the scheduled time. (Note: fixed-time alarms will be reset after the display is turned off)

8. Volume settings:

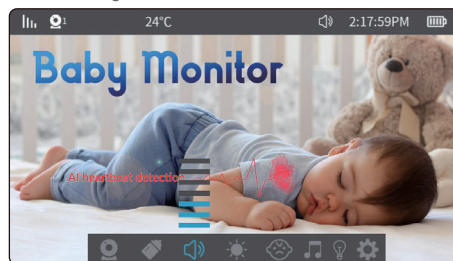

Select the volume setting to access the following menu. At this time, press the arrow keys (up & down) to adjust the volume level.

9. Screen brightness settings:

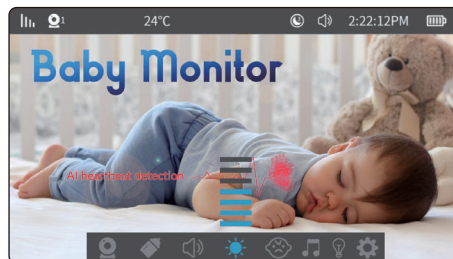

Select the screen brightness settings to access the following menu. At this time, press arrow keys (up & down) to adjust the screen brightness.

10. Crying alarm settings:



The crying alarm offers three levels of sensitivity: high, medium and low. After enabling this function, if the camera detects ambient noise exceeding the set threshold for more than 2 seconds, an icon will appear on the display and an alarm will sound. When an alarm is triggered, there is a 60-second interval between consecutive detections

11. VOX function settings:





The vox function has low and high sensitivity levels. After turning on the vox function, if the surrounding environment is quiet, the screen

13. Other menus:

① Temperature unit settings:



Temperature unit settings: Users can choose Fahrenheit or Celsius as the temperature unit

  Low and high temperature alarm: When the ambient temperature of the camera falls below or exceeds the set thresholds, the camera will sound an alarm with an interval of five minutes.

② Screen saver settings:



Screen saver time setting: Display saver duration can be set to 1 minute, 3 minutes, 5 minutes or off

③ Date and time settings:

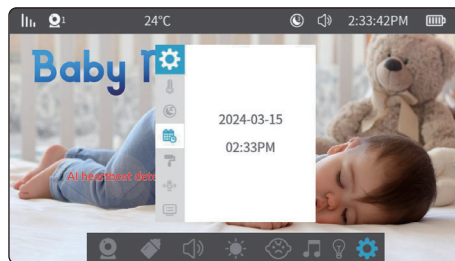

Clock settings: Users can set the current date and time. The date format is year-month-day, and the time is in 12-hour format. Use the left and right arrow keys to select the time unit. Use the up and down arrow keys to adjust the value. After that, press the OK key to save settings.

④ Theme color settings:



Navigate to menu → settings → background settings. Use the "arrow key" to select your option, and press the "OK key" to confirm.

⑤ Intercom mode settings:



One-way intercom mode: Only when the intercom key is pressed can the person on the camera side hear the voice from the screen side. The person on the display side cannot hear the sound from the camera side in intercom mode.

Two-way intercom mode: Press and release the intercom button to turn on the intercom mode. At this time, the person on the camera side and the person on the display side can hear each other's voice. Click the button again to close.

© version information and factory reset:

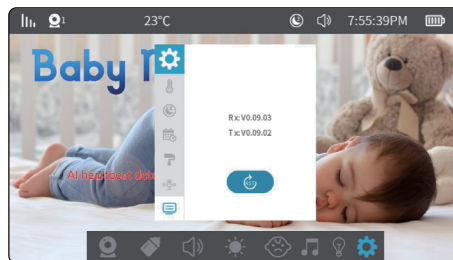

Product Maintenance

1. Lens maintenance and cleaning: Avoid touching the lens with your hands or other dirty objects to ensure image clarity. Gently clean dirt using clean gauze.
2. Product surface cleaning: Use clean, soft gauze to wipe the device and LCD display regularly. Do not open or attempt to repair the device yourself.
3. Keep device dry: Do not open or attempt to repair the device yourself.

Installation Precautions

1. Place the camera out of the baby's reach, in a stable place with relatively wide viewing angle.
2. Use a bracket to fix the camera to a wall or stable object if necessary.
3. Avoid installing the camera in direct backlight

Precautions

- ◆ Avoid placing the device near metal furniture.
- ◆ Keep away from household appliances such as microwave ovens.
- ◆ Minimize cable clutter by separating audio, video, and data cables.
- ◆ Ensure the device is within the Wi-Fi coverage area for optimal performance.
- ◆ When connecting the camera to a new network, reconfigure the camera.

Harmful substances in the product

Part Name	harmful substances					
	Pb	Hg	Cd	Cr(VI)	PBB	PBDE
Housing	○	○	○	○	○	○
Circuit board	x	○	○	○	○	○
Charger	○	○	○	○	○	○
Appendix	○	○	○	○	○	○

This form is compiled in accordance with the provisions of SJ/T 11364.

This product complies with RoHS environmental protection standards. However, current global technology does not allow for the complete replacement or reduction of lead content in electronic ceramics, optical glass, steel, and copper alloys.

FCC SDoC

NOTE: This equipment has been tested and found to comply with the limits for a Class B digital device, pursuant to part 15 of the FCC Rules. These limits are designed to provide reasonable protection against harmful interference in a residential installation. This equipment generates, uses and can radiate radio frequency energy and, if not installed and used in accordance with the instructions, may cause harmful interference to radio communications. However, there is no guarantee that interference will not occur in a particular installation. If this equipment does cause harmful interference to radio or television reception, which can be determined by turning the equipment off and on, the user is encouraged to try to correct the interference by one or more of the following measures:

- Reorient or relocate the receiving antenna.
- Increase the separation between the equipment and receiver.
- Connect the equipment into an outlet on a circuit different from that to which the receiver is connected.
- Consult the dealer or an experienced radio/TV technician for help.

FCC Statement:

This equipment has been tested and found to comply with the limits for a Class B digital device, pursuant to part 15 of the FCC Rules. These limits are designed to provide reasonable protection against harmful interference in a residential installation. This equipment generates, uses and can radiate radio frequency energy and, if not installed and used in accordance with the instructions, may cause harmful interference to radio communications. However, there is no guarantee that interference will not occur in a particular installation. If this equipment does cause harmful interference to radio or television reception, which can be determined by turning the equipment off and on, the user is encouraged to try to correct the interference by one or more of the following measures:

- Reorient or relocate the receiving antenna.
- Increase the separation between the equipment and receiver.
- Connect the equipment into an outlet on a circuit different from that to which the receiver is connected.



-Consult the dealer or an experienced radio/TV technician for help.
Caution: Any changes or modifications to this device not explicitly approved by manufacturer could void your authority to operate this equipment.
This device complies with part 15 of the FCC Rules. Operation is subject to the following two conditions:
(1) This device may not cause harmful interference, and
(2) this device must accept any interference received, including interference that may cause undesired operation.

RF Exposure Information:

This equipment complies with FCC radiation exposure limits set forth for an uncontrolled environment. This equipment should be installed and operated with minimum distance 20cm between the radiator & your body