

# User Guide

Bluetooth®

HD Voice Ready Built-in Microphone

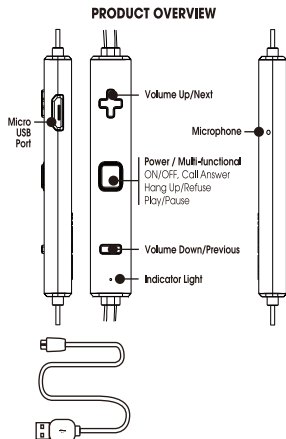

## CHARGING THE EARBUDS

These earbuds have an internal rechargeable battery. The battery must be fully charged prior to use. Charging time is approximately 1 hr. Your earbuds cannot be used while charging.

Red light ON – Charging      Blue light ON – Fully charged

### Via AC Adapter Wall Charger

Using the provided Micro USB cable, connect the Earbuds (Micro USB port) to the AC Adapter (USB port).

### Via Computer

Using the provided Micro USB cable, connect the Earbuds to the computer or laptop (USB port).

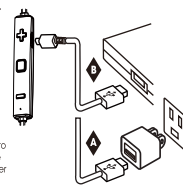

## PAIRING THE EARBUDS TO BLUETOOTH DEVICE

Make sure the Bluetooth function is available on your cell phone. Specific pairing procedures will be different depending on different cell phone. For detailed information, please refer to your cell phone's User Guide.

- If no device connection is made within 5 minutes of the earbuds being switched on, the earbuds will automatically be switched off to save power.
- After a successful pairing devices will memorize each. Therefore, no pairing will be needed next time.

2

## PAIRING TO BLUETOOTH DEVICE (CONTINUED):

1. Turn OFF the earbuds by pressing and holding the multifunction key for about 3 seconds. Turn it back on by pressing and holding the multifunction button.
2. Keep the distance between the cell phone and the earbuds within 3 feet (for pairing only).
3. Turn on cell phone Bluetooth, and search the Bluetooth device. Device name is same as model name
4. Press "yes" or "enter" key to confirm the successful pairing.
5. After the successful connection, the blue light of the earbuds will flash quickly twice every four seconds.

## CONNECTING TO OTHER BLUETOOTH DEVICES

**Note:** Your earbuds can only be connected to **one** Bluetooth device at a time.

1. In order to connect to the other Bluetooth device, you must first close the current Bluetooth connection.
2. Follow the above steps (under **PAIRING TO BLUETOOTH DEVICE**) to pair your earbuds to another Bluetooth device.

## FAQ's

**Q:** Why can't I turn the headset on?

**A:** Make sure your device is fully charged before using it for the first time. Your device can not be turned on if battery level is very low. Refer to Charging the Earbuds section of the manual.

**Q:** There is no sound during playback.

**A:** Check the connection between your device with phone or computer. If the connection is not established, please reconnect again. And adjust the volume level to a suitable level.

3

## EARBUDS CONTROLS

### Making and receiving calls

You can use your earbuds in various ways for handling calls.

Answer call \_\_\_\_\_ Press

End a call \_\_\_\_\_ Press

Reject call \_\_\_\_\_ Press and hold for 2 seconds

Redial last call \_\_\_\_\_ Quickly press 2 times

### Listening to music

Play music \_\_\_\_\_ Press

Pause/resume music \_\_\_\_\_ Press

Go to next song \_\_\_\_\_ Press and hold

Go to previous song \_\_\_\_\_ Press and hold

Power ON/OFF \_\_\_\_\_ Press and hold

### Changing the volume

When needed, adjust the volume by pressing the keys (up) or (down) during a call or when listening to music.

4

## IMPORTANT SAFEGUARDS

- Do not use this unit for anything other than its intended use.
- Keep the unit away from heat source, direct sunlight, humidity, water or any other liquid.
- Do not expose the device to extremely high or low temperatures, as it may damage the battery.
- Do not operate the unit if it has been wet or moist to prevent against electric shock and/or injury to yourself and damage to the unit.
- Do not use the unit if it has been dropped or damaged in any way.
- Repairs to electrical equipment should only be performed by a qualified technician. Improper repairs may place the user at serious risk.
- Keep the unit out of reach of children.
- This unit is not a toy.

### BATTERY DISPOSAL:

This product contains a lithium polymer battery. Lithium Polymer batteries are environmentally safe when fully discharged. Please refer to your local and state laws for battery disposal procedures.

## SPECIFICATIONS

Bluetooth Version \_\_\_\_\_ Bluetooth V4.1 + EDR  
Distance \_\_\_\_\_ Up to 10m  
Battery \_\_\_\_\_ Rechargeable Lithium battery: 50mAh  
Frequency \_\_\_\_\_ 2.4GHz  
Standby Time \_\_\_\_\_ Up to 5.0 hours  
Charging Time \_\_\_\_\_ 1 hour  
Play Time \_\_\_\_\_ 2.5+ hours

5

over

FCC Statement  
This device complies with Part 15 of the FCC Rules. Operation is subject to the following two conditions:

- (1) This device may not cause harmful interference.
- (2) This device must accept any interference received, including interference that may cause undesired operation.

2. Changes or modifications not expressly approved by the party responsible for compliance could void the user's authority to operate the equipment.

Note: This equipment has been tested and found to comply with the limits for a class B digital device pursuant to Part 15 of the FCC Rules. These limits are designed to provide reasonable protection against harmful interference in a residential installation.

This equipment generates uses and can radiate radio frequency energy and if not installed and used in accordance with the instructions, may cause harmful interference to radio communications. However, there is no guarantee that interference will not occur in a particular installation. If this equipment does cause harmful interference to radio or television reception, which can be determined by turning the equipment off and on, the user is encouraged to try to correct the interference by one or more of the following measures:

- Reorient or relocate the receiving antenna.
- Increase the separation between the equipment and receiver.
- Connect the equipment into an outlet on a circuit different from that to which the receiver is connected.
- Consult the dealer or an experienced radio/TV technician for help.

The device has been evaluated to meet general RF exposure requirement. The device can be used in portable exposure condition without restriction.