

# WIRELESS POWER BANK 10000 mAh

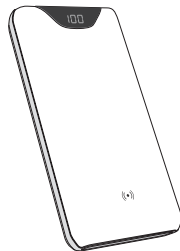

BC

## USER MANUAL

Please read this user manual carefully before use. This product can be used for charging all devices that have a wireless charging module.

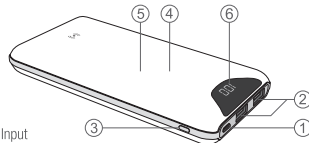

1. Input
2. USB Output
3. Power/battery indication button
4. Wireless Charging surface area
5. Anti-slip surface
6. Power light indicator

Over-charge protection  
Over-discharge protection  
Over-current protection  
Over-temperature protection  
Short circuit protection

### Technical Specifications :

Capacity: 10000 mAh  
Wh rating: 37 Wh  
Input: DC 5V  $\Rightarrow$  2A USB  
Output 1: DC 5V  $\Rightarrow$  2,1A  
Output 2: DC 5V  $\Rightarrow$  2,1A  
Wireless Output: DC 5V  $\Rightarrow$  1A  
Total Output Current: 2,1 Max  
Charging Distance:  $\leq$  5 mm

Dimensions: 143,5 x 73 x 19 mm  
Weight: 240 g  
Number of charging cycles: 200 - 250  
Type of battery: Polymer  
Operating temperature: - 10 / + 60°C  
Storage environment: - 10 / + 40°C  
Charging time: 6 hours with 2.4 A adapter.

### Package content :

Wireless Charger  $\times$  1  
Micro USB cable  $\times$  1  
User Manual  $\times$  1

### Instructions :

One time press to turn on Power Bank and 2 times to turn off. Completely charge the power bank before first time use.

1. Charging & discharging simultaneously: Connect the wireless power bank and a power adaptor with the charging cable. Then, plug the adaptor into an electric socket, put wireless cellphone onto surface for easy charging.

2. Using wireless power bank individually: Place a supported mobile device in the center of the charging surface and press the power/battery button to start wireless charging, like picture showed below.

3. If device is not compatible with wireless charging, you may charge via USB output.

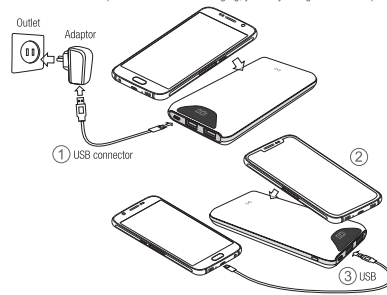

### Charging diagram :

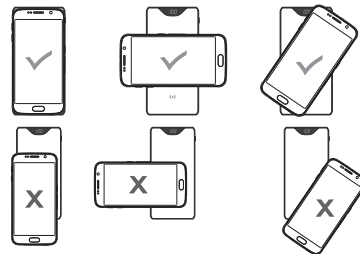

### Safety information - Warning:

Do not drop or bump; do not put it into the fire, expose the power bank to extreme temperatures and/or water. Please use the proper charger or adaptor, if have any deformities or corrosion, please stop use ! Improper use may cause product damage and may harm yourself ! Keep away from children! If it is found that the product inflated or expanded by charging equipment, please stop using immediately.

RoHS CE FCC



**FCC Caution :**

This device complies with part 15 of the FCC Rules. Operation is subject to the following two conditions:

(1) This device may not cause harmful interference, and (2) this device must accept any interference received, including interference that may cause undesired operation.

Any Changes or modifications not expressly approved by the party responsible for compliance could void the user's authority to operate the equipment.

Note: This equipment has been tested and found to comply with the limits for a Class B digital device, pursuant to part 15 of the FCC Rules. These limits are designed to provide reasonable protection against harmful interference in a residential installation.

This equipment generates uses and can radiate radio frequency energy and, if not installed and used in accordance with the instructions, may cause harmful interference to radio communications. However, there is no guarantee that interference will not occur in a particular installation.

If this equipment does cause harmful interference to radio or television reception, which can be determined by turning the equipment off and on, the user is encouraged to try to correct the interference by one or more of the following measures:

- Reorient or relocate the receiving antenna.
- Increase the separation between the equipment and receiver.
- Connect the equipment into an outlet on a circuit different from that to which the receiver is connected.
- Consult the dealer or an experienced radio/TV technician for help.

\* RF warning for Portable device:

The device has been evaluated to meet general RF exposure requirement. The device can be used in portable exposure condition without restriction.

Frequency band(s) in which the radio equipment operates: 100 KHZ - 200 KHZ

Maximum radio-frequency power transmitted in the frequency band(s) in which the radio equipment operates: 200KHZ 50% / 130kzh 65%

Statement:

"Hereby, [NOESON HONGKONG LIMITED], declares that this [WIRELESS POWER BANK B66954804] is in compliance with Directive 2014/53/EU. The declaration of conformity may be consulted at [www.cg-mobile.com](http://www.cg-mobile.com)"

FCC ID: 2AP7Z-B66954804