



 **FANLIGHT**

# SD-005 Manual

# Components of SD-005



Case

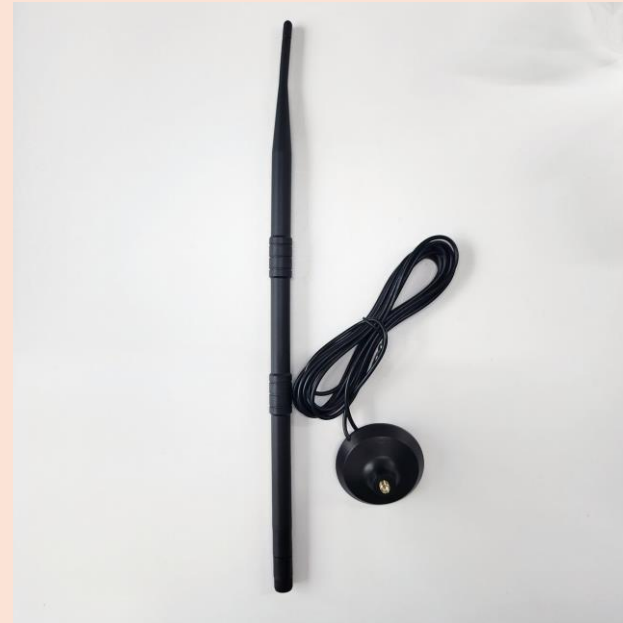

Antenna

# Previous

- 1) This device must be professionally installed.
- 2) This product is a device for centrally controlling products such as light sticks at the stadium, concert hall... etc.
- 3) This product is not sold to consumer and is directly Managed by the manufacturer's engineers,  
because to control this equipment, need to understand the operating system and the radio signal.
- 4) Product compatible antenna type: Dipole Antenna
- 5) Product compatible Peak Gain: < 2.05 dBi

# SD-005 (Front View)

## LCD Screen

Control panel, internal settings,  
and status check

## Button

RF transmission on/off control  
LCD Screen panel control

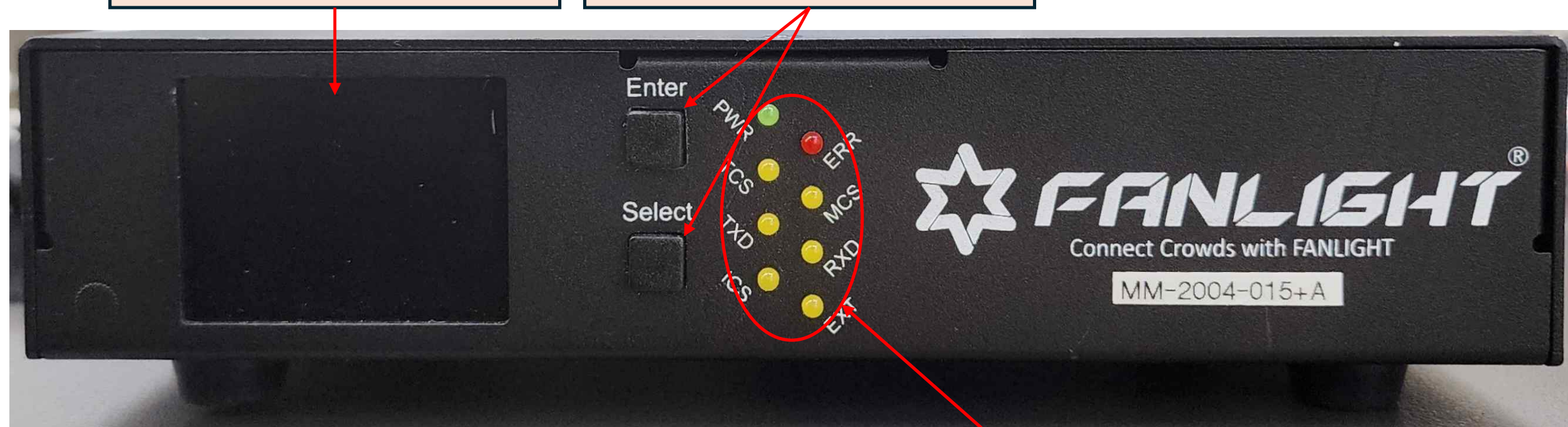

## LED indicators

Power, Tx, Err for  
operation status



# SD-005 (Back View)

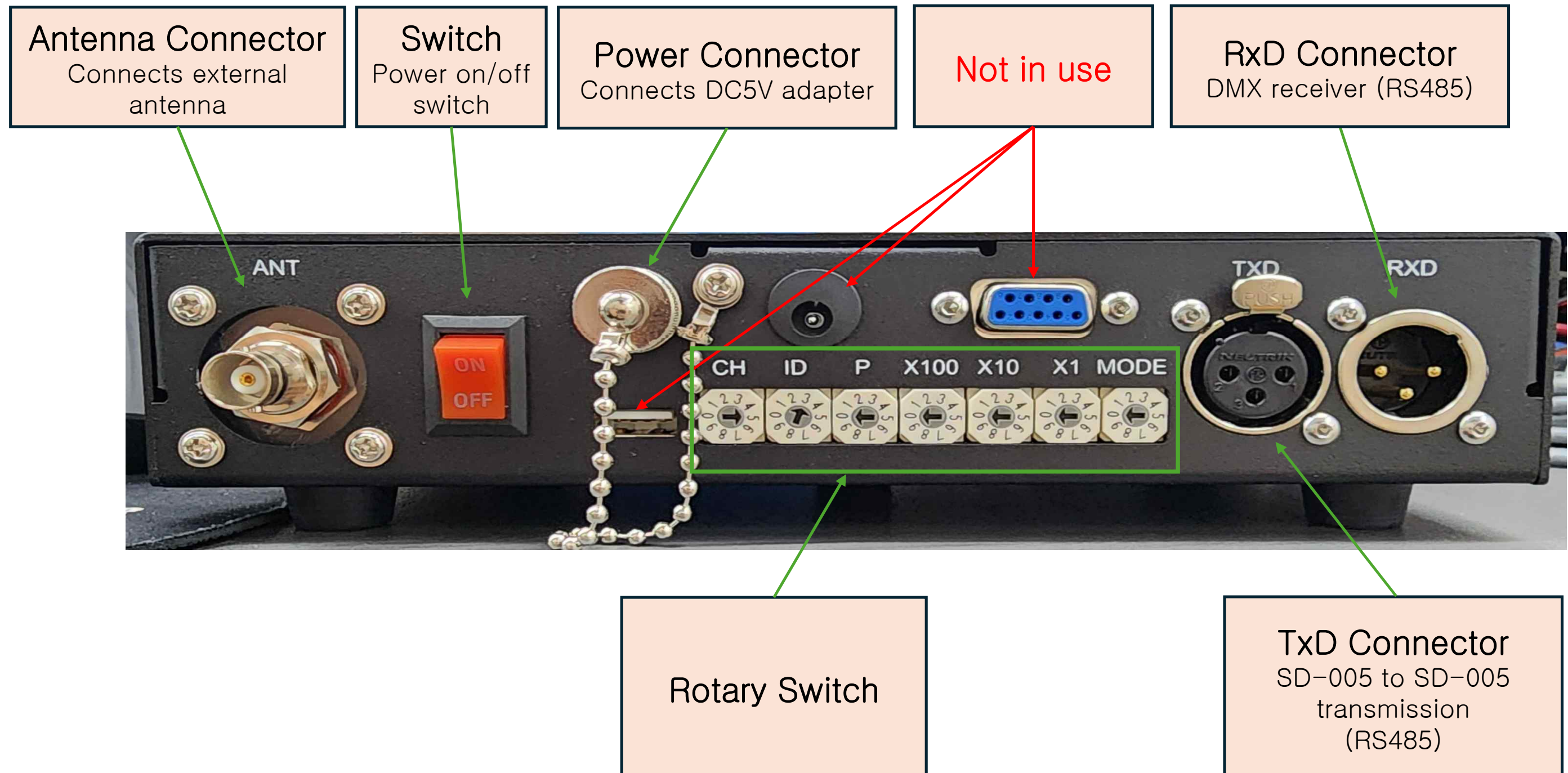



# Specifications

- Model: SD-005
- Operating Frequency: 905–923 MHz
- Dimensions
  - 210 × 160 × 50 mm
  - ↳ Width × Length × Height (excluding antenna)
- Weight: 676g (excluding antenna)
- Power Supply: DC 5V adapter



**FANLIGHT**



# Usage Instructions



1. Set the rotary switch on the back of the device as follows.

✓ 'CH : 5', 'ID : 3, P : 0', 'MODE : 0'

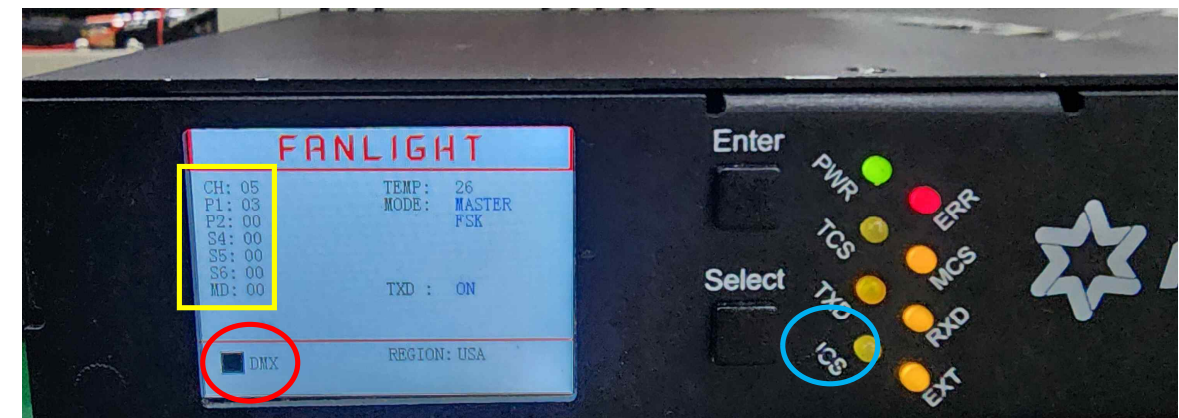

2. Connect the RS485 cable between the DMX transmitter and the RXD port on the back of the SD-005.
3. Connect the DC 5V adapter and turn the switch to ON; the LCD will light up.
4. Once powered on, the device automatically transmits wireless signals. DMX data (color) can also be checked.
5. Use the Select button on the LCD panel to toggle wireless signal transmission ON/OFF. When 'TXD : ON', the TXD LED blinks..

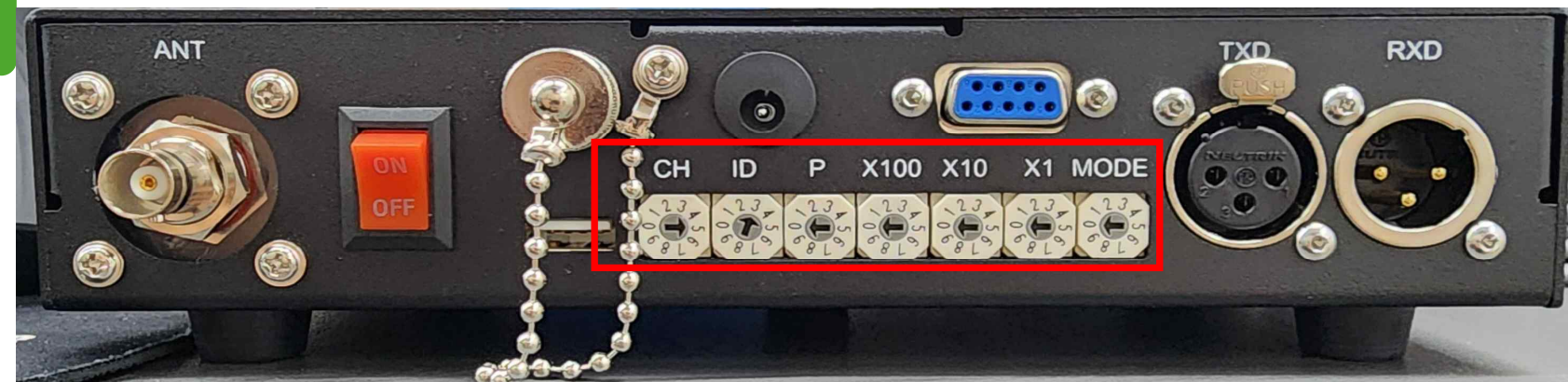

# Features

- CH must be fixed at 5. it means 915MHz frequency.  
❖ If it is not 5, receiver can't receive RF signals properly.
- ID and P adjust wireless signal strength.  
✓ Default strength is low, recommend to set to 30 for usage.

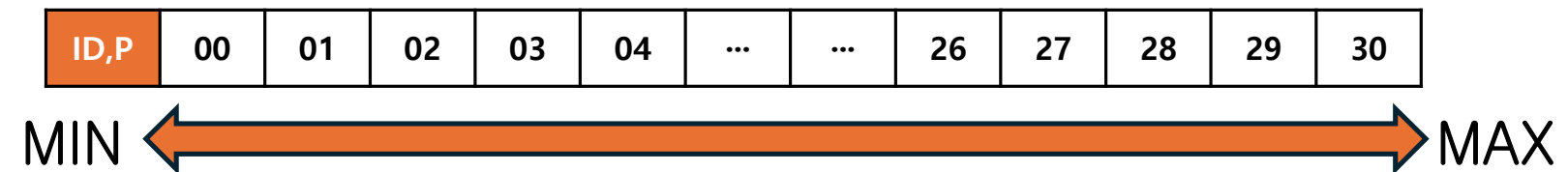



# Features



- X100, X10, X1 No functionality.
- MODE determines modulation method.
  - ❖ It fixed at 0 (FSK)



# Precautions

- Ensure the LCD screen displays the following settings

- CH : 5 (915MHz)
- MD : 0 (Master, FSK)
- Tx – On  
(RF signal transmission enabled)

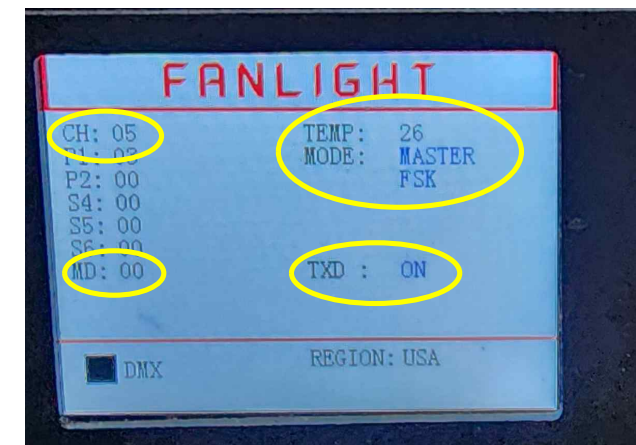

- It is recommended to reboot after adjusting the rotary switch.
- Avoid applying physical force to the external antenna.
- Use only the DC 5V adapter..
- Connect the power adapter properly according to its shape.

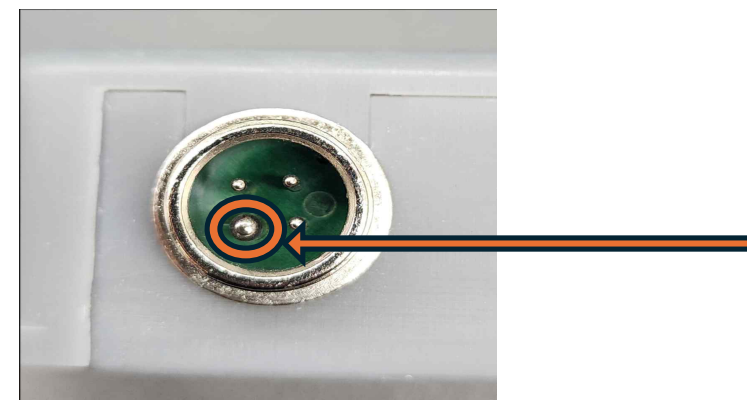



## FCC Statement

This device complies with Part 15 of the FCC Rules. Operation is subject to the following two conditions: (1) this device may not cause harmful interference, and (2) this device must accept any interference received, including interference that may cause undesired operation.

This equipment has been tested and found to comply with the limits for a Class B digital device, pursuant to part 15 of the FCC Rules.

These limits are designed to provide reasonable protection against harmful interference in a residential installation.

This equipment generates, uses and can radiate radio frequency energy and, if not installed and used in accordance with the instructions, may cause harmful interference to radio communications.

However, there is no guarantee that interference will not occur in a particular installation.

If this equipment does cause harmful interference to radio or television reception, which can be determined by turning the equipment off and on, the user is encouraged to try to correct the interference by one or more of the following measures:

- Reorient or relocate the receiving antenna.
- Increase the separation between the equipment and receiver.
- Connect the equipment into an outlet on a circuit different from that to which the receiver is connected.
- Consult the dealer or an experienced radio/TV technician for help.

Any changes or modifications to this device not explicitly approved by manufacturer could void your authority to operate this equipment.

This equipment complies with FCC radiation exposure limits set forth for an uncontrolled environment.

This equipment should be installed and operated with minimum 20cm between the radiator and your body.

This transmitter must not be collocated or operating in conjunction with any other antenna or transmitter unless authorized to do so by the FCC.