

Dealer: Changan Ford Automobile Co., Ltd.

Address: No.1, Changfu West Road, New North Zone, Chongqing

Manufacture: Guangdong Creator & FlyAudio Electronic Technology Co.,Ltd

Address: Block D1, No.3 Industrial Zone, Banxianshan, Hengli Town, Dongguan City,  
Guangdong Province, P.R, China

Service hotline: 400-880-9133

Issue date: 7th December. 2018

Executive Standard: Q/TYFG 1-2016



BP02V0234R0

# **Ford Middle East Model 2018**

**G6169K03A9/G6169K04A9/G6169K05A9**

**Vehicle Infotainment System**

# **User Manual**

Before using the system, please carefully read this manual and properly keep for future reference.



To prevent accident, don't watch video during driving.

## Statement

- This manual mainly introduces the function, purpose and operating method, etc. of the vehicle infotainment system;
- This manual is only used as a user operating guide, not as a basis for maintenance services;
- Due to continuous improvement of the product, the design and specifications are subject to changes without further notice;
- The information provided in this manual can be modified without statement, we reserve the final interpretation right of it;
- Pictures used in this manual are for reference only, we will not assume any liability for any wrong understanding;
- The actual product shall prevail. For details, please consult relevant dealers;
- Brand name such as product name, etc. is the trademark or registered trademark owned by each company.

**FCC NOTICE:**

This equipment has been tested and found to comply with the limits for a Class B digital device, pursuant to Part 15 of the FCC Rules. These limits are designed to provide reasonable protection against harmful interference in a residential installation. This equipment generates, uses and can radiate radio frequency energy and, if not installed and used in accordance with the instructions, may cause harmful interference to radio communications. However, there is no guarantee that interference will not occur in a particular installation. If this equipment does cause harmful interference to radio or television reception, which can be determined by turning the equipment off and on, the user is encouraged to try to correct the interference by one or more of the following measures:

- Reorient or relocate the receiving antenna.
- Increase the separation between the equipment and receiver.
- Connect the equipment into an outlet on a circuit different from that to which the receiver is connected.
- Consult the dealer or an experienced radio/TV technician for help.

To assure continued operation, follow the attached installation instructions and use only shield cables when connecting to other devices. Changes or modifications not expressly approved by the party responsible for compliance could void the user's authority to operate the equipment.

This device complies with part 15 of the FCC Rules. Operation is subject to the following two conditions: (1) This device may not cause harmful interference, and (2) this device must accept any interference received, including interference that may cause undesired operation.

The equipment complies with FCC radiation exposure limits set forth for an uncontrolled environment. The equipment should be installed and operated with minimum distance 20cm between the radiator & your body.

# Catalogue

## Before using the system

Important safety information .....	1
Safety statement .....	1
Ensure safe driving .....	2
Other safety information .....	2
Preparations before use .....	2

## Function and media operation

Schematic diagram of the front panel .....	3
Function description of the front panel components .....	3
Function description of control keys on steering wheel .....	4
Function introduction of main menu .....	5
Standby interface .....	5
Reversing prompt .....	5
[Audio] operation flow chart .....	6
[Audio] operation instruction .....	6
[Media] operation flow chart .....	7
[USB Music] operation instruction .....	9
[USB Video] operation instruction .....	9
[Bluetooth Music]operation instruction .....	10
[AUX]operation instruction .....	10
[Phone]operation flow chart .....	11
[Phone]operation instruction .....	13
[Apps]operation flow chart .....	15
[EasyConnection]operation instruction .....	16
[File Explorer]operation instruction .....	16
[Settings]operation flow chart .....	17
[Sound]operation instruction .....	19
[Clock]operation instruction .....	19
[Display]operation instruction .....	20
[General]operation instruction .....	20
[Bluetooth]operation instruction .....	21
[Wi-Fi]operation instruction .....	21
[Info]operation instruction .....	21

## Appendix

The proper operation of touch screen .....	
■ Attentions .....	23
■ About LCD screen .....	23
■ About TFT .....	23
■ About maintenance .....	23
■ In case of any failure .....	24
■ Common issues .....	24

## Specifications

Universal .....	25
GPS .....	25
Power amplifier and audio components .....	25
FM tuner components .....	25
AM tuner components .....	25
Installation Guide .....	26
Environmental Protection .....	27
USB compatibility list .....	28

## Important safety information

Before using the system, be sure to carefully read and understand the following safety information, and put this manual in car, as the reference for operating procedures and safety information.



- ★ Do not install or repair your infotainment system by yourself. If the personnel not trained on electronic devices and auto parts install or repair the system, it may lead to electric shock or other dangers;
- ★ Relevant national laws and regulations provide that no driver shall watch video or operate infotainment system during driving, in order to protect your and others' life safety, please do not watch video or operate infotainment system during driving;
- ★ Someone else shall not use the system, unless they have read and understood the operating instruction manual;
- ★ Do not use the infotainment system in an emergency of driving to hospital, police station or similar institutions;
- ★ Please pay special attention to all the matters needing attention in this manual, and strictly comply with the operating instructions;
- ★ The infotainment system shall not be exposed to any liquid material, otherwise it will lead to electric shock, and may cause damage, overheating and smoking, etc. of the infotainment system.

## Safety statement

- The navigation function (as well as the optional backing camera function) of the infotainment system is only an auxiliary tool when you drive, it doesn't mean that you can be distracted, careless and even lose judgment when driving. For the resulting safety accident, we do not assume any legal liability;
- The route and navigation information displayed on the system is for reference only and may not be able to reflect exactly the new and approved routes, road situations, one-way streets, road closures or traffic restrictions;
- Currently implemented traffic restrictions and traffic suggestions must have precedence over the information provided by the infotainment system. Therefore, please be sure to comply with current traffic restrictions, even when the navigation system provides opposite traffic suggestions;
- The map data stored in TF card belong to the intellectual property of map supplier, and the map supplier shall be responsible for such contents.



Do not install the infotainment system in case of any one of the following circumstances:

- ★ It may obstruct the driver's line of sight;
- ★ It may affect vehicle operating system or safety performance, including air bag, danger alarm lamp button, etc.

## ※ Attentions

- ☆ If you fail to input accurate place name, it may result in that the infotainment system provides improper route and navigation instructions;
- ☆ This product shall not be exposed to moisture;
- ☆ If the battery is power off or discharges electricity, it will cause the system memory to be cleared, and the system must be reprogrammed.

## Ensure safe driving

- Be sure to abide by safe driving rules and current traffic regulations;
- If the operation of the navigation system (and the optional backing camera function) will distract you from safe driving, please do not operate;
- If you want to watch the display screen for system operation, please park the car in a safe place and brake, and then operate the system;
- Do not set the volume of the navigation system to be too high, otherwise you can't hear the traffic situations and emergency rescue signals outside the car;
- For safety, when driving, you will be unable to operate some functions of the system. Unless you stop the car or brake to standstill;
- Please bear in mind that fasten your seat belt when driving, otherwise in case of any traffic accident, it will cause grievous injury to you;
- Do not wear earphones when driving;
- In order to prevent traffic accident and avoid possible violation of applicable laws, during driving, please do not use the system for any other purpose other than navigation;
- In some areas, drivers or passengers inside the vehicle watching the images on the display screen may be illegal. Please comply with these regulations when applicable;
- This system can detect whether the stopping brake of the vehicle is in service, and it will prevent you watching the images on the display screen during driving;
- During vehicle running, you will be unable to operate some menu of the navigation system and some media functions. If you want to watch the images on the front display screen, please park the car in a safe place and brake.

## Other safety information

- In order to avoid the battery exhaustion, please ensure to start the engine when using this system, otherwise the use of this system may lead to battery exhaustion;
- If this product can not work normally, please consult the manufacturer's customer service department.
- The right of final interpretation for the product manual is owned by the manufacturer.

## Preparations before use

Adjust the ACC of the vehicle to ON, start the engine, update the system, reset the system, reset factory data, or turn off and turn on the power supply, after a few seconds, the following prompt box will appear:



### **Warning**

- ★ For safety, the system is designed in the following way: no destination setting or other complex operations can be conducted during driving;
- ★ Please operate after parking the vehicle in a safe location and braking, the driver shall never operate during driving.

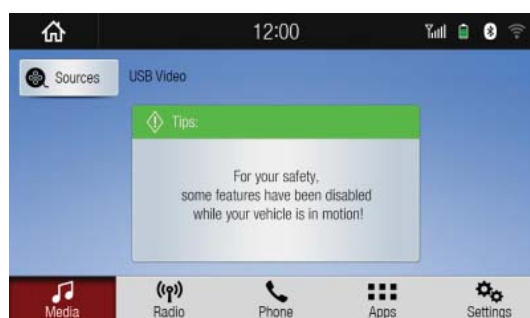

Note:

When the vehicle speed is more than 8Km/h, safety tips will pop up;  
when the vehicle speed is less than 8Km/h, the tips will disappear automatically.

## Schematic diagram of the front panel



## Function description of the front panel components

### Touch screen

To display different images, click on the control menu in the images to select the control items.

### Standby/Restart/Volume control knob button ( VOL )

- 1、Adjust the volume outputted from the machine. Turn it clockwise, the volume will increase. Turn it counterclockwise, the volume will decrease.
- 2、Press the knob button, the screen will enter into standby interface. Press again to cancel standby status and return to current interface.
- 3、Press and hold for more than 5 seconds, infotainment system will restart.

### Main menu key ( )

Except at the backing, Bluetooth phone and standby status, pressing this key at any other pages can quickly switch to the main menu interface.

When lock the screen, pressing the main menu key for the first time can only wake up the screen, and the screen will stay at display interface in settings.

### Media source key ( )

Press this key to switch between media and radio.

### FM/Previous song/next song/sound

- 1、When listen to the radio, switch the knob for changing radio channel.
- 2、Press this knob vertically to quickly enter into sound setting interface.
- 3、At the status of multimedia playing, turn the knob clockwise to enter the next song, turn the knob counterclockwise to enter previous song(AUX IN doesn't support this function).

### Mute key ( )

Press the key to open/cancel mute.

### USB port/built-in reset pin ( )



- 1、Read the files in USB flash disk.
- 2、Open the USB cover, press the reset pin to restart the infotainment system.

**Note** • This picture is for reference only. The actual product appearance shall prevail!



## Function description of control keys on steering wheel



- 【】 : In radio interface, press this key to switch back to previous preset channel, press and hold this key to automatically search previous frequency channel with signal. In music or video interfaces, press this key to enter previous song or video, press and hold this key to skip backward. In Bluetooth music interface, press this key to enter previous song, and has no function if press and hold. At the status of incoming call, press this key to answer.
- 【】 : In radio interface, press this key to switch to next preset channel, press and hold this key to automatically search next frequency channel with signal. In music or video interface, press this key to enter next song or video, press and hold this key to skip forward. In Bluetooth music interfaces, press this key to enter next song, and has no function if press and hold. At the status of incoming call or answering a call, press this key to reject or hang up.
- 【VOL+】 : Push up the "M" on steering wheel to increase the volume. Push up slightly to +1, push and hold to continuously increase the volume.
- 【VOL-】 : Push down the "M" on steering wheel to decrease the volume. Push down slightly to -1, push and hold to continuously decrease the volume.
- 【M】 : This key is for media switching function.

### Note

- This function is only for Intermediate and high configuration, models don't have this function.
- The actual product shall prevail!

## Function introduction of main menu

Except the status of backing, calling and standby, pressing the 「」 key on frame can switch to the main menu interface. There are 6 function menu keys in this page, as shown below:



- 【Media】 : Open navigation and media function in this infotainment system.
- 【Radio】 : Listen to FM/AM radio channel.
- 【Phone】 : Via Bluetooth match, achieve contact, and answering calls in car and by phone function,
- 【Apps】 : Enter EasyConnection and Explorer file interface ports.
- 【Settings】 : Set relevant information of system.

The operation of these functions will be introduced in detail in the following sections.

### Standby interface :



Press the center of the left knob button vertically of the machine, then the system will enter standby interface. Press again to return to current interface. The standby interface is as shown above.

### Reversing prompt :

If backing car camera has been installed , when there is a reversing with an incoming call, a prompt interface will be popped up as below:



Implement incoming call according to answer or reject key in current prompt interface.

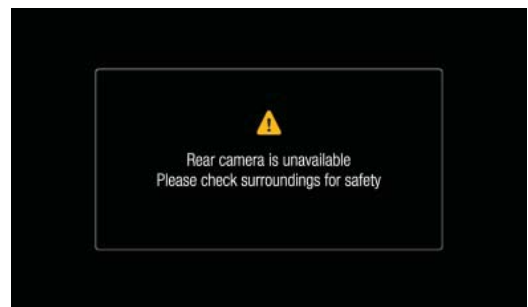

When the backing car camera is uninstalled, relevant prompt of which camera doesn't work will be popped up on screen.

## 【Radio】 Operation flow chart

Main menu



Radio



## 【Radio】 Operation instruction

Click on the 【Radio】 in main menu to enter radio main page and search the previously received stations.



【531 kHz】 : The frequency of the radio being played.

【Mute】 : Press this key to enter the mute mode, press again to return to the original volume.

【Scan】 : Click to automatically search, scan and save the radio stations.

Press relevant keys to switch between FM and AM modes. It provide stored cells for both FM and AM modes to store frequently used stations. Press the frequency in cells to listen. If need to change or reset stations, please follow the steps below:

【Presets】 : Press this key to search the desired stations. Select one cell, press and hold for 2 seconds, then the desired radio station will be in the cell with its frequency showed on.

Manual Search :

In the radio interface, press button [◀◀] or [▶▶] on the physical panel to automatically search backward or forward until an effective station is found. If no station is found after a cycle, will return to the original frequency (There is no sound during searching).

Press and hold to quickly search backward and forward with sound outputting. Release the key to continue to automatically search backward or forward until an effective station is found (There is no sound during searching). If no station is found after a cycle, will return to the frequency before release.

### Note

- Automatically preset the list display of the radio stored in frequency channel.
- The received signal will be weak in tunnels, behind mountains, building interspace and other places where the electric waves are easily blocked and the electric waves are weak.
- Even if the list displays, according to current position and electric wave situations, sometimes it can't receive signal.
- In case of power failure due to battery cut off or fuse blowing, the prestored radio stations may be erased.

## 【Media】 Operation flow chart

### Main menu



### AUX



### Bluetooth music



### Media source

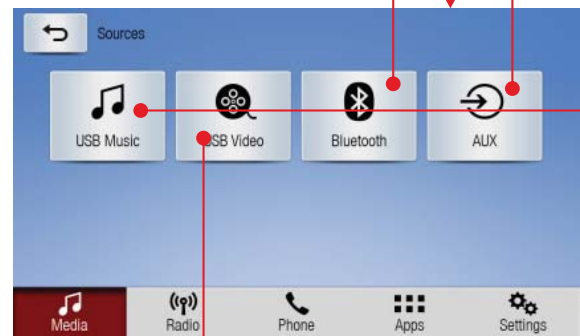

### USB video

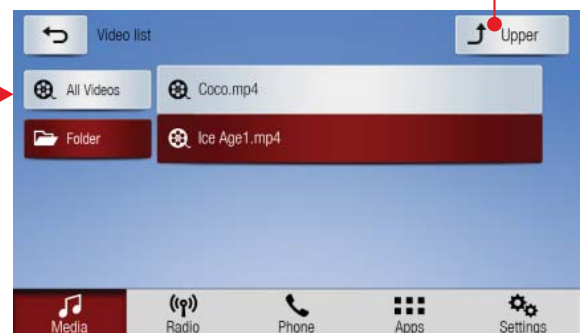
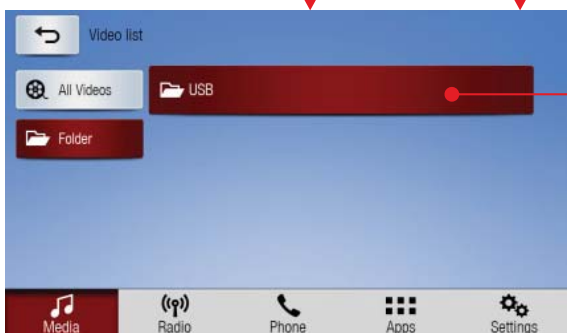

## USB music





## 【USB Music】 operation instruction

### USB Music

Click 【USB Music】 key in 【Sources】 function to enter USB Music operation interface as below:



- 【 || 】 : At the status of playing, press this key to pause.
- 【 ► 】 : After insert USB flash disk with available songs, press this key to start playing.
- 【 ◀◀ 】 : Press to play previos song. Press and hold to skip backward.
- 【 ▶▶ 】 : Press to play next song. Press and hold to skip forward.
- 【 Repeat 】 : Default to repeat the whole music list. Click to repeat one song.
- 【 Shuffle 】 : Press this key to shuffle audio documents.
- 【 Mute 】 : Press this key to enter mute mode.Press again to restore the former volume.

Note: The system will default to automatically repeat the music lit if 【repeat one】 and 【shuffle】 are not chosen.

### Music list



- 【 All Songs 】 : Press this key to enter music list interface.
- 【 Folder 】 : Press this key to search music by folder routine.
- 【 Artist 】 : Press this key to search music by choosing artists.
- 【 Album 】 : Press this key to search music by album.

## 【USB Video】 operation instruction

### USB Video

Click 【USB Video】 key in 【Sources】 function to enter USB video operation interface as below:



- 【 || 】 : At the status of playing, press this key to pause.
- 【 ► 】 : After insert USB flash disk with available videos, press this key to start playing.
- 【 ◀◀ 】 : Press to play previos song. Press and hold to skip backward.
- 【 ▶▶ 】 : Press to play next song. Press and hold to skip forward.
- 【 Repeat 】 : Enter list repeat mode.
- 【 Shuffle 】 : Press this key to shuffle videos.
- 【 Mute 】 : Press this key to enter mute mode.Press again to restore the former volume.
- 【 Image 】 : Press this key to enter video image and operation menu interface as below:

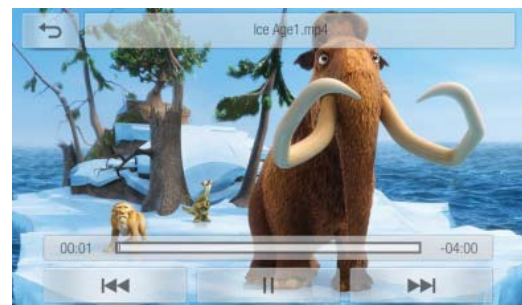

### Video list

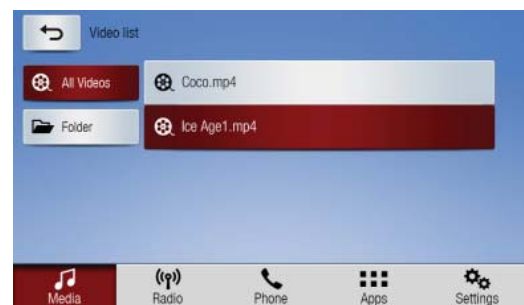

- 【 All Videos 】 : Press this key to enter video list interface.
- 【 Folder 】 : Press this key to search videos by folder routine.

### 【Bluetooth Music】 operation instruction

Click 【Bluetooth music】 key in 【Sources】 function to enter Bluetooth music operation interface as below:



- 【<<】 : Press this key to play previous song.
- 【▶】 : At connective status, press this key to play.
- 【||】 : At connective status, press this key to pause.
- 【>>】 : Press this key to play next song.
- 【Mute】 : Press this key to enter mute mode. Press again to restore the former volume.

### 【AUX】 operation instruction

Click 【AUX】 key in 【Sources】 function to enter AUX interface (There is only audio input without operation function).



The audio and video format as well as decode format supported by the infotainment system are as below:

Audio	File Format		Audio Decode
	AAC		AAC
	MP2		MPEG
	MP3		MPEG
	FLAC		FLAC
	APE		MONKEY
	M4A		AAC
	WAV		PCM
Video	File Format	Video Decode	Audio Decode
	AVI	XVID	MPEG/AC3
	MP4	XVID	AAC
	MKV	MPEG-4	MPEG/AAC/AC3

## 【Phone】 operation flow chart

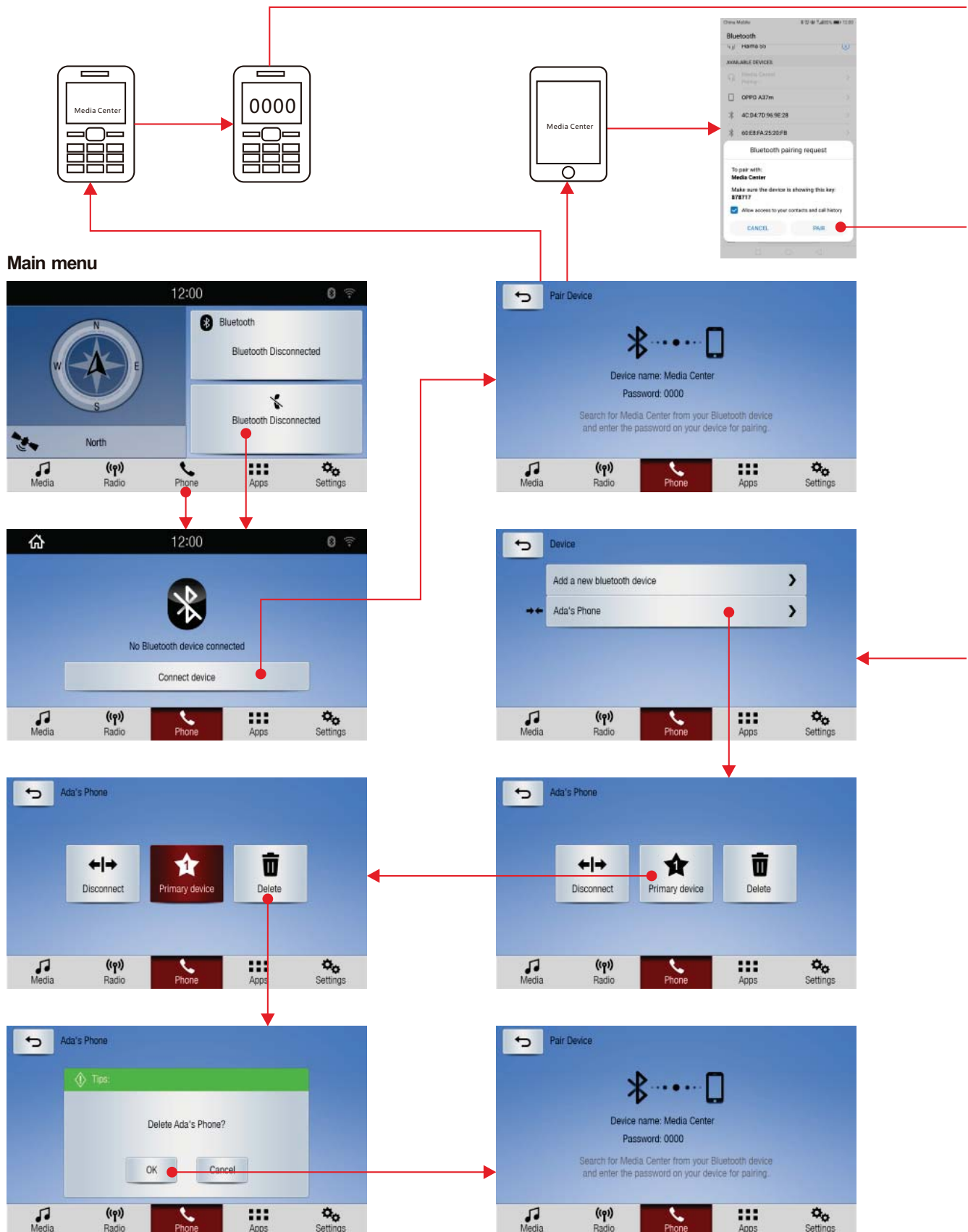



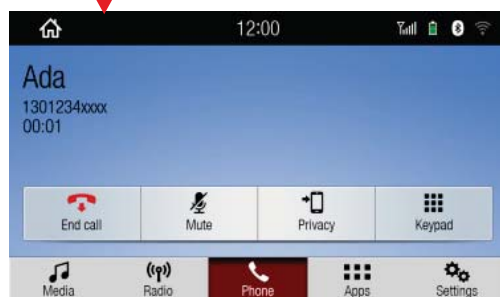
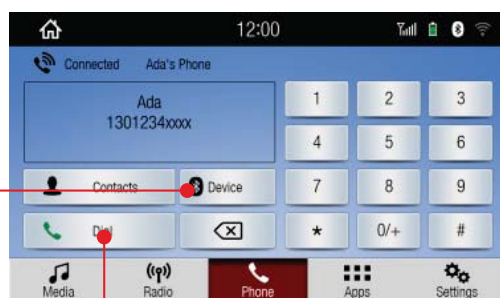
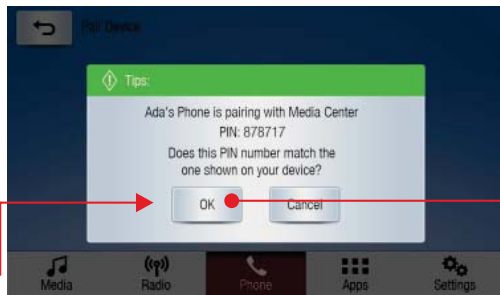

The 3rd call



## 【Phone】 operation instruction

If there is a history bluetooth device list,click phone's name to pair shown as below:



If there is no history bluetooth device list,click Connect device to enter pairing interface.



Pairing method is shown as below:

1. For a feature mobile phone , input the default pairing code, then the connection of mobile phone pairing will be started,with the default pairing code being "0000".

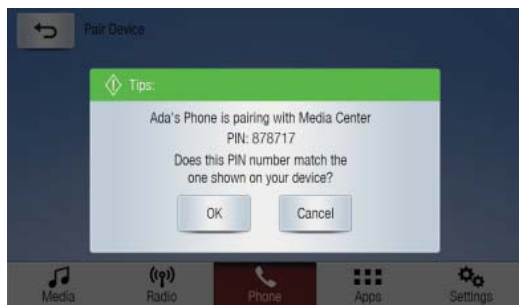

2. For a smart mobile phone, when the name of the navigation device is found by searching, click the corresponding name of the navigation device upon confirming that the PIN code on the mobile phone side is consistent with that on the navigation device side, then the pairing will be started.

After connect successfull, the interface will be shown as below. Click Device to enter bluetooth device interface.

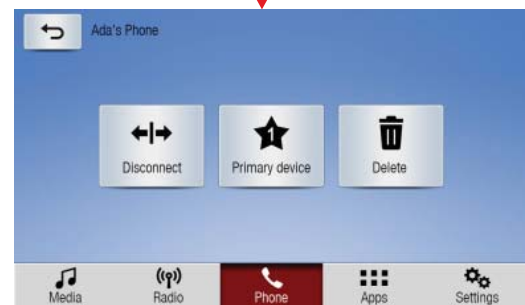

Click the phone name in the device list to enter the device setting. You can select "Disconnect", "Primary device", "Delete" and other setting options.

Disconnect: Disconnect the current pairing phone device.

Primary device: Choose it to preferentially connect the current phone device next time open the phone bluetooth.

Delete: Delete the current phone device in pairing list.

Click the **【Phone】** key in main menu.

The interface after connect bluetooth is shown as below:



**【Contacts】** : Click on this key, the image is shown as below.

**【Device】** : Click this key to enter bluetooth device interface.

**【☎】** : Dial.

**【✕】** : Delete the wrong number.



After successfully connect bluetooth, the system will prompt to automatically download contacts. Click "OK" to download automatically.

**【Missed】** : List of missed calls.

**【Received】** : List of received calls.

**【Placed】** : List of dialed numbers.

**【Phonebook】** : Contacts stored in mobile phone (the device should support it)

**【↩】** : Click this key to return to **【Phone】** interface.

**【Search】** : Click the search box at the top of the page to enter contacts for searching as below:



In the search box, input related letters of contact name, relevant contact information will pop up. Then click on the "↓" key on the keyboard to hide it as below:



When in an active call there is another call coming in, you can click Answer to reserve the current calling and answer the third's call.



When you are answering a call, you can click the Switch button to switch between the calls. Click **【Privacy】** to switch to answer by phone.

## [Apps] operation flow chart

### Main menu



### Easy Connection



### Apps

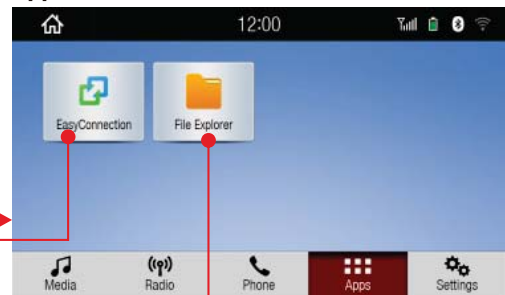

### File Explorer



Press and hold the image



Press and hold the image

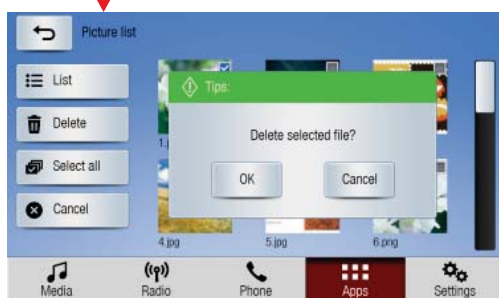
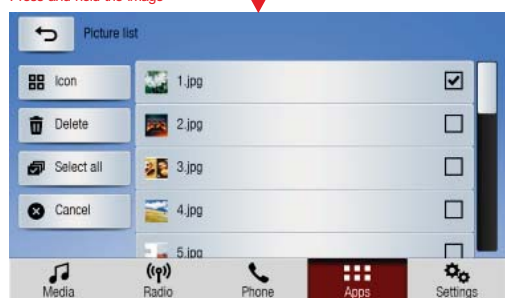



### 【EasyConnection】 operation instruction

Click 【EasyConnection】 key in Apps menu.  
The interface is shown as below:



Phone APP downloading:

Downloading method 1.

Click 【EasyConnection】 key in Apps menu to enter EasyConnection main page. Connect the phone to the navigation device via USB data line, a prompt of visiting Google Play to download App will pop up on the phone.

Downloading method 2.

Click 【EasyConnection】 key in Apps menu to enter EasyConnection main page. Click Android USB on the navigation device screen, wait a few seconds for the QR code of downloading prompt. Scan the QR code by phone to download.

Connection method :

1. Open EasyConnection which is downloaded on phone.

2. Connect phone to the navigation device via USB data line. After the connection is well fulfilled, a prompt of authorization will pop up. Click Agree or Allow.



After connect successfully, the main page is shown as above. For more details, please visit EasyConnection website.

### 【File Explorer】 operation instruction

Click 【File Explorer】 key in Apps menu, the interface is shown as below:



【Pictures】 : Click this picture to enter the related list.



Click Icon on the top left corner to switch to picture browse mode.



Press to enter browse mode shown as below. Press and hold to edit, delete, select all, cancel and more.

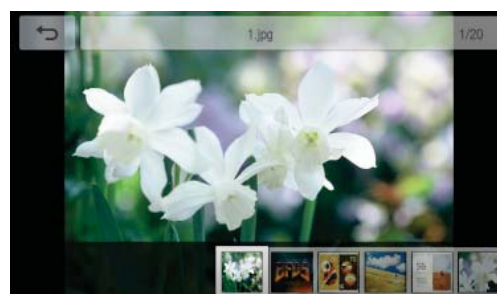

## [Settings] operation flow chart

### Main menu



### Clock



### Sound

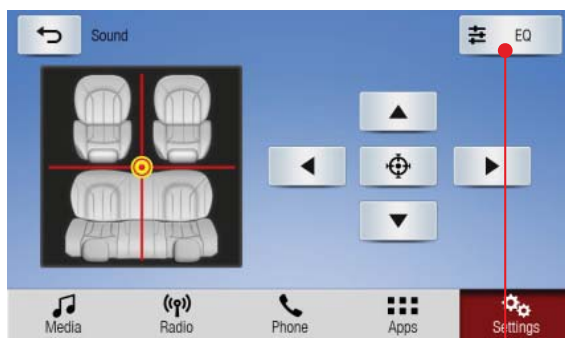

### Settings

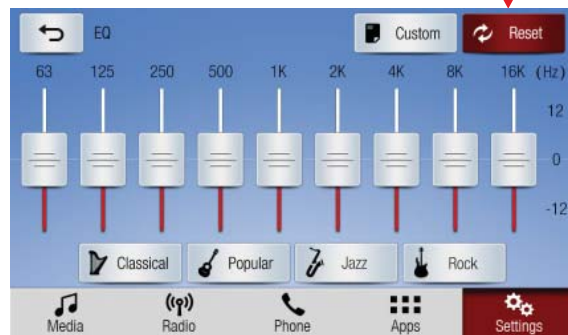

### WiFi

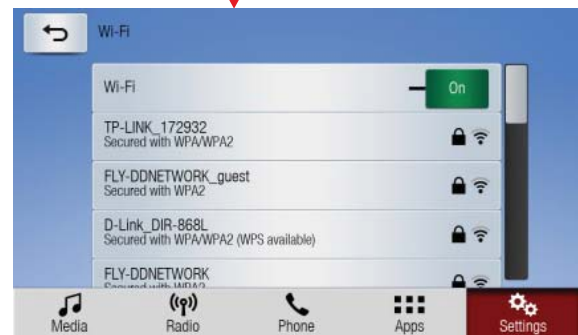

### Info



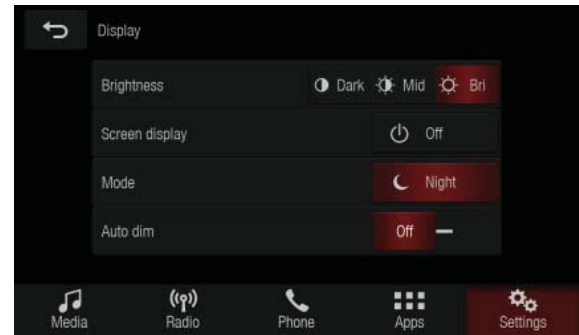

## Display



## General



## 【Sound】 operation instruction

The sound effect depends largely on the combined sound level of high and low sounds. In fact, various musical and vocal programs will be more fair-sounding through the combination of high and low sounds of different sound levels. It's also very important to maintain the best balance of the left and right stereo sound channels as well as the front and rear sound levels. As shown below:

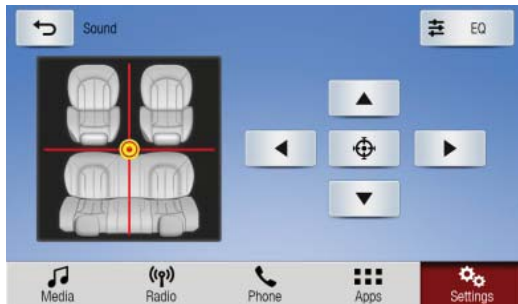

【▲】 【▼】 : Adjust the sound balance between the front and rear speakers.

【◀】 【▶】 : Adjust the sound balance between the left and right speakers.

Each time you press the 【▲】 or 【▼】 , 【◀】 or 【▶】 , the red display bar will move towards corresponding direction for one unit.

【↶】 : Press this key to return to the upper operation interface.

**Note** • When listening to the disc or broadcast of stereo, changing the left/right balance will increase the volume of one group of sound and meanwhile decrease the volume of the other group of sound.

### EQ

In audio equipment, EQ is a kind of electronic equipment that can adjust the amplification of electrical signals of different frequency components. Through adjusting electrical signals of different frequency, it can compensate the defects of speakers and sound field, compensate and beautify various sound sources, etc. EQ of general sound console can only respectively adjust the electrical signals of high, intermediate and low frequency.

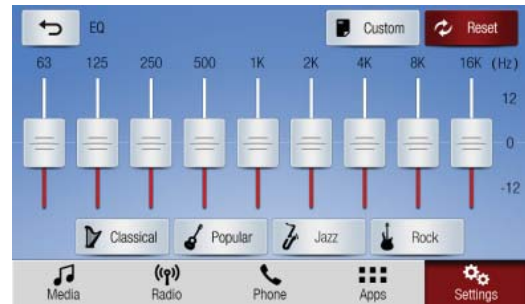

【Classical】 : For classical music, it increases the volume of high and low parts, and mainly highlights the performance of musical instruments.

【Popular】 : For popular music, it requires the combination of voice and instrumental music to be equalized, so the fluctuation of curve is not big.

【Jazz】 : Jazz inverts the strong and weak beat by a continuously syncopated way, change the rhythm, make timbres dramatic.

【Rock】 : Rock expresses emotion through its flexible and bold manifestation and passionate music rhythm.

【Custom】 : Users adjust the EQ according to their own preference. Note: After the custom function is set, press and hold this key to save the custom settings.

【Reset】 : Reset all the EQs.

## 【Clock】 operation instruction

At the status of closing GPS time, click 【Clock】 in the 【settings】 to adjust the system by scrolling as below:





## 【Display】 operation instruction

Press 【Display】 in the 【Settings】 as below:



【Brightness】 : When the system is working, users can set the screen to one of the three brightness modes, [Dark] [Mid] or [Bri] according to their own needs.

【Screen display】 : Click to enter black screen sleep mode. Click again to restore.

【Mode】 : Click on this key to set the navigation screen to [Day] or [Night] .

【Auto dim】 :

When it is set to [ON]:

Car model with automatic headlamps

【Automatic headlamps】 : 【Mode】 can not be manually set. In dark places, it can be switched to the night mode with keypad backlight on and screen darkened, otherwise it is in the day mode with keypad backlight off and screen lightened in bright places.

Car model with nonautomatic headlamps

【Nonautomatic headlamps】 : Open the headlamps to enter night mode with keypad backlight. The day and night mode can only be set manually by clicking the [Mode] on the screen, but can not be controlled by car headlamps and light in surroundings.

When it is set to [Off] :

The day and night mode can only be set manually by clicking the [Mode] on the screen, but can not be controlled by car headlamps and light in surroundings.

【 ⏻ 】 : Click this key to turn off the screen.

## 【General】 operation instruction

Click [General] in [Settings] of the main menu to enter the interface as shown below:

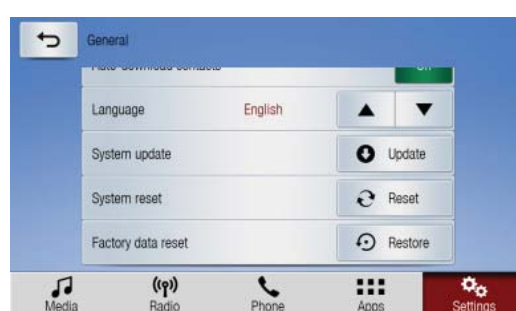

### 1.Auto-download contacts

Open it then the prompt of downloading contacts will pop up when connect bluetooth. Close not to prompt after connect bluetooth.

### 2.Language

Select 【 ▲ 】 【 ▼ 】 to choose system language.

### 3.System update

Click 【Update】 , two update methods will be displayed on the screen.

Update online : Connect the internet and press this key to check the current version. If there is a new version, can download and update.

Update offline: Insert the USB flash dish with the latest version, press this key to update offline.

(Note: Do not cut off the power supply during updating.)

### 4.System reset

Press 【Reset】 to reset the system.

### 5.Factory data reset

Press this key to wipe the system settings and reset to factory defaults.

Press 【 ⬅️ 】 to return to settings operation interface.

## 【Bluetooth】 operation instruction

If there is history Bluetooth phone list, click phone name to pair as below:



If there is no history Bluetooth phone list, click connect Bluetooth directly enter into pairing interface.



Pairing method as below:

1. Input default pairing password to pair with devices for feature phone according to prompt. The default pairing password is "0000".

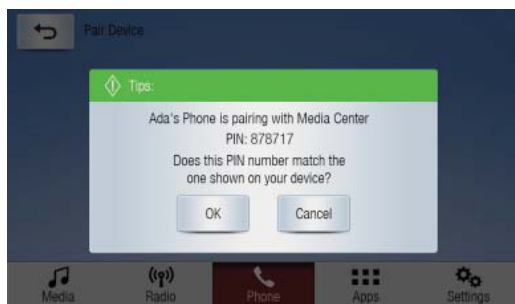

2. Search device name using smart phone, click corresponding device name on phone screen, check the PIN number of phone match with the device's, click "OK" to pair.

## 【WiFi】 operation instruction

Click 【WiFi】 button and open 【WiFi】. The button shows as below:



Find corresponding WiFi name in WiFi list, click and input WiFi password to connect.

## 【Info】 operation instruction

Click 【Info】 button to display information such as MODEL、MCU、Barcode、FID、BOOT.



# Appendix

## The proper operation of touch screen

### Attentions

- \* Do not place the display screen in direct sunlight or high temperature for a long time, otherwise it may cause screen failure; please use the display screen within the following temperature range:  
Application temperature range: -10°C~+50°C  
Storage temperature range: -20°C~+80°C
- \* Do not press hard on the display screen, otherwise it may cause failure;
- \* For the vehicles equipped with air bags and other safety devices, be careful not to interfere with the work of safety devices.

## About LCD Screen

- \* Sometimes there will be small dark spot or flare spot (bright spot) on the LCD image of display screen, it is a peculiar phenomenon of LCD screen, not a failure;
- \* When used in cold area, the screen may be dark after power on, after a while, it will restore normal brightness;
- \* It will be difficult to clearly watch the LCD image of display screen due to the reflection of sunshine.

## About TFT (Thin Film Transistor)

- \* In order to ensure the backlight of LCD screen, use TFT inside the display screen;
- \* The service life of the TFT is about ten thousand hours (when used in cold area, the service life will be shortened), at the end of its service life, the screen will become dark or can not display images, please consult the manufacturer's service department.

## About maintenance

- \* When cleaning the dust or dirt from the display screen, please first turn off power supply, then use a soft cloth to wipe gently;
- \* When wiping the display screen, be careful not to scratch the screen by nails;
- \* Do not use wet wiping cloth, volatile oil, diluent, etc. to wipe the display screen;
- \* The display screen shall not be exposed to corrosive materials.

## In case of any failure

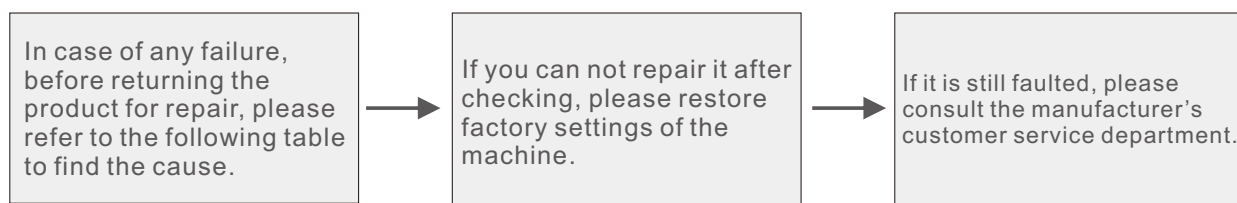

## Common Issues

Trouble	Cause	Solution
Fail to turn on power supply, it does not work	The wires and connectors are not properly connected.	Confirm again whether it is properly and firmly connected.
	Fuse is blown.	Find out the cause for blown fuse, please replace with the fuse of the same capacity.
	Due to noise and other factors, the built-in computer is out of order.	Please press the reset button.
The touch key on the screen is inactive or unresponsive	There is deviation between the position on the screen and the actual touch position.	Please conduct the setting of touch screen calibration.
There is small dark spot or bright spot on LCD screen	It is a peculiar phenomenon of LCD screen, not a failure.	
LCD screen is dark	Adjustment of the bright degree is improper.	Adjust the brightness.
	Temperature in the car is low.	If the ambient temperature is low, the LCD screen will become dark. Please use heat to increase the temperature in the car.
There is no sound	The volume is set to 0.	Increase the volume.
	Audio line connection is wrong.	Confirm whether it is wrongly connected.
It doesn't display image	No parking brake.	Conduct parking brake.
	Close the display screen.	Press the power key or gently click on the screen.
The volume is low.	Decrease the volume.	Increase the volume.
It doesn't display the navigation system interface	The image is not switched to the navigation system.	The image is switched to the navigation system.
There is no sound from the front or rear speaker	The adjustment of increasing or decreasing the volume of the front or rear speaker is improper.	Correctly adjust and set.
There is no sound from the left or right speaker	The adjustment of increasing or decreasing the volume of the left or right speaker is improper.	

## Specifications

(Due to continuous improvement of the product, the specifications are subject to changes without further notice)

### Universal

Maximum current consumption: 10.0A  
Power supply: DC14.4V (11V~16V can be used)  
Grounding method: minus earth  
External image input level: 1V<sub>p~p</sub>/75  
Maximum input level of external sound: 1.5V/22K  
Image output level: 1V<sub>p~p</sub>/75

### GPS

Method: L1, C/A code GPS SPS standard positioning service  
Reception mode: 12 channels  
Receiving frequency: 1575.42MHz  
Sensitivity: -130dBm  
Test update time: about 1 time/s

### Power amplifier and audio components

Rated power output: 48W (12Wx4)  
Maximum power output: 120W (30Wx4)  
Load impedance: 4Ω

### FM tuner components

Wave band of receiving frequency: 87.5 MHz – 108.00 MHz  
Practical sensitivity: ≤12 dBμV  
Search sensitivity: 35 dBμV  
S/N: more than 50dB (IHF-A network)  
Harmonic distortion rate: 0.3%  
Frequency response: ≥ 2KHz  
Stereo separation degree: ≥ 27dB

### AM tuner components

Wave band of receiving frequency: 522KHz ~ 1620KHz (9 KHz)  
Practical sensitivity: ≤ 28 dBμV

**Please read all items in detail before install. Recommend to install by specialist car audio distributors.**

#### Installation Steps

- 1、Check if all installation accessories with the machine are complete.
- 2、Please disassemble the original stereo equipment.
- 3、Fix set bolts and rubbers in accessory package on the infotainment system machine(There is no need to fix if no set bolts and rubbers in package).
- 4、Install by steps in installation flow chart, connect peripheral auxiliary equipment to the machine, start the engine, turn on the machine and check. If it can't be turned on, please check whether wires connection is correct. If it works normally, adjust ACC to OFF and shut down the engine.
- 5、Assemble the machine which is connected correctly to the position of original machine and ensure the stability of assembly.

**Note**

#### Special Notes

- 1、Do not damage car wires.
- 2、Advice to disassemble the battery cathode before install to avoid short circuit.
- 3、To prevent accidently damage, please don't connect components when the power is on.
- 4、Please check if the car model remarked on switched wire provided by the infotainment system machine is the same as the actual car model.
- 5、Please check the connection between car line and audio wire of the infotainment system machine.
- 6、Check the components connection before electrify, including no short circuit between battery anode +(yellow wire) and Earth wire(black). Connecting power line to other wires will damage the machine or car.
- 7、Do not connect directly the power line of this product to power lines of other electrical equipments.

**Table of the name and content of poisonous and harmful substances or elements**

Part Name	Poisonous and harmful substances or elements						
	Pb	Hg	Cd	Cr6	PBDE	PBB	Environment-friendly use period
Mainboard	X	○	○	○	○	○	10
Display screen	○	○	○	○	○	○	10
Platstic	○	○	○	○	○	○	10
Metal	X	○	○	○	○	○	10
Nonmetal	○	○	○	○	○	○	10
Data line	○	○	○	○	○	○	10
Antenna	○	○	○	○	○	○	10
Accessories	○	○	○	○	○	○	10

O: It indicates that the content of the poisonous and harmful substance in all the homogeneous materials of the part is below the limit specified in GB/26572-2011.

X: It indicates that the content of the poisonous and harmful substance in at least one homogeneous material of the part is within the limit specified in GB/26572-2011.

**Note** • The reason for this product marked with "X": At present, there is no alternative technology or part available.

The environment-friendly use period indicated on this product refers to the safe use period during which there is no leakage of poisonous and harmful substances when using this product under the service conditions specified in this information guide.



## USB compatibility list

NO	Manufacture	Model	Memory Capacity (GB)	Picture	NO	Manufacture	Model	Memory Capacity (GB)	Picture
1	TOSHIBA	THUHYBS	4		15	Kingston	DT100 G3	32	
2		THV3DCH	16		16		DT50	16	
3		THN-U363S0640C4	64		17		DT100 G3	16	
4		THN-U301W0160C4	16		18		DTIG4	64	
5		U365-32G	32		19	SanDisk	CZ50	8	
6		U364-64G	64		20		SDCZ48	16	
7		THN-U203W0320C4	32		21		CZ71	16	
8		THN-U301W0320C4	32		22		CZ33	16	
9		THN-U363S0320C4	32		23		CZ73	32	
10	Kingston	DTSE9H	8		25		SDCZ430-032G-Z46	32	
11		DTSE9G2	32		26		SDDD2-032G-Z46	32	
12		SE1	8		27		SDDDC2-016G-Z46	16	
13		DTSE9H	8		28		SDCZ57-032G-Z35	32	
14		DT50	32						

## Note

- This product doesn't support to read encrypted USB drives. This list is for reference only. The actual product shall prevail!